

Some of the contents in this manual may differ from your phone depending on the software of the phone or your service provider.

SAMSUNG ELECTRONICS



World Wide Web
<http://www.samsungmobile.com>

Printed in Korea
Code No.:GH68-23447A
English (TNZ). 03/2009. Rev. 1.0

Samsung C5220 user manual



using this manual

This user manual has been specially designed to guide you through the functions and features of your mobile phone. To get started quickly, refer to “introducing your mobile phone,” “assembling and preparing your mobile phone,” and “using basic functions.”

Instructional icons

Before you start, familiarise yourself with the icons you will see in this manual:



WARNING

Warning—situations that could cause injury to yourself or others



CAUTION

Caution—situations that could cause damage to your phone or other equipment



Note—notes, usage tips, or additional information



Refer to—pages with related information; for example: ► p. 12 (represents “see page 12”)

- **Followed by**—the order of options or menus you must select to perform a step; for example: In Menu mode, select **Messages** → **Create message** (represents **Messages**, followed by **Create message**)
- [] **Square brackets**—phone keys; for example: [] (represents the Power/Menu exit key)
- < > **Angled brackets**—softkeys that control different functions at each screen; for example: <OK> (represents the **OK** softkey)

Copyright information

Rights to all technologies and products that comprise this device are the property of their respective owners:

- Bluetooth® is a registered trademark of the Bluetooth SIG, Inc. worldwide—Bluetooth QD ID: B014825.
- Java™ is a trademark of Sun Microsystems, Inc.
- Windows Media Player® is a registered trademark of Microsoft Corporation.

contents

safety and usage information	2
Safety warnings	2
Safety precautions	4
Important usage information	7
introducing your mobile phone	10
Unpack	10
Phone layout	11
Keys	12
Display	13
Icons	13
assembling and preparing your mobile phone	15
Install the SIM or USIM card and battery ...	15
Charge the battery	17
Insert a memory card (optional)	18
using basic functions	19
Turn your phone on and off	19

Access menus	20	Activate the mobile tracker	38
Customise your phone	20	Record and play voice memos	39
Use basic call functions	21	Use Java-powered games and applications	39
Send and view messages	22	Use the RSS reader	40
Add and find contacts	24	Create and view world clocks	41
Use basic camera functions	25	Set and use alarms	42
Listen to music	26	Use the calculator	43
Browse the web	27	Convert currencies or measurements	43
Launch the Google search engine	28	Set a countdown timer	44
using advanced functions	29	Use the stopwatch	44
Use advanced call functions	29	Create a new task	44
Use advanced phonebook functions	31	Create a text memo	44
Use advanced messaging functions	32	Manage your calendar	45
Use advanced music functions	34		
using tools and applications	36	troubleshooting	a
Use the Bluetooth wireless feature	36		
Print images	37		

safety and usage information

Comply with the following precautions to avoid dangerous or illegal situations and ensure peak performance of your mobile phone.



Safety warnings

Keep your phone away from small children and pets

Keep your phone and all accessories out of the reach of small children or animals. Small parts may cause choking or serious injury if swallowed.

Protect your hearing



Listening to a headset at high volumes can damage your hearing. Use only the minimum volume setting necessary to hear your conversation or music.

Install mobile phones and equipment with caution

Ensure that any mobile phones or related equipment installed in your vehicle are securely mounted. Avoid placing your phone and accessories near or in an air bag deployment area. Improperly installed wireless equipment can cause serious injury when air bags inflate rapidly.

Handle and dispose of batteries and chargers with care

- Use only Samsung-approved batteries and chargers specifically designed for your phone. Incompatible batteries and chargers can cause serious injuries or damage to your phone.
- Never dispose of batteries or phones in a fire. Follow all local regulations when disposing used batteries or phones.

- Never place batteries or phones on or in heating devices, such as microwave ovens, stoves, or radiators. Batteries may explode when overheated.
- Never crush or puncture the battery. Avoid exposing the battery to high external pressure, which can lead to an internal short circuit and overheating.

Avoid interference with pacemakers

Maintain a minimum of 15 cm (6 inches) between mobile phones and pacemakers to avoid potential interference, as recommended by manufacturers and the independent research group, Wireless Technology Research. If you have any reason to suspect that your phone is interfering with a pacemaker or other medical device, turn off the phone immediately and contact the manufacturer of the pacemaker or medical device for guidance.

Turn off the phone in potentially explosive environments

Do not use your phone at refuelling points (service stations) or near fuels or chemicals. Turn off your phone whenever directed by warning signs or instructions. Your phone could cause explosions or fire in and around fuel or chemical storage and transfer areas or blasting areas. Do not store or carry flammable liquids, gases, or explosive materials in the same compartment as the phone, its parts, or accessories.

Reduce the risk of repetitive motion injuries

When sending text messages or playing games on your phone, hold the phone with a relaxed grip, press the keys lightly, use special features that reduce the number of keys you have to press (such as templates and predictive text), and take frequent breaks.



Safety precautions

Drive safely at all times

Avoid using your phone while driving and obey all regulations that restrict the use of mobile phones while driving. Use hands-free accessories to increase your safety when possible.

Follow all safety warnings and regulations

Comply with any regulations that restrict the use of a mobile phone in a certain area.

Use only Samsung-approved accessories

Using incompatible accessories may damage your phone or cause injury.

Turn off the phone near medical equipment

Your phone can interfere with medical equipment in hospitals or health care facilities. Follow all regulations, posted warnings, and directions from medical personnel.

Turn off the phone or disable the wireless functions when in an aircraft

Your phone can cause interference with aircraft equipment. Follow all airline regulations and turn off your phone or switch to a mode that disables the wireless functions when directed by airline personnel.

Protect batteries and chargers from damage

- Avoid exposing batteries to very cold or very hot temperatures (below 0° C/32° F or above 45° C/113° F). Extreme temperatures can reduce the charging capacity and life of your batteries.
- Prevent batteries from contacting metal objects, as this can create a connection between the + and - terminals of your batteries and lead to temporary or permanent battery damage.
- Never use a damaged charger or battery.

Handle your phone carefully and sensibly

- Do not allow your phone to get wet—liquids can cause serious damage. Do not handle your phone with wet hands. Water damage to your phone can void your manufacturer's warranty.

CAUTION

- Avoid using or storing your phone in dusty, dirty areas to prevent damage to moving parts.
- Your phone is a complex electronic device—protect it from impacts and rough handling to avoid serious damage.
- Do not paint your phone, as paint can clog moving parts and prevent proper operation.
- Avoid using the phone's camera flash or light close to the eyes of children or animals.
- Your phone and memory cards may be damaged by exposure to magnetic fields. Do not use carrying cases or accessories with magnetic closures or allow your phone to come in contact with magnetic fields for extended periods of time.

Avoid interference with other electronic devices

Your phone emits radio frequency (RF) signals that may interfere with unshielded or improperly shielded electronic equipment, such as pacemakers, hearing aids, medical devices, and other electronic devices in homes or vehicles. Consult the manufacturers of your electronic devices to solve any interference problems you experience.

CAUTION



Important usage information

Use your phone in the normal position

Avoid contact with your phone's internal antenna.

Allow only qualified personnel to service your phone

Allowing unqualified personnel to service your phone may result in damage to your phone and will void your warranty.

Ensure maximum battery and charger life

- Avoid charging batteries for more than a week, as overcharging may shorten battery life.
- Over time, unused batteries will discharge and must be recharged before use.

- Disconnect chargers from power sources when not in use.
- Use batteries only for their intended purpose.

Handle SIM cards and memory cards with care

- Do not remove a card while the phone is transferring or accessing information, as this could result in loss of data and/or damage to the card or phone.
- Protect cards from strong shocks, static electricity, and electrical noise from other devices.
- Frequent writing and erasing will shorten the life span of memory cards.
- Do not touch gold-coloured contacts or terminals with your fingers or metal objects. If dirty, wipe the card with a soft cloth.

Ensure access to emergency services

Emergency calls from your phone may not be possible in some areas or circumstances. Before travelling in remote or undeveloped areas, plan an alternate method of contacting emergency services personnel.

Specific Absorption Rate (SAR) certification information

Your phone conforms to European Union (EU) standards that limit human exposure to radio frequency (RF) energy emitted by radio and telecommunications equipment. These standards prevent the sale of mobile phones that exceed a maximum exposure level (known as the Specific Absorption Rate, or SAR) of 2.0 watts per kilogram of body tissue.

During testing, the maximum SAR recorded for this model was 0.856 watts per kilogram. In normal use, the actual SAR is likely to be much lower, as the phone has been designed to emit only the RF energy necessary to transmit a signal to the nearest base station. By automatically emitting lower levels when possible, your phone reduces your overall exposure to RF energy.

Correct disposal of this product

(Waste Electrical & Electronic Equipment)



(Applicable in the European Union and other European countries with separate collection systems)



This marking shown on the product or its literature, indicates that it should not be disposed with other household wastes at the end of its working life. To prevent possible harm to the environment or human health from uncontrolled waste disposal, please separate this from other types of wastes and recycle it responsibly to promote the sustainable reuse of material resources.

Household users should contact either the retailer where they purchased this product, or their local government office, for details of where and how they can take this item for environmentally safe recycling.

Business users should contact their supplier and check the terms and conditions of the purchase contract. This product should not be mixed with other commercial wastes for disposal.

introducing your mobile phone

In this section, learn about your mobile phone's layout, keys, display, and icons.

Unpack

Check your product box for the following items:

- Mobile phone
- Battery
- Travel adapter (charger)
- User manual



The items supplied with your phone may vary depending on the software and accessories available in your region or offered by your service provider.

You can obtain additional accessories from your local Samsung dealer.

Phone layout





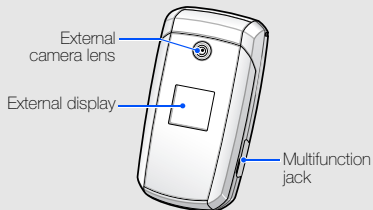

The inside of your phone includes the following keys and features:







The outside of your phone includes the following keys and features:



Keys

Key	Function
 Softkeys	Perform actions indicated at the bottom of the display
 4-way navigation	In Idle mode, access user-defined menus (left/right/up/down); In Menu mode, scroll through menu options
 Confirm	In Idle mode, access Menu mode; In Menu mode, select the highlighted menu option or confirm an input
 Application switch	Open the application switch window to access other applications without exiting the current application
 Video call	From the dialling screen, make a video call
 Dial	Make or answer a call; In Idle mode, retrieve recently dialled, missed, or received numbers

Key	Function
 Delete	Delete characters or items in an applications
 Power/ Menu exit	Turn the phone on and off (press and hold); End a call; In Menu mode, cancel input and return to Idle mode
 Alpha- numeric	Enter numbers, letters and special characters; In Idle mode, press and hold [1] to access voice mails and [0] to enter an international call prefix
 Special function	Enter special characters or perform special functions; In Idle mode, press and hold [#] for the silent profile; In Idle mode, press and hold [*] to enter a pause between numbers
 Volume	Adjust the phone's volume

Display

Your phone's display consists of three areas:

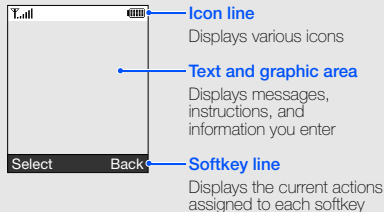









Icons

Learn about the icons that appear on your display.

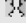
Icon	Definition
	Signal strength
	GPRS network connected
	Transferring data via GPRS network
	EDGE network connected
	Transferring data via EDGE network
	UMTS network connected
	Transferring data via UMTS network
	Call in progress
	Video call in progress
	Browsing the web

Icon	Definition
	Connecting to secured web page
	Roaming (outside of normal service area)
	New text message (SMS)
	New multimedia message (MMS)
	New email message
	New voice mail message
	New push message
	New configuration message
	Synchronised with PC
	Alarm activated
	Bluetooth hands-free car kit or headset connected

Icon	Definition
	Bluetooth activated
	Memory card inserted
	Normal profile activated
	Silent profile activated
	Driving profile activated
	Meeting profile activated
	Outdoor profile activated
	Offline profile activated
	Battery power level

assembling and preparing your mobile phone

Get started by assembling and setting up
your mobile phone for its first use.

Install the SIM or USIM card and battery

When you subscribe to a cellular service, you will receive a Subscriber Identity Module, or SIM card, with subscription details, such as your personal identification number (PIN) and optional services.

To use UMTS services, you can purchase a Universal Subscriber Identity Module (USIM) card.

To install the SIM or USIM card and battery,

1. Remove the battery cover.

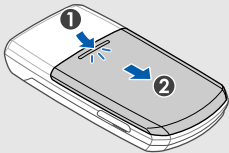

If the phone is on, press and hold [📞] to turn it off.

2. Insert the SIM or USIM card.

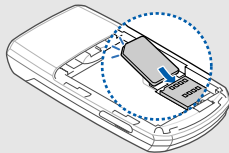

Place the SIM or USIM card in the phone with the gold-coloured contacts facing down.

3. Insert the battery.

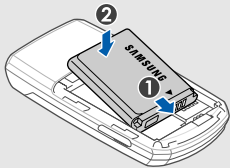

4. Replace the battery cover.

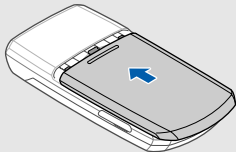

Charge the battery

Before using the phone for the first time, you must charge the battery.

1. Open the cover to the multifunction jack on the side of the phone.
2. Plug the small end of the travel adapter into the multifunction jack.

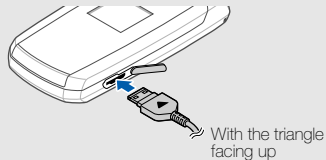

Improperly connecting the travel adapter can cause serious damage to the phone. Any damages by misuse are not covered by the warranty.

3. Plug the large end of the travel adapter into a power outlet.
4. When the battery is fully charged (the  icon is no longer moving), unplug the travel adapter from the power outlet.
5. Unplug the travel adapter from the phone.
6. Close the cover to the multifunction jack.



About the low battery indicator

When your battery is low, the phone will emit a warning tone and a low battery message. The battery icon will also be empty and blinking. If the battery level becomes too low, the phone will automatically power off. Recharge your battery to continue using your phone.

Insert a memory card (optional)

To store additional multimedia files, you must insert a memory card. Your phone accepts microSD™ memory cards up to 8 GB (depending on memory card manufacturer and type).

1. Open the cover to the memory card slot on the side of the phone.
2. Insert a memory card with the label side facing up.

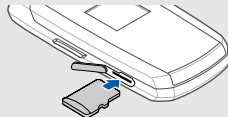

3. Push the memory card in the memory card slot until it locks in place.

To remove the memory card, push it gently until it disengages from the phone, and then pull the memory card out of the memory card slot.

using basic functions

Learn how to perform basic operations and use the main features of your mobile phone.

Turn your phone on and off

To turn your phone on,

1. Open the phone.
2. Press and hold [.
3. Enter your PIN and press <**Confirm**> (if necessary).

To turn your phone off, repeat steps 1 and 2 above.

Switch to the offline profile

By switching to the offline profile, you can use your phone's non-network services in areas where wireless devices are prohibited, such as aeroplane and hospitals.

To switch to the offline profile, in Menu mode, select **Settings** → **Phone profiles** → **Offline**.



Follow all posted warnings and directions from official personnel when in areas where wireless devices are prohibited.

Access menus

To access your phone's menus,

1. In Idle mode, press [OK] to access Menu mode.
2. Use the navigation key to scroll to a menu or option.
3. Press [OK], <Select>, or <OK> to confirm the highlighted option.
4. Press <Back> to move up one level; Press [] to return to Idle mode.

Customise your phone

Get more from your phone by customising it to match your preferences.

Adjust the volume of the key tones

In Idle mode, press [▲/▼] to adjust the key tone volume.

Switch to or from the silent profile

In Idle mode, press and hold [#] to silence or unsilence your phone.

Change your ringtone

1. In Menu mode, select **Settings** → **Phone profiles**.
2. Scroll to the profile you are using.
3. Press <Options> → **Edit** → **Voice call ringtone** or **Video call ringtone**.

4. Select a Sounds category → a ringtone.
 5. Press <Options> → **Save**.
- To switch to another profile, select it from the list.

Select a wallpaper (Idle mode)

1. In Menu mode, select **Settings** → **Display settings** → **Main display** → **Wallpaper** → **Pictures**.
2. Select an image category → an image.
3. Press <Set>.

Set menu shortcuts

1. In Menu mode, select **Settings** → **Phone settings** → **Shortcuts**.
2. Select a key to use as a shortcut.
3. Select a menu to assign to the shortcut key.

Lock your phone

1. In Menu mode, select **Settings** → **Security** → **Phone lock** → **On**.
2. Enter a new 4- to 8-digit password and press <Confirm>.
3. Enter the new password again and press <Confirm>.



Use basic call functions

Learn to make or answer calls and use basic call functions.

Make a call

1. In Idle mode, enter an area code and a phone number.
2. Press [>] to dial the number
3. To end the call, press [>].

Answer a call

1. When a call comes in, press [.
2. To end the call, press [.

Adjust the volume

To adjust the volume during a call, press [/.

Use the speakerphone feature

1. During a call, press [OK] → <Yes> to activate the speaker.
2. To switch back to the earpiece, press [OK] again.

Use the headset

By plugging the supplied headset into the multifunction jack, you can make and answer calls:

- To redial the last call, press and hold the headset button and then press and hold again.
- To answer a call, press and hold the headset button.
- To end a call, press and hold the headset button.

Send and view messages

Learn to send or view text (SMS), multimedia (MMS), or email messages.

Send a text or multimedia message

1. In Menu mode, select **Messages** → **Create message** → **Message**.

2. Enter your message text. ► Enter text
For sending as a text message, skip to step 4.
For attaching multimedia, continue with step 3.
3. Press <Options> → **Add item** and add an item.
4. Scroll up enter a destination number or an email address.
5. Press [OK] → **Send** to send the message.

Send an email

1. In Menu mode, select **Messages** → **Create message** → **Email**.
2. Enter your email text.
3. Press <Options> → **Add attachment** and attach a file (if necessary).
4. Scroll up and enter a subject.

5. Scroll up and enter an email address.
6. Press [OK] → **Send** to send the message.

Enter text

When entering text, you can change the text input mode:

- Press and hold [*] to switch between T9 and ABC modes.
- Press [*] to change case or switch to Number mode.
- Press and hold [#] to switch to Symbol mode.

Enter text in one of the following modes:

Mode	Function
ABC	Press the appropriate alphanumeric key until the character you want appears on the display.

Mode	Function
T9	<ol style="list-style-type: none"> 1. Press the appropriate alphanumeric keys to enter an entire word. 2. When the word displays correctly, press [#] to insert a space. If the correct word does not display, press [0] to select an alternate word.
Number	Press the appropriate alphanumeric key to enter a number.
Symbol	Press the appropriate alphanumeric key to select a symbol.

View text or multimedia messages

1. In Menu mode, select **Messages** → **Inbox**.
2. Select a text or multimedia message.

View an email

1. In Menu mode, select **Messages** → **Email inbox**.
2. Press <**Options**> → **Download**.
3. Select an email or a header.
4. If you selected a header, press <**Options**> → **Retrieve** to view the body of the email.

Add and find contacts

Learn the basics of using the phonebook feature.

Add a new contact

1. In Idle mode, enter a phone number and press <**Options**>.
2. Select **Add to Phonebook** → a memory location (phone or SIM) → **New**.

3. Select a number type (if necessary).
4. Enter contact information.
5. Press <**Options**> → **Save** to add the contact to memory.

Find a contact

1. In Menu mode, select **Phonebook**.
2. Enter the first few letters of the name you want to find.
3. Select the contact's name from the search list.



Once you have found a contact, you can:

- call the contact by pressing [- edit the contact information by pressing [OK] → <**Options**> → **Edit**

Use basic camera functions

Learn the basics to capture and view photos and videos.

Capture photos

1. In Menu mode, select **Camera** to turn on the camera.
2. Aim the lens at the subject and make any adjustments.
3. Press [OK] to take a photo.
The photo is saved automatically.
4. Press <

View photos

In Menu mode, select **My files** → **Images** → **My photos** → a photo file.

Capture videos

1. In Menu mode, select **Camera** to turn on the camera.
2. Press [**1**] to switch to Recording mode.
3. Aim the lens at the subject and make any adjustments.
4. Press [**OK**] to start recording.
5. Press [**OK**] to stop recording.
The video is saved automatically.
6. Press <**Back**> to record another video (step 3).

View videos

In Menu mode, select **My files** → **Videos** → **My video clips** → a video file.

Listen to music

Learn how to listen to music via the music player.

Listen to music files

Start by transferring files to your phone or memory card:

- Download from the wireless web. ► p. 27
- Download from a PC with the optional Samsung PC Studio. ► p. 34
- Receive via Bluetooth. ► p. 37
- Synchronise with Windows Media Player 11.
► p. 34

After transferring music files to your phone or memory card,

1. In Menu mode, select **Music player**.
2. Select a music category → a music file.
3. Control playback using the following keys:

Key	Function
OK	Pause or resume playback
▲/▼	Adjust the volume up or down
Navigation	<ul style="list-style-type: none">• Left: Restart playback; Skip backward (press within 3 seconds); Scan backward in a file (press and hold)• Right: Skip forward; Scan forward in a file (press and hold)• Up: Open the playlist• Down: Stop playback

Browse the web

Learn to access and bookmark your favourite web pages.

Browse web pages

1. In Menu mode, select **TWorld** → **Go to homepage** to launch your service provider's homepage.
2. Navigate web pages using the following keys:

Key	Function
Navigation	Scroll up or down on a web page
OK	Select an item
<Back>	Return to the previous page
<Options>	Access a list of browser options

Bookmark your favourite web pages

1. In Menu mode, select **TWorld** → **Bookmarks**.
2. Press <**Options**> → **Add bookmark**.
3. Enter a page title and a web address (URL).
4. Press <**Save**>.

Launch the Google search engine

Learn to access the homepage of Google search.

1. In Menu mode, select **Google** → **Search** to launch your service provider's homepage.
2. Navigate web pages using the following keys:

Key	Function
Navigation	Scroll up or down on a web page
Confirm	Select an item
< Back >	Return to the previous page
< Options >	Access a list of browser options

using advanced functions

Learn how to perform advanced operations and use additional features of your mobile phone.

Use advanced call functions



Learn about your phone's additional calling capabilities.

View and dial missed calls

Your phone will display calls you have missed on the display. To dial the number of a missed call,

1. Press <**View**>.
2. Scroll to the missed call you want to dial.
3. Press [] to dial.

Call a recently dialled number



1. In Idle mode, press [] to display a list of recent numbers.
2. Scroll to the number you want and press [] to dial.

Hold a call or retrieve a held call

Press <**Hold**> to place a call on hold or press <**Retrieve**> to retrieve a held call.

Dial a second call

If your network supports this function, you can dial another number during a call:

1. Press <**Hold**> to place the first call on hold.
2. Enter the second number to dial and press [].
3. Press <**Swap**> to switch between the two calls.
4. To end the call on hold, press <**Options**> → **End** → **Held call**.
5. To end the current call, press [.

Answer a second call

If your network supports this function, you can answer a second incoming call:

1. Press [] to answer the second call.
The first call is automatically placed on hold.
2. Press <**Swap**> to switch between the calls.

Make a multiparty call (conference call)

1. Call the first party you want to add to the multiparty call.
2. While connected to the first party, call the second party.
The first party is automatically placed on hold.
3. When connected to the second party, press <**Options**> → **Join**.

4. Repeat steps 2 and 3 to add more parties (if necessary).
5. To end the multiparty call, press [].

Call an international number

1. In Idle mode, press and hold [0] to insert the + character.
2. Enter the complete number you want to dial (country code, area code, and phone number), and then press [] to dial.

Call a contact from the phonebook

You can call numbers directly from the phonebook using stored contacts. ► p. 24

1. In Menu mode, select **Phonebook**.
2. Scroll to the number you want to dial and press [] to dial.

Use advanced phonebook functions

Learn to create namecards, set speed dial numbers, and create groups of contacts.

Create a namecard

1. In Menu mode, select **Phonebook**.
2. Press <Options> → **My contact details**.
3. Enter your personal details and press <Options> → **Save**.



You can send your namecard by attaching it to a message or email or transferring it via the Bluetooth wireless feature.

Set speed dial numbers

1. In Menu mode, select **Phonebook**.
2. Scroll to a contact to assign to the number.
3. Press <Options> → **Assign speed dial**.

4. Scroll to a number you want to set (2-9) and press **[OK]**.

The contact is saved to the speed dial number.



You can now call this contact from Idle mode by pressing and holding the assigned speed dial number.

Create a group of contacts

By creating groups of contacts, you can assign ringtones and caller ID photos to each group or send messages to an entire group. Start by creating a group:

1. In Menu mode, select **Phonebook**.
2. Scroll left or right to **Groups**.
3. Press **<Options>** → **Create group**.
4. Enter a group name and press **<Save>**.

5. To set the caller ID image, scroll to the group and press **<Options>** → **Group settings** → **Picture**.
6. Scroll left or right to a memory location (if necessary).
7. Select an image category → an image.
8. To set a group ringtone, scroll down and press **[OK]** → a ringtone category → a ringtone.
9. Press **<Options>** → **Save**.

Use advanced messaging functions

Learn to create templates, use templates to create new messages, and use the messenger.

Create a text template

1. In Menu mode, select **Messages** → **Templates** → **Text templates**.

2. Press <**Add new**> to open a new template window.
3. Enter your text and press [**OK**] to save the template.

Create a multimedia template

1. In Menu mode, select **Messages** → **Templates** → **Multimedia templates**.
2. Press <**Add new**> to open a new template window.
3. Create a multimedia message, with a subject and desired attachments, to use as your template. ► p. 22
4. Press <**Options**> → **Save as template** to save the template.

Insert text templates in new messages

1. To start a new message, in Menu mode, select **Messages** → **Create message** → a message type.
2. In the text field, press <**Options**> → **Insert** → **Text template** → a template.

Create a message from a multimedia template

1. In Menu mode, select **Messages** → **Templates** → **Multimedia templates**.
2. Scroll to the template you want and press <**Options**> → **Send**.
Your template opens as a new multimedia message.

Use advanced music functions

Learn to prepare music files and create playlists.

Copy music files via Samsung PC Studio

1. In Menu mode, select **Settings** → **Phone settings** → **USB settings** → **Samsung PC studio**.
2. Press [>] to return to Idle mode.
3. Using an optional PC data cable, connect the multifunction jack on your phone to a PC.
4. Run Samsung PC Studio and copy files from the PC to the phone.
Refer to the Samsung PC Studio help for more information.

Synchronise your phone with Windows Media Player

1. In Menu mode, select **Settings** → **Phone settings** → **USB settings** → **Media player**.
2. Press [>] to return to Idle mode.
3. Using an optional PC data cable, connect the multifunction jack on your phone to a PC with Windows Media Player installed.
When connected, a pop-up window will appear on the PC.
4. Select **Sync digital media files to this device** in the pop-up window on the PC.
5. Edit or enter your phone's name in the pop-up window (if necessary), and then click **Finish**.
6. Select and drag the music files you want to the sync list.
7. Click **Start Sync**.

Create a playlist

1. In Menu mode, select **Music player** → **Playlists**.
2. Press <**Options**> → **Create playlist**.
3. Enter a title for your new playlist and press <**Save**>.
4. Select the new playlist.
5. Press <**Options**> → **Add** → **Files**.
6. Select the files you want to include and press <**OK**>.

Customise your music player settings

1. In Menu mode, select **Music player**.
2. Press <**Options**> → **Player settings**.
3. Adjust the settings to customise your music player.
4. Press <**Save**>.

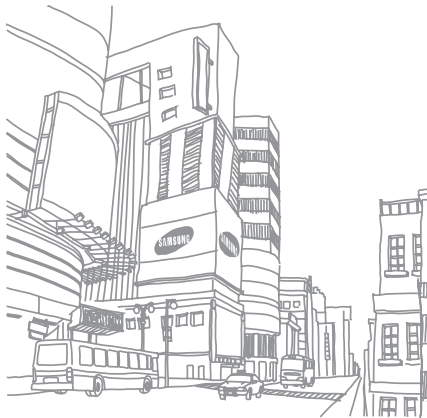

using tools and applications

Learn how to work with your mobile phone's tools and additional applications.

Use the Bluetooth wireless feature

Learn about your phone's ability to connect to other wireless devices for exchanging data and using hands-free features.

Turn on the Bluetooth wireless feature

1. In Menu mode, select **Settings** → **Network settings** → **Bluetooth** → **Activation** → **On**.
2. To allow other devices to locate your phone, select **My phone's visibility** → **On**.

Find and pair with other Bluetooth-enabled devices

1. In Menu mode, select **Settings** → **Network settings** → **Bluetooth** → **My devices** → **Search new device**.
2. Scroll to a device and press <**Select**>.

3. Enter a PIN for the Bluetooth wireless feature or the other device's Bluetooth PIN, if it has one, and press <OK>.

When the owner of the other device enters the same code or accepts the connection, pairing is complete.

Send data using the Bluetooth wireless feature

1. Select the file or item from one of your phone's applications that you want to send.
2. Press <Options> → **Send via**, **Send contact detail via**, or **Send URL** → **Bluetooth** or **Via bluetooth** (when sending contact data, specify which data to send).

Receive data using the Bluetooth wireless feature

1. Enter the PIN for the Bluetooth wireless feature and press <OK> (if necessary).
2. Press <Yes> to confirm that you are willing to receive data from the device (if necessary).

Print images

Learn to print your image with an optional PC data cable or the Bluetooth wireless feature.

To print an image using an optional PC data cable,

1. Connect the multifunction jack on your phone to a compatible printer.
2. Open an image. ► p. 25
3. Press <Options> → **Print via** → **USB**.
4. Set print options and press <Print>.

To print an image using the Bluetooth wireless feature,

1. Open an image. ► p. 25
2. Press <Options> → **Print via** → **Bluetooth**.
3. Select a Bluetooth-enabled printer and pair with the printer. ► p. 36
4. Set print options and press <Print>.

Activate the mobile tracker

When someone inserts a new SIM or USIM card in your phone, the mobile tracker feature will automatically send the contact number to two recipients to help you locate and recover your phone.

To activate the mobile tracker,

1. In Menu mode, select **Settings** → **Security** → **Mobile tracker**.
2. Enter your password and press <Confirm>.
3. Scroll left or right to **On**.
4. Scroll down and press [OK] to open the recipient list.
5. Press <Options> → **Phonebook** to open your contact list.
6. Scroll to a contact and press [OK].
7. Select a number to return to the recipient list.
8. Press [OK] to save the recipients.
9. Scroll down and enter the sender's name.
10. Press <Options> → **Save** → <Accept>.

Record and play voice memos

Learn to operate your phone's voice recorder.

Record a voice memo

1. In Menu mode, select **Applications** → **Voice recorder**.
2. Press [OK] to start recording.
3. Speak your memo into the microphone.
4. When you are finished speaking, press the navigation key down.

Play a voice memo

1. From the voice recorder screen, press <Options> → **My voice clips**.
2. Select a file.

3. Control the playback using the following keys:

Key	Function
OK	Pause or resume playback
▲ / ▼	Adjust the volume up or down
Navigation	<ul style="list-style-type: none">• Left: Scan backward in a file• Right: Scan forward in a file• Down: Stop playback

Use Java-powered games and applications

Learn to use games and applications powered by award-winning Java technology.

Play games

1. In Menu mode, select **My files** → **Games and more**.

2. Select a game from the list and follow the on-screen instructions.



Available games may vary, depending on your region or service provider. Game controls and options may vary.

Launch applications

1. In Menu mode, select **My files** → **Games and more** → an application.
2. Press <Options> to access a list of various options and settings for your application.

Use the RSS reader

Learn to use the RSS reader to get the latest news and information from your favourite websites.

Create feeds

1. In Menu mode, select **Applications** → **RSS reader**.
2. Press <Options> → **Add new**.
3. Enter the address of an RSS feed and press <OK>.
4. To add more feeds, repeat steps 2-3 above.

Read RSS feeds

1. In Menu mode, select **Applications** → **RSS reader**.
2. Press <Options> → **Update** → **Selected** or **All** to get the latest contents.
3. Select a feed → an updated post.

Customise RSS reader settings

1. In Menu mode, select **Applications** → **RSS reader**.
2. Press <**Options**> → **Settings**.
3. Customise the settings as desired.
4. Press [**OK**].

Create and view world clocks

Learn to view the time in another city and set world clocks to appear on your display.

Create a world clock

1. In Menu mode, select **Applications** → **World clock**.
2. Press <**Options**> → **Add**.
3. Scroll left or right to a time zone.
4. To set daylight saving time, scroll down and press [**OK**].
5. Press <**OK**> to create your world clock.
The world clock is set as the second clock.
6. To add more world clocks, repeat steps 2-5 above.

Add a world clock to your display

In Dual Clock Display mode, you can view clocks with two different time zones on your display.

After you have created world clocks,

1. In Menu mode, select **Applications** → **World clock**.
2. Scroll to the world clock you want to add and press <**Options**> → **Set as second clock**.
3. Press <**Options**> → **Display settings**.
4. Scroll left or right to **Dual**.
5. Scroll down, and then scroll left or right to select a dual clock style.
6. Press <**Save**>.

Set and use alarms

Learn to set and control alarms for important events.

Set a new alarm

1. In Menu mode, select **Alarms**.
2. Scroll to an empty alarm location and press [OK].
3. Set alarm details.
4. Press <**Options**> → **Save**.



The auto power-up feature sets the phone to automatically turn on and sound the alarm at the designated time if the phone is turned off.

Stop an alarm

When the alarm sounds,

- Press <OK> or [OK] to stop an alarm without snooze.
- Press <OK> or [OK] to stop an alarm with snooze, or press <Snooze> or any key to silence the alarm for the snooze period.

Deactivate an alarm

1. In Menu mode, select **Alarms**.
2. Scroll to the alarm you want to deactivate and press [OK].
3. Scroll down (if necessary).
4. Scroll left or right to **Off**.
5. Press [OK].

Use the calculator

1. In Menu mode, select **Applications** → **Calculator**.
2. Use the keys that correspond to the calculator display to perform basic mathematical operations.

Convert currencies or measurements

1. In Menu mode, select **Applications** → **Converter** → a conversion type.
2. Enter the currencies or measurements and units in the appropriate fields.

Set a countdown timer

1. In Menu mode, select **Applications** → **Timer**.
2. Press <**Set**>.
3. Enter the length of time to count down and press <**OK**>.
4. Press [**OK**] to begin or pause the countdown.
5. When the timer expires, press <**OK**> to stop the alert.

Use the stopwatch

1. In Menu mode, select **Applications** → **Stopwatch**.
2. Press [**OK**] to begin and record lap times.
3. Press <**Reset**> to clear recorded times.

Create a new task

1. In Menu mode, select **Applications** → **Task**.
2. Press <**Options**> → **Create**.
3. Enter the details of the task.
4. Press <**Options**> → **Save**.

Create a text memo

1. In Menu mode, select **Applications** → **Memo**.
2. Press <**Options**> → **Create**.
3. Enter your memo text.
4. Press [**OK**].

Manage your calendar

Learn to change the calendar view and create events.

Change the calendar view

1. In Menu mode, select **Calendar**.
2. Press <Options> → **View by** → **Day** or **Week**.

Create an event

1. In Menu mode, select **Calendar**.
2. Press <Options> → **Create** → an event type.
3. Enter the details of the event as required.
4. Press <Options> → **Save**.

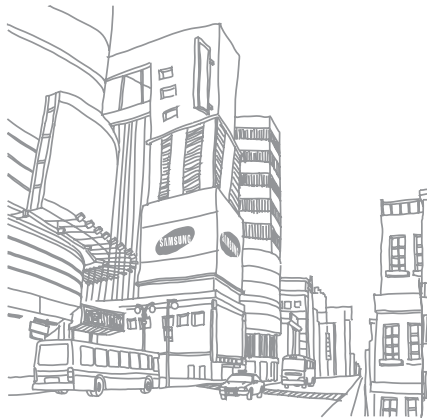

troubleshooting

If you are having trouble with your mobile phone, try these troubleshooting procedures before contacting a service professional.

When you turn on your phone, the following messages may appear:

Message	Try this to solve the problem:
Please insert SIM card	Ensure that the SIM or USIM card is installed correctly.
Phone lock	When the phone lock feature is enabled, you must enter the password you set for the phone.

Message	Try this to solve the problem:
PIN lock	When using the phone for the first time or when the PIN requirement is enabled, you must enter the PIN supplied with the SIM or USIM card. You can disable this feature by using the PIN lock menu.
PUK lock	Your SIM card is blocked, usually as a result of entering your PIN incorrectly several times. You must enter the PUK supplied by your service provider.

Your phone displays “Service unavailable” or “Network error.”

- When you are in areas with weak signals or poor reception, you may lose reception. Move to another area and try again.
- You cannot access some options without a subscription. Contact your service provider for more details.

You enter a number, but the call is not dialed.

- Ensure that you have pressed the Dial key: [📞].
- Ensure that you have accessed the right cellular network.
- Ensure that you have not set call barring for the phone number.

Another caller cannot reach you.

- Ensure that your phone is turned on.
- Ensure that you have accessed the right cellular network.
- Ensure that you have not set call barring for the phone number.

Another caller cannot hear you speaking.

- Ensure that you are not covering the built-in microphone.
- Ensure that the microphone is close to your mouth.
- If using a headset, ensure that it is properly connected.

The phone beeps and the battery icon flashes.

Your battery is low. Recharge or replace the battery to continue using the phone.

The audio quality of the call is poor.

- Ensure that you are not blocking the phone's internal antenna.
- When you are in areas with weak signals or poor reception, you may lose reception. Move to another area and try again.

You select a contact to call, but the call is not dialed.

- Ensure that the correct number is stored in the contact list.
- Re-enter and save the number, if necessary.

The battery does not charge properly or sometimes the phone turns itself off.

- The battery terminals may be dirty. Wipe both gold-coloured contacts with a clean, soft cloth and try charging the battery again.
- If the battery will no longer charge completely, dispose of the old battery properly and replace it with a new battery.

Your phone is hot to the touch.

When you use several applications at once, your phone requires more power and may heat up.

This is normal and should not affect your phone's lifespan or performance.

Declaration of Conformity (R&TTE)

We, **Samsung Electronics**

declare under our sole responsibility that the product

GSM Mobile Phone : C5220

to which this declaration relates, is in conformity with the following standards and/or other normative documents.

SAFETY	EN 60950- 1 : 2001+A11:2004
EMC	EN 301 489- 01 V1.6.1 (09-2005)
	EN 301 489- 07 V1.3.1 (11-2005)
	EN 301 489- 17 V1.2.1 (08-2002)
	EN 301 489- 24 V1.3.1 (11-2005)
SAR	EN 50360 : 2001
	EN 62209-1 : 2006
RADIO	EN 301 511 V9.0.2 (03-2003)
	EN 300 328 V1.7.1 (10-2006)
	EN 301 908- 1 V2.2.1 (10-2003)
	EN 301 908- 2 V3.2.1 (05-2007)

We hereby declare that [all essential radio test suites have been carried out and that] the above named product is in conformity to all the essential requirements of Directive 1999/5/EC.

The conformity assessment procedure referred to in Article 10 and detailed in Annex[IV] of Directive 1999/5/EC has been followed with the involvement of the following Notified Body(ies):

BABT, Balfour House, Churchfield Road,
Walton-on-Thames, Surrey, KT12 2TD, UK*
Identification mark: 0168

CE 0168

The technical documentation kept at :

Samsung Electronics QA Lab.

which will be made available upon request.
(Representative in the EU)

Samsung Electronics Euro QA Lab.
Blackbushe Business Park, Saxony Way,
Yateley, Hampshire, GU46 6GG, UK*
2009.01.28

Yong-Sang Park / S. Manager

(place and date of issue)

(name and signature of authorised person)

* It is not the address of Samsung Service Centre. For the address or the phone number of Samsung Service Centre, see the warranty card or contact the retailer where you purchased your phone.