

Nokia C5-04 User Guide

Contents**Safety**

Battery removing 4

Find help

In-device help 5

Accessibility solutions 5

Extended user guide 5

Support 5

Software updates over the air 6

Update device software using your PC 6

Access codes 7

Get started

Insert the SIM card and battery 7

Insert the memory card 9

Remove the memory card 11

Charge the battery 11

Keys and parts 12

Switch the device on 13

Lock the keys and touch screen 13

Home screen 14

Access the menu 15

Touch screen actions 15

Change the ringing tone 16

Ovi by Nokia 16

About Ovi Store 16

Your device

Contacts bar 17

Antenna locations 17

Offline profile 17

Shortcuts 18

Sensor settings and display rotation 18

Headset 19

Attach a wrist strap 19

Make calls

Calls 19

Write text

20

Virtual keyboard 20

Handwriting 21

Enter text with the virtual keypad 21

Touch input settings 23

Contacts

23

Save phone numbers and mail addresses 24

Manage names and numbers 24

Assign default numbers and addresses 24

Ringing tones, images, and call text for contacts 25

Copy contacts 25

SIM services 26

Messaging

27

Messaging main view 27

Write and send messages 27

Set up your e-mail 28

E-mail service 29

Mail for Exchange 29

About Ovi Contacts 30

Connect to the service 30

Start using Ovi Contacts 30

Music player

31

Play music 31

Create a playlist 32

Camera

33

Activate the camera 33

Image capture 33

Video recording 34

Gallery

34

View and organize files 34

View images and videos 35

Share online

35

About Share online 35

Subscribe to an online sharing service 36

Manage your accounts 36

Create a post 36

Post files from Gallery	37	Product and safety information	54
Nokia Video Center	37		
View and download video clips	37		
Video feeds	38		
My videos	39		
Transfer videos from your PC	39		
Video center settings	39		
Web browser	40		
Browse the web	40		
Add a bookmark	40		
Positioning (GPS)	41		
About GPS	41		
About assisted GPS (A-GPS)	41		
Hold your device correctly	41		
Maps	42		
Maps overview	42		
View your location and the map	42		
Map view	43		
Change the look of the map	44		
Download and update maps	44		
About positioning methods	45		
Find a location	45		
View location details	46		
Save or view a place or route	46		
Send a place to a friend	47		
Check in	47		
Synchronize your Favorites	48		
Get voice guidance	49		
Drive to your destination	49		
Navigation view	50		
Get traffic and safety information	50		
Walk to your destination	51		
Plan a route	52		
Connectivity	53		
Protect the environment	53		
Save energy	53		
Recycle	53		

Safety

Read these simple guidelines. Not following them may be dangerous or illegal. Read the complete user guide for further information.

SWITCH OFF IN RESTRICTED AREAS



Switch the device off when cellular phone use is not allowed or when it may cause interference or danger, for example, in aircraft, near medical equipment, fuel, chemicals, or blasting areas.

ROAD SAFETY COMES FIRST



Obeys all local laws. Always keep your hands free to operate the vehicle while driving. Your first consideration while driving should be road safety.

INTERFERENCE



All wireless devices may be susceptible to interference, which could affect performance.

QUALIFIED SERVICE



Only qualified personnel may install or repair this product.

KEEP YOUR DEVICE DRY



Your device is not water-resistant. Keep it dry.

PROTECT YOUR HEARING



Listen to a headset at a moderate level, and do not hold the device near your ear when the loudspeaker is in use.

Battery removing

Switch the device off and disconnect the charger before removing the battery.

Find help

For local services and warranty information, see the separate booklet.

In-device help



Your device contains instructions to help to use the applications in your device.

To open help texts from the main menu, select **Menu > Applications > Help** and the application for which you want to read instructions.

When an application is open, to access the help text for the current view, select **Options > Help**.

When you are reading the instructions, to change the size of the help text, select **Options > Decrease font size** or **Increase font size**.

You may find links to related topics at the end of the help text.

If you select an underlined word, a short explanation is displayed.

Help texts use the following indicators:



Link to a related help topic.



Link to the application being discussed.

When you are reading the instructions, to switch between help texts and the application that is open in the background, select **Options > Show open apps.** and the desired application.

Accessibility solutions

Nokia is committed to making mobile phones easy to use for all individuals, including those with disabilities. For more information, visit the Nokia website at www.nokiaaccessibility.com.

Extended user guide

An extended version of this user guide is available on the product support pages of the Nokia website. Some applications or functions are explained only in the extended user guide.

Support

When you want to learn more about how to use your product or you are unsure how your device should function, go to www.nokia.com/support, or using a cellular phone, www.nokia.mobi/support. You can also select **Menu > Applications > Help** in your device.

If this does not resolve your issue, do one of the following:

- Reboot your device. Switch off the device, and remove the battery. After about a minute, replace the battery, and switch on the device.
- Restore the original factory settings.
- Update your device software.

If your issue remains unsolved, contact Nokia for repair options. Go to www.nokia.com/repair, or in Latin America, www.nokia-latinoamerica.com/centrosdeservicio. Before sending your device for repair, always back up the data in your device.

Software updates over the air

Select **Menu > Applications > Tools > SW update**.

With Software update (network service), you can check if there are updates available for your device software or applications, and download them to your device.

After updating your device software or applications using Software update, the instructions related to the updated applications in the user guide or the helps may no longer be up to date.

To download the available updates, select . To unmark specific updates that you do not want to download, select the updates from the list.

To view information on an update, select the update and .

To view the status of previous updates, select .

Select **Options** and from the following:

Update via PC — Update your device using a PC. This option replaces the Start update option when updates are only available using the Nokia Software Updater PC application.

View update history — View the status of previous updates.

Settings — Modify the settings, such as the default access point used for downloading updates.

Disclaimer — View the Nokia license agreement.

Update device software using your PC

You can use the Nokia Ovi Suite PC application to update your device software. You need a compatible PC, a high-speed internet connection, and a compatible USB data cable to connect your device to the PC.

To get more information and to download the Nokia Ovi Suite application, go to www.ovi.com/suite.

Access codes

PIN code — Protect your device and SIM card against unauthorized use. The PIN code (4 - 8 digits) is usually supplied with the SIM card.

PIN2 code — This code (4 - 8 digits) is supplied with some SIM cards, and is required to access some functions in your device.

If you forget an access code, contact the network service provider whose SIM card is in your device. After three consecutive incorrect PIN or PIN2 code entries, the code is blocked, and you need the PUK or PUK2 code to unblock it.

PUK code and PUK2 code — These codes (8 digits) are required to change a blocked PIN code or PIN2 code, respectively. If the codes are not supplied with the SIM card, contact the network service provider whose SIM card is in your device.

IMEI number — This number (15 digits) is used to identify valid devices in the GSM network. Devices that are, for example, stolen, can be blocked from accessing the network. The IMEI number for your device can be found under the battery.

Lock code (also known as security code) — The lock code helps you to protect your device against unauthorized use. You can create and change the code, and set the device to request the code. Keep the new code secret and in a safe place separate from your device. If you forget the code and your device is locked, your device will require service and additional charges may apply. Additional charges may apply, and all the personal data in your device may be deleted. For more information, contact a Nokia Care Point or your device dealer.

Get started

Insert the SIM card and battery

Safe removal. Always switch the device off and disconnect the charger before removing the battery.



Important: Do not use a mini-UICC SIM card, also known as a micro-SIM card, a micro-SIM card with an adapter, or a SIM card that has a mini-UICC cutout (see figure) in this device. A micro-SIM card is smaller than the standard SIM card. This device does not support the use of micro-SIM cards and use of incompatible SIM cards may damage the card or the device, and may corrupt data stored on the card.



A SIM card may be already inserted in the device. If not, do the following:

- 1 Remove the back cover.

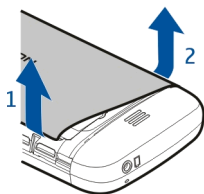

- 2 Remove the battery, if inserted.

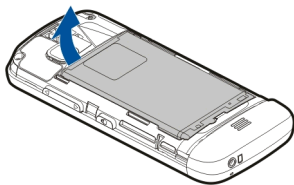

- 3 Slide the SIM card holder, to unlock it.

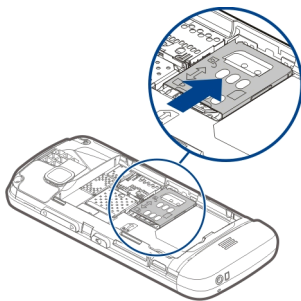

- 4 Lift the SIM card holder up.

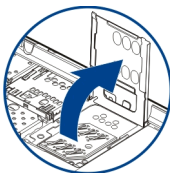

- 5 Make sure the contact area of the SIM card is facing toward the device, and slide the SIM card into the SIM card holder.

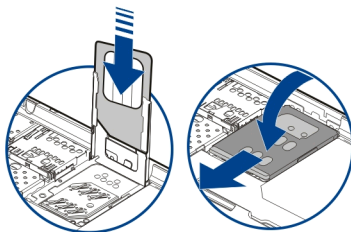

- 6 Lower the SIM card holder into place. Slide the SIM card holder, to lock it.
7 Line up the battery contacts, and insert the battery.

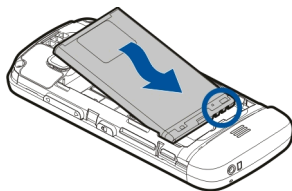

- 8 To replace the cover, direct the top locking catches toward their slots, and press down until the cover locks into place.

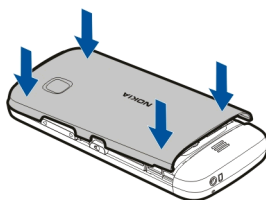

If the SIM card is not properly in place, the device can only be used in the offline profile.

Insert the memory card

Use only compatible memory cards approved by Nokia for use with this device. Incompatible cards may damage the card and the device and corrupt data stored on the card.



- 1 Remove the back cover.

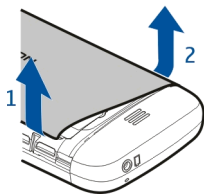

- 2 Make sure the contact area of a compatible memory card is facing down, and insert it into the memory card slot.

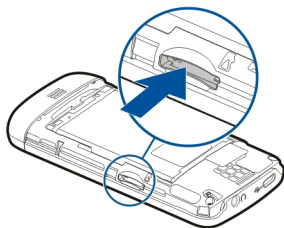

- 3 Push the card in, until you hear a click.

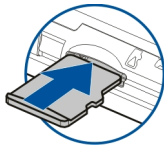

- 4 Replace the back cover.

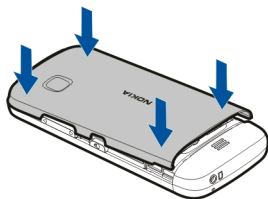

Remove the memory card



Important: Do not remove the memory card when an application is using it. Doing so may damage the memory card and the device, and corrupt data stored on the card.

- 1 If the device is switched on, before you remove the card, press the power key, and select **Remove memory card**.
- 2 When **Remove memory card? Some applications will be closed.** is displayed, select **Yes**.
- 3 When **Remove memory card and press 'OK'** is displayed, remove the back cover of the device, and push the card in, until you hear a click.
- 4 Pull out the memory card, and replace the back cover. If the device is switched on, select **OK**.

Charge the battery

Your battery has been partially charged at the factory, but you may need to recharge it before you can switch on your device for the first time. If the device indicates a low charge, do the following:

- 1 Connect the charger to a wall outlet.
- 2 Connect the charger to the device.

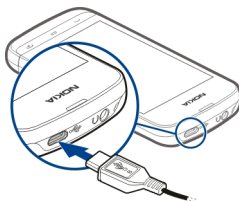

- 3 When the device indicates a full charge, disconnect the charger from the device, then from the wall outlet.

You do not need to charge the battery for a specific length of time, and you can use the device while it is charging. If the battery is completely discharged, it may take several minutes before the charging indicator appears on the display or before any calls can be made.

Tip: Disconnect the charger from the wall outlet when the charger is not in use. A charger that is connected to the outlet consumes power even when it is not connected to the device.

USB charging

You can use USB charging when a wall outlet is not available. Data can be transferred while charging the device. The efficiency of USB charging power varies significantly, and it may take a long time for charging to start and the device to start functioning.

- 1 Use a compatible USB data cable to connect your device to a compatible USB device. Depending on the type of the device that is used for charging, it may take a while for charging to start.
- 2 If the device is switched on, select the appropriate USB mode.

Only connect your device to products that have USB-IF logo.

Keys and parts

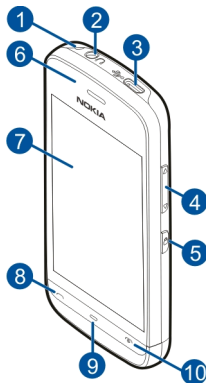

- 1 Wrist strap hole
- 2 Nokia AV connector (3.5 mm)
- 3 Micro USB connector
- 4 Volume/Zoom key
- 5 Lock key
- 6 Earpiece
- 7 Touch screen

- 8 Call key
- 9 Menu key
- 10 End/power key
- 11 Camera lens
- 12 Loudspeaker
- 13 Microphone

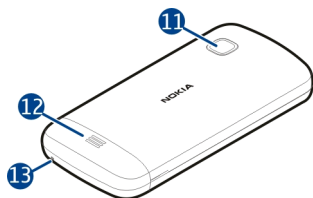

Switch the device on

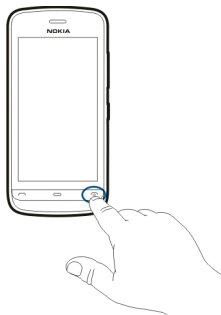

1

Press and hold the power key.

- 2 If the device asks for a PIN code or lock code, enter it, and select **OK**. To delete a number, select **X**. The factory setting for the lock code is **12345**.
- 3 Select your location. If you accidentally select the wrong location, select **Back**.
- 4 Enter the date and time. When using the 12-hour time format, to switch between a.m. and p.m., select any number.

Lock the keys and touch screen

To lock the touch screen and the keys, press the lock key on the side of the device.

To unlock, press the lock key on the side of the device, and select the unlock icon on the screen.

When the touch screen and keys are locked, the touch screen is switched off and the keys are inactive.

The screen and keys may be locked automatically after a period of inactivity.

To change the settings for automatic screen and key locking, select **Menu** > **Settings** and **Phone** > **Phone mgmt.** > **Auto. keyguard** > **Keypad autolock period**.

Home screen

The home screen is your starting point where you can collect all your important contacts or application shortcuts.

Interactive display elements

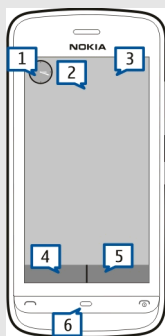

To open the clock application, tap the clock (1).

To open calendar or change profiles in the home screen, tap the date or the profile name (2).

To view or change connectivity settings () or to view missed events, tap the top right corner (3).

To make a phone call, select  (4), or, if the contacts bar is active, select **Telephone**.

To open Contacts, select  (5), or, if the contacts bar is active, select **Contacts**.

To open the main menu, press the menu key (6).

Start using the contacts bar

To add a contact to the contacts bar, in the home screen, select  and a contact, and follow the displayed instructions.

Contacts need to be saved in the phone memory.

To add a new contact to your contacts list, select  > **Options** > **New contact**, and follow the displayed instructions.

Contacts added from the contacts bar are always saved to the phone memory.

Change the home screen theme

To change the home screen theme or the shortcuts, select **Menu** > **Settings** and **Personal** > **Home screen**.

Access the menu

To access the menu, press the menu key.

To open an application or folder in the menu, select the item.

Touch screen actions

Open an application or other screen element

Tap the application or element once.

To view the options available for the opened item, select **Options** or, if available, select an icon from a toolbar.

Access functions quickly

Tap and hold the item. A pop-up menu with available options opens. For example, to send an image, tap and hold the image, and from the pop-up menu, select the appropriate option.

Tip: To see the options available for an opened item, such as an image or a video, tap the screen.

Select

In this user documentation, opening applications or items by tapping them is called "selecting". If you need to select several items in a sequence, the menu items to select are separated by arrows.

For example, to select **Options** > **Help**, tap **Options**, and then tap **Help**.

Scroll

To scroll up or down in lists that have a scroll bar, drag the slider of the scroll bar.

Touch screen backlight

The touch screen backlight is turned off after a period of inactivity. To turn the screen backlight on, tap the screen.

If the touch screen and keys are locked, tapping the screen does not turn the screen backlight on.

Change the ringing tone

Select **Menu > Settings and Personal > Profiles**.

You can use profiles to set and customize the ringing tones, message alert tones, and other tones for different events, environments, or caller groups.

To customize a profile, go to the profile, and select **Customize**.

Ovi by Nokia

 With Ovi by Nokia, you can find new places and services, and stay in touch with your friends. You can do, for example, the following:

- Download games, applications, videos, and ringing tones to your device
- Find your way with free walk and drive navigation, plan trips, and view locations on a map
- Get a free Ovi Mail account
- Buy music

Some items are free of charge, others you may need to pay for.

The available services may also vary by country or region, and not all languages are supported.

To access Nokia's Ovi services, go to www.ovi.com, and register your own Nokia account.

For more help and information, go to www.ovi.com.

About Ovi Store





 With Ovi Store, you can download mobile games, applications, videos, pictures, themes, and ringing tones to your device. Some items are free of charge; others you need to pay for with your credit card or in your phone bill. The availability of payment methods depends on your country of residence and your network service provider. Ovi Store offers content that is compatible with your mobile device and relevant to your tastes and location.

Your device

Contacts bar

To add a contact to the home screen, in the home screen, select  > **Options** > **New contact**, and follow the instructions.

To communicate with a contact, select the contact and from the following:

-  — Call the contact.
-  — Send a message to the contact.
-  — Add a link to an Ovi contact. If you want to chat to an Ovi contact, select the contact. The icon changes to . To start chatting, select the icon.
-  — Refresh the contact's web feeds.

To view past communication events with a contact, select the contact. To view the details of a communication event, select the event.

To close the view, select **Options** > **Exit**.

Antenna locations

Avoid touching the antenna area unnecessarily while the antenna is transmitting or receiving. Contact with antennas affects the communication quality and may cause a higher power level during operation and may reduce the battery life.

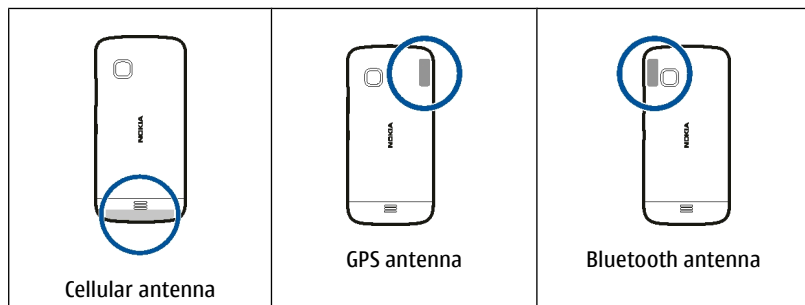

Offline profile

The offline profile lets you use the device without connecting to the wireless cellular network. When the offline profile is active, you can use your device without a SIM card.

Activate the offline profile

Press the power key briefly, and select **Offline**.

When you activate the offline profile, the connection to the cellular network is closed. All radio frequency signals to and from the device to the cellular network are prevented. If you try to send messages using the cellular network, they are placed in the Outbox folder to be sent later.



Important: In the offline profile you cannot make or receive any calls, or use other features that require cellular network coverage. You may be able to call the official emergency number programmed into your device. To make calls, you must first change to another profile.

Shortcuts

To switch between open applications, press and hold the menu key.

Leaving applications running in the background increases the demand on battery power and reduces the battery life.

To change the profile, press the power key, and select a profile.

To call your voice mailbox (network service), in the dialer, tap and hold **1**.

To open a list of last dialed numbers, in the home screen, press the call key.

To use voice commands, in the home screen, press and hold the call key.

Sensor settings and display rotation

When you activate the sensors in your device, you can control certain functions by turning the device.

Select **Menu > Settings and Phone > Sensor settings**.

Select from the following:

Sensors — Activate the sensors.

Turning control — Select **Silencing calls** and **Snoozing alarms** to mute calls and snooze alarms by turning your device so that the display faces down. Select **Auto-rotate display** to rotate the display content automatically when you turn the device on its left side or back to a vertical position. Some applications and features may not support rotating the display content.

Headset

You can connect a compatible headset or compatible headphones to your device. You may need to select the cable mode.

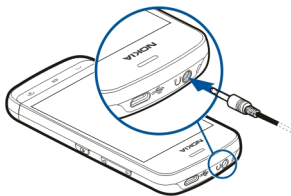

Attach a wrist strap

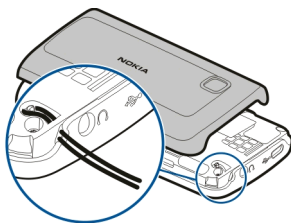

Make calls

Calls

- 1 In the home screen, select **Telephone** to open the dialer, and enter the phone number, including the area code. To remove a number, select . For international calls, select * twice for the + character (which replaces the international access code), and enter the country code, area code (omit the leading zero if necessary), and phone number. The + character as a replacement for the international access code may not work in all regions. In this case, enter the international access code directly.
- 2 To make the call, press the call key.
- 3 To end the call (or to cancel the call attempt), press the end key.
Pressing the end key always ends a call, even if another application is active.

To make a call from the contacts list, select **Menu > Contacts**.

Go to the desired name. Or, select the search field, enter the first letters or characters of the name, and go to the name.

To call the contact, press the call key. If you have saved several numbers for a contact, select the desired number from the list, and press the call key.

Write text

Tap any text input field to enter letters, numbers, and special characters.

Your device can complete words based on the built-in dictionary for the selected text input language. The device also learns new words from your input.

Virtual keyboard

You can use the virtual keyboard in landscape mode.

To activate the virtual keyboard, select  > **Full screen QWERTY**.

When using the virtual keyboard in full screen mode, you can select keys with your fingers.

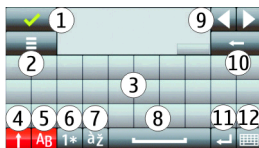

- 1 Close - Close the virtual keyboard.
- 2 Input menu - Open the touch input options menu to access commands such as **Writing language**.
- 3 Virtual keyboard
- 4 Shift and caps lock - To enter an uppercase character when writing in lowercase, or vice versa, select the key before entering the character. To activate the caps lock, select the key twice. A line under the key indicates that the caps lock is activated.
- 5 Letters
- 6 Numbers and special characters
- 7 Character accents
- 8 Space bar
- 9 Move - Move the cursor.
- 10 Backspace
- 11 Enter - Move the cursor to the next row or text input field. Additional functions are based on the current context (for example, in the web address field of the web browser, it acts as the Go button).
- 12 Input mode - Select the input method. When you tap an item, the current input method view closes, and the selected one opens.

Handwriting

The input methods and languages supported by the handwriting recognition vary by region and may not be available for all languages.

To activate handwriting mode, select  > **Handwriting**.

Write legible, upright characters on the text input area, and leave a space between each character.

To teach the device your handwriting style, select  > **Handwriting training**.

To enter letters and numbers (default mode), write words as you would normally. To select number mode, select . To enter non-Latin characters, select the corresponding icon, if available.

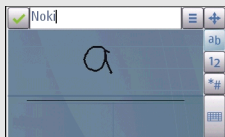

To enter special characters, write them as you would normally, or select  and the desired character.

To delete characters or move the cursor back, swipe backwards (see Figure 1).

To insert a space, swipe forwards (see Figure 2).



Enter text with the virtual keypad

Virtual keypad

With the virtual keypad (**Alphanumeric keypad**), you can enter characters like you would with a traditional physical keypad with numbers on the keys.

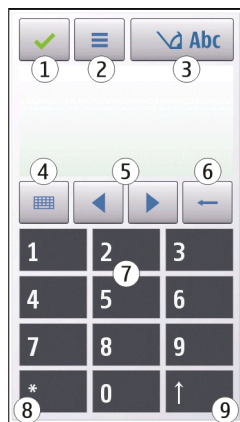

- 1 Close - Closes the virtual keypad (**Alphanumeric keypad**).
- 2 Input menu - Opens the touch input menu, which includes commands such as **Activate predictive text** and **Writing language**.
- 3 Text input indicator - Opens a pop-up window, in which you can activate or deactivate predictive text input modes, change the character case, and switch between letter and number modes.
- 4 Input mode - Opens a pop-up window, in which you can select the input mode. When you tap an item, the current input method view closes, and the selected one opens. The availability of input modes may vary depending on whether the automatic input mode (sensor settings) is activated or not.
- 5 Arrow keys - Scroll left or right.
- 6 Backspace
- 7 Numbers
- 8 Star - Opens a special characters table.
- 9 Shift - Changes the character case, activates or deactivates predictive text input modes, and switches between letter and number modes.

Traditional text input

Tap a number key (1-9) repeatedly until the desired character appears. There are more characters available for a number key than are visible on the key.

If the next letter is located on the same key as the present one, wait until the cursor appears (or move the cursor forward to end the time-out period), and enter the letter.

To insert a space, tap **0**. To move the cursor to the next line, tap **0** three times.

Predictive text input

With predictive text input, to enter a word, select one number key for each letter in the word. Predictive text input is based on a built-in dictionary to which you can add new words. Predictive text input is not available for all languages.

- 1 To activate predictive text input for all editors on the device, select  > **Activate prediction**.
- 2 Write a word. For example, to write "Nokia" when the English dictionary is selected, select **6** for N, **6** for o, **5** for k, **4** for i, and **2** for a.
The word suggestion changes after each key selection.
- 3 If the word is not correct, select ***** repeatedly, until the correct match is displayed. If the word is not in the dictionary, select **Spell**, enter the word using traditional text input mode, and select **OK**.
If **?** is displayed after the word, the word is not in the dictionary. To add a word to the dictionary, select *****, enter the word using traditional text input mode, and select **OK**.
- 4 To insert a punctuation mark, select *****.
- 5 To insert a space, select **0**.

Touch input settings

Select **Menu** > **Settings** and **Phone** > **Touch input**.

To modify text input settings for the touch screen, select from the following:

Handwriting training — Open the handwriting training application. Train the device to recognize your handwriting better. This option is not available in all languages.

Writing language — Define which language-specific characters in your handwriting are recognised and how the virtual keyboard is laid out.

Writing speed — Select the writing speed.

Guiding line — Display or hide the guiding line in the writing area. The guiding line helps you write in a straight line, and it also helps the device recognize your writing.

Pen trail width — Select the pen trail width for the text written with the stylus.

Writing color — Select the color of the text written with the stylus.

Adaptive search — Activate adaptive search.

Touch screen calibration — Calibrate the touch screen.

Contacts



You can save and update contact information, such as phone numbers, home addresses, or e-mail addresses of your contacts. You can add a personal ringing tone or a thumbnail image to a contact. You can also create contact groups, which allow you to send text messages or e-mail to many recipients at the same time.

To open the contacts list, in the home screen, depending on the home screen theme, select **Contacts** or .

Save phone numbers and mail addresses

You can save your friends' phone numbers, mail addresses, and other information to your contacts list.

Select **Menu > Contacts**.

Add a contact to the contacts list

- 1 Select **Options > New contact**.
- 2 Select a field, and enter the details. To close the text input, select .

Edit contact information

Select a contact and **Options > Edit**.

Add details about a contact

Select a contact and **Options > Edit > Options > Add detail**.

Manage names and numbers

To copy or delete a contact, or to send a contact as a business card to another device, tap and hold a contact, and select **Add to favorites**, **Edit**, or **Send as business card**.

To delete several contacts at the same time, select **Options > Mark/Unmark** to mark the desired contacts, and to delete, select **Options > Delete**.

To listen to the voice tag assigned to a contact, select the contact and **Options > Voice tag details > Options > Play voice tag**.

When entering contacts or editing voice commands, do not use very short or similar names for different contacts or commands.



Note: Using voice tags may be difficult in a noisy environment or during an emergency, so you should not rely solely upon voice dialing in all circumstances.

Assign default numbers and addresses

If a contact has several numbers or addresses, a default number or address makes it easier for you to call or send a message to the contact. The default number is also used in voice dialing.

- 1 Select **Menu > Contacts**.
- 2 Select a contact and **Options > Defaults**.
- 3 Select a default to which you want to add a number or an address.
- 4 Select a number or an address you want to set as a default.

- 5 To exit the Defaults view and save the changes, tap outside the view.

Ringling tones, images, and call text for contacts

You can define a ringing tone for a contact or contact group, and an image and call text for a contact. When the contact calls you, the device plays the selected ringing tone and shows the call text or image (if the caller's phone number is sent with the call and your device recognizes it).

Select **Menu** > **Contacts**.

Add more fields to a contact details view

Select the contact and **Options** > **Edit** > **Options** > **Add detail**.

Define a ringing tone for a contact or contact group

Select the contact or contact group and **Options** > **Ringling tone**, and select a ringing tone.

Remove the ringing tone from a contact

Select **Default tone** from the list of ringing tones.

Add an image for a contact

Select a contact saved in the device memory and **Options** > **Add image**, and select an image from **Gallery**.

Define a call text for a contact

Select the contact and **Options** > **Add call alert text**. Enter the call text, and select



View, change or remove the image from a contact

Select a contact and **Options** > **Image**, and the desired option.

Copy contacts

When you open the contacts list for the first time, the device asks if you want to copy names and numbers from the SIM card to your device.

To start copying, select **Yes**.

If you do not want to copy the contacts from the SIM card to your device, select **No**. The device asks if you want to view the SIM card contacts in the contacts directory. To view the contacts, select **Yes**. The contacts list opens, and the names stored on your SIM card are indicated with .

SIM services

For availability and information on using SIM card services, contact your SIM card vendor. This may be the network service provider or other vendor.

SIM contacts

The number of contacts that can be stored on the SIM card is limited.

Display contacts stored on the SIM card in the contacts list

Select **Options > Settings > Contacts to display > SIM memory**.

The numbers you save in the contacts list may not be automatically saved to your SIM card.

Copy contacts to the SIM card

Go to a contact, and select **Options > Copy > SIM memory**.

Select the default memory where to save the new contacts

Select **Options > Settings > Default saving memory > Phone memory or SIM memory**.

Contacts stored in the device memory can contain more than one phone number and an image.

Fixed dialling

With the fixed dialling service, you can restrict calls from your device to certain phone numbers. Not all SIM cards support the fixed dialling service. For more information, contact your service provider.

Select **Menu > Contacts and Options > SIM numbers > Fixed dial contacts**.

You need your PIN2 code to activate and deactivate fixed dialling or edit your fixed dialling contacts. Contact your service provider for your PIN2 code.

Select **Options** and from the following:

Activate fixed dialling or **Deactivate fixed dialling** — Activate or deactivate fixed dialling.

New SIM contact — Enter the contact name and phone number to which calls are allowed.

Add from Contacts — Copy a contact from the contacts list to the fixed dialling list.

To send text messages to the SIM contacts while the fixed dialling service is active, you need to add the text message centre number to the fixed dialling list.

Messaging



Messaging main view

Select **Menu** > **Messaging** (network service).

Create a new message

Select **New message**.

Tip: To avoid rewriting messages that you send often, use saved messages in the Templates folder in My folders. You can also create and save your own templates.

Messaging contains the following folders:

Inbox — Received messages, except e-mail and cell broadcast messages.

My folders — Organize your messages into folders.

Mailbox — Connect to your remote mailbox to retrieve your new e-mail messages, or view your previously retrieved e-mail messages offline.

Drafts — Draft messages that have not been sent.

Sent — The last messages that have been sent, excluding messages sent using Bluetooth connectivity or infrared. You can define the number of messages that can be saved in this folder.

Outbox — Messages waiting to be sent are temporarily stored in the Outbox, for example, when your device is outside network coverage.

Delivery reports — Request the network to send you a delivery report of the text messages and multimedia messages you have sent (network service).

Write and send messages

Select **Menu** > **Messaging**.

Before you can create a multimedia message or write an e-mail, you must have the correct connection settings defined.

If the item you inserted in a multimedia message is too large for the network, the device may automatically reduce the size.

Only compatible devices can receive and display multimedia messages. Messages may look different in different devices.

Check the size limit of e-mail messages with your service provider. If you attempt to send an e-mail message that exceeds the size limit of the e-mail server, the message is left in the Outbox folder, and the device will attempt to resend it periodically. Sending an e-mail requires a data connection, and continuous attempts to resend the e-mail

may incur charges from your service provider. In the Outbox folder, you can delete such message, or move it to the Drafts folder.

Messaging requires network services.

Send a text or multimedia message

Select **New message**.

Send an audio or e-mail message

Select **Options > Create message**, and the relevant option.

Select recipients or groups from the contacts list

Select  from the toolbar.

Enter the number or e-mail address manually

Tap the To field.

Enter the subject of the e-mail or multimedia message

Enter it in the Subject field, . If the Subject field is not visible, select **Options > Message header fields** to change the fields that are visible.

Write the message

Tap the message field.

Add an object to a message or e-mail

Select  and the relevant type of content.

The message type may change to multimedia message based on the inserted content.

Send the message or e-mail

Select , or press the call key.

You can send text messages that are longer than the character limit for a single message. Longer messages are sent as two or more messages. Your service provider may charge accordingly.

Characters with accents, other marks, or some language options, take more space, and limit the number of characters that can be sent in a single message.

Set up your e-mail

To set up your e-mail, select **Menu > Messaging and Mailbox**.

You can set up several e-mail accounts, for example, a personal e-mail account and a corporate e-mail account.

To set up e-mail from your home screen, select the relevant plug-in. Alternatively, to set up an e-mail account, select **Menu > Applications > Tools > Sett. wizard**.

E-mail service

The e-mail service on your Nokia device automatically transfers e-mail from your existing e-mail address to your device. You can read, respond to, and organize your e-mails on the go. The service works with a number of internet e-mail providers that are often used for personal e-mail. Data charges may be applicable when using the service. For information on possible costs, contact your service provider

Set up e-mail on your Nokia device

- 1 Select **Menu > Applications > Tools > Sett. wizard**.
- 2 When the Settings wizard is opened for the first time, you are asked to define the e-mail settings after the service provider settings. If you have used the Settings wizard before, select **E-mail setup**.
- 3 Accept the terms and conditions to activate the e-mail service.

For more information, see nokia.com/messaging.

Mail for Exchange

With Mail for Exchange, you can receive your work e-mail to your device. You can read and reply to your e-mails, view and edit compatible attachments, view calendar information, receive and reply to meeting requests, schedule meetings, and view, add, and edit contact information.

Use of the Mail for Exchange is limited to over-the-air synchronization of PIM information between the Nokia device and the authorized Microsoft Exchange server.

Mail for Exchange can be set up only if your company has Microsoft Exchange Server. In addition, your company's IT administrator must have activated Mail for Exchange for your account.

Before starting to set up Mail for Exchange, ensure that you have the following:

- A corporate e-mail ID
- Your office network user name
- Your office network password
- Your network domain name (contact your company's IT department)
- Your Mail for Exchange server name (contact your company's IT department)

Depending on your company's Mail for Exchange server configuration, you may need to enter other information in addition to those listed. If you do not know the correct information, contact your company's IT department.

With Mail for Exchange, the use of the lock code may be mandatory. The default lock code of your device is 12345, but your company's IT administrator may have set a different one for you to use.

To access and edit the Mail for Exchange profile and settings, select **Menu > Settings > Phone > Application sett. > Messaging**.

About Ovi Contacts

With Ovi Contacts, you can stay connected to the people who matter most. Search for contacts, and discover friends in the Ovi community. Keep in touch with your friends - chat, share your location and presence information, and easily follow what your friends are up to and where they are.

You can also sync your contacts, calendar, and other content between your Nokia device and Ovi. Your important information is stored and kept up to date both in your device and on the web. With Ovi Contacts, you can make your contacts list dynamic and be confident that your contacts are stored in Ovi.

You must have a Nokia account to use the service. Create an account on your cellular phone, or go to www.ovi.com on your PC.

Using Ovi Contacts may involve the transmission of large amounts of data through your service provider's network. For information about data transmission charges, contact your network service provider.

Connect to the service

Select **Menu** > **Contacts**, and open the Ovi tab.

Connect to Ovi Contacts

Select **Go online** and the connection method.

Close the connection

Select **Options** > **Sign out**.

A packet data connection may generate additional data transmission charges. For pricing details, contact your service provider.

Select **Go online** > **Options** and from the following:

Select — Select the item.

Go online — Connect to the service if you are offline.

My profile — Edit your profile information.

Recommend to friend — Invite a contact to join Ovi Contacts. The invitation is sent as a text message.

Settings — Change the Ovi Contacts settings.

Available options may vary.

Start using Ovi Contacts

Select **Contacts**, and open the Ovi tab.

The Ovi Contacts service is part of Ovi, and uses the same account information.

If you are new to Ovi and its services, to start using the Ovi Contacts application, you must register to Ovi by creating a Nokia account.

Create a Nokia account

- 1 Select **Ovi Chat**, and when prompted, connect to the internet.
- 2 Enter the required information.
- 3 In the My Profile view, enter your profile information. It is mandatory that you provide your first and last name.
- 4 Select **Done**.

If you have already registered with Ovi using your PC or mobile device, you can start using Ovi Contacts with the same account details.

Sign in to Ovi Contacts and activate the service

Select **Ovi Chat**, and enter your user name and password.

If you have not yet provided your profile information for Ovi Contacts, do so, and select **Done**. It is mandatory that you provide your first and last name.

Music player



Music player supports file formats such as AAC, AAC+, eAAC+, MP3, and WMA. Music player does not necessarily support all features of a file format or all the variations of file formats.

You can also use Music player to listen to podcasts. Podcasting is a method for delivering audio or video content over the internet using either RSS or Atom technologies for playback on cellular phones and computers.

Listen to music at a moderate level. Continuous exposure to high volume may damage your hearing.

Play music

Select **Menu > Music > Music player**.

Browse songs

Select the desired view. You can browse songs by artist, album, genre, or composer.

Play a song



Select the song.

Tip: To listen to the songs in a random order, select **Shuffle play**.

Pause and resume playback

To pause playback, select ; to resume, select .

Fast-forward or rewind a song

Select and hold  or .

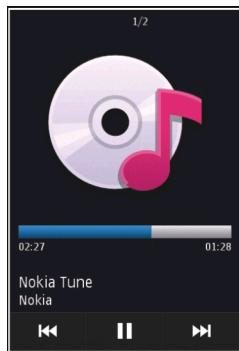

Tip: When listening to music, you can return to the home screen and leave the Music player application playing in the background.

Create a playlist

Want to listen to different music for different moods? With playlists, you can create selections of songs to play in a specific order.

Select **Menu** > **Music** > **Music player**.

- 1 Select **Playlists**.
- 2 Select **Options** > **New playlist**.
- 3 Enter a name for the playlist, and select **OK**.
- 4 Select the songs to add to the playlist, in the order you want them to play.

If a compatible memory card is inserted, the playlist is saved to the memory card.

Add a song to a playlist

Select and hold the song, and from the pop-up menu, select **Add to playlist**.

Remove a song from playlist

In the playlist view, select and hold the song, and from the pop-up menu, select **Remove**.

This does not delete the song from the device; it only removes it from the playlist.

Play a playlist

Select **Playlists** and the playlist.

Tip: Music player automatically creates a playlist for the most played songs, recently played songs, and recently added songs.

Camera

Your device supports an image capture resolution of 1600 x 1200 pixels. The image resolution in this guide may appear different.

Activate the camera

To activate the camera, select **Menu > Applications > Camera**.



Image capture

Capture an image

Select **Menu > Applications > Camera**.

When capturing an image, note the following:

- Use both hands to keep the camera steady.
- The quality of a digitally zoomed image is lower than that of a non-zoomed image.
- The camera goes into battery saving mode after about a minute of inactivity.

To switch from video mode to image mode, if necessary, select  > .

Zoom in or out when capturing an image

Use the zoom slider.

After capturing an image

After you capture an image, select from the following options (available only if you have selected **Options > Settings > Show captured image > Yes**):

 — Send the image in a multimedia or e-mail message, or through connection methods such as Bluetooth connectivity.

To send the image to the person you are talking to, select  during a call.

 — Upload the image to a compatible online album.

 **Delete** — Delete the image.

Use the image as wallpaper in the home screen

Select **Options > Use image > Set as wallpaper**.

Set the image as a default call image

Select **Options** > **Use image** > **Set as call image**.

Assign the image to a contact



Select **Options** > **Use image** > **Assign to contact**.

Return to the viewfinder to capture a new image

Select **Back**.



Video recording**Record a video**

Select **Menu** > **Applications** > **Camera**.

- 1 To switch from image mode to video mode, if necessary, select  > .
- 2 To pause recording, select **Pause**. To resume, select **Continue**. If you pause recording and do not press any key within one minute, the recording stops. To zoom in or out, use the zoom keys.
- 3 To stop recording, select **Stop**. The video is automatically saved in Gallery.

After recording a video

After you record a video, select from the following (available only if you have selected **Options** > **Settings** > **Show last captured video** > **Yes**):

-  **Play** — Play the video you just recorded.
-  — Upload the image to a compatible online album.
-  **Delete** — Delete the video.

To return to the viewfinder to record a new video, select **Back**.



Gallery

To store and organise your images, videos, sound clips, and streaming links, select **Menu** > **Gallery**.

View and organize files

Select **Menu** > **Gallery**.

Select from the following:

-  **Images & videos** — View images in the image viewer and videos in Video center.
-  **Songs** — Open Music player.
-  **Sound clips** — Listen to sound clips.

 **Other media** — View presentations.

 indicates files stored on your compatible memory card (if inserted).

Open a file

Select a file from the list. Videos and files with the .ram file extension open and play in Video center, and music and sound clips in Music player.

Copy or move files

To copy or move files to the memory card (if inserted) or device memory, select a file, **Options > Organize > Copy or Move**, and the appropriate option.

View images and videos

Select **Menu > Gallery and Images & videos**.

By default, the images, videos, and folders are organized by date and time.

To open a file, select a file from the list. To zoom in an image, use the volume key.

To edit a video or an image, select **Options > Edit**.

Select an image, **Options > Use image**, and from the following:

Set as wallpaper — Use the image as wallpaper in the home screen.

Set as call image — Set the image as a default call image

Assign to contact — Set the image as a call image for a contact.

Select a video, **Options > Use video clip**, and from the following:

Assign to contact — Assign the video as a ringing tone for a contact.

As ringing tone — Set the video as a ringing tone.

The toolbar helps you select frequently used functions with images, videos, and folders.

From the toolbar, select from the following:

 **Send** — Send your image or video.

 **Delete** — Delete an image or a video.

Share online

About Share online

Select **Menu > Applications > Share online**.

With Share online (network service), you can post your images, video clips, and sound clips from your device to compatible online sharing services, such as albums and blogs.

You can also view and send comments to the posts in these services, and download content to your compatible Nokia device.

The supported content types and the availability of the Share online service may vary.

Subscribe to an online sharing service

Select **Menu > Applications > Share online**.

- 1 Go to the service provider's website, and make sure your Nokia device is compatible with the service.
- 2 Create an account as instructed on the website. You receive a username and password needed to set up your device with the account.

Activate a service

- 1 Select and hold the service, and from the pop-up menu, select **Activate**.
- 2 Allow the device to open a network connection. If prompted, select an internet access point from the list.
- 3 Sign in to your account as instructed on the service provider's website.

For the availability and cost of the third party services and data transfer costs, contact your service provider or the relevant third party.

Manage your accounts

To view your accounts, select **Options > Settings > My accounts**.

To create a new account, select **Options > Add new account**.

To change the user name or password for an account, select and hold the account name, and from the pop-up menu, select **Edit**.

To set an account as the default when sending posts from your device, select and hold the account name, and from the pop-up menu, select **Set as default**.

To remove an account, select and hold the account name, and from the pop-up menu, select **Delete**.

Create a post

Select **Menu > Applications > Share online**.

To post your images or video clips to a service, select and hold the service, and from the pop-up menu, select **New upload**. If the online sharing service provides channels for posting files, select the desired channel.

To add your image, video, or sound clip to the post, select **Options > Add**.

Enter a title or description for the post, if available.

To add tags to the post, select **Tags**..

To enable the posting of location information contained in the file, select **Location**..

To send the post to the service, select **Options > Upload**.

Post files from Gallery

You can post your images and videos from Gallery to an online sharing service.

- 1 Select **Menu > Gallery** and your images and videos to post.
- 2 Select **Options > Send > Upload** and the desired account.
- 3 Edit your post as required.
- 4 Select **Options > Upload**.

Nokia Video Center



With Nokia Video Center (network service), you can download and stream videos over the air from compatible internet video services using a packet data connection. You can also transfer your video clips from a compatible PC to your device and view them in Video center.

Using packet data access points to download videos may involve the transmission of large amounts of data through your service provider's network. Contact your service provider for information about data transmission charges.

Your device may have predefined services.

Service providers may provide free content or charge a fee. Check the pricing in the service or from the service provider.

View and download video clips

Connect to video services

- 1 Select **Menu > Applications > Video center**.
- 2 To connect to a service to install video services, select **Add new services** and the desired video service from the service catalog.

View a video clip

To browse the content of installed video services, select **Video feeds**.

The content of some video services is divided into categories. To browse video clips, select a category.

To search for a video clip in the service, select **Video search**. Search may not be available in all services.

Some video clips can be streamed over the air, but others must be first downloaded to your device. To download a video clip, select **Options > Download**. Downloads continue in the background if you exit the application. The downloaded video clips are saved in My videos.

To stream a video clip or view a downloaded one, select **Options > Play**. When the video clip is playing, to use the control keys for controlling the player, tap the screen.

To adjust the volume, use the volume key.

Select **Options** and from the following:

Resume download — Resume a paused or failed download.

Cancel download — Cancel a download.

Preview — Preview a video clip. This option is available if supported by the service.

Feed details — View information about a video clip.

Refresh list — Refresh the list of video clips.

Open link in browser — Open a link in the web browser.

Schedule downloads

Setting the application to download video clips automatically may involve the transmission of large amounts of data through your service provider's network. For information about data transmission charges, contact your service provider.

To schedule an automatic download for video clips in a service, select **Options > Schedule downloads**.

Video center automatically downloads new video clips daily at the time you define.

To cancel scheduled downloads, select **Manual download** as the download method.

Video feeds

Select **Menu > Applications > Video center**.

The content of the installed video services is distributed using RSS feeds. To view and manage your feeds, select **Video feeds**.

Select **Options** and from the following:

Feed subscriptions — Check your current feed subscriptions.

Feed details — View information about a video.

Add feed — Subscribe to new feeds. Select **Via Video directory** to select a feed from the services in the video directory.

Refresh feeds — Refresh the content of all feeds.

Manage account — Manage your account options for a particular feed, if available.

To view the videos available in a feed, select a feed from the list.

My videos

My videos is a storage place for all videos in the Video center application. You can list downloaded videos and video clips recorded with the device camera in separate views.

- 1 To open a folder and view video clips, select the folder. When a video clip is playing, to use the control keys for controlling the player, tap the screen.
- 2 To adjust the volume, press the volume key.

Select **Options** and from the following:

Resume download — Resume a paused or failed download.

Cancel download — Cancel a download.

Video details — View information about a video clip.

Find — Find a video clip. Enter a search term that matches the file name.

Memory status — View the amount of free and used memory.

Sort by — Sort video clips. Select the desired category.

Move and copy — Move or copy video clips. Select **Copy** or **Move** and the desired location.

Transfer videos from your PC

Transfer your own videos from compatible devices using a compatible USB data cable. Only videos which are in a format supported by your device are displayed.

- 1 To view your device on a PC as a mass memory device where you can transfer any data files, connect using a compatible USB data cable.
- 2 Select **Mass storage** as the connection mode. A compatible memory card needs to be inserted in the device.
- 3 Select the video clips you want to copy from your PC.
- 4 Transfer the videos to **E:\My Videos** on the memory card.
The transferred videos appear in the My videos folder.

Video center settings

In the Video center main view, select **Options** > **Settings** and from the following:

Video service selection — Select the video services that you want to appear in Video center. You can also add, remove, edit, and view the details of a video service. You cannot edit preinstalled video services.

Connection settings — To define the network destination used for the network connection, select **Network connection**. To select the connection manually each time Video center opens a network connection, select **Always ask**.

To set GPRS connection on or off, select **Confirm GPRS usage**.

To set roaming on or off, select **Confirm roaming**.

Parental control — Set an age limit to videos. The required password is the same as the device lock code. The factory setting for the lock code is **12345**. In video-on-demand services, videos which have the same or a higher age limit than you have set, are hidden.

Preferred memory — Select whether downloaded videos are saved in the device memory or on a compatible memory card.

Thumbnails — Select whether to download and view thumbnail images in video feeds.

Web browser

With the web browser, you can view hypertext markup language (HTML) pages on the web as originally designed (network service). You can also browse web pages that are designed specifically for cellular phones, and use extensible hypertext markup language (XHTML), or the wireless markup language (WML).

To browse the web, you need to have an internet access point defined in your device.

Browse the web

Select **Menu > Web**.

Go to a web page

From the toolbar, select , and enter a web address.

A cache is a memory location that is used to store data temporarily. If you have, or have tried to, access confidential information or a secure service, requiring passwords, clear the cache after each use.



Empty the cache

Select **Options > Clear privacy data > Cache**.

Add a bookmark

If you visit the same websites all the time, add them to your Bookmarks view, so you can easily access them.

Select **Menu > Web**.

While browsing, select  > .

Go to a bookmarked website while browsing

Select  and a bookmark.

Positioning (GPS)

You can use applications such as GPS data to calculate your location or measure distances. These applications require a GPS connection.

About GPS

The availability and quality of GPS signals may be affected by your location, satellite positions, buildings, natural obstacles, weather conditions and adjustments to GPS satellites made by the United States government. GPS signals may not be available inside buildings or underground.

Do not use GPS for precise location measurement, and never rely solely on the location information provided by GPS and cellular networks.

The coordinates in the GPS are expressed using the international WGS-84 coordinate system. The availability of the coordinates may vary by region.

About assisted GPS (A-GPS)

Your device supports A-GPS (network service). When you activate A-GPS, your device receives useful satellite information from an assistance data server over the cellular network. With the help of assisted data, your device can obtain the GPS position faster.

Your device is preconfigured to use the Nokia A-GPS service, if no service provider-specific A-GPS settings are available. The assistance data is retrieved from the Nokia A-GPS service server only when needed.

You must have an internet access point defined in the device to retrieve assistance data from the Nokia A-GPS service over a packet data connection.

Define an access point for A-GPS

Select **Menu > Applications > Location and Positioning > Positioning server > Access point**. Only a packet data internet access point can be used for this service. Your device asks for the internet access point when GPS is used for the first time.

Hold your device correctly

When using the GPS receiver, ensure you do not cover the antenna with your hand.

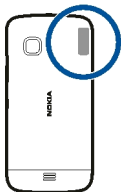

Establishing a GPS connection may take from a couple of seconds to several minutes. Establishing a GPS connection in a vehicle may take longer.

The GPS receiver draws its power from the device battery. Using the GPS receiver may drain the battery faster.

Maps

Maps overview

 Select Menu > Maps.

Welcome to Maps.

Maps shows you what is nearby, helps you plan your route, and guides you where you want to go.

- Find cities, streets, and services.
- Find your way with turn-by-turn directions.
- Synchronize your favorite locations and routes between your cellular phone and the Ovi Maps internet service.
- Check weather forecasts and other local information, if available.

Some services may not be available in all countries, and may be provided only in selected languages. The services may be network dependent. For more information, contact your network service provider.

Using the service or downloading content may cause transfer of large amounts of data, which may result in data traffic costs.

Almost all digital cartography is inaccurate and incomplete to some extent. Never rely solely on the cartography that you download for use in this device.

Some content is generated by third parties and not Nokia. The content may be inaccurate and is subject to availability.

View your location and the map

See your current location on the map, and browse maps of different cities and countries.

Select **Menu > Maps and My position**.

📍 indicates your current position, if available. When searching for your position, 📍 blinks. If your position is not available, 📍 indicates your last known position.

If accurate positioning is not available, a red halo around the positioning icon indicates the general area you might be in. In densely populated areas, the accuracy of the estimate increases, and the red halo is smaller than in lightly populated areas.

Browse the map

Drag the map with your finger. By default, the map is oriented north.

View your current or last known location

Select 📍.

Zoom in or out

Select + or -.

Tip: To zoom, you can also place two fingers on the map, and slide your fingers apart to zoom in or together to zoom out. Not all devices support this feature.

If you browse to an area not covered by the street maps that are stored on your device, and you have an active data connection, new street maps are automatically downloaded.

To prevent downloading new street maps automatically, in the main menu, select 🛠️ > **Internet > Connection > Offline**.

Map coverage varies by country and region.

Map view

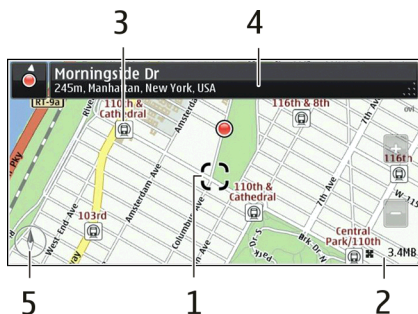

1 Selected location

- 2 Indicator area
- 3 Point of interest (for example, a railroad station or a museum)
- 4 Information area
- 5 Compass

Change the look of the map

View the map in different modes, to easily identify where you are.

Select **Menu > Maps and My position**.

Select  and from the following:

Map view — In the standard map view, details such as location names or highway numbers, are easy to read.

Satellite view — For a detailed view, use satellite images.

Terrain view — View at a glance the ground type, for example, when you are traveling off-road.

3D view — For a more realistic view, change the perspective of the map.

Landmarks — Display prominent buildings and attractions on the map.

Night mode — Dim the colors of the map. When traveling at night, the map is easier to read in this mode.

Transit lines — View selected public transportation services, such as metro and trolley routes.

The available options and features may vary by region. The unavailable options are dimmed.

Download and update maps

To avoid cellular data transfer costs, download the latest street maps and voice guidance files to your computer, and then transfer and save them to your device.

Use the Nokia Ovi Suite application to download the latest street maps and voice guidance files to your compatible computer. To download and install Nokia Ovi Suite, go to www.ovi.com.

Tip: Save new street maps to your device before a journey, so you can browse the maps without an internet connection when traveling abroad.

If you have an older version of the Maps application installed on your device, when you update to the latest version, the country or region maps are deleted. Before using Nokia Ovi Suite to download new country or region maps, open and close the Maps application.

Make sure you have the latest version of Nokia Ovi Suite installed on your computer.

About positioning methods

Maps displays your location on the map using GPS, A-GPS, or network (cell ID) based positioning.

The global positioning system (GPS) is a satellite-based navigation system used for calculating your location. Assisted GPS (A-GPS) is a network service that sends you GPS data, improving the speed and accuracy of the positioning.

With network (cell ID) based positioning, the position is determined through the antenna system your cellular phone is currently connected to.

When you use Maps for the first time, you are prompted to define the internet access point to use to download map information or use A-GPS.

To avoid network service costs, you can disable A-GPS and network (cell ID) based positioning in your device positioning settings, but calculating your location may take much longer. For more information about positioning settings, see the user guide of your device.

The availability and quality of GPS signals may be affected by your location, satellite positions, buildings, natural obstacles, weather conditions and adjustments to GPS satellites made by the United States government. GPS signals may not be available inside buildings or underground.

Do not use GPS for precise location measurement, and never rely solely on the location information provided by GPS and cellular networks.

The trip meter may not be accurate, depending on the availability and quality of your GPS connection.

Depending on the available positioning methods, the accuracy of positioning may vary from a few metres to several kilometers.

Find a location

Maps helps you find specific locations and businesses.

Select **Menu** > **Maps and Search**.

- 1 Enter search words, such as a street address or place name.
- 2 Select .
- 3 Select an item from the list of proposed matches.
The location is displayed on the map.

Return to the list of proposed matches

Select **Search**.

Tip: In the search view, you can also select from the list of your previous search words.

Search for different types of nearby places

Select **Categories** and a category, such as shopping, accommodation, or transport.

If no search results are found, make sure the spelling of your search words is correct. Problems with your internet connection may also affect results when searching online.

If you have maps of the searched area stored on your device, you can also get search results without an active internet connection, to avoid data transfer costs, but the search results may be limited.

View location details

Find more information about a specific location or place, such as a hotel or restaurant, if available.

The available options may vary by region. To view all the available place details, you need an active internet connection.

Select **Menu > Maps and Search**.

View the details of a place

Search for a place. Select the place and its information area.

Rate a place

Search for a place. Select the place, its information area, **Rate**, and the star rating. For example, to rate a place as being 3 out of 5 stars, select the third star.

When you find a place that does not exist or contains inappropriate information or incorrect details, such as the wrong contact information or location, it is recommended that you report it to Nokia.

Report incorrect place information

Select the place, its information area, **Report**, and the appropriate option.

Save or view a place or route

Save an address, place of interest, or route, so it can be quickly used later.

Select **Menu > Maps**.

Save a place

- 1 Select **My position**.
- 2 Tap the location. To search for an address or place, select **Search**.
- 3 Tap the location's information area.
- 4 Select **Save**.

Save a route

- 1 Select **My position**.
- 2 Tap the location. To search for an address or place, select **Search**.
- 3 Tap the location's information area.
- 4 To add another route point, select **Navigate** > **Add to route**.
- 5 Select **Add new route point** and the appropriate option.
- 6 Select **Show route** > **Options** > **Save route**.

View a saved place

In the main view, select **Favorites** > **Places**, the place, and **Show on map**.

View a saved route

In the main view, select **Favorites** > **Routes** and the route.

Send a place to a friend

When you want to show your friends where a place is on the map, you can send the place to them.

Select **Menu** > **Maps** and **My position**.

To view the place on the map, your friends don't need to have a Nokia cellular phone, but an active internet connection is required.

- 1 Select a place and its information area.
- 2 Select **Share** > **Share via SMS** or **Share via Email**.

A mail or text message containing a link to the location on the map is sent to your friend.

Check in

With the Check in feature, you can keep a private record of where you have been. Keep your social networking friends and contacts up to date with what you are doing, and share your location on your favorite social networking services.

Select **Menu** > **Maps** and **Check in**.

To check in, you need a Nokia account. To share your location, you also need a social networking service account. The supported social networking services vary by country or region.

- 1 Sign in to your Nokia account, or, if you do not yet have one, create the account.
- 2 It is possible to share your location on the social networking services that you use. When you use Check in for the first time, you can set your account credentials for the services that you use. To later set up accounts, select **...**
- 3 Select your current location.
- 4 Write your status update.

You can post only to selected services that you have set up. To exclude a service, select the service logo. To exclude all the services, keeping your location and status update private, clear the **and post on** check box.

5 Select **Check in**.

You may also be able to attach a picture to your post, depending on the social networking service.

View your Check in history

Select .

Checking in and sharing your location requires an internet connection. This may involve the transmission of large amounts of data and related data traffic costs.

The terms of use of the social networking service apply to sharing your location on that service. Familiarize yourself with the terms of use and the privacy practices of that service.

Before sharing your location to others, always consider carefully with whom you are sharing it. Check the privacy settings of the social networking service you are using, as you might share your location with a large group of people.

Synchronize your Favorites

Plan a trip on your computer at the Ovi Maps website, synchronize the saved places and routes with your cellular phone, and access the plan on the go.

To synchronize places or routes between your cellular phone and the Ovi Maps internet service, you need to be signed in to your Nokia account.

Synchronize saved places and routes

Select **Favorites** > **Synchronize with Ovi**. If you do not have a Nokia account, you are prompted to create one.

You can set your device to synchronize your Favorites automatically when you open or close the Maps application.

Synchronize Favorites automatically

Select  > **Synchronization** > **Synchronization** > **At start-up and shut-d..**

Synchronizing requires an active internet connection, and may involve the transmission of large amounts of data through your service provider's network. For information about data transmission charges, contact your service provider.

To use the Ovi Maps internet service, go to www.ovi.com.

Get voice guidance

Voice guidance, if available for your language, helps you find your way to a destination, leaving you free to enjoy the journey.

Select **Menu** > **Maps** and **Drive** or **Walk**.

When you use drive or walk navigation for the first time, you are asked to select the language of the voice guidance, and download the appropriate files.

If you select a language that includes street names, also the street names are said aloud. Voice guidance may not be available for your language.

Change the voice guidance language

In the main view, select  and **Navigation** > **Drive guidance** or **Walk guidance** and the appropriate option.

Deactivate voice guidance

In the main view, select  and **Navigation** > **Drive guidance** or **Walk guidance** and **None**.

Repeat the voice guidance for car navigation

In the navigation view, select **Options** > **Repeat**.

Adjust the volume of the voice guidance for car navigation

In the navigation view, select **Options** > **Volume**.

Drive to your destination

When you need turn-by-turn directions while driving, Maps helps you get to your destination.

Select **Menu** > **Maps** and **Drive**.

Drive to a destination

Select **Set destination** and the appropriate option.

Drive to your home

Select **Drive home**.

You can start driving without a set destination. The map follows your location, and traffic information is automatically displayed, if available. To set the destination later, select **Destination**.

By default, the map rotates to your driving direction.

Orient the map to north

Select . To rotate the map back to your driving direction, select .

When you select **Drive home** or **Walk home** for the first time, you are prompted to define your home location.

Change your home location

- 1 In the main view, select .
- 2 Select **Navigation** > **Home Location** > **Redefine**.
- 3 Select the appropriate option.

Change views during navigation

Swipe left to select **2D view**, **3D view**, **Arrow view**, or **Route overview**.

Obey all local laws. Always keep your hands free to operate the vehicle while driving. Your first consideration while driving should be road safety.

Navigation view



- 1 Route
- 2 Your location and direction
- 3 Information bar (speed, distance, time)

Get traffic and safety information

Enhance your driving experience with real-time information about traffic events, lane assistance, and speed limit warnings, if available for your country or region.

Select **Menu** > **Maps and Drive**.

View traffic events on the map

During drive navigation, select **Options** > **Traffic info**. The events are displayed as triangles and lines.

Update traffic information

Select **Options** > **Traffic info** > **Update traffic info**.

When planning a route, you can set the device to avoid traffic events, such as traffic jams or roadworks.

Avoid traffic events

In the main view, select  > **Navigation** > **Reroute due to traffic**.

The location of speed cameras may be shown on your route during navigation, if this feature is enabled. Some jurisdictions prohibit or regulate the use of speed camera location data. Nokia is not responsible for the accuracy, or the consequences of using speed camera location data.

Walk to your destination

When you need directions to follow a route on foot, Maps guides you over squares, and through parks, pedestrian zones, and even shopping centers.

Select **Menu** > **Maps and Walk**.

Walk to a destination

Select **Set destination** and the appropriate option.

Walk to your home

Select **Walk home**.

You can start walking without a set destination.

By default, the map is oriented to north.

Rotate the map to your walking direction

Select . To rotate the map back to north, select .

When you select **Drive home** or **Walk home** for the first time, you are prompted to define your home location.

Change your home location

- 1 In the main view, select .
- 2 Select **Navigation** > **Home Location** > **Redefine**.
- 3 Select the appropriate option.

Plan a route

Plan your journey, and create your route and view it on the map before setting off.

Select **Menu > Maps and My position**.

Create a route

- 1 Tap the location of your starting point. To search for an address or place, select **Search**.
- 2 Tap the location's information area.
- 3 Select **Add to route**.
- 4 To add another route point, select **Add new route point** and the appropriate option.

Change the order of the route points

- 1 Select a route point.
- 2 Select **Move**.
- 3 Tap the place where you want to move the route point to.

Edit the location of a route point

Tap the route point, and select **Edit** and the appropriate option.

View the route on the map

Select **Show route**.

Navigate to the destination

Select **Show route > Options > Start driving or Start walking**.

Change the settings for a route

The route settings affect the navigation guidance and the way the route is displayed on the map.

- 1 In the route planner view, open the Settings tab. To get to the route planner view from the navigation view, select **Options > Route pts. or Route points list**.
- 2 Set the transportation mode to **Drive** or **Walk**. If you select **Walk**, one-way streets are regarded as normal streets, and walkways and routes through, for example, parks and shopping centers, can be used.
- 3 Select the desired option.

Select the walking mode

Open the Settings tab, set the transportation mode to **Walk**, and select **Preferred route > Streets or Straight line**. **Straight line** is useful on off-road terrain as it indicates the walking direction.

Use the faster or shorter driving route

Open the Settings tab, set the transportation mode to **Drive**, and select **Route selection** > **Faster route** or **Shorter route**.

Use the optimized driving route

Open the Settings tab, set the transportation mode to **Drive**, and select **Route selection** > **Optimized**. The optimized driving route combines the advantages of both the shorter and the faster routes.

You can also choose to allow or avoid using, for example, highways, toll roads, or ferries.

Connectivity

Your device offers several options to connect to the internet or to another compatible device or PC.

Protect the environment**Save energy**

You do not need to charge your battery so often if you do the following:

- Close applications and data connections, for example, your Bluetooth connection, when not in use.
- Deactivate unnecessary sounds, such as touch screen and key tones.

Recycle

When this device has reached the end of its working life, all of its materials can be recovered as materials and energy. To guarantee the correct disposal and reuse, Nokia co-operates with its partners through a program called We:recycle. For information on how to recycle your old Nokia products and where to find collection sites, go to www.nokia.com/werecycle, or using a mobile device, nokia.mobi/werecycle, or call the Nokia Contact Center.

Recycle packaging and user guides at your local recycling scheme.

For more information on the environmental attributes of your device, go to www.nokia.com/ecodeclaration.

Product and safety information

Accessories



Warning:

Use only batteries, chargers, and accessories approved by Nokia for use with this particular model. The use of any other types may invalidate any approval or guarantee, and may be dangerous. In particular, use of unapproved chargers or batteries may present a risk of fire, explosion, leakage, or other hazard.

For availability of approved accessories, please check with your dealer. When you disconnect the power cord of any accessory, grasp and pull the plug, not the cord.

Network services and costs

Your device is approved for use on the WCDMA 2100/1700/900 MHz and GSM/EDGE 850/900/1800/1900 MHz networks. To use the device, you need a subscription with a service provider.

Using network services and downloading content to your device may result in data traffic costs. Some product features require support from the network, and you may need to subscribe to them.

Take care of your device

Handle your device, battery, charger and accessories with care. The following suggestions help you protect your warranty coverage.

- Keep the device dry. Precipitation, humidity, and all types of liquids or moisture can contain minerals that corrode electronic circuits. If your device gets wet, remove the battery, and allow the device to dry.
- Do not use or store the device in dusty or dirty areas. Moving parts and electronic components can be damaged.
- Do not store the device in high temperatures. High temperatures can shorten the life of the device, damage the battery, and warp or melt plastics.
- Do not store the device in cold temperatures. When the device warms to its normal temperature, moisture can form inside the device and damage electronic circuits.
- Do not attempt to open the device other than as instructed in the user guide.
- Unauthorized modifications may damage the device and violate regulations governing radio devices.
- Do not drop, knock, or shake the device. Rough handling can break internal circuit boards and mechanics.
- Only use a soft, clean, dry cloth to clean the surface of the device.
- Do not paint the device. Paint can clog the moving parts and prevent proper operation.
- Switch off the device and remove the battery from time to time for optimum performance.
- Keep your device away from magnets or magnetic fields.
- To keep your important data safe, store it in at least two separate places, such as your device, memory card, or computer, or write down important information.

During extended operation, the device may feel warm. In most cases, this condition is normal. If you suspect the device is not working properly, take it to the nearest authorized service facility.

Recycle

Always return your used electronic products, batteries, and packaging materials to dedicated collection points. This way you help prevent uncontrolled garbage disposal and promote the recycling of materials. Check product environmental information and how to recycle your Nokia products at www.nokia.com/werecycle, or with a cellular phone, [nokia](tel:nokia), [mobi](tel:mobi), or [werecycle](tel:werecycle).

About Digital Rights Management

When using this device, obey all laws and respect local customs, privacy and legitimate rights of others, including copyrights. Copyright protection may prevent you from copying, modifying, or transferring images, music, and other content.

Content owners may use different types of digital rights management (DRM) technologies to protect their intellectual property, including copyrights. This device uses various types of DRM software to access DRM-protected content. With this device you can access content protected with WMDRM 10 and OMA DRM 2.0. If certain DRM software fails to protect the content, content owners may ask that such DRM software's ability to access new DRM-protected content be revoked. Revocation may also prevent renewal of such DRM-protected content already in your device. Revocation of such DRM software does not affect the use of content protected with other types of DRM or the use of non-DRM-protected content.

Digital rights management (DRM) protected content comes with an associated license that defines your rights to use the content.

If your device has OMA DRM-protected content, to back up both the licenses and the content, use the backup feature of Nokia Ovi Suite.

Other transfer methods may not transfer the licenses which need to be restored with the content for you to be able to continue the use of OMA DRM-protected content after the device memory is formatted. You may also need to restore the licenses in case the files on your device get corrupted.

If your device has WMDRM-protected content, both the licenses and the content will be lost if the device memory is formatted. You may also lose the licenses and the content if the files on your device get corrupted. Losing the licenses or the content may limit your ability to use the same content on your device again. For more information, contact your service provider.

Some licenses may be connected to a specific SIM card, and the protected content can be accessed only if the SIM card is inserted in the device.

Batteries and chargers

Battery and charger information

This device is intended for use with a BL-4U rechargeable battery. Nokia may make additional battery models available for this device. Always use original Nokia batteries.

This device is intended for use when supplied with power from the following chargers: AC-10U . The exact charger model number may vary depending on the type of plug. The plug variant is identified by one of the following: E, X, AR, U, A, C, K, or B.

The battery can be charged and discharged hundreds of times, but it will eventually wear out. When the talk and standby times are noticeably shorter than normal, you need to replace the battery.

Battery safety

Always switch the device off and disconnect the charger before removing the battery. When you unplug a charger or an accessory, hold and pull the plug, not the cord.

When your charger is not in use, unplug it from the electrical plug and the device. Do not leave a fully charged battery connected to a charger, as overcharging may shorten the battery's lifetime. If left unused, a fully charged battery will lose its charge over time.

Always keep the battery between 15°C and 25°C (59°F and 77°F). Extreme temperatures reduce the capacity and lifetime of the battery. A device with a hot or cold battery may not work temporarily.

Accidental short-circuiting can happen when a metallic object touches the metal strips on the battery, for example, if you carry a spare battery in your pocket. Short-circuiting may damage the battery or the connecting object.

Do not dispose of batteries in a fire as they may explode. Dispose of batteries according to local regulations. Recycle when possible. Do not dispose as household garbage.

Do not dismantle, cut, open, crush, bend, puncture, or shred cells or batteries. If a battery leaks, do not let battery liquid touch skin or eyes. If this happens, immediately flush the affected areas with water, or seek medical help.

Do not modify, remanufacture, attempt to insert foreign objects into the battery, or immerse or expose it to water or other liquids. Batteries may explode if damaged.

Use the battery and charger for their intended purposes only. Improper use, or use of unapproved batteries or chargers may present a risk of fire, explosion, or other hazard, and may invalidate any approval or warranty. If you believe the battery or

charger is damaged, take it to a service center for inspection before continuing to use it. Never use a damaged battery or charger. Only use the charger indoors.

Additional safety information

Emergency calls

Make an emergency call

- 1 Ensure the device is switched on.
- 2 Check for adequate signal strength. You may also need to do the following:
 - Insert a SIM card.
 - Remove call restrictions you have activated for your device, such as call restriction, fixed dialing, or closed user group.
 - Ensure your device is not in an offline or flight profile.
 - If the device screen and keys are locked, unlock them.
- 3 To clear the display, press the end key as many times as needed.
- 4 Select **Telephone**.
- 5 Enter the official emergency number for your present location. Emergency call numbers vary by location.
- 6 Press the call key.
- 7 Give the necessary information as accurately as possible. Do not end the call until given permission to do so.



Important: Activate both cellular and internet calls, if your device supports internet calls. The device may attempt to make emergency calls both through cellular networks and through your internet call service provider. Connections in all conditions cannot be guaranteed. Never rely solely on any wireless device for essential communications like medical emergencies.

Small children

Your device, its battery and accessories are not toys. They may contain small parts. Keep them out of the reach of small children.

Medical devices

Operation of radio transmitting equipment, including wireless phones, may interfere with the function of inadequately protected medical devices. Consult a physician or the manufacturer of the medical device to determine whether they are adequately shielded from external RF energy. Switch off your device when regulations posted instruct you to do so, for example, in hospitals.

Implanted medical devices

Manufacturers of medical devices recommend a minimum separation of 15.3 centimeters (6 inches) between a wireless device and an implanted medical device, such as a pacemaker or implanted cardioverter defibrillator, to avoid potential interference with the medical device. Persons who have such devices should:

- Always keep the wireless device more than 15.3 centimeters (6 inches) from the medical device.
- Not carry the wireless device in a breast pocket.
- Hold the wireless device to the ear opposite the medical device.
- Turn the wireless device off if there is any reason to suspect that interference is taking place.
- Follow the manufacturer directions for the implanted medical device.

If you have any questions about using your wireless device with an implanted medical device, consult your health care provider.

Hearing



Warning:

When you use the headset, your ability to hear outside sounds may be affected. Do not use the headset where it can endanger your safety.

Some wireless devices may interfere with some hearing aids.

Your cellular device complies with FCC rules governing hearing aid compatibility. These rules require an M3 microphone or higher. The M value of your device microphone is marked on the device sales package. To determine the M-rating of your hearing aid and compatibility with this device, consult your hearing health professional. For more information about accessibility, see www.nokiaaccessibility.com.

To use a telecoil-equipped hearing aid with this device, activate the hearing aid (T switch) and the device telecoil. The sound quality depends on the type of your hearing aid.

Operating environment

This device meets RF exposure guidelines in the normal use position at the ear or at least 1.5 centimeters (5/8 inch) away from the body. Any carry case, belt clip, or holder for body-worn operation should not contain metal and should position the device the above-stated distance from your body.

To send data files or messages requires a quality connection to the network. Data files or messages may be delayed until such a connection is available. Follow the separation distance instructions until the transmission is completed.

Vehicles

Radio signals may affect improperly installed or inadequately shielded electronic systems in motor vehicles such as electronic fuel injection, electronic antilock braking, electronic speed control, and air bag systems. For more information, check with the manufacturer of your vehicle or its equipment.

Only qualified personnel should install the device in a vehicle. Faulty installation or service may be dangerous and may invalidate your warranty. Check regularly that all wireless device equipment in your vehicle is mounted and operating properly. Do not store or carry flammable liquids, gases, or explosive materials in the same compartment as the device, its parts, or accessories. Remember that air bags inflate with great force. Do not place your device or accessories in the air bag deployment area.

Switch off your device before boarding an aircraft. The use of wireless devices in an aircraft may be dangerous to the operation of the aircraft and may be illegal.

Potentially explosive environments

Switch off your device in any area with a potentially explosive atmosphere. Obey all posted instructions. Sparks in such areas could cause an explosion or fire resulting in bodily injury or death. Switch off the device at refueling points such as near gas pumps at service stations. Observe restrictions in fuel depots, storage, and distribution areas; chemical plants; or where blasting operations are in progress. Areas with a potentially explosive atmosphere are often, but not always, clearly marked. They include areas where you would be advised to turn off your vehicle engine, below deck on boats, chemical transfer or storage facilities and where the air contains chemicals or particles such as grain, dust, or metal powders. You should check with the manufacturers of vehicles using liquefied petroleum gas (such as propane or butane) to determine if this device can be safely used in their vicinity.

Certification information (SAR)

This cellular device meets guidelines for exposure to radio waves.

Your cellular device is a radio transmitter and receiver. It is designed not to exceed the limits for exposure to radio waves recommended by international guidelines. These guidelines were developed by the independent scientific organization ICNIRP and include safety margins designed to assure the protection of all persons, regardless of age and health.

The exposure guidelines for cellular devices employ a unit of measurement known as the Specific Absorption Rate or SAR. The SAR limit stated in the ICNIRP guidelines is 2.0 watts/kilogram (W/kg) averaged over 10 grams of tissue. Tests for SAR are

conducted using standard operating positions with the device transmitting at its highest certified power level in all tested frequency bands. The actual SAR level of an operating device can be below the maximum value because the device is designed to use only the power required to reach the network. That amount changes depending on a number of factors such as how close you are to a network base station.

The highest SAR value under the ICNIRP guidelines for use of the device at the ear is 1.18 W/kg .

Use of device accessories may result in different SAR values. SAR values may vary depending on national reporting and testing requirements and the network band. Additional SAR information may be provided under product information at www.nokia.com.

Your cellular device is also designed to meet the requirements for exposure to radio waves established by the Federal Communications Commission (USA) and Industry Canada. These requirements set a SAR limit of 1.6 W/kg averaged over one gram of tissue. The highest SAR value reported under this standard during product certification for use at the ear is 1.42 W/kg and when properly worn on the body is 1.04 W/kg .

Copyright and other notices

DECLARATION OF CONFORMITY

CE 0434

Hereby, NOKIA CORPORATION declares that this RM-720 product is in compliance with the essential requirements and other relevant provisions of Directive 1999/5/EC. A copy of the Declaration of Conformity can be found at http://www.nokia.com/phones/declaration_of_conformity/.

© 2011 Nokia. All rights reserved.

Nokia and Nokia Connecting People are trademarks or registered trademarks of Nokia Corporation. Nokia tune is a sound mark of Nokia Corporation. Other product and company names mentioned herein may be trademarks or tradenames of their respective owners.

Reproduction, transfer, distribution, or storage of part or all of the contents in this document in any form without the prior written permission of Nokia is prohibited. Nokia operates a policy of continuous development. Nokia reserves the right to make changes and improvements to any of the products described in this document without prior notice.



Java and all Java-based marks are trademarks or registered trademarks of Sun Microsystems, Inc.

This product is licensed under the MPEG-4 Visual Patent Portfolio License (i) for personal and noncommercial use in connection with information which has been encoded in compliance with the MPEG-4 Visual Standard by a consumer engaged in a personal and noncommercial activity and (ii) for use in connection with MPEG-4 video provided by a licensed video provider. No license is granted or shall be implied for any other use. Additional information, including that related to promotional, internal, and commercial uses, may be obtained from MPEG LA, LLC. See <http://www.mpegla.com>.

To the maximum extent permitted by applicable law, under no circumstances shall Nokia or any of its licensors be responsible for any loss of data or income or any special, incidental, consequential or indirect damages howsoever caused.

The contents of this document are provided "as is." Except as required by applicable law, no warranties of any kind, either express or implied, including, but not limited to, the implied warranties of merchantability and fitness for a particular purpose, are made in relation to the accuracy, reliability or contents of this document. Nokia reserves the right to revise this document or withdraw it at any time without prior notice.

Reverse engineering of software in the device is prohibited to the extent permitted by applicable law. Insofar as this user guide contains any limitations on Nokia's representations, warranties, damages and liabilities, such limitations shall likewise limit any representations, warranties, damages and liabilities of Nokia's licensors.

The availability of products, features, applications and services may vary by region. For more information, contact your Nokia dealer or your service provider. This device may contain commodities, technology or software subject to export laws and regulations from the US and other countries. Diversion contrary to law is prohibited.

The availability of Ovi services may vary by region.

FCC/INDUSTRY CANADA NOTICE

Your device may cause TV or radio interference (for example, when using a telephone in close proximity to receiving equipment). The FCC or Industry Canada can require you to stop using your telephone if such interference cannot be eliminated. If you require assistance, contact your local service facility. This device complies with part 15 of the FCC rules. Operation is subject to the following two conditions: (1) This device may not cause harmful interference, and (2) this device must accept any interference received, including interference that may cause undesired operation. Any changes or modifications not expressly approved by Nokia could void the user's authority to operate this equipment.

Some operations and features are SIM card and/or network dependent, MMS dependent, or dependent on the compatibility of devices and the content formats supported. Some services are subject to a separate charge.

9223462/Issue 1 EN-US