



motorola Bluetooth® Handsfree Headset



MOTOSTART

Get connected in 4 quick steps.

H670

Motorola, Inc.
Consumer Advocacy Office
1307 East Algonquin Road
Schaumburg, IL 60196

www.hellomoto.com
1-877-MOTOBLU
1-888-390-6456 (TTY/TDD United States for
hearing impaired)

Guide Number: 6809504A20-A

MOTOROLA and the Stylized M Logo are registered in the US
Patent & Trademark Office. The use of wireless devices and their
accessories may be prohibited or restricted in certain areas.
Always obey the laws and regulations on the use of these
products. The Bluetooth trademarks are owned by their
proprietor and used by Motorola, Inc. under license. All other
product or service names are the property of their respective
owners.

© Motorola, Inc. 2006.

BEFORE YOU BEGIN

Before using this product, read the Important Safety and Legal
Information pamphlet and follow its instructions.

Take a moment before you get started to
familiarize yourself with your new
H670 Headset.

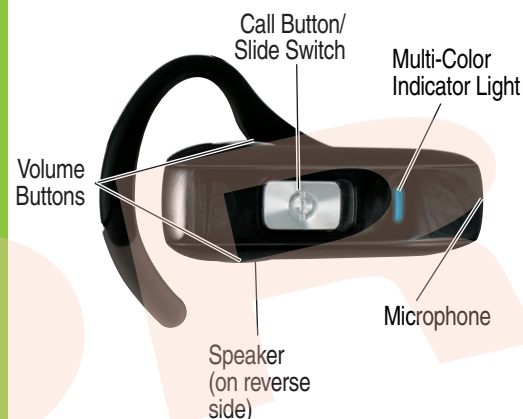

①

CHARGE

Your Headset's Battery



Charging
Port

- 1 Plug the Motorola charger into the end of
the headset.

The indicator light turns red when the
battery is charging. It may take up to 1
minute for the indicator light to turn on.
When the headset's battery is fully charged
(about 2 hours), the indicator light turns off.

- 2 Disconnect the charger.

Note: Headset is not functional while charging.

②

START BLUETOOTH FEATURE

Your Phone

Your phone's Bluetooth feature is off by default.
To use your headset, you must turn on the
Bluetooth feature in your phone.

For most Motorola phones (at the main menu):

- 1 Press **Menu** (Menu) > **Settings** > **Connection** >
Bluetooth Link > **Setup**.
- 2 Scroll to **Power**.
- 3 Select **Change**.
- 4 Scroll to **On**.
- 5 Press **Select** to turn on the Bluetooth
feature. The Bluetooth feature remains on
until you turn the feature off.

Note: These steps are for most Motorola phones.
For other phones, see your phone's user's guide.

③

PAIR

Your Headset

Before you can use your headset, you must pair
(link) it with your phone.

Step A - ENSURE HEADSET IS IN PAIRING MODE

Power on headset by sliding the Call button
towards the microphone to initiate easy
pairing. After a few moments, the indicator
light will be steadily lit in blue to indicate
headset is in pairing mode.

Indicator Light
(steadily blue
for pairing mode)



If the headset does not enter pairing mode,
see **TROUBLESHOOTING** for help.

③

PAIR CONTINUED

Your Phone

Step B - SET YOUR PHONE TO LOOK FOR YOUR HEADSET

For most Motorola phones:

- 1 On your Motorola phone, press **Menu** (Menu) >
Settings > **Connection** > **Bluetooth Link** >
Handsfree > **Look for Devices**.
- The phone lists Bluetooth devices it finds.
- 2 Select **Motorola H670**.
- 3 Select **OK** or **Yes** to pair your headset with
your phone.
- 4 Enter the passkey: **0000**
- 5 Select **OK**.

When your headset successfully pairs and
connects with your phone, the indicator light
changes from steadily lit to flashing blue.

Note: These steps are for most Motorola phones.
For other phones, see your phone's user's guide.

④

TEST AND USE

Your phone and headset are now paired and
ready to make and receive calls.
To make a call:

- 1 Place the headset over your ear.
- 2 On the phone, dial the number you want to
call and press **SEND** key on your phone.
- 3 If your phone and headset are successfully
paired, you will hear ringing on the headset.

After you have successfully paired your
phone and headset, you don't need to
repeat these steps. For daily use, ensure
that your headset is turned ON and that
your phone's Bluetooth feature is ON.

To save battery power, turn OFF the
headset when you don't use it for an
extended time by sliding the switch
towards the charging plug.

USING YOUR H670

See
**Features and
Functions Guide**
on the reverse side
for information on
using your H670

Note: If desired, your headset can be restored to original
factory settings. This action will erase all pairing information
stored in your headset. Thus, you will need to pair your
phone and headset again (see step 3).

To restore your headset to original factory settings, press
and hold both Volume buttons and the Call button at the
same time for 10 seconds.

TROUBLESHOOTING

My headset will not enter pairing mode.

Make sure that any devices previously paired
with the headset are turned off. If the indicator
light is not steadily lit in blue, turn off both the
other device and headset, wait 10 seconds,
then turn headset back on. Wait for the indicator
light to become steadily lit in blue, indicating
the headset is now in pairing mode.

My phone doesn't find my headset.

Make sure the indicator light on your headset is
on (lit in blue) and steady when your phone is
searching for devices (see step 3).

My headset worked before but now it's not working.

Make sure your phone is on and the Bluetooth
feature is turned on in your phone (see step 2).
If the Bluetooth feature was turned off or was
turned on only temporarily, you may need to
restart the Bluetooth feature (see step 2) and
pair your phone and headset again (see step 3).

Support.

If you need more help, contact us at
1-877-MOTOBLU or visit us at
www.hellomoto.com/Bluetoothsupport

Features and Functions Guide

H670
Bluetooth®
Handsfree Headset

IMPORTANT:
Be sure to first follow the **MOTOSTART** Quick Start Guide on the reverse side of this guide to complete initial setup of your H670.

European Union Directives Conformance Statement

- CE** Hereby, Motorola declares that this product is in compliance with:
- The essential requirements and other relevant provisions of Directive 1999/5/EC.
 - All other relevant EU Directives.

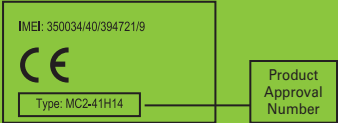

The above gives an example of a typical Product Approval Number.

You can view your product's Declaration of Conformity (DoC) to Directive 1999/5/EC (to R&TTE Directive) at www.motorola.com/rtte. To find your DoC, enter the product Approval Number from your product's label in the "Search" bar on the web site.

TURNING HEADSET ON AND OFF

To turn your headset on, slide the switch toward the microphone. The indicator light is steadily purple for several seconds, then flashes blue (if paired and connected with another device) or is steadily blue (if ready to be paired).

To turn your headset off, slide the switch toward the charging plug. The indicator light will turn off.



EARHOOKS AND YOUR HEADSET

Your H670 headset is supplied with multiple earhooks. The earhook is attached onto a hinge pin, and is placed onto your ear when using your headset. To install an earhook on your headset:

- 1 Open the attached earhook 90 degrees from the headset.
- 2 Gently lift and pull the top of the earhook up and off the upper hinge pin. Then, pull it away to remove it.
- 3 Position the headset for right or left ear use (right ear use is displayed).
- 4 Hook the bottom of the earhook onto the lower hinge pin, then lift and pull the top of the earhook over the upper hinge pin.

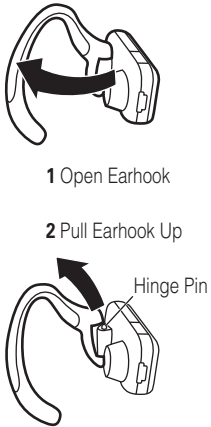

WEARING THE HEADSET

Once you have attached your desired earhook, follow these steps to wear your headset on your ear:

- 1 Open the attached earhook 45 degrees from the headset.
- 2 Loop the earhook over your ear.
- 3 Press earhook to your ear.

When worn, your headset will look like this on your head:

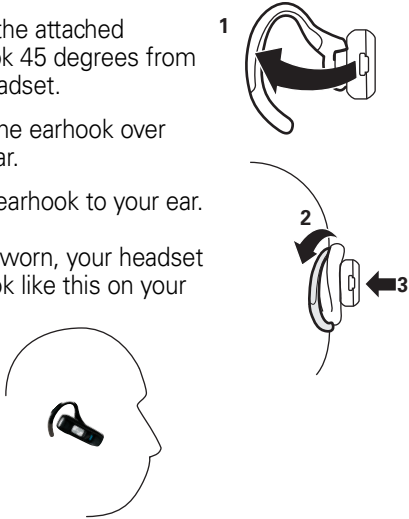

CHANGING VOLUME BUTTON ORIENTATION

You can also change the orientation of the volume buttons on your headset.

- 1 Turn the headset power off.
- 2 Press and hold the Volume button you want to assign as the "volume up" button and slide the switch toward the microphone. The indicator light is either steadily lit or flashing in blue.



MAKING CALLS

Function	Action
Receive a call	Tap the Call button
Mute or unmute a call	Tap both Volume buttons
Reject a call	Press and hold a Volume button until you hear two ascending tones
End a call	Tap the Call button
Redial last call	Press and hold the Call button until you hear two ascending tones
Make a voice dial call	Tap the Call button and speak the name after the tone

Note: Your H670 supports both Handsfree and Headset Profiles. Accessing call functions depends upon which profile your phone supports. See your phone's user's guide for more information.

MAKING CALLS *CONTINUED*

Function	Action
Answer a second incoming call	Tap the Call button
End an active call and resume a call on hold	Tap the Call button
Disable the indicator light	First slide the switch toward charging plug (to turn headset off), then press and hold both Volume buttons AND slide the switch towards the microphone (to turn headset on)

Note: Some features are phone/network dependent.

INDICATOR LIGHTS

With the Charger Plugged In

Headset Indicator	Headset Status
Steady red	Charging
Off	Charging complete

With No Charger Plugged In

Headset Indicator	Headset Status
Off	Power off
Steady purple	Powering up
Steady blue	Pairing/connection mode
10 rapid purple flashes	Connection successful
Slow blue flash	Standby (not on call)
Quick blue flash	Incoming call
Slow blue pulse	Connected (on a call)
Slow purple pulse	Connected (on a muted call)
Red flash	Idle (not connected)
Quick red flash	Low battery

Note: After 30 minutes of inactivity, the light stops flashing to conserve power, but the headset remains in standby mode.

AUDIO TONES

Audio Tone	Headset Status
Ring tone	Incoming call
Single high tone	Pairing confirmation
High to low tone	End call / phone network not available
Single high tone when pressing volume button	Volume at minimum or maximum
Two ascending tones	Mute enabled
Two descending tones	Mute disabled
Low to high tone	Voice activation
No audio indications; deteriorating quality	Out of range
Two tones repeated every 60 sec.	Low battery