

Panasonic®



Operating Instructions
使用说明书

Ladies Epilator
女用脱毛器

Model No. ES2058

型号 ES2058

Contents

English	2
中文	10
保修证	18

Before operating this unit, please read these instructions completely and save them for future use.

在使用前，请仔细阅读此说明书并妥善保管，以备将来参考。

Parts identification

English

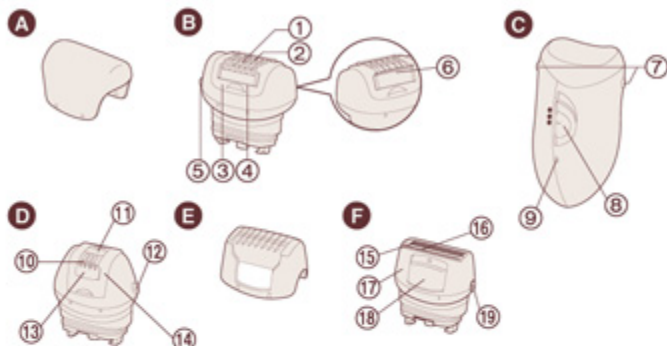

- A** Protection cap
- B** Epilation head for legs/arms
 - ① Epilation discs (inside)
 - ② Skin protector (metal part on the outside)
 - ③ Legs/arms frame
 - ④ Foam keeper
 - ⑤ Frame release button
 - ⑥ Foam wiper
- C** Main body
 - ⑦ Head release button
 - ⑧ On/off switch
 - ⑨ Charging light
- D** Epilation head for underarms/ bikini-line
 - ⑩ Epilation discs (inside)
 - ⑪ Skin protector (metal part on the outside)
 - ⑫ Frame release button
 - ⑬ Foam keeper (on both sides)
 - ⑭ Underarms frame
- E** Bikini comb

- F** Shaver head
 - ⑮ Outer foil
 - ⑯ Trimmer
 - ⑰ Frame
 - ⑱ Pop-up trimmer switch
 - ⑲ Frame release button

Accessories:
 Charger (RE7-44), cleaning brush and pouch
 (Please do not use accessories any other than the accessories provided.)

► Before use

- Make sure skin is clean before and after use. Failure to do so might cause infection and inflammation.
- Do not use the appliance if you have eczema, rashes, sensitive skin, proneness to infections, varicose veins, diabetes, hemophilia or poor blood clotting or other skin conditions.
- Using just before swimming and sports activities or sharing with other persons might result in bacteria entering the skin and causing damage and inflammation.
- Turning on the appliance without an epilation or shaver head attached might cause finger injury, hair entanglement in the spinning gears or mechanical malfunction.
- The followings might cause sensitive skin damage, injury, inflammation, pain, bleeding, and severe pain.
 - Using the appliance if the epilation discs, the skin protector or the outer foil have been damaged.
 - Using on or near your face, genitals, warts, pimples, bruises, rashes, wounds or loose skin.
 - Applying strong pressure to the skin, repeatedly moving over the same area or using a jabbing motion.
 - Using before or during menstruation, pregnancy, about one month after giving birth, when ill and when your skin is sunburned etc.

The appliance can be used for wet or dry epilation. The following is the symbol for a wet epilator. It means that the appliance can be used in a bath or shower.

**► Safety precautions**

- Never use the charger in the bathroom.
- Always ensure the appliance is used on an electric power source matched to its rated voltage.
- Do not bend, twist, pull or modify the cord.
- Do not wrap the cord tightly around the appliance.
- Never use the appliance if the cord or the charger is damaged or overly hot or if the plug fits loosely in a household outlet.
- Regularly clean the cord connector to prevent dust.
- Do not drop or hit the appliance as the skin protector or the epilation discs can be damaged.

- The movement of the discs makes some noise but this is perfectly normal.
- Keep the appliance out of the reach of children or invalids.
- Do not leave the appliance near sinks, bathrooms or other high-humidity areas where it could be exposed to water and moisture after use.
- The followings might cause mechanical malfunction.
 - Using nail polish remover, benzene, alcohol, etc. to clean the appliance.
 - Leaving the appliance where it will be exposed to high temperatures or direct sunlight.
- Contact an authorized service center if the epilator or the cord get damaged.

Before use

Changing the head

1. Remove the head while holding the head release button.
2. Push the head until it clicks.

Charging

Charging the appliance

1. Plug the charger into the epilator (a) and a household outlet (b).
2. Charge the appliance for approximately 12 hours. (The charging light stays on even after 12 hours.)
 - The epilator can be used for approximately 30 minutes after 12 hours charge.
- When the appliance is being charged for the first time or when it has not been used for over 6 months, charge for approximately 20 hours.
- The charge light may not come on after a few minutes in some cases. However, it will come on eventually if you continue charging.
- The appliance can be left plugged in after it is fully charged without deteriorating the battery life.
- If the appliance is repeatedly charged before the batteries are completely discharged, battery life may deteriorate. (Memory effect)
- Charge and use the appliance in a temperature between 5 - 40 °C.
- The charger can be positioned in a vertical or horizontal position.



Do not use the epilation head for legs/arms to epilate your underarms and bikini-line.

- Trim your hair before epilating for the first time or if you have not epilated for a long time.
- If you use the appliance in temperature of 15 °C or less, the operating time might be reduced.

- 1. Wet your skin.**
- 2. Remove the cap and attach the head you wish to use.**
- 3. Wet the discs and place a small quantity of liquid body soap on the discs.**
- 4. Turn the switch on to the 1 or 2 position and then epilate.** (1=low speed epilation/2=high speed epilation)
 - Foam makes the epilator slide better, so you can move it fast. Always wash the discs well after use to remove any residual soap.

Dry epilation

You can also epilate without wetting your skin or the discs.

Apply the epilator at a right angle to your skin and press gently while moving it slowly against the hair growth.

- When using the appliance, pull your skin taut where the area is prone to sagging (on the inside of the knees and elbows).
- Rub your skin to lift short hair.
- Move the epilator with the side that has the foam keeper facing the front.
- Do not remove the frame of the epilation head.
- Do not use if your hair is longer than 5 mm.
- Reddening might appear for your first use. Cool towel will help if you feel pain or there is a rash.
- We recommend regular use of massage sponges or exfoliation to prevent ingrown hair.



Moving the appliance correctly

- ① Legs: Upwards from the bottom of the leg.
- ② Arms: Inwards from the outside of the arm.
- ③ Upper arms: Upwards from the bottom of the upper arms.
- ④ Underarms: Move in several directions as underarm hair grows in different directions.



Shaving

Wet/foam shaving

1. Attach the shaver head.

2. Wet your skin.

- Shaving with soap lather makes the skin slippery for a closer shave.
- Do not use shaving cream, skin cream or skin lotion as it will clog the blades.

3. Turn the switch on to the 1 or 2 position.

- (1=low speed shaving/2=high speed shaving)
- Hair removal is easier and less painful when the hair is short.
 - Slide the pop-up trimmer switch up to cut long hair.
 - Press gently so that the whole of the blade is in close contact with the skin and the surface of the blade does not move up and down.

Shaving the bikini line with the bikini comb

Place the bikini comb onto the shaver head and slide trimmer up.

- When the bikini comb is in place, make sure the comb is in close contact with the skin.

Dry shaving

You can also shave without wetting your skin or the discs.

Switch off and unplug the appliance before cleaning.

- Always unplug the charger from a household outlet and from the epilator before cleaning the appliance.
- Wipe the main body only with a damp cloth. The use of alcohol etc. might cause discoloration or deformation of the main body.
- Always attach the caps when storing the epilator.

Washing your epilator

Always clean the frames and discs after use to keep them in a hygienic state.

- Take care not to damage the skin protector during cleaning.

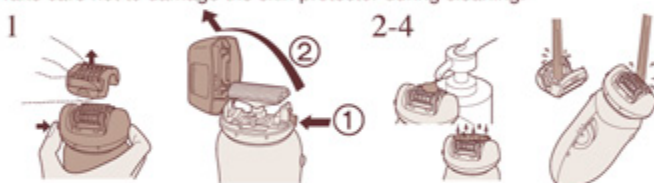

1. Remove the frame by pushing the frame release button.
2. Apply liquid hand soap to the discs and blade.
3. Turn the switch on and then wet the discs to create foam.
4. Wash the head with water to clean hair.
 - Do not use hot water.
 - If soap is not completely washed away, then a white deposit can accumulate and prevent the blades from moving smoothly.
5. Turn the switch off, wipe the appliance with a dry cloth and dry it well.

Cleaning your epilator with the supplied brush

You can also clean the **epilation head** and the **shaver head** with the cleaning brush.



Replacing**Replacing the outer foil**

Replace the shaving foil and the inner blade when you notice reduced shaving performance. Never remove the outer foil of the shaver head for any other reason than to change it.

Removing the outer foil

While pushing the outer foil gently with the fingers, use a fingernail to release the plastic panel (b) on the blade from the catches (a) on the inside of the frame.

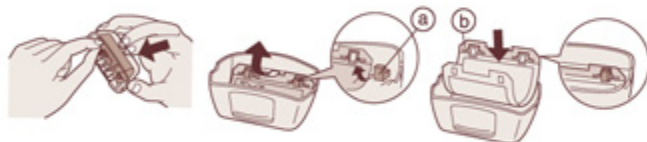
**Fitting the new outer foil**

Hold the outer foil so that the surface with the plastic panel (b) (i.e. the surface that will come into contact with the inner blade) faces upward and then insert it into the frame so that the catches (a) on the frame fit into the holes on the foil.

- We recommend replacing the outer foil every year and the inner blade every two years.

For environmental protection and recycling of materials

This epilator contains Ni-MH batteries.

Please make sure that the battery is disposed of at an officially assigned location, if there is one in your country.

Removing the built-in rechargeable batteries

The batteries in this epilator are not intended to be replaced by consumers. However, they can be replaced at an authorized service center.

The procedure below shows how to remove the batteries so that they can be disposed of.

- Unplug the charger from the epilator before disassembling it.
- Turn the switch on to the 1 or 2 position until the batteries are completely discharged.
- Using a screwdriver, disassemble the unit in the following order.
- Please take care not to short-circuit the batteries.

Perform steps ① to ⑧ to disassemble the epilator.

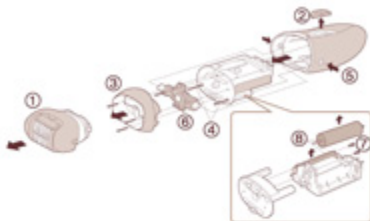

English

Specifications

Power supply	AC 220 - 240 V, 50-60 Hz
Charging time	12 hours
Batteries	Ni-MH
Power consumption	Approx. 1 W (When charging.)
Weight	Epilator (Approx. 185 g with the epilation head) (Approx. 170 g with the shaver head)

Subject to change without notice.

This product is intended for house-hold use only.

READ ALL INSTRUCTIONS BEFORE USE

各部件名称

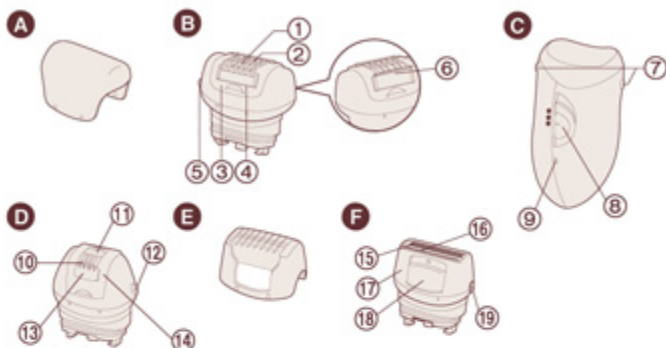

A 保护盖

B 手臂/腿部脱毛刀头

- ① 脱毛夹轮 (内部)
- ② 柔肤倍护装置 (表面的金属部分)
- ③ 手臂/腿部脱毛架
- ④ 起泡器
- ⑤ 脱毛架装卸按钮
- ⑥ 去泡滚轴

C 本体

- ⑦ 刀头装卸按钮
- ⑧ 电源开关
- ⑨ 充电指示灯

D 腋下/比基尼线脱毛刀头

- ⑩ 脱毛夹轮 (内部)
- ⑪ 柔肤倍护装置 (表面的金属部分)
- ⑫ 脱毛架装卸按钮
- ⑬ 起泡器 (两侧)
- ⑭ 腋下脱毛架

E 比基尼剃毛附件

F 剃毛刀头

- ⑮ 外刀网
- ⑯ 推出式修剪刀
- ⑰ 剃毛架
- ⑱ 推出式修剪刀开关
- ⑲ 剃毛架装卸按钮

附属品：

充电器(RE7-44)，清洁刷和携带用小包
(请勿使用所提供附属品以外的其他物品)

► 使用前

- 使用前确保皮肤清洁，否则皮肤可能会感染或发炎。
 - 如果患有湿疹或其他皮肤病、皮疹、过敏性皮肤、易受感染、静脉曲张、糖尿病、血友病或凝血不良，请勿使用本产品。
 - 在游泳和体育运动前使用，或与他人共用本产品，均可能会导致细菌侵入皮肤，造成皮肤损伤或发炎。
 - 在没有装上脱毛刀头或剃毛刀头的状态下打开电源开关，可能会导致手指损伤，毛发卷入转齿轮或发生机械故障。
 - 以下情况可能会导致敏感性皮肤损伤、发炎、疼痛、流血、过敏或剧痛。
 - 当脱毛夹轮、柔肤倍护装置或外刀网损坏时使用本产品。
 - 在脸部、外阴部、疣、丘疹、瘀伤或脱皮处使用本产品。
 - 对皮肤施加过大的压力，反复在同一处移动或猛戳皮肤。
 - 在经期前或经期、孕期、产后约一月内、生病及皮肤被晒伤等情况下使用。
- 本产品可干湿两用。下图标志说明此脱毛器可以在入浴或淋浴时使用。



► 安全注意事项

- 充电状态下的脱毛器禁止在浴室使用。
 - 脱毛器必须使用与其额定电压相匹配的电源。
 - 请勿折弯、缠绕、拉扯或改装电源软线。
 - 请勿将电源软线紧紧缠绕在本产品上。
 - 当电源软线或充电器损坏或过热时，或者家用电源插座松动时，切勿使用本产品。
 - 定期清洁脱毛器端的电源软线插头，防止灰尘或细微异物如别针等附着在上面。
 - 请勿掉落或重击本产品，否则柔肤倍护装置或脱毛夹轮可能损坏。
 - 夹轮运动时会产生一些噪音，但这是完全正常的现象。
 - 请将本产品置于儿童触摸不到的地方。
 - 使用后请勿将本产品置于水池、浴室或其他有水或湿气下的高湿度区域附近保管。
 - 以下情况可能导致机械故障。
 - 使用指甲水、汽油、酒精等来清洁脱毛器。
 - 将脱毛器放置在高温或直射阳光的地方。
 - 如果脱毛器损坏，请联系松下电器指定的维修中心。
 - 充电器的电源软线不能更换，如果电源软线损坏，此充电器应废弃。
- 警告：脱毛器须与电源软线分离后才能用水清洗。

使用前

更换刀头

1. 按住本体两侧的刀头装卸按钮，卸下刀头。
2. 装入刀头直至其“咔嚓”一声入位固定。

充电方法

给脱毛器充电

1. 将充电器一端插入脱毛器 (a)，另一端插入家用电源插座 (b)。
2. 充电约12个小时。(充电指示灯在12小时后仍会保持亮灯。)。
 - 脱毛器在充电12小时后可使用约30分钟。
 - 脱毛器首次充电或超过6个月未使用，需充电约20个小时。
 - 在特殊情况下，当接上电源线开始充电时，充电指示灯在最初数分钟无法亮起。如出现这种情况，请在接上电源线的状态下放置一段时间，充电指示灯会随即亮起。
 - 脱毛器完全充电后插头可以不拔出来留在电源插座里，它不会影响电池寿命。
 - 如果在未完全消耗完电量前反复充电，会影响电池寿命。(记忆效应)
 - 建议充电环境的温度介于5-40℃。
 - 充电器可以直立或水平放置。
3. RE7-44充电器只能与本产品配合使用，不能用于其它的产品或用途。

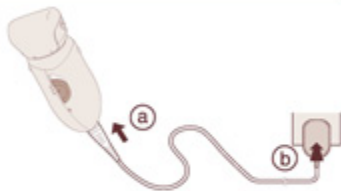

请勿使用手臂、腿部脱毛刀头进行腋下和比基尼线的脱毛。

- 在首次脱毛或者已经长期未脱毛时请先进行剃毛。
- 在15℃或更低温度下使用本产品时，操作时间会缩短。

1. 弄湿皮肤。
 2. 取下保护盖，装上想要使用的刀头。
 3. 弄湿夹轮，将少量沐浴露涂在夹轮上。
 4. 将电源开关推到1或2位置，然后开始脱毛（1=低速脱毛/2=高速脱毛）
- 泡沫会使脱毛器更好的滑动，从而快速地移动脱毛器。使用后必须将刀头充分清洗，以清除残留物。

干式脱毛

也可以不弄湿皮肤或刀头来脱毛。

以垂直皮肤表面的方向，轻轻按住皮肤，逆着毛发的生长方向缓缓移动。

- 处理皮肤比较松弛的部位时(如膝盖或肘部内侧)，需拉伸皮肤，使皮肤平直后再使用本产品。
- 揉擦皮肤，使短的毛发竖起。
- 请勿卸下脱毛刀头的脱毛架。
- 请勿用于处理超过5毫米的毛发。
- 初次脱毛可能出现红斑点。如果感到疼痛或出现疱疹，可用冷毛巾进行冷敷。
- 建议经常使用按摩海绵或祛死皮素，防止毛发向皮内生长。



C 正确地移动脱毛器

- ①腿部：从下向上移动。
- ②臀部：从臀部外侧向内移动。
- ③上臂：从下向上移动。
- ④腋下：上下左右移动，因为腋下毛发向不同方向生长。



剃毛刀头的使用方法

湿/泡沫剃毛

1. 装上剃毛刀头。

2. 弄湿皮肤。

- 肥皂泡沫会使皮肤光滑，从而使剃毛刀头更紧贴皮肤。
- 请勿使用剃毛膏、面霜或化妆液，否则可能阻碍刀片。

3. 将电源开关推到1或2位置。

(1=低速剃毛/2=高速剃毛)

- 剃短毛更容易，而且疼痛感较少。
- 滑出推出式修剪刀剃除长毛。
- 轻轻按压，使整个刀头与皮肤紧密接触，这样刀面不会上下移动。

C 使用比基尼剃毛附件整理比基尼线

将比基尼剃毛附件安装在剃毛刀头上，并将推出式修剪刀开关向上滑动。

- 请确保比基尼剃毛附件紧贴皮肤。

C 干式剃毛

也可以不弄湿皮肤或夹轮来剃毛。

清洗前关闭脱毛器电源开关并拔除电源插头。

- 清洁脱毛器前，务必将充电器从家用电源插座和脱毛器中拔出来。
- 可用蘸水的湿布擦拭机身，使用酒精等可能会导致机身褪色或变形。
- 存放脱毛器时必须装上保护盖。

清洗脱毛器

使用后必须清洗脱毛架和脱毛夹轮，使其保持清洁。

- 清洁时注意不要损坏柔肤倍护装置。



1. <脱毛刀头>

按住有脱毛架装卸按钮的一侧可卸下脱毛架。

<剃毛刀头>

按住有剃毛架装卸按钮的一侧可卸下剃毛架。

2. 将洗手液涂在夹轮及刀头上。
3. 打开开关，然后弄湿夹轮以制造泡沫。
4. 用水清洗刀头，以清除毛发。
 - 请勿使用热水。
 - 如果清洗液体没有完全冲洗掉，会形成白色沉淀，阻止刀头平滑移动。
5. 关闭开关，用干布擦干本产品。

使用所提供的清洁刷来清洁脱毛器

另可使用清洁刷清洁脱毛刀头和剃毛刀头。



如果发现剃毛刀头的剃毛性能下降，请更换剃毛外刀网和内刀头。除非更换需要，禁止因其他原因取下剃毛刀头的外刀网。

取下外刀网

当用手指轻轻推动外刀网时，用指甲将刀头上的塑料嵌板⑥从刀架内侧的钩子⑤上脱开。

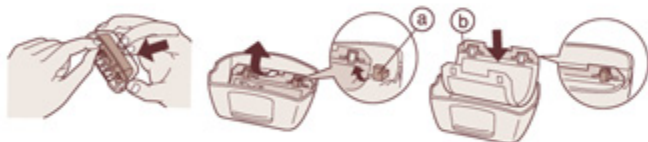

装上新的外刀网

轻轻捏住外刀网，使带塑料嵌板⑥的一面(即与内刀头相接触的一面)朝下放置，然后将其插入刀架，使刀架上的钩子⑤勾入外刀网上的孔洞。

• 我们建议外刀网每年更换一次，内刀头每两年更换一次。

环境保护和资源回收

此脱毛器使用镍氢(Ni-MH)电池。

如果您的国家有相关规定，请务必在指定处对旧电池进行统一处理。

取出内置的可充电电池

- 本机内藏有可充电的电池，在您决定废弃本机时，一定要事先将电池从机器中取出。
- 分解器具，取出电池前，一定要断开电源。
- 建议您在决定废弃器具前，事先征求经销商或本公司指定维修点的意见，尽量延长器具的使用寿命。
- 当您决定废弃器具又不想自行分解机器取出电池时，建议您将器具送往本公司指定的维修店，由维修店对电池进行分解和回收。
- 下列步骤示范如何取出电池以便处理。
 - ①拆卸前，将充电器从脱毛器中拔出来；
 - ②把电源开关推到1或2位置，直至脱毛或剃毛刀头完全停止后，将开关拆卸；
 - ③使用螺丝刀按①至⑥的图解拆卸脱毛器；
 - ④请小心不要让电池碰到任何物体而短路。
- 电池务必废弃于政府规定的地方或回收处理单位。

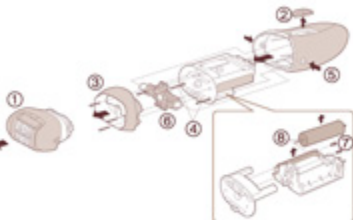

规格

额定电压	交流 220 - 240 V, 50-60 Hz
充电时间	12 小时
电池	镍氢(Ni-MH)电池2枚
额定功率	约1W (充电时)
重量	脱毛器 (约185g, 带脱毛刀头) (约170g, 带剃毛刀头)

执行标准：GB4706.1附录B、GB4706.9、Q/(GZ)PEWWBG 6

若有变动，恕不另行通知。

本产品仅限家庭使用，使用前请仔细阅读说明书所有内容。

Panasonic

保 修 证

保修条款

有关保修期内Panasonic商品的保修(无偿修理),自购入之日起开始实施。

1.保修期内的商品只可在松下维修店进行保修;保修时,请出示本保修证及购机发票。

以下两点需特别注意:

a.本保修证遗失后不再补发,请妥善保管;

b.本保修证仅限于中华人民共和国国内有效(但香港、澳门、台湾三地暂不可使用)。

2.自购入之日起在以下期间内,在正常使用中发生故障的情况下进行保修。

a.整机2年内无偿;

b.专业理发器6个月内无偿;

c.附件:刀头、刀网、替刃、修剪刀有偿提供。

3.属下列情况之一者,即使在保修期内,也不能以保修对待,但是可以实行收费修理:

a.未按商品使用说明书要求使用、维护、保管而造成损坏的;

b.因不正确操作、电源不正常、破损(如:摔落等)而造成损坏的;

c.不经松下认定维修店维修人员拆动造成损坏的;

d.不能出示本保修证及有效购机发票的;

e.保修证上记录的信息与商品实物标识不符或者涂改的;

f.因不可抗力因素(如雷电、地震、火灾、水灾等)造成损坏的。

4.本保修条款只适用于消费者个人为生活需要而购买使用的场合,不适用于经营性等使用。

松下电器顾客咨询服务中心: 800-810-0781

手机/小灵通/未开通800业务地区: 400-810-0781

松下电器网站: <http://panasonic.cn>

松下电器(中国)有限公司

Panasonic

商品信息 / 销售记录 (未完整记录以下信息将可能无法进行保修)

商品名称	女用脱毛器	商品型号	ES2058
制造编号		产地	中国
销售日期		发票号码	
顾客姓名		联系电话	
顾客地址		邮编	
销售店名称		销售店电话	
销售店地址		邮编	

维修记录

维修店名称		联系电话		送修日	
维修店地址				邮编	
故障内容		故障原因			
维修内容					
维修员签字		交验日期			

维修店名称		联系电话		送修日	
维修店地址				邮编	
故障内容		故障原因			
维修内容					
维修员签字		交验日期			

维修店名称		联系电话		送修日	
维修店地址				邮编	
故障内容		故障原因			
维修内容					
维修员签字		交验日期			

本保修证内容如有变更恕不另行通知。

松下电工・万宝电器（广州）有限公司 (PEWWBG)
Panasonic Electric Works Wanbao (Guangzhou) Co.,Ltd.

工厂地址：广州市番禺区市广路万宝基地

(Address): Wanbao Base, Shiguang Road, Panyu District, Guangzhou

电话 (Tel): (020)84770333

传真 (Fax): (020)84773033

邮政编码 (Post Code): 511495