

## BEFORE YOU BEGIN

**NOTE:** The lavatory shown in this guide may differ from your actual product. The installation steps still apply.

- Observe all local plumbing and building codes.
- Inspect the drainage and supply tubing; Replace if necessary.
- Prior to installation, unpack the new lavatory and carefully inspect it for damage. Return the lavatory to its protective carton until you are ready to install it.
- For replacement installations, make sure the existing cutout is the same or smaller size as the new lavatory.
- If possible, assemble the faucet and drain to the lavatory before installing the lavatory.
- Kohler lavatory is made according to American National Standard that it can match the American lavatory fittings. Any other lavatory fittings may not fit for kohler lavatory.

## 安装之前

注意：本安装说明中展示的脸盆可能与您实际购买的产品不同。请放心，其中的安装步骤仍可适用。

- 留意当地所有给排水及建筑规定。
- 检查排水管及供水管。如有需要请更换。
- 安装之前，先开启新脸盆的包装，并小心检验新的脸盆是否有损坏，再将新的脸盆放回包装盒内，到安装时才取用。
- 若为更换新脸盆，须确保现有的柜台孔口与新脸盆的切割位相同或者较后者小。
- 如果可能，在安装脸盆之前先组装脸盆上的龙头和排水管。
- 科勒洗脸盆是根据美国标准制造的，与美式洗脸盆配件相配。其它洗脸盆配件可能与之不相配。

## TOOLS AND MATERIALS

## 所需工具和材料

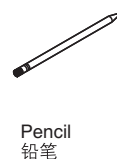
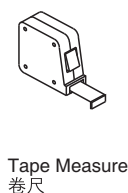

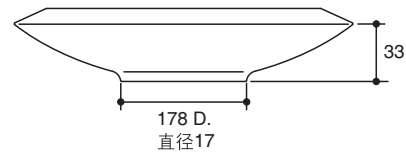
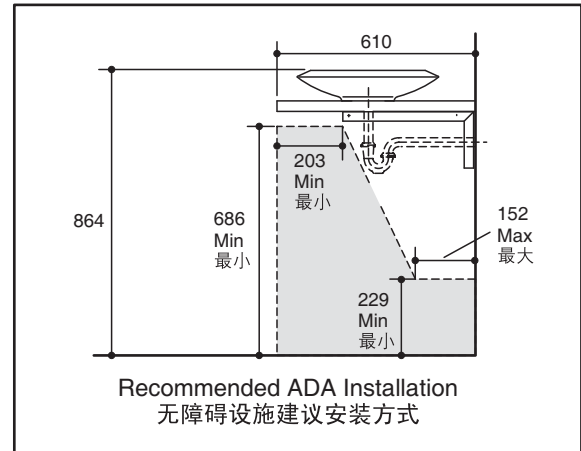
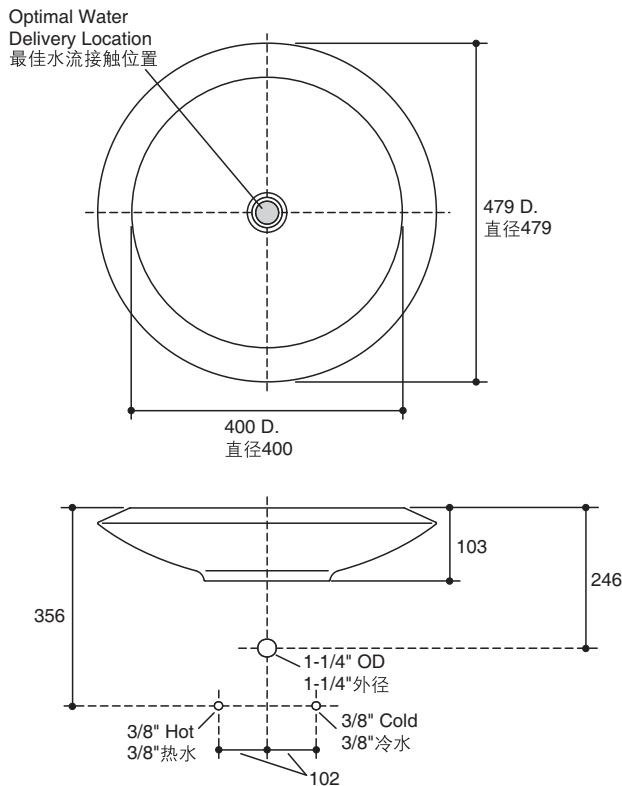

## INSTALLATION

### 1. Install the Lavatory

- CAUTION: Risk of product damage.** Do not overtighten drain connection.
- CAUTION: Risk of product damage.** Ensure the foam gasket provided with the lavatory is properly positioned under the drain flange.

**IMPORTANT!** The drain must be installed using the foam gasket and O-ring provided with the lavatory. Do not use the gasket supplied with the drain.

- Trace the lavatory drain hole onto the countertop.
- Remove the lavatory and set aside.
- Drill a 41mm hole, at the marked location.
- Discard the gasket supplied with the drain.
- Slide the foam gasket onto the drain body.
- Insert the drain body into the lavatory drain hole.
- Roll the O-ring onto the drain body. Roll the O-ring up the drain body until it is seated in the underside of the lavatory.
- Align the lavatory and drain body assembly with the drain hole in the countertop. Lower the drain body through the countertop drain hole until the lavatory rests on the countertop.
- Slide the washer onto the drain body.
- Thread the nut onto the drain body.
- Tighten the nut until secure, making sure the drain is properly centered in the lavatory. Do not overtighten.

## 安装

### 1. 安装脸盆

- 小心：产品损坏危险。** 连接处请勿过度上紧。
- 小心：产品损坏危险。** 将白色泡沫垫放在台面上的安装位置。

**重要！** 可将附带的白色泡沫垫放在台面上，衬托脸盆的颜色。如果您希望连同泡沫垫一起安装，请格外注意在定位落水孔位置时请勿损坏泡沫垫，或在泡沫垫上做标记。

- 在台面上勾画落水孔的位置。
- 移除泡沫垫，放在一边。
- 在标记的位置钻一个41mm的孔。
- 丢弃落水附带的垫圈。
- 将泡沫垫圈套在落水本体上。
- 将落水本体插入脸盆的落水孔中。
- 将O型圈套在落水本体上，不断将O型圈向上套直至其位于脸盆底部。
- 通过台面上的落水孔对齐脸盆和落水本体组件。将落水本体慢慢降低，穿过台面上的落水孔，直至整个脸盆坐在台面上。
- 将垫圈套在落水本体上。
- 将螺母套在落水本体上。
- 紧固螺母，确认落水位于脸盆的正中。请勿过度上紧。

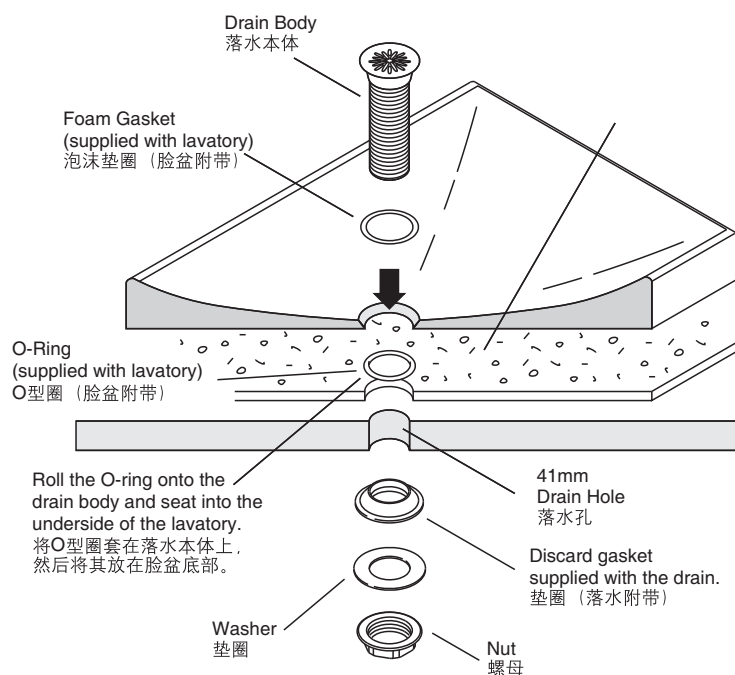

## 2. Complete the Installation

**IMPORTANT!** When installing the faucet, the water should contact the lavatory in the area shown in the diagram for best performance.

- Apply a thin bead of clear silicone sealant where the lavatory meets the countertop.
- Install the faucet following the faucet manufacturer's instructions.

## 2. 完成安装

**重要！** 安装龙头时，水流接触脸盆的位置应该位于如图所示的位置，这样才表明龙头和脸盆的安装位置恰当。

- 在脸盆与台面的接触位置涂上密封硅胶。
- 根据龙头说明书安装龙头。

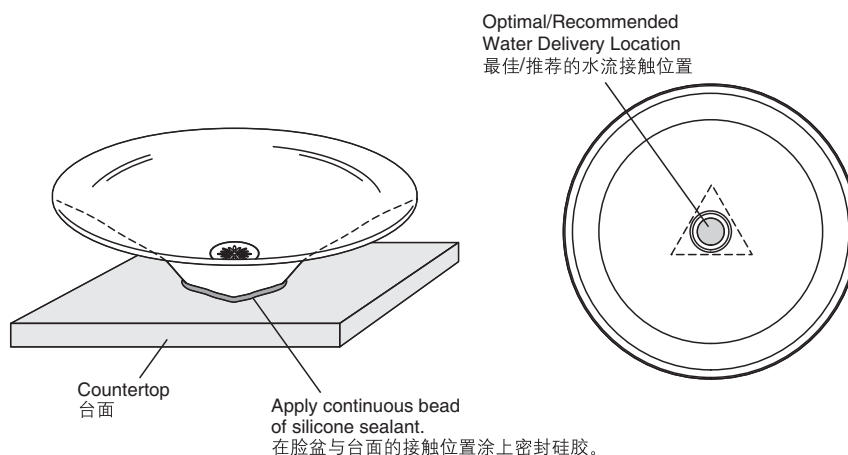

## USER MAINTENANCE



### Warn! Risk of product damage.

Many cleansers contain abrasive and chemical substance which is not suitable for cleaning stainless steel, enamel, plating or plastic products. You may use mild cleansers or soaps to clean the surfaces. Wipe any splashes of cleaner solutions from the surface with clean soft cloth.

The top should be cleaned with water and detergent. Never use a product which contains abrasive, liquid putty powder or other similar products. If you try to maintain the top with automobile wax on a regular basis, say, once a year, the impermeability of the top will be greatly upgraded. In this way, the little graffiti and dirt on the top will be easily removed. If the top blurs after several years' use, you could apply the following method as a remedy to restore its luster. a) To polish the surface of the top with a piece of 1200 abrasive paper dipped with water. b) To work with a polishing paste. In some countries, the temperature of hot water will exceed 60°C. Continuous use of this kind of hot water may lead to crack on the top. Therefore, avoid to use water over 60°C in the process of installing valves.

Please do not sit, lean or step on the top.

## 日常维护



### 警告！小心产品受损。

许多清洁剂都含有研磨剂及化学物质，不可用于清洁不锈钢、搪瓷、镀层或塑料制品。这些表面须使用温和的清洁剂或皂液进行清洁，将残余洗涤剂洗干净，然后用干净的软布擦干。

应该用清水和肥皂清洗台面。禁止使用含有磨蚀剂，液体抛光粉和类似产品的清洗产品。如果您不时地使用车用蜡对台面进行保养，大概一年一次，台面表层的防水性会大大提高。用这种方法，你将轻易地去除台面上的小划痕和污点处。假如几年后台面变得黯淡，您也可以通过以下方法轻易进行补救，使其重新焕发光泽。您可以采用：a)用1200砂纸蘸水打磨整个台面。b)使用抛光膏。在某些国家，热水温度超过60度，持续使用这种热水，台面表面可能会产生裂缝。安装阀门时，避免水温高于60度。

日常使用时，请勿坐、倚、靠、踩踏在脸盆上。