

BEFORE YOU BEGIN

- Please read these instructions carefully to familiarize yourself with the required tools, materials, and installation sequences. Follow the sections that pertain to your particular installation. This will help you avoid costly mistakes. In addition to proper installation, read all operating and safety instructions.
- All information in these instructions is based upon the latest product information available at the time of publication. Kohler China reserves the right to make changes in product characteristics, packaging, or availability at any time without notice.
- These instructions contain important care, cleaning, and warranty information - **please leave instructions for the consumer.**

安装之前

- 请小心详阅本指引。以便熟悉所需工具、材料及安装程序。请遵照适用的章节来安装你的座便器，以避免由于安装不当而导致不必要的损失。除了有关正确的安装方法之外，还务请详阅所有操作及安全指引。
- 本指引所载之一切资料，均以印刷时所有之最新产品情况为基础，科勒中国保留权利随时更改产品特性、包装或供应情况，恕不另行通知。
- 本指引也包含了有关护理、清洁及保养等重要资料 - 请交予用户保存。

ORDERING INFORMATION

PERSUADE™ Two-Piece Toilet	K-3654T
Includes Bowl.....	K-4322
Includes Tank	K-4419
Includes French Curve® Toilet Seat.....	K-4653T
PERSUADE™ E Two-Piece Toilet	K-3654T-AS
Includes Bowl.....	K-4322
Includes Tank	K-4419
Includes AVANTIS™ Quiet-close Elongated Toilet Seat ...	K-4761T
PERSUADE™ Two-Piece Toilet	K-3654T-C
Includes Bowl.....	K-4322
Includes Tank	K-4419
Includes French Curve® Quiet-close Toilet Seat ...	K-4713T

订购资料

珀斯唯分体座便器	K-3654T
含缸体	K-4322
含水箱	K-4419
含法弧加长型座便器盖板	K-4653T
珀斯唯分体座便器.....	K-3654T-AS
含缸体	K-4322
含水箱	K-4419
含雅蒂诗豪华座便器盖板	K-4761T
珀斯唯分体座便器.....	K-3654T-C
含缸体	K-4322
含水箱	K-4419
含法弧型缓降座便器盖板	K-4713T

NOTES

- Observe all local plumbing and building codes.
- Shut off the water supply.
- Seat post holes are on 140mm (5-1/2") centers.
- 51mm (2") passageway.
- Water depth from the rim is 210mm (5-1/2") .
- Ensure that the new drain has the correct roughing-in dimension. This toilet has a 305mm (12") roughing-in dimension. **See Roughing-in.**
- Closet flange must be 305mm (12") on-center from wall.
- Carefully inspect the new fixture for any sign of damage.
- For new construction, refer to the dimensions in installation step for locating the shut-off valve.
- Fixture dimensions are nominal and conform to tolerances established by ASME Standards (A112.19.2-2003).

注意

- 遵守当地所有给排水及建筑规定。
- 先关掉水源。
- 盖板孔中心间距140mm。
- 51mm排污通道。
- 座便器上表面距水面210mm。
- 请确保污水管的坑距尺寸正确。本型号坑距为305mm(请参阅尺寸图)。
- 座便器法兰盘中心必须距离墙壁305mm。
- 小心检验新的座便器是否有损坏的迹象。
- 若为新安装工程，请参看安装步骤中的尺寸标示以定位止水阀。
- 部件尺寸为标定值，误差符合美国ASME标准A112.19.2-2003。

WARNING: Risk of personal injury or product damage: Handle vitreous china products very carefully. Vitreous china can break and chip if you overtighten bolts and nuts.

WARNING: Risk of external leakage. The fill valve nut has been factory-tightened to design specifications. If re-tightening is required, wrench tighten one turn past finger tight .

IMPORTANT! Make sure the supply pressure is a minimum of 35 psi (2.5 kg/cm²). The toilet will not function properly without minimum Pressure.

警告：提防身体受伤或产品破裂。请小心处理釉面陶瓷产品。不可把螺母和螺栓上得过紧，以免产品破损或崩裂。

警告：有向外渗漏之危险。注水阀螺母在出厂时已上紧以符合设计规格，如需再上紧，可用手上紧后再以板钳上紧一圈。

重要！确保供水水压至少为35psi(2.5 kg/cm²)，座便器在低于最小压力下无法保证正常操作。

TOOLS AND MATERIALS REQUIRED (Not supplied)

- 254mm (10") adjustable wrench
- 305mm (12") pipe wrench
- Metal file (file cut)
- Tape measure
- Tubing cutter
- Level
- Hacksaw
- Putty knife
- Screwdriver
- Toilet gasket (wax seal)
- Toilet installation flange
- Toilet T-bolts (2), 8mm (5/16") diameter
- Toilet supply shut-off valve

NOTICE: If the existing toilet does not have a supply shut-off valve below the tank, install one before installing the new toilet.

所需工具及材料（不随货供应）

- 254mm 活动板钳
- 305mm 喉管板钳
- 锉刀
- 卷尺
- 切管刀
- 水平尺
- 钢锯
- 涂油灰刀
- 螺丝刀
- 座便器垫圈（蜡封）
- 安装座便器用之法兰盘
- 直径8mm的T型螺栓（2枚）
- 座便器供水管止水阀

注意：如果现有座便器的水箱下方没有止水阀，须在安装新座便器前装妥止水阀。

ROUGHING-IN

尺寸图

Reference Value
参考值

Unit: mm
单位: 毫米

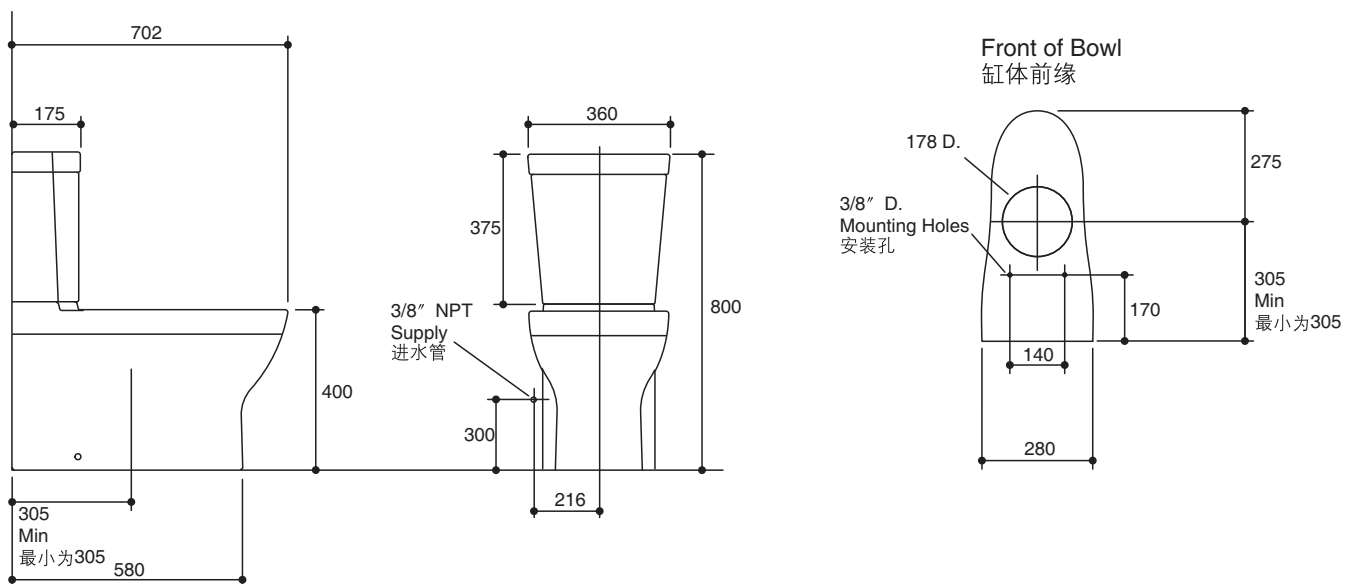

科勒公司保留随时变更图中标示尺寸的权利，无需另行通知。
Kohler reserves the right to change marked dimensions without prior notice.

INSTALLATION

安装

- 1 Install or relocate the supply and outlet as necessary to conform to the roughing-in dimensions.

根据尺寸图安装进水管和下水管或将现有管道移位，务求与尺寸图一致。

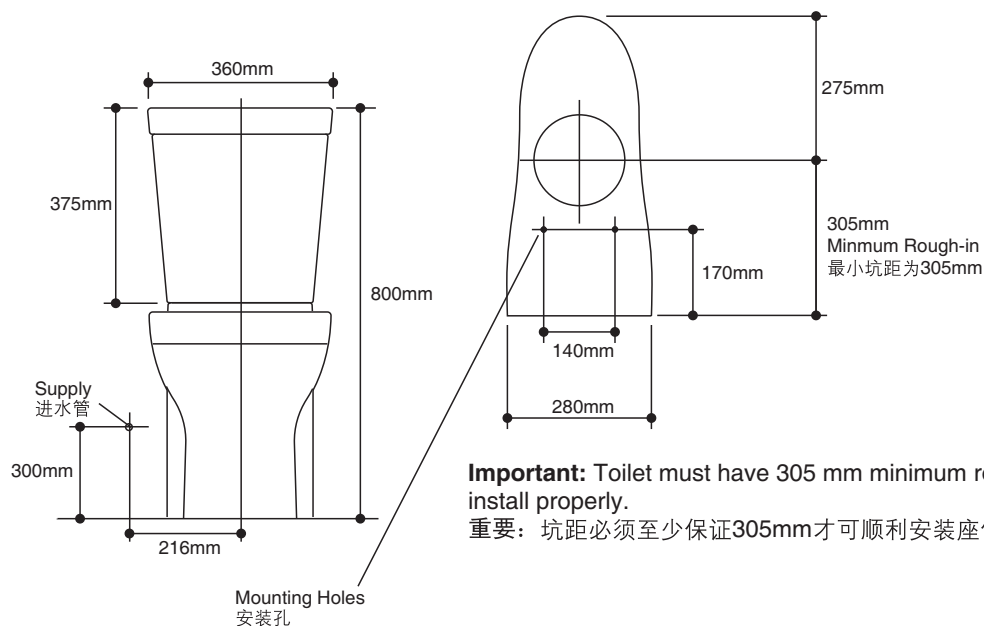

- 2 If replacing a toilet, remove the old wax.

如需拆除现有座便器，请先刮除旧的蜡环。

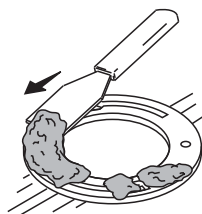

- 3 Position the template.

将安装模版放置在地面上。

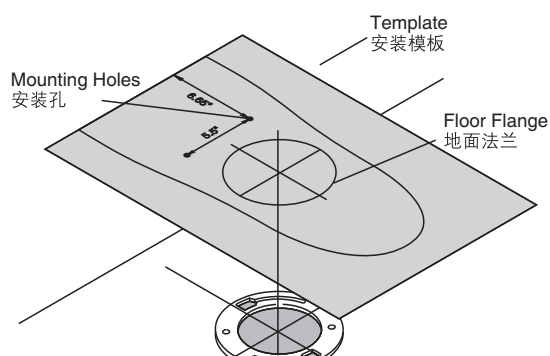

- 4 Tape in place and drill holes.

用胶带固定安装模版，根据安装模版用电钻在地面上钻孔。

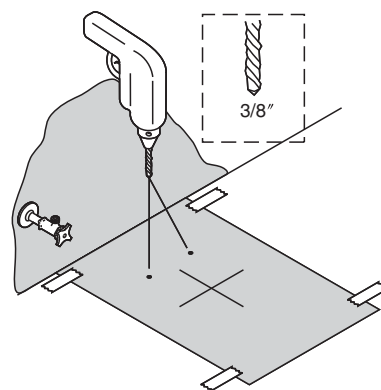

5 Insert anchors.

在钻好的孔内插入螺栓套管。

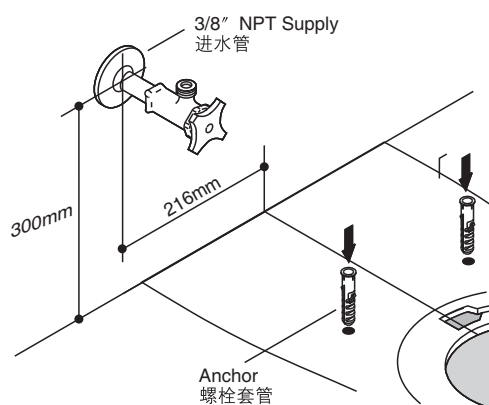

6 Install brackets.

安装支架。

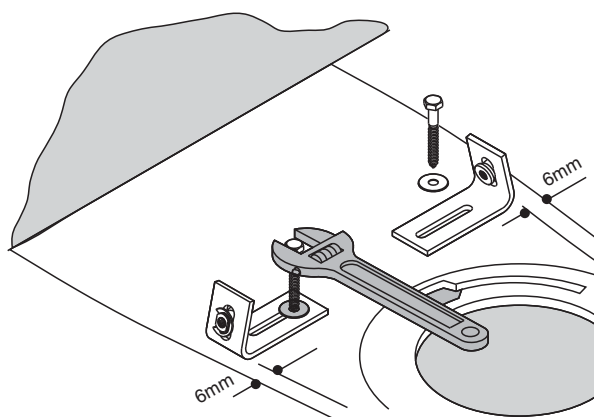

7 Thread the supply hose onto the tank.

将进水软管旋入到水箱上。

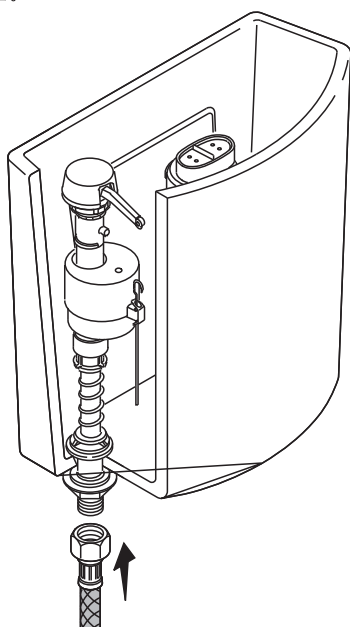

8 Position the gasket on the bowl inlet.

将垫圈放置在缸体的进水口上。

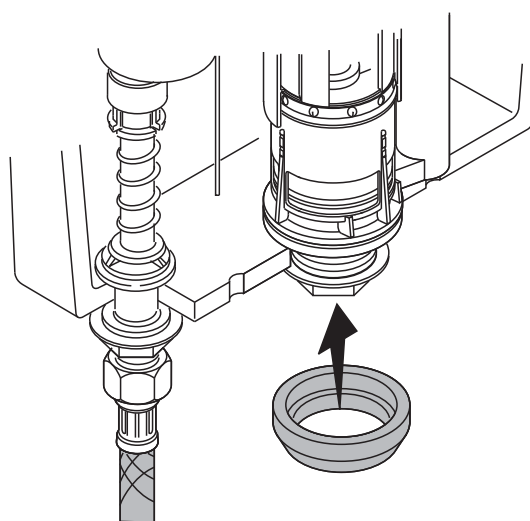

9 Position the tank on the bowl.

将水箱放置在缸体上。

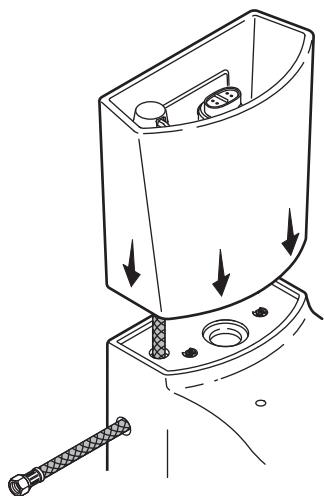

10 Slide the hose guide onto the hose, with the flared end last. Slide the two inserts into the flared end of the hose guide.

将软管导块套在软管上，展开面朝内。将两个插块合拢，套在缸体进水口末端。

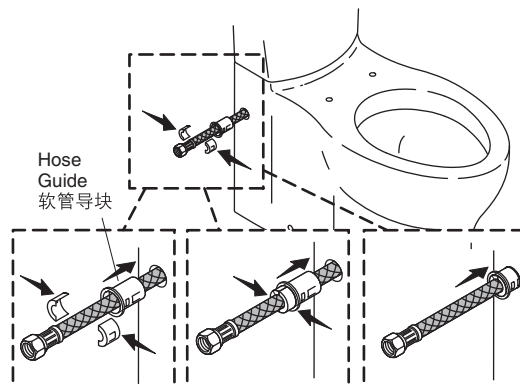

11 Slide the metal washer and the rubber washer onto the bolt.

将金属垫片和橡皮垫片套在螺栓上。

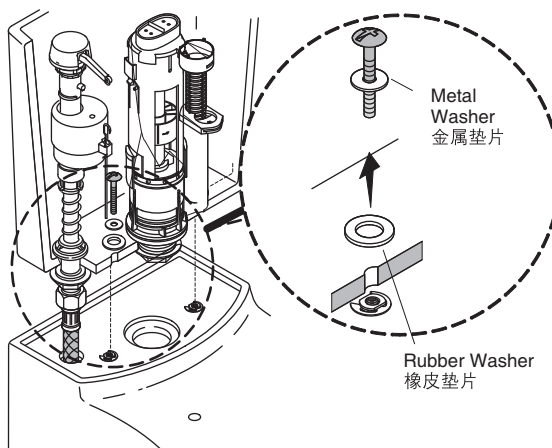

12 Thread the bolts into the bowl through the bolt holes in the bottom of the tank. Tighten the bolts using a screwdriver.

Do not overtighten.

将螺栓完全旋入水箱底部的螺栓孔中。使用螺丝刀紧固螺栓。
请勿过度旋紧。

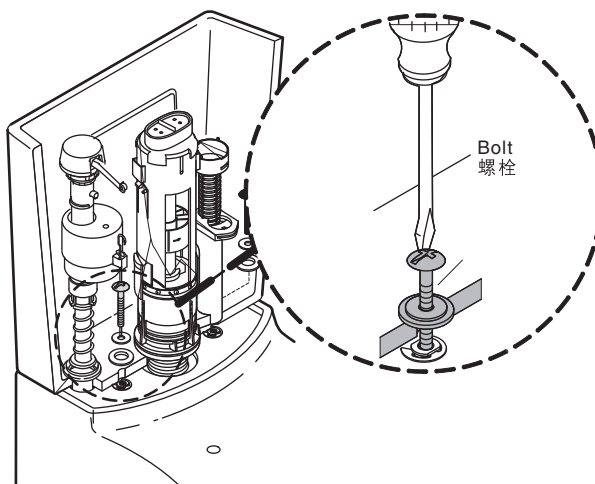

- 13 Install the wax seal.
安装蜡封。

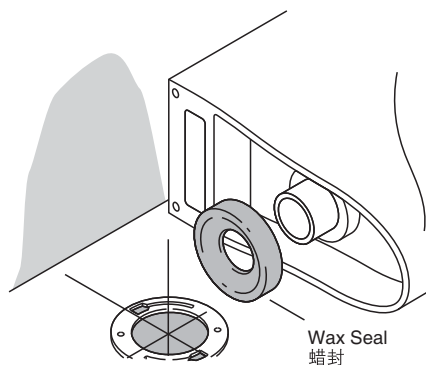

- 14 Carefully lower over brackets.
轻轻的将马桶降低，压在支架上。

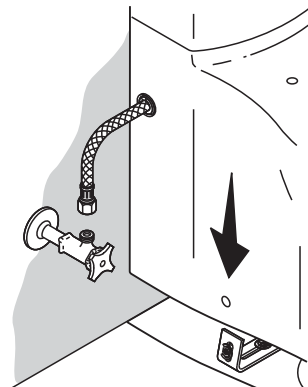

- 15 Apply weight evenly.
Do not move after placement!
Watertight seal may be broken!
均匀的将座便器下压。
放置后请勿移动！
否则会破坏防水层！

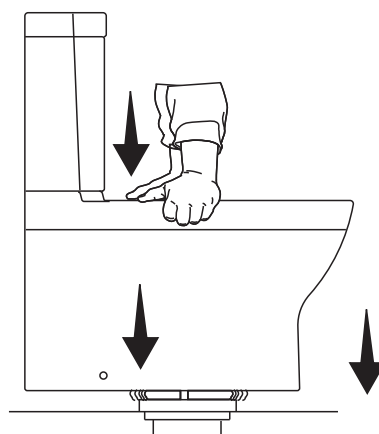

- 16 Carefully thread the bolts into the nuts on the brackets.
Do not overtighten.
小心的将螺栓旋入支架上的螺母。
请勿过度旋紧。

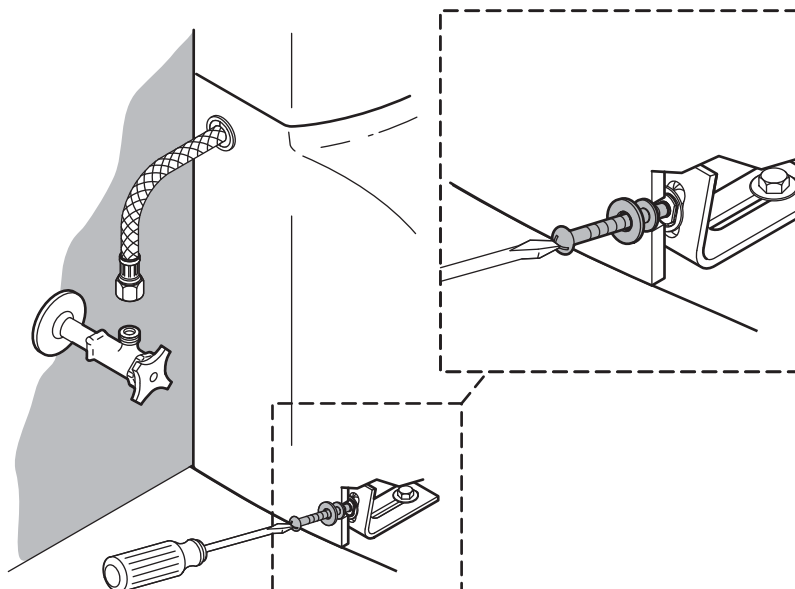

- 17** Connect supply and turn on the water.
连接供水管，打开水源。

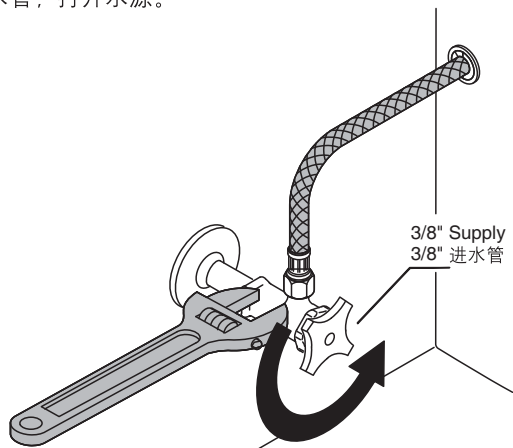

- 18** Remove the tape and protective pad.
移除胶带和保护垫。

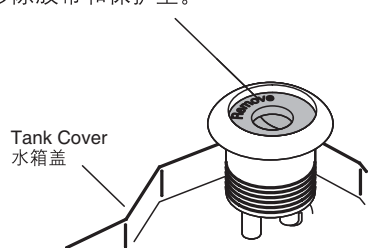

- 19** Press down on the large button.
按下大冲水按钮。

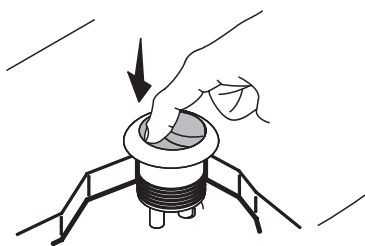

- 20** Pull out and remove the small button.
拔出并拆除小冲水按钮。

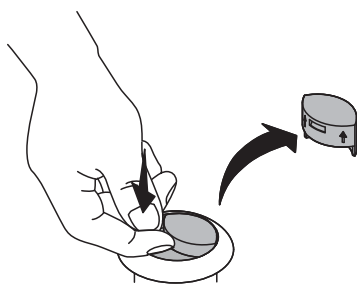

- 21** Pull out and remove the large button.
拔出并拆除大冲水按钮。

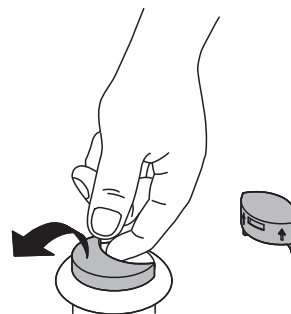

- 22** Press the large button onto the black rod.
将大冲水按钮按在黑色冲水杆上。

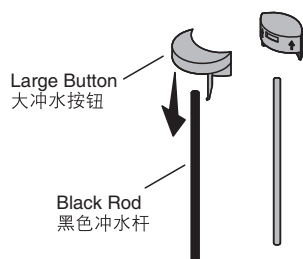

- 23** Press the small button onto the green rod.
将小冲水按钮按在绿色冲水杆上。

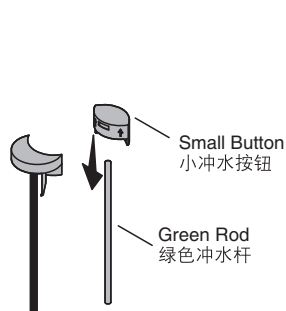

- 24 Insert the rods into the holes in the push button housing.
将冲水杆插入冲水按钮孔中。

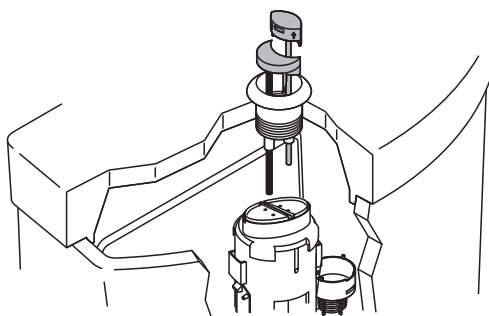

- 25 Press down on the push buttons until they click into place.
将冲水按钮向下按直到其卡入到位。

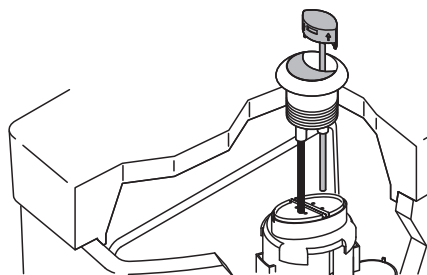

- 26 Flush several times and check for leaks.
冲水数次，检查是否漏水。

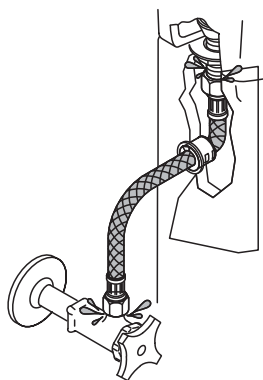

- 27 Turn here to adjust the water level.
旋转图中所示部位调整水位。

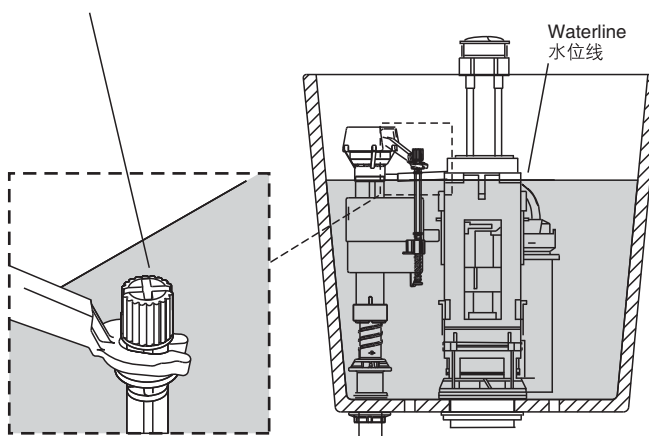

- 28 Install the tank lid and the seat. Use the supplied 1/4"-20 seat bolts and washers. Periodically check for leaks for several days following the installation.

安装水箱盖和盖板。使用附带的1/4"-20盖板螺栓和垫圈。安装后定期检查漏水情况。

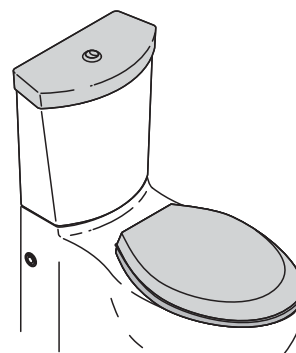

Replace the Seal

- 1 Shut off the water supply.
关闭水源。

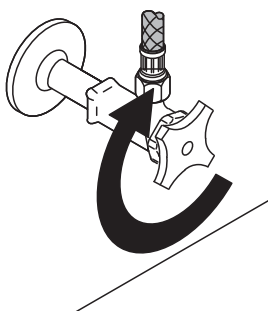

更换密封圈

- 2 Remove the tank cover.
移除水箱盖。

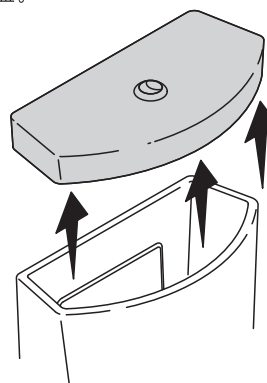

- 3** Note the position of the colored buttons for reinstallation.
注意重新安装时的彩色按钮。



- 4** Squeeze the tabs and pull straight up on the canister.
压紧冲水阀上的卡扣，并把卡扣向上提。

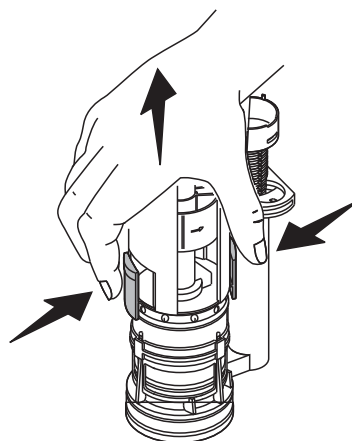

- 5** Remove and replace the seal.
移除并更换盖板。

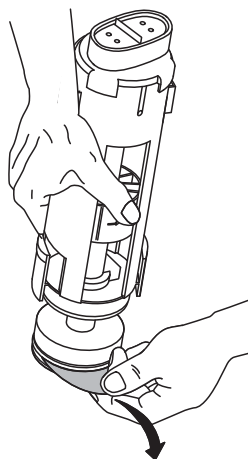

- 6** Reinstall the canister so it snaps into place.
重新安装冲水阀，直到其向下卡入到位。

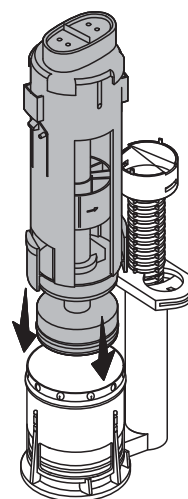

- 7** Rotate the canister so that the colored buttons are in their original positions.
旋转冲水阀，彩色按钮处于其初始位置。

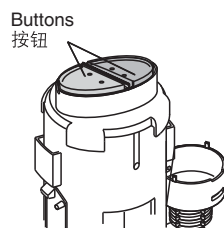

- 8** Reinstall the tank cover.
重新安装水箱盖板。

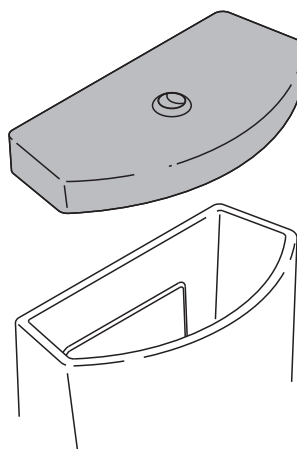

- 9 Turn on the water supply.
打开水源。

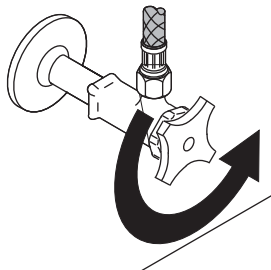

- 10 Flush several times and check for leaks.
冲水数次，检查是否漏水。

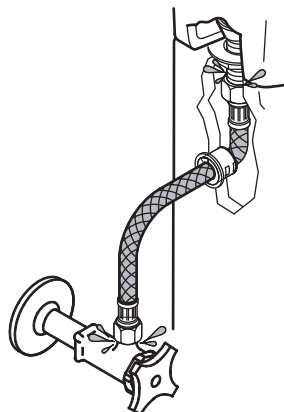

TROUBLESHOOTING CHART

SYMPTOMS	CORRECTIVE ACTION
1. Poor Flush	<p>A. Clean under the bowl rim.</p> <p>B. Plunge the bowl, auger trap, and auger drain to clear blockage.</p> <p>C. Adjust the gap between the actuator and plunger arm to approximately 1/8" (3 mm).</p> <p>D. Fully open the supply stop.</p> <p>E. Clean the screen with a medium to hard bristle brush. Replace the screen if necessary.</p> <p>F. Refer to the installer/dealer for assistance.</p>
2. No Flush	<p>A. Fully open the supply stop.</p> <p>B. Tighten the nut. Turn the nut counterclockwise.</p> <p>C. Hook the plunger arm over the trip arm.</p> <p>D. Clean the screen. Retain the screen if necessary.</p> <p>E. Replace the inlet components.</p>
3. Bowl water continues to flow or tank fill water will not shut off.	<p>A. Adjust gap between actuator and plunger arm to approximately 1/8" (3 mm).</p> <p>B. Repair or replace plunger arm (refer to installer/dealer for assistance).</p> <p>C. Replace the lower supply group.</p>

故障处理表

现象	处理措施
1. 冲水效果不佳	A. 清洁缸体边缘下部区域。 B. 伸入缸体，存水弯管和排水以清除堵塞。 C. 调整制动装置和活塞臂之间的距离大约为3mm。 D. 完全开启水制动塞。 E. 使用如硬毛刷之类的介质清洗筛网，如果必要则更换筛网。 F. 请咨询安装人员/经销商获取帮助。
2. 无冲水	A. 完全打开角阀。 B. 旋松螺母。逆时针开启螺母。 C. 将活塞臂卡在冲水把手臂上。 D. 清理O型圈，如果有必要，进行更换。 E. 更换进水组件。
3. 缸体水流持续流动或水箱注水持续不停	A. 调整制动装置和活塞臂之间的间距至大约3mm。 B. 修理或更换活塞臂。（请咨询安装人员/经销商获取帮助） C. 更换供水零件组。

IMPORTANT CONSUMER INFORMATION 用户须知

CONSUMER RESPONSIBILITIES

If you live in a hard water area, make certain that the holes in the toilet rim are kept clean to ensure proper bowl flushing. Toilet bowl cleaners should be used at least once a week. Use a long-handled brush to clean the rim holes, and to clean as far into the trap as possible to prevent mineral deposits from forming.

Most toilet bowl cleaners are not harmful to the vitreous china surface of the toilet bowl. Please follow the bowl cleaner manufacturer's instructions carefully.

Do not use abrasive cleaners or solvents.



WARNING: Risk of property or product damage.

Do not use in-tank cleaners. Products containing chlorine (calcium hypochlorite) can seriously damage fittings in the tank. This damage can cause leakage and property damage.

Kohler Company shall not be responsible or liable for any damage to these tank fittings caused by the use of cleaners containing chlorine (calcium hypochlorite).

用户责任

如果你居住地方的水质是硬性，你必须保持冲水孔清洁，令座便器冲水正常。每星期应最少使用座便器清洁剂清洁一次，用长把手的刷子清洁冲水孔，并尽量伸入排污管洗刷，防止矿物质积聚。

大多数马桶清洁剂对座便器表面是无害的。请认真遵循马桶清洁剂制造商的指示来操作。

请勿使用腐蚀性清洁剂或溶剂。



警告：提防楼宇受损或损坏产品。请勿使用水箱内用清洁剂。含氯（次氯酸钙）的清洁剂会严重破坏水箱配件，从而引起渗漏，或对楼宇结构造成损坏。

科勒公司对此类因使用氯(次氯酸钙)而引致的水箱装置损毁，概不负责。