

DENVER®

CAD-520

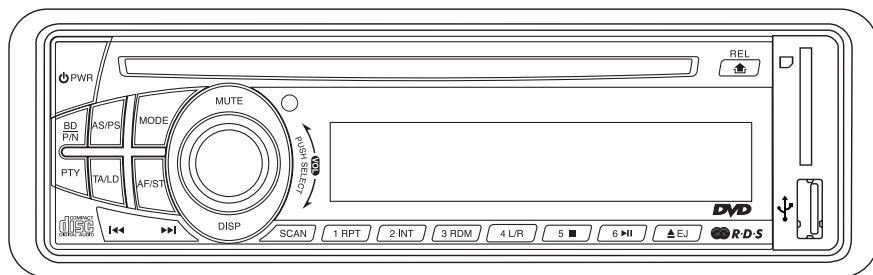

INSTRUCTION MANUAL

CAR STEREO
DVD/SVCD/VCD/CD/MP3/MP4 PLAYER
WITH PLL FM STEREO RADIO
RDS
USB / SD / MMC CARD INPUT
DETACHABLE FRONT PANEL

BEFORE YOU BEGIN

PRECAUTIONS:

CAUTION:

USE OF CONTROLS OR ADJUSTMENT OR PERFORMANCE OF PROCEDURES OTHER THAN THOSE SPECIFIED HEREIN MAY RESULT IN HAZARDOUS RADIATION EXPOSURE.

THE USE OF OPTICAL INSTRUMENTS WITH THIS PRODUCT WILL INCREASE EYE HAZARD.

- Keep this manual handy as a reference for operating procedures and precautions.
- Always keep the volume low enough so you can hear sounds outside of the car.
- Protect this product from moisture.
- If the battery is disconnected or discharged, the preset memory will be erased and must be reprogrammed.

FEATURES:

DVD video playback

It is possible to play back DVD video, DVD-R and DVD-RW.

Video CDs featuring PBC compatibility

It is possible to play back Video CDs featuring PBC (playback control).

CD playback

Music CD/CD-R/CD-RW playback is possible.

MP3 file playback

It is possible to play back MP3 files recorded on CD-ROM/CD-R/CD-RW.

MP4 file playback

It is possible to play back MP4 files.

PAL/NTSC compatibility

This unit is PAL/NTSC system compatible. When connecting other components to this unit, be sure components are compatible with the same video system or else images will not be correctly reproduced.

Multi-aspect

Switching between wide screen, letter box and panscan display is possible.

Multi-audio

You can switch between multiple audio systems recorded on a DVD as desired.

Multi-subtitle

You can switch between multiple subtitle languages recorded on a DVD as desired.

Multi-angle

You can switch between multiple viewing angles of a scene recorded on a DVD as desired.

When an operation is prohibited

When you are watching a DVD and attempt to perform an operation, it may not be performed by the programming on the disc. When this happens, this unit indicates on the screen.

INSTALLATION

PRECAUTIONS

- Choose the mounting location carefully so that the unit will not interfere with the normal driving functions of the driver.
- Avoid installing the unit where it would be subject to high temperatures, such as from direct sunlight or hot air from the heater, or where it would be subject to dust, dirt or excessive vibration.
- Use only the supplied mounting hardware for a safe and secure installation.
- Be sure to remove the front panel before installing the unit.

NOTE : Inclination angle for car radio installation must not exceed 30° otherwise the front panel will not open.

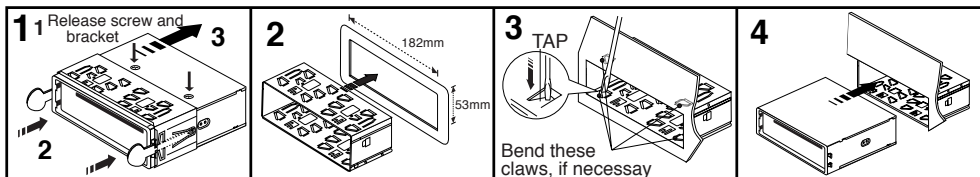

NOTE: Keep the release key in the safe place as you may need it in future to remove the unit from the car.

Detaching and attaching the front panel

The front panel of this unit can be detached in order to prevent the unit from being stolen.

DETACHING THE FRONT PANEL

Before detaching the front panel, be sure to press the POWER OFF button first. Then press the button (15) and detach the panel by pulling it towards you as illustrated.

Note:

Be sure not to drop the panel when detaching it from the unit.

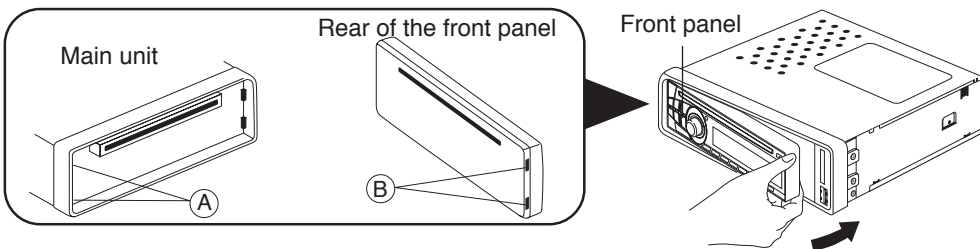

Notes:

- Make sure that the front panel is the right way up when attaching it to the unit as it cannot be attached upside down.
- Do not press the front panel hard against the unit when attaching it. It can be easily attached by pressing it lightly against the unit.
- When you carry the front panel with you, put it in the supplied front panel case.
- Do not press hard or give excessive pressure to the display window of the front panel when attaching it to the unit.

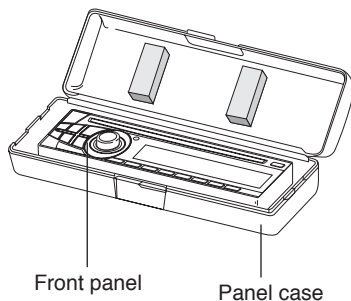

TO SUPPORT THE UNIT

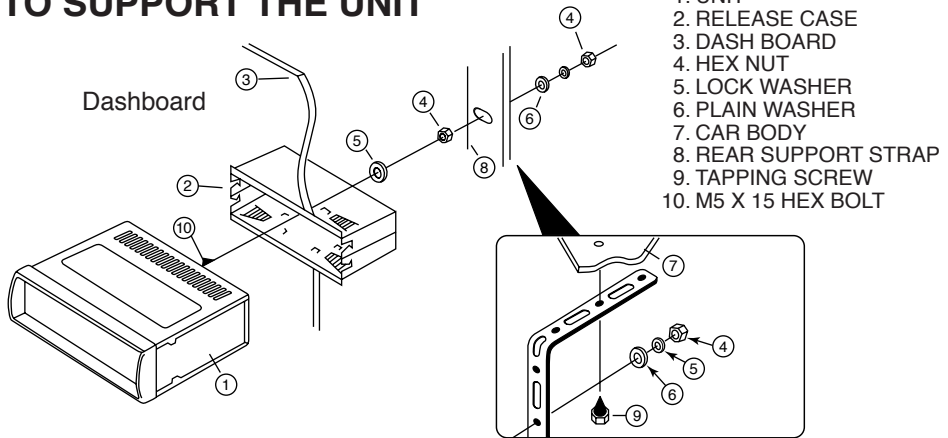

ISO Connector

VIDEO OUTPUT (GREEN): YELLOW (PLUG)

AUDIO LINE OUT (GREY):
RED (R) WHITE (L)

AUDIO LINE IN (BLACK):
RED (R) WHITE (L)

CONNECTOR A

4. MEMORY +12V
5. AUTO ANTENNA OUTPUT
7. +12V (TO IGNITION KEY)
8. GROUND

NOTE: (connector A no. 7) must be connected by car ignition key in order to avoid that car battery becomes weak when the car will be not used for long period.

CONNECTOR B

1. REAR RIGHT SPEAKER (+)
2. REAR RIGHT SPEAKER (-)
3. FRONT RIGHT SPEAKER (+)
4. FRONT RIGHT SPEAKER (-)
5. FRONT LEFT SPEAKER (+)
6. FRONT LEFT SPEAKER (-)
7. REAR LEFT SPEAKER (+)
8. REAR LEFT SPEAKER (-)

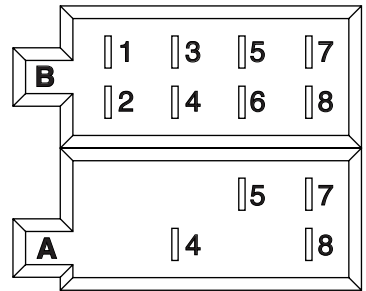

Maintenance

FUSE REPLACEMENT

If the fuse blows, check the power connection and replace the fuse. If the fuse blows again after the replacement, there may be an internal malfunction. In this case, consult your nearest repairing center.

Warning

Use the specified amperage fuse for each lead. Use of a higher amperage fuse may cause serious damage.

Locations of Parts (Main unit)

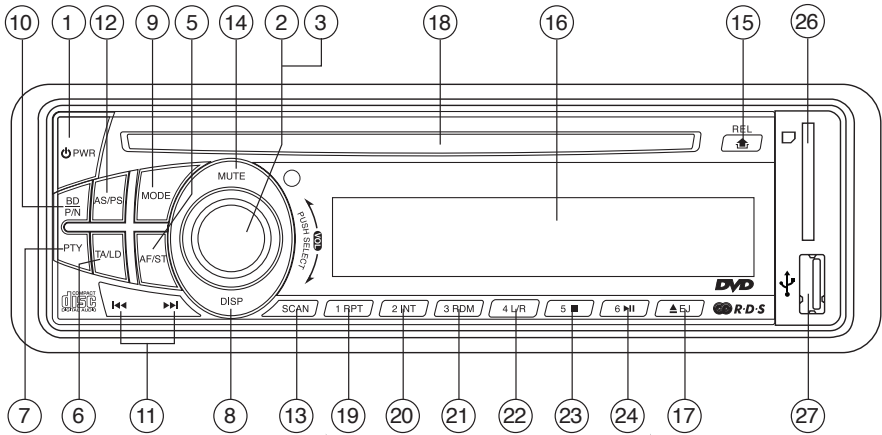

translation to Deutsch, Spanish

4 (1-6)

1. POWER ON/OFF ()
- 2,3.SELECT BUTTON: VOL/TA VOL/BASS/TREBLE/BALANCE/FADER
4. PRESET STATIONS (1,2,3,4,5,6)
5. 'AF' FUNCTION (ALTERNATIVE FREQUENCIES) / STEREO/MONO SELECTOR (AF/ST)
6. 'TA' FUNCTION (TRAFFIC ANNOUNCEMENT) / LOUDNESS (TA/LD)
7. 'PTY' FUNCTION (PROGRAM TYPE)
8. DISPLAY (DISP)
9. MODE BUTTON (MODE)
10. BAND / PAL/NTSC SYSTEM BUTTON (BD / P/N)
11. AUTOMATIC OR MANUAL TUNING
(FREQ UP OR FREQ DOWN)/
CD TRACK/SEARCH BUTTON
12. AUTO SEEK/PRESET SCAN (AS/PS)
13. 'SCAN' AUTOMATIC TUNING CONTROL
14. MUTE BUTTON
15. PANEL RELEASE BUTTON ()
16. LCD DISPLAY
17. CD EJECT BUTTON ()
18. CD SLOT
19. REPEAT BUTTON
20. INTRO BUTTON (Preview all Tracks)
21. RANDOM BUTTON
22. MONO L/MONO R (L/R)
23. STOP BUTTON
24. PLAY/PAUSE BUTTON
25. RESET BUTTON
26. USB PORT
27. MULTI-MEDIA CARD (MMC) / SD CARD SLOT

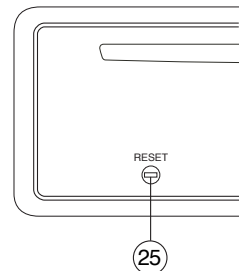

Locations of Parts (Remote Control)

1. POWER ON/OFF
2. MODE
3. PLAY/PAUSE (▶||)
4. STOP/RETURN (■↶)
5. SELECT
6. SEEK+/SEEK-
7. VOL +/VOL-
8. KEYPAD
9. GOTO
10. AUDIO
11. ENTER
12. NAVIGATION
13. AUTO SEARCH / REPEAT
14. RANDOM
15. BAND/SYSTEM
16. STEREO/MONO / PROGRAM
17. TITLE (MAIN MENU)
18. SUBTITLE
19. SETUP
20. ANGLE
21. SLOW MOTION
22. ZOOM
23. PLAYBACK CONTROL
24. ON SCREEN DISPLAY
25. MUTE

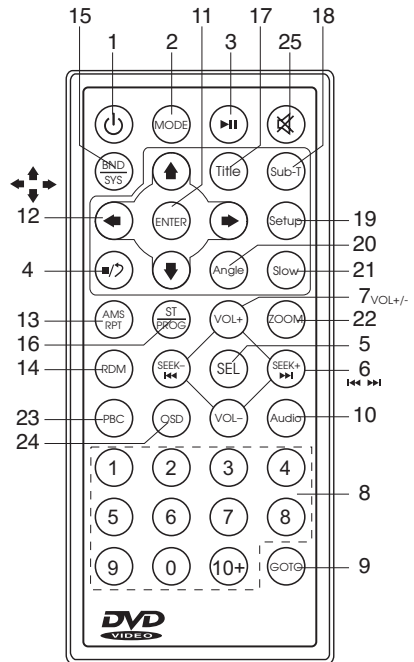

Use and care of the remote control

Installing the battery

Slide the tray out on the back of the remote control and insert the battery with the (+) and minus (-) poles pointing in the proper direction.

- When use for the first time, pull out the film protruding the tray.

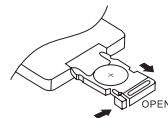

CAUTIONS

- Remove the battery if the remote control is not used for a month or longer.
- Do not recharge, disassemble, heat or dispose the battery on fire.
- Do not store the battery with metallic materials.
- In the event of battery leakage, wipe the remote control completely clean and install a new battery
- When disposing of used batteries, please comply with government regulations or environmental public institution's rule that apply in your country/area.
- Always check carefully that you are loading the battery with plus (+) and minus (-) poles facing the proper directions.

Using the remote control

Point the remote control in the direction of the front panel to operate.

IMPORTANT

- Do not store the remote control in high temperatures or direct sunlight.
- Do not let the remote control fall onto the floor, where it may become jammed under the brake or accelerator pedal.

GENERAL OPERATIONS

Turning the unit ON/OFF (PWR)

- Head Unit: Press PWR to turn on the unit. To turn off, press this button again.
- Remote Control: Press  button to turn on the unit. To turn off, press this button again.

Setting Time

1. Press DISP button repeatedly until time shows.
2. Press and hold DISP button. Hour digit starts blinking.
3. Rotate Volume knob to adjust hour. Press SEL
4. Rotate Volume knob to adjust minute.
5. Press DISP to save and exit.

Selecting a source (MODE)

- Head Unit: Press MD repeatedly to switch between TUNER, CD/DVD, AUX IN, USB, SD/MMC mode.
- Remote Control: Press MODE repeatedly.

Loading a Disc

- Insert a disc into the disc loading slot

Ejecting a Disc

- Press the EJECT button to eject disc

Adjusting the volume

- Head Unit: Rotate VOL knob right or left to increase or decrease volume.
- Remote Control: Press VOL+ or VOL- to increase or decrease volume

Adjusting the BASS/TREBLE/BALANCE/FADER/TA VOLUME

- Head Unit: Press VOL knob repeatedly until desired feature appears, rotate VOL knob to make adjustments.
- Remote Control: Press SEL repeatedly until desired feature appears. Press VOL+ or Vol- to make adjustments.

Mute Button

- Head Unit: Press the MUTE button to mute the sound at once. Press again to return to previous volume level.
- Remote Control: Press  button to mute the sound at once. Press again to return to previous volume level.

Display (DISP)

When this key is pressed, it is operated as the conversion of each display mode as follow.

1) In case of receiving RDS station.

RADIO MODE

PS ---- CT ---- FREQ ---- PTY

CD/MP3 PLAYER MODE

CDP ---- CT ---- PS ---- FREQ ---- PTY

2) In case of receiving NON RDS station

RADIO MODE

CLOCK ---- FREQ ---- NO PTY

CD/MP3 PLAYER MODE

CDP ---- CT ---- FREQ ---- NO PTY

Each display time is several seconds, and come back to 1'st position after several seconds.

Note: • CT = clock time • FREQ = frequency • CDP = CD Player

Loudness Button (LD)

By pressing this key longer than 2 sec., you can select LOUDNESS mode.

PAL / NTSC system (P/N)

Press this button to switch between PAL, PAL60, NTSC, AUTO system.

- During playback, press P/N button on the head unit or SYS button on the remote control, unit automatically switches between systems.

Reset

- Reset button is placed on the housing.
- The reset button is to be activated for the following reason:
 - Initial installation of the unit when all wiring is completed.
 - All the function button does not operate.
 - Error symbol on the display.

LISTENING TO RADIO

Band button (BD)

Each band is toggled cyclically by pressing this key FM1---FM2---FM3.

Automatic or Manual tuning (FREQ UP▶▶ OR FREQ DOWN◀◀)

When pressed short, these keys are operated as **MANUAL** tuning mode.

When pressed longer than 1 sec., they are operated as **SEEK** tuning mode.

Auto seek/Preset scan (A/PS)

Preset Scan (PS) - By pressing shortly, the radio plays each preset station for 5 seconds.

Auto Seek (AS) - By pressing longer than 1 sec., auto seek is activated. The 6 strongest stations are preset and stored in the corresponding preset number. When Auto Seek operation is finished, the radio executes the preset scan.

Note: This feature is called **AMS** on the remote control.

Scan automatic tuning control (SCN)

This key is operated as RADIO SCAN. The operation is similar as normal search but different thing is holding 5 seconds on every station detected.

Storing and recalling broadcast frequencies

If you press any of the NUMBER (1-3) you can easily store up to six broadcast frequencies for later recall with the touch of a button.

1. Choose a desired BAND (FM1-FM2-FM3).
2. When you find a frequency that you want to store in memory, press a NUMBER (1-3) and hold until the preset number shows and lit in the display.
3. The number you have pressed will remain lit. The selected radio station frequency has been stored in memory. The next time you press the same NUMBER (1-3) the radio station frequency is recalled from memory.

Note: Up to 18 FM stations can be stored in the memory.

Stereo/Mono

Head Unit: Press and hold ST button to switch between stereo or mono sound.

Remote Control: Press ST button

FUNCTION SELECT BUTTON: BASS/TREBLE/BALANCE/FADER/EQUALIZER/TA SEEK/PI SOUND/RETUNE/MASK DPI/BEEP (SEL)

Press the SEL (2) button shortly until the desired functions is shown on the display. Figure 1 shows how control functions are selected using the SEL button. Turn the VOL knob to settings.

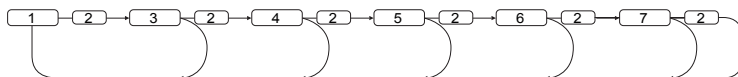



Fig. 1 Selection of sound control functions

1. VOL 2. SEL 3. BAS 4. TRE 5. BAL 6. FAD 7. EQ

TA SEEK/TA ALARM (2)

When press the SEL button for more than 2 seconds, it is activated as selecting mode of these function.

TA SEEK Mode or TA ALARM mode is selected by  or .



- TA SEEK mode:

When newly turned station does not receive TP information for 5 sec., the radio retunes to next station which has not the same station (PI) as the last station, but has the TP information.

In TA seek mode, the current station can be changed to the completely different station because the unit searches TP station when the field strength of the current station is very weak, or the current station has no TP signal.

- TA ALARM mode:

Any automatic retune mode is not activated, just can hear Beep sound.

PROGRAMME IDENTIFICATION (PI)

This information consists of a code enabling the receiver to distinguish between countries, areas in which the same programme is transmitted, and the identification of the programme itself. The code is not intended for direct display and is assigned to each individual radio programme, to enable it to be distinguished from all other programmes.

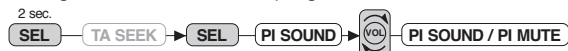

RETUNE L / S CONTROLS (2)

When press the SEL button for more than 2 seconds, it is activated as selecting Retune mode.

RETUNE L: Select 90 seconds as the initial time of automatic TA search.

RETUNE S: Select 30 seconds as initial time.



MASK DPI (2)

When press the SEL button for more than 2 seconds, it is activated as selecting mode of these function.



MASK DPI: masked only the AF which has different PI.

MASK ALL: masked the AF which has different PI and NO RDS signal with field strength.

BEEP MODE (2)

When press the SEL button for more than 2 seconds, it is activated as selecting mode of these function.



BEEP ON: BEEP sound can be heard from speaker when the buttons are pressed.

USING THE RDS FUNCTION

What is RDS?

The RDS (Radio Data System) is a digital information system developed by the EBU (European Broadcast Union). Piggy-backed on normal FM broadcasts, RDS offers a variety of information services and automatic retuning functions for RDS-compatible car stereos.

In 1988, RDS became available in the United Kingdom, France, West Germany, Ireland and Sweden. Test transmissions are being conducted in many other European countries. It is expected that RDS will be available in most Western European countries in the near future.

'AF' function (Alternative frequencies)

When pressed short, AF switching mode is selected.

When AF switching mode is selected, the radio checks the signal strength of the AF all the time.

'TA' function (Traffic announcement)

When pressed short, it is activated as TA mode on or off

When TA mode is on and traffic announcement is transmitted.

- When the unit is in CD/MP3 mode, it will switch to radiomode temporarily.
- If the volume level was under the threshold point, it will be raised to the threshold point.
- When TP station is received, TP segment is turned on in LCD display.

'PTY' Function (Program type)

1. Press PTY button repeatedly to select 'Music' or 'Speech' programs.
2. Press preset buttons (1-6) repeatedly to select desired program types. Unit will automatically search for program type stations.

Button	Music	Speech
1	Pop M, Rock M	News, Affairs, Info
2	Easy M, Light M	Sport, Educate, Drama
3	Classics, Other M	Culture, Science, Varied
4	Jazz, Country	Weather, Finance, Children
5	Nation M, Oldies	Social, Religion, Phone In
6	Folk M	Travel, Leisure, Document

LISTENING TO CD/MP3

Basic operation of CD/MP3

1. To perform fast forward or reverse, press and hold ◀◀ or ▶▶ . To resume normal playback at a desired point, press ▶▶▶ .
2. To skip back or forward to another chapter, press ◀◀ or ▶▶▶ . Pressing ▶▶▶ skips to the start of the next chapter. Pressing ◀◀◀ skips to the previous chapter.
3. To pause playback, press ▶▶▶▶ . Press it again to resume.
4. To stop playback, press ■ .

Note:

- When MP3 disc is inserted, all track file names will be displayed on the TV screen with their corresponding track number.
- You can use the navigation keypads on the remote control to access the file. To play selected file, simply press enter.

Searching for particular track

During playback, you can simply press the corresponding track number using the number pad on the remote control.

Note:

- To select 3, press 3.
- To select 13, press 10+, 3.
- To select 23, press 10+, 10+, 3 in order.

Searching for particular track using GOTO

You can use the GOTO function to search for a desired track number or particular point of a track to play.

1. Press **GOTO** on the remote control. Track search appears.
2. Enter track number and press **ENTER**.

Repeat tracks

You can choose between repeat playback of a single track or all tracks.

1. Press **RPT** on the head unit or remote control during playback.
2. Every time you press this button, the unit switches to the following settings:
 - **Repeat Single** – Repeat the current playback track.
 - **Repeat All** – Repeat all tracks.
 - **Off** – Turn repeat off.

Random Playback

You can play the tracks in random/shuffle order instead of normal progression.

1. Press **RDM** on the head unit or remote control during playback. To turn off, press it again.

Program Playback

You can set which tracks to play according to your desired sequence using the PROG function.

1. Press **PROG** button on the remote control.
2. Enter the track number besides the memory location. Up to 16 tracks can be stored.
3. When all tracks have been programmed, select **PLAY** and press **ENTER**. Program playback will start.
4. Press **STOP** button to exit program playback.

LISTENING TO USB, SD/MMC CARD MUSIC

This unit supports playback of music files stored in a USB memory stick and SD/MMC memory card. Plug the USB stick or memory card in the designated port. Playback starts automatically.

PLAYING DVD VIDEO**Basic operation of DVD Video**

1. Insert a DVD disc. Unit automatically loads the disc. When the DVD offers a menu, the menu is displayed.
2. Using the remote control navigation buttons to choose desired features displayed on the menu. Press **ENTER** to select.
3. To perform fast forward or reverse, press and hold **I◀◀** or **▶▶I**. To resume normal playback at a desired point, press **▶II**.
4. To skip back or forward to another chapter, press **I◀◀** or **▶▶I**. Pressing **▶▶I** skips to the start of the next chapter. Pressing **I◀◀** skips to the previous chapter.
5. To pause playback, press **▶II**. Press it again to resume.
6. To stop playback, press **■**. When you stop DVD playback, that location on the disc is memorized enabling playback from that point when you play the disc again. To resume playback, press **▶II**.

Specifying Title/Chapter

Press **NUMBER** corresponding to a desired title/chapter during playback. The number is displayed and playback starts from the selected title.

- To select 3, press 3.
- To select 13, press 10+, 3.
- To select 23, press 10+, 10+, 3 in order.

Changing audio language during playback (Multi-audio)

DVDs can provide audio playback with different languages and different systems (Dolby Digital, DTS etc.). With DVDs featuring multi-audio recordings, you can switch between languages/audio systems during playback.

1. To choose different audio, simply press **Audio** on remote control or **L/R** on head unit repeatedly.

Note:

- With some DVDs, switching between languages/audio systems may only be possible using a menu display.
- You can also switch between languages/audio systems using **SET-UP MENU**.

Changing the subtitle language during playback (Multi-subtitle)

With DVDs featuring multi-subtitle recordings, you can switch between subtitle languages during playback.

1. Press **Sub-T** on the remote control during playback. Press repeatedly until the supported desired subtitle appears.

Note:

- With some DVDs, switching between subtitles may only be possible using a menu display.
- You can also switch between subtitles using **SET-UP MENU**.

Changing the viewing angle during playback (Multi-angle)

With DVDs featuring multi-angle (scenes shot from multiple angles) recordings, you can switch among

viewing angles during play-back.

1. Press **Angle** on the remote control during playback of a scene.

Slow motion playback

This feature lets you slow down playback.

1. Press **Slow** on the remote control during playback.
2. Pressing it repeatedly will switch you to the following steps: 1/2 – 1/3 – 1/4 – 1/5 – 1/6 – 1/7.

Note:

- To resume normal playback, press **▶II**.
- There is no sound during slow motion playback.
- With some disc, slow motion may be unclear during slow motion playback.

Fast forward/Reverse

1. Press and hold **▶▶I** (forward) or **I◀◀** (reverse) button
2. Repeat step 1 and the speed of the search will increase by x2, x4, x8, x16, x20.
3. To resume normal playback at desired point, press **▶II**.

Searching from a desired scene, starting playback from a specific time

You can use the GOTO function to search for a desired scene by specifying a title and chapter, or the time search function to specify the time on a disc at which play starts.

1. Press **GOTO** on the remote control. Time and Title/Chapter search appears.
2. Enter the hour, minutes and seconds if you want to search by time. Press **Enter**.
3. Enter Title/Chapter number if you want to search by Title/chapters. Press **Enter**.

Selecting repeat range

You can choose between repeat playback of a title or chapter.

1. Press **RPT** on the head unit or remote control during playback.
2. Every time you press this button, the unit switches to the following settings:
 - **Repeat Title** – Repeat the current playback title.
 - **Repeat Chapter** – Repeat the current playback chapter.
 - **Off** – Turn repeat off.

Zooming in during playback

You can zoom in into the picture during playback.

1. Press **ZOOM** on the remote control during playback.
2. Every time you press this button, the unit will zoom **2, 3, 4, 1/2, 1/3, 1/4** times and **OFF**.

Go back to Main Menu

You can go back to Main Menu of the DVD anytime during playback.

1. Press **TITLE** on the remote control during playback.

Displaying information

During playback, you can see all DVD disc information and current play settings. Display will show related playback time, elapse time, title number, chapter number, angle, audio settings and subtitle.

1. Press **OSD** on the remote control once. Unit will display the play time and the disc elapse time.
2. Press it twice and all other settings information will be displayed.

Program Playback

You can set which tracks to play according to your desired sequence using the PROG function.

1. Make sure the unit is in STOP mode. If the unit is playing, stop the playback first.
2. Press **PROG** button on the remote control.
3. Enter the track number and the chapter number besides the memory location. Up to 12 locations can be stored.
4. When all tracks have been programmed, select PLAY PROGRAM and press **ENTER**. Program playback will start.

PLAYING VCD/SVCD/MP4

Basic operation of Video CD

1. To perform fast forward or reverse, press and hold **⏮** or **⏭**. To resume normal playback at a desired point, press **⏮**.
2. To skip back or forward to another chapter, press **⏮** or **⏭**. Pressing **⏭** skips to the start of the next chapter. Pressing **⏮** skips to the previous chapter.
3. To pause playback, press **⏮**. Press it again to resume.
4. To stop playback, press **■**.

Turning PBC ON/OFF

PBC (Playback Control) is a feature found on VCD 2.0 and SVCD 1.0. PBC allows control of the playback of play items and the possibility of interaction with the user through the remote control or some other input device available. If it's on, the player won't auto start after inserting the disc because it will take time to select program on disc; if it's off, the player will auto playback the program on disc one by one.

1 To turn ON PBC function, press **PBC** on the remote control. To turn OFF, press the button again.

Note: Not all VCD/SVCD disc have PBC functions.

Specifying Track

Press NUMBER corresponding to a desired track number during playback. The number is displayed and playback starts from the selected track.

1. Make sure to turn off PBC feature first.
2. Using the number pad on the remote control, enter the desired track number.

Note:

- To select 3, press 3.
- To select 13, press 10+, 3.
- To select 23, press 10+, 10+, 3 in order.

Changing audio language during playback

VCDs can provide audio playback with different languages. It is usually separated into 2 channels (left and right). With VCDs featuring multi-audio recordings, you can switch between languages/audio systems during playback.

1. To choose different audio, simply press **Audio** on remote control or L/R on head unit repeatedly.

Slow motion playback

translation to Deutsch, Spanish

This feature lets you slow down playback.

1. Press **Slow** on the remote control during playback.
2. Pressing it repeatedly will switch you to the following steps: 1/2 – 1/3 – 1/4 – 1/5 – 1/6 – 1/7.

Note:

- To resume normal playback, press **⏮**.
- There is no sound during slow motion playback.
- With some disc, slow motion may be unclear during slow motion playback.

Fast forward/Reverse

1. Press and hold **⏭** (forward) or **⏮** (reverse) button
2. Repeat step 1 and the speed of the search will increase by x2, x4, x8, x16, x20.
3. To resume normal playback at desired point, press **⏮**.

Searching from a desired scene, starting playback from a specific time

You can use the GOTO function to search for a desired scene by specifying the track, or the time search function to specify the time on a disc at which play starts.

1. Press **GOTO** on the remote control. Time and Title/Chapter search appears.
2. Enter the hour, minutes and seconds if you want to search by time. Press **Enter**.
3. Enter track number if you want to search by track. Press **Enter**.

Selecting repeat range

You can choose between repeat playback of a title or chapter.

1. Make sure to turn off PBC feature first.
2. Press **RPT** on the head unit or remote control during playback.
3. Every time you press this button, the unit switches to the following settings:

- **Repeat 1** – Repeat the current playback track.
- **Repeat DIR** – Repeat the current playback directory.
- **Off** – Turn repeat off.

Zooming in during playback

You can zoom in into the picture during playback.

1. Press **ZOOM** on the remote control during playback.
2. Every time you press this button, the unit will zoom **1, 2, 3, 4, 1/2, 1/3, 1/4** times and **OFF**.

Random Playback

You can play the tracks/chapters in random/shuffle order.

1. Press **RDM** on the head unit or remote control during playback. To turn off, press it again.

Displaying information

During playback, you can see the VCD disc play information.

1. Press **OSD** on the remote control once. Unit will display the play time and the disc elapse time.
2. Press it twice and the track number together with total tracks information will be displayed.

Program Playback

You can set which tracks to play according to your desired sequence using the PROG function.

1. Press **PROG** button on the remote control.
2. Enter the track number besides the memory location. Up to 16 tracks can be stored.
3. When all tracks have been programmed, select **PLAY PROGRAM** and press **ENTER**. Program playback will start.

SETTING UP THE DVD PLAYER

Important

1. Load any disc into the unit before you can access the settings.
2. Press **SETUP** on the remote control.
3. Use the navigation key and press **ENTER** to setup the DVD player.

Note: Depending on the type of disc inserted, some features may not be available.

SETUP	CATEGORY	OPTIONS
SYSTEM SETUP	TV SYSTEM	NTSC, PAL60, PAL, AUTO
	VIDEO	Interlace-YUV , TV-RGB P-SCAN YPBPR, S-VIDEO
	TV TYPE	4:3 PS, 4:3 LB, 16:9
	PASSWORD	
	RATING	1. Kid Safe 2. G 3. PG 4. PG-13 5. PG-R 6. R 7. NC-17 8. Adult
	DEFAULT	RESTORE
LANGUAGE SETUP	OSD LANGUAGE	
	AUDIO LANGUAGE	
	SUBTITLE LANGUAGE	
	MENU LANGUAGE	
AUDIO SETUP	AUDIO OUT	SPDIF/OFF, SPDIF/RAW SPDIF/PCM
	KEY	
VIDEO SETUP	BRIGHTNESS	0 → 12
	CONTRAST	0 → 12
	HUE	-6 → +6
	SATURATION	0 → 12
	SHARPNESS	0 → 8
DIGITAL SETUP	OP MODE	LINE OUT RF REMOD
	DYNAMIC RANGE	OFF → FULL
	DUAL MONO	STEREO, MONO L MONO R, MIX MONO

Setting Rating Password

1. Press **SETUP** on the remote control.
2. Using Navigation keys, scroll down to **RATING** and select a rating level.
3. If you like to change password, scroll up to **PASSWORD**. Enter default password '0000'. The lock logo will switch to unlock.
4. Enter the new password. The unlock logo will switch to lock indicating new password saved properly.

Note:

- The default password is '0000'.
- To reset password, enter the old password to unlock first and then enter new password.

TECHNICAL SPECIFICATIONS

CD/MP3 PLAYER SECTION

Signal to Noise Ratio	> 60 dB
Channel Separation	> 50 dB (1 kHz)
Frequency Response	20 Hz - 20 kHz

TUNER (FM)

Frequency Range	87.5-108 MHz
Intermediate Frequency	10.7 MHz
Sensitivity	2.8 μ V
Stereo Separation	30 dB
Signal to Noise Ratio	50 dB
Channel Step	100 kHz

LINE-OUT

Output	5V max.
Impedance	10 kOhm

GENERAL

Power Supply	12V DC (10.8-15.6V allowable)
Speaker Impedance	4 or 8 ohm
Output Power	40W x 4CH
Fuse	10A

Note: Specification and the design are subject to possible modification without notice due to improvements.



Instructions on environment protection

Do not dispose of this product in the usual household garbage at the end of its lifecycle; hand it over at a collection point for the recycling of electrical and electronic appliances. The symbol on the product, the instructions for use or the packing will inform about the methods for disposal.

The materials are recyclable as mentioned in this marking. By recycling, material recycling or other forms of re-utilization of old appliances, you are making an important contribution to protect our environment.

Please inquire at the community administration for the authorized disposal location.

ALL RIGHTS RESERVED
COPY RIGHT DENVER ELECTRONICS A/S



www.denver-electronics.com