

PRODUCT GUIDE

Version 2004:02



Filtronic Sweden

For a better workbench environment

FILTRONIC AB
Box 2284, SE-531 02 LIDKÖPING SWEDEN
Tel +46 (0)510-208 10, Fax +46 (0)510-201 40
e-mail: office@filtronic.se
www.filtronic.se



Filtronic Sweden

For a better workbench environment

PRODUCT LINES

1. FILTER SYSTEMS for connection of extraction arms

MG-series High airflow systems
Accessories

BT-series High airflow systems

2. EXTRACTION ARMS

Extraction arms
Accessories
Compose your own extraction arm!

3. FILTER SYSTEMS for tip extraction integrated on soldering irons

FT/FE-series High vacuum systems
FC-series Central systems
Tube system
Clip-on kits For integration on soldering iron

4. CLEAN-BENCH-CONCEPT

CBC Air Curtain Cabinets

5. SUCTION CABINETS

6. REPLACEMENT FILTERS



Filtronic Sweden

MG-High airflow systems

for connection of extraction arms



Article number	Description																																				
950-1000-ESD	<p>Filter unit MG95, ESD-safe with filter guard for gas and particles <i>Filter unit operated by electricity for fumes and gases for connection to one or two extraction arms. Delivered complete with remote control and two connection hoses (1000 mm).</i></p> <p>Technical data MG95</p> <table> <tr><td>Height (mm)</td><td>640</td></tr> <tr><td>Width (mm)</td><td>465</td></tr> <tr><td>Depth (mm)</td><td>220</td></tr> <tr><td>Weight (kg)</td><td>21</td></tr> <tr><td>Noise level dB(A) 1 m</td><td>38-49</td></tr> <tr><td>Voltage 1-phase 50/60 Hz (Volt)</td><td>100-240</td></tr> <tr><td>Effect (Watt)</td><td>100</td></tr> <tr><td>Max. suction capacity (m³/h)</td><td>100</td></tr> <tr><td>Micro filter-tested separation degree DOP</td><td>>99,97%</td></tr> <tr><td>Gas filter-Purafil CP-Select-Media, separation degree</td><td>>93%</td></tr> <tr><td>Visual filter guard gas</td><td>Yes</td></tr> <tr><td>Visual filter guard particles</td><td>Yes</td></tr> </table> <p>Replacement filters MG95</p> <table> <tr><td>950-2000-ESD</td><td>Micro/Gas filter, standard</td></tr> <tr><td>950-2002-ESD</td><td>Micro/Gas filter, Clean Room</td></tr> <tr><td>950-2003-ESD</td><td>Micro/Gas filter, solvents type MEK</td></tr> <tr><td>950-2005-ESD</td><td>Micro/Gas filter, Epoxy</td></tr> <tr><td>950-2006-ESD</td><td>Micro/Gas filter, ammonia</td></tr> <tr><td>950-2007-ESD</td><td>Micro/Gas filter, CO₂</td></tr> </table>	Height (mm)	640	Width (mm)	465	Depth (mm)	220	Weight (kg)	21	Noise level dB(A) 1 m	38-49	Voltage 1-phase 50/60 Hz (Volt)	100-240	Effect (Watt)	100	Max. suction capacity (m³/h)	100	Micro filter-tested separation degree DOP	>99,97%	Gas filter-Purafil CP-Select-Media, separation degree	>93%	Visual filter guard gas	Yes	Visual filter guard particles	Yes	950-2000-ESD	Micro/Gas filter, standard	950-2002-ESD	Micro/Gas filter, Clean Room	950-2003-ESD	Micro/Gas filter, solvents type MEK	950-2005-ESD	Micro/Gas filter, Epoxy	950-2006-ESD	Micro/Gas filter, ammonia	950-2007-ESD	Micro/Gas filter, CO ₂
Height (mm)	640																																				
Width (mm)	465																																				
Depth (mm)	220																																				
Weight (kg)	21																																				
Noise level dB(A) 1 m	38-49																																				
Voltage 1-phase 50/60 Hz (Volt)	100-240																																				
Effect (Watt)	100																																				
Max. suction capacity (m³/h)	100																																				
Micro filter-tested separation degree DOP	>99,97%																																				
Gas filter-Purafil CP-Select-Media, separation degree	>93%																																				
Visual filter guard gas	Yes																																				
Visual filter guard particles	Yes																																				
950-2000-ESD	Micro/Gas filter, standard																																				
950-2002-ESD	Micro/Gas filter, Clean Room																																				
950-2003-ESD	Micro/Gas filter, solvents type MEK																																				
950-2005-ESD	Micro/Gas filter, Epoxy																																				
950-2006-ESD	Micro/Gas filter, ammonia																																				
950-2007-ESD	Micro/Gas filter, CO ₂																																				
750-1000-ESD	<p>Filter unit MG75, ESD-safe with filter guard for gas and particles <i>Filter unit operated by electricity for fumes and gases for connection to one extraction arm. Delivered complete with remote control and one connection hose (1000 mm).</i></p> <p>Technical data MG75</p> <table> <tr><td>Height (mm)</td><td>640</td></tr> <tr><td>Width (mm)</td><td>465</td></tr> <tr><td>Depth (mm)</td><td>220</td></tr> <tr><td>Weight (kg)</td><td>18</td></tr> <tr><td>Noise level dB(A) 1 m</td><td>38-49</td></tr> <tr><td>Voltage 1-phase 50/60 Hz (Volt)</td><td>100-240</td></tr> <tr><td>Effect (Watt)</td><td>100</td></tr> <tr><td>Max. suction capacity (m³/h)</td><td>70</td></tr> <tr><td>Micro filter – tested separation degree DOP</td><td>>99,97%</td></tr> <tr><td>Gas filter – Purafil CP-Media, separation degree</td><td>>93%</td></tr> <tr><td>Visual filter guard gas</td><td>Yes</td></tr> <tr><td>Visual filter guard particles</td><td>Yes</td></tr> </table>	Height (mm)	640	Width (mm)	465	Depth (mm)	220	Weight (kg)	18	Noise level dB(A) 1 m	38-49	Voltage 1-phase 50/60 Hz (Volt)	100-240	Effect (Watt)	100	Max. suction capacity (m³/h)	70	Micro filter – tested separation degree DOP	>99,97%	Gas filter – Purafil CP-Media, separation degree	>93%	Visual filter guard gas	Yes	Visual filter guard particles	Yes												
Height (mm)	640																																				
Width (mm)	465																																				
Depth (mm)	220																																				
Weight (kg)	18																																				
Noise level dB(A) 1 m	38-49																																				
Voltage 1-phase 50/60 Hz (Volt)	100-240																																				
Effect (Watt)	100																																				
Max. suction capacity (m³/h)	70																																				
Micro filter – tested separation degree DOP	>99,97%																																				
Gas filter – Purafil CP-Media, separation degree	>93%																																				
Visual filter guard gas	Yes																																				
Visual filter guard particles	Yes																																				
750-1010-ESD	<p>Filter unit MG75 "Clean Room", ESD-safe <i>as above but with higher demands on filtration of particles for Clean Room-applications (10000 particles/m³).</i></p> <p>Replacement filters MG75</p> <table> <tr><td>750-2000-ESD</td><td>Micro/Gas filter, standard</td></tr> <tr><td>750-2002-ESD</td><td>Micro/Gas filter, Clean Room</td></tr> <tr><td>750-2003-ESD</td><td>Micro/Gas filter, solvents type MEK</td></tr> <tr><td>750-2005-ESD</td><td>Micro/Gas filter, Epoxy-application</td></tr> <tr><td>750-2006-ESD</td><td>Micro/Gas filter, ammonia</td></tr> <tr><td>750-2007-ESD</td><td>Micro/Gas filter, CO₂</td></tr> </table>	750-2000-ESD	Micro/Gas filter, standard	750-2002-ESD	Micro/Gas filter, Clean Room	750-2003-ESD	Micro/Gas filter, solvents type MEK	750-2005-ESD	Micro/Gas filter, Epoxy-application	750-2006-ESD	Micro/Gas filter, ammonia	750-2007-ESD	Micro/Gas filter, CO ₂																								
750-2000-ESD	Micro/Gas filter, standard																																				
750-2002-ESD	Micro/Gas filter, Clean Room																																				
750-2003-ESD	Micro/Gas filter, solvents type MEK																																				
750-2005-ESD	Micro/Gas filter, Epoxy-application																																				
750-2006-ESD	Micro/Gas filter, ammonia																																				
750-2007-ESD	Micro/Gas filter, CO ₂																																				
PC-UK PC-EU PC-US PC-AU	<p><i>Please state which power cord you require for the units:</i></p> <p>Power cord model United Kingdom Power cord model Europe Power cord model USA Power cord model Australia</p>																																				



Filtronic Sweden

MG-High airflow systems

for connection of extraction arms

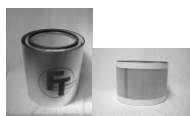

Article number	Description																								
100-1000-ESD	<p>Filter unit MG100S <i>Filter unit operated by electricity for fumes and gases for connection to two extraction arms.</i></p> <p>Technical data MG100S</p> <table> <tr><td>Height (mm)</td><td>610</td></tr> <tr><td>Width (mm)</td><td>460</td></tr> <tr><td>Depth (mm)</td><td>210</td></tr> <tr><td>Weight incl filter cartridge (kg)</td><td>21</td></tr> <tr><td>Noise level dB(A) 1 m</td><td>52</td></tr> <tr><td>Voltage 1-phase 50/60Hz (Volt)</td><td>100-240</td></tr> <tr><td>Effect (Watt)</td><td>100</td></tr> <tr><td>Max. suction capacity (m³/hr)</td><td>100</td></tr> <tr><td>Micro filter HEPA -styled - separation degree DOP</td><td>>99,97%</td></tr> <tr><td>Gas filter - Chemisorbtion media, efficiency</td><td>>93%</td></tr> <tr><td>Filter alarm</td><td>Yes, light/sound</td></tr> </table>	Height (mm)	610	Width (mm)	460	Depth (mm)	210	Weight incl filter cartridge (kg)	21	Noise level dB(A) 1 m	52	Voltage 1-phase 50/60Hz (Volt)	100-240	Effect (Watt)	100	Max. suction capacity (m³/hr)	100	Micro filter HEPA -styled - separation degree DOP	>99,97%	Gas filter - Chemisorbtion media, efficiency	>93%	Filter alarm	Yes, light/sound		
Height (mm)	610																								
Width (mm)	460																								
Depth (mm)	210																								
Weight incl filter cartridge (kg)	21																								
Noise level dB(A) 1 m	52																								
Voltage 1-phase 50/60Hz (Volt)	100-240																								
Effect (Watt)	100																								
Max. suction capacity (m³/hr)	100																								
Micro filter HEPA -styled - separation degree DOP	>99,97%																								
Gas filter - Chemisorbtion media, efficiency	>93%																								
Filter alarm	Yes, light/sound																								
100-1032-ESD	<p>Filter unit MG100S with flexible extraction arms Ø 32 mm <i>2 pcs of extraction arm 4002 are included in the delivery.</i></p>																								
100-1055-ESD	<p>Filter Unit MG100S with flexible extraction arms Ø 55 mm <i>2 pcs of extraction arm 3035 are included in the delivery.</i></p>																								
100-2000-ESD 100-2003-ESD 100-2005-ESD 100-2006-ESD 100-2007-ESD	<p>Replacement filters MG100S</p> <p>Micro/gas filter, standard Micro/gas filter, MEK-application Micro/gas filter, Epoxy-application Micro/gas filter, ammonia Micro/gas filter, CO₂</p>																								
800-1000-ESD	<p>Filter unit MG350S, ESD-safe* <i>Filter unit operated by electricity for fumes and gases for connection to several extraction arms or to a small suction cabinette. Delivered complete with remote control.</i></p> <p>Technical data MG350S</p> <table> <tr><td>Max. No. of extraction arms (pcs) at 40 m³/h</td><td>6</td></tr> <tr><td>Height (mm)</td><td>1000</td></tr> <tr><td>Diameter (mm)</td><td>430</td></tr> <tr><td>Weight (kg)</td><td>45</td></tr> <tr><td>Noise level dB(A) 1 m (250 m³/h, 600 Pa)</td><td>54</td></tr> <tr><td>Voltage 1-phase (Volt)</td><td>230</td></tr> <tr><td>Effect (Watt)</td><td>300</td></tr> <tr><td>Suction capacity (m³/h)</td><td>310</td></tr> <tr><td>Micro filter – tested separation degree DOP</td><td>>99,97%</td></tr> <tr><td>Gas filter – Purafil CP-Media, separation degree</td><td>>93%</td></tr> <tr><td>Visual filter Guard gas</td><td>Yes</td></tr> <tr><td>Visual filter guard particles</td><td>Yes</td></tr> </table> <p>Replacement filters MG350S</p> <p>Micro filter Gas filter, standard Gas filter, solvents type MEK Gas filter, ammonia Gas filter, CO₂</p>	Max. No. of extraction arms (pcs) at 40 m³/h	6	Height (mm)	1000	Diameter (mm)	430	Weight (kg)	45	Noise level dB(A) 1 m (250 m³/h, 600 Pa)	54	Voltage 1-phase (Volt)	230	Effect (Watt)	300	Suction capacity (m³/h)	310	Micro filter – tested separation degree DOP	>99,97%	Gas filter – Purafil CP-Media, separation degree	>93%	Visual filter Guard gas	Yes	Visual filter guard particles	Yes
Max. No. of extraction arms (pcs) at 40 m³/h	6																								
Height (mm)	1000																								
Diameter (mm)	430																								
Weight (kg)	45																								
Noise level dB(A) 1 m (250 m³/h, 600 Pa)	54																								
Voltage 1-phase (Volt)	230																								
Effect (Watt)	300																								
Suction capacity (m³/h)	310																								
Micro filter – tested separation degree DOP	>99,97%																								
Gas filter – Purafil CP-Media, separation degree	>93%																								
Visual filter Guard gas	Yes																								
Visual filter guard particles	Yes																								
800-2000 800-2001 800-2003 800-2006 800-2007																									
PC-UK PC-EU PC-US PC-AU	<p>Please state which power cord you require for the units:</p> <p>Power cord model United Kingdom Power cord model Europé Power cord model USA Power cord model Australia</p>																								



Filtronic Sweden

BT-High airflow system

for connection of extraction arms



Article number

500-1000

500-2000
500-4000PC-UK
PC-EU
PC-US
PC-AU

Description

Filter unit BT75

*Filter unit operated by electricity for fumes.
Delivered with an integrated extraction arm.*

Technical data BT75

Height (mm)	785
Width (mm)	285
Depth (mm)	240
Weight (kg)	6,2
Sound level dB(A) 1 m	54
Voltage 1-phase 50/60Hz (Volt)	100-240
Effect (Watt)	60
Max. suction capacity freeblowing (m³/h)	150
Max. suction capacity with filters (m³/h)	75
Micro filter-tested separation degree DOP	99,97%
Activated carbon gasfilter	Yes
Visual particles filter guard	Yes

Technical data extraction arm (0F07)

Diameter (mm)	Ø 55
Length, extended (mm)	700
Antistatic	Yes

Replacement filters BT75

Micro filter
Pre filter bag (5 pcs/pack)

Please state which power cord you require for the units:

Power cord model United Kingdom
Power cord model Europe
Power cord model USA
Power cord model Australia

See also accessories for High airflow systems



Filtronic Sweden

Accessories to High airflow systems

for MG70 / MG75 / MG80S / MG95 / MG100S / MG350S / BT75



Article number

Description

950-3202-ESD

Mobile unit with wheels and arm attachment for MG75 / MG95
(is delivered without filter unit and extraction arms).

Width (mm) 450
Depth (mm) 450
Height (mm) 750

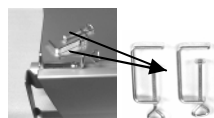

750-3001-ESD

Set for table mounting for MG75*To be mounted on the back of the unit.*

780-3001-ESD

Set for table mounting for MG100S*To be mounted on the edge of the work bench.*

700-3042

Y-connection with quick-connection

700-3043-ESD

Y-connection with quick-connection, ESD

700-3040-ESD

Connection hose, aluminium covered Ø 65 mm, complete with quick-connection, length = 1000 mm (standard)

700-3041-ESD

Connection hose, aluminium covered, Ø 65 mm, complete with quick-connection, length = 2000 mm

700-3051-ESD

Connection hose, aluminium covered, Ø 65 mm, complete with quick-connection, length = 3000 mm

700-3052-ESD

Connection hose, aluminium covered, Ø 65 mm, complete with quick-connection, length = 4000 mm

700-3053-ESD

Connection hose, aluminium covered, Ø 65 mm, complete with quick-connection, length = 5000 mm

700-3055-ESD

Connector for hoses, complete with 2 x male quick-connection, length = 120 mm

700-3027

Flexible hose Ø 55 mm, length (extended) = 1,45 m (price per piece)

700-3034

Flexible hose Ø 32 mm, length (extended) = 1,45 m (price per piece)

700-3028

Vaneometer*Instrument for measuring air speed (m/s).*

750-3003

Holder for remote control (MG75 / MG95 / MG350S)*For installation on extraction arms, fits on pipes Ø 50-60 mm.*

950-4000

Prefilter for MG95

750-4000

Prefilter for MG75 (picture)

750-4100

Replacement filter (5 pcs) for prefilter MG95/ MG75



Filtronic Sweden

Accessories to High airflow systems

for MG70 / MG75 / MG80S / MG95 / MG100S / MG350S / BT75

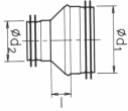

Article number

800-5001-ESD

800-5002

800-5004

300-3002

300-3003

300-3004

300-5000

300-5001

300-5004

300-5005

700-3003-ESD

700-3011-ESD

700-3019

Description

Connection hose, aluminium covered \varnothing 100 mm, for MG350S, by meter.

Reduction \varnothing 100/63 mm with quick-connection

Reduction \varnothing 80/63 mm with quick-connection

Spare parts MG-Series

Lid to MG70, complete

Fan part to MG70, complete

Base with spring clips for MG70, complete

Remote control box for MG75

Cables for remote control box for MG75 and MG350S

Remote control box for MG350S

Remote control box for MG95

Transformer for MG70

Brackets (pair) for table attachment on extraction arms

Sound damper MG70



Filtronic Sweden

Extraction arms 60 mm

for connection to High airflow systems

The extraction arms are ESD-approved in the Filtronic Sweden filter systems. If connected to other suction source ground connection must be secured.



Article number

599E0-0000-0F07

Description

Extraction arm 3046 (Ø 60 mm)

Short extraction arm with 700 mm flexible hose part (incl. Ball joint).

Diameter (mm) Arm Ø 60

Measure/arm part (mm) 230 / 700

Total measure (mm) 930

Complete the arm with nozzles, see page 2:3.

599EW-0000-0F07

Extraction arm 3446 (Ø 60 mm)

As above but with air valve.



5A3B0-0000-AF07

Extraction arm 3015 (Ø 60 mm)

Short extraction arm with 700 mm flexible hose part (incl. table console)

Diameter (mm) Arm Ø 60

Measure/arm part (mm) 230 / 895

Total measure (mm) 1125

Complete the arm with nozzles, see page 2:3.

5A3BW-0000-AF07

Extraction arm 3415 (Ø 60 mm)

As above but with air valve.



5A3B0-A500-AF05

Extraction arm 3007 (Ø 60 mm)

Extraction arm with 500 mm flexible hose part (incl. table console).

Diameter (mm) Arm Ø 60

Measure/arm part (mm) 230 / 395 / 695

Total measure (mm) 1320

Complete the arm with nozzles, see page 2:3.

5A3BW-A500-AF05

Extraction arm 3407 (Ø 60 mm)

As above with air valve.



5A3B0-H500-A200-P

Extraction arm 3013 (Ø 60 mm)

Short extraction arm with horizontal link and metal nozzle (incl. table console).

Diameter (mm) Arm Ø 60

Nozzle Ø 50

Measure/arm part (mm) 230 / 430 / 195 / 105-235

Total measure (mm) 960-1090

5A3BW-H500-A200-P

Extraction arm 3413 (Ø 60 mm)

As above but with air valve.



50000-0000-0F15-A

Extraction arm 3035 (Ø 55 mm)

Flexible extraction arm with funnel-shaped nozzle, model Alfa, for direct connection to MG75 / MG95 / MG100S / BT75 units.

Diameter (mm) Arm Ø 55

Total measure (mm) 1450

Nozzle BxH (mm) 225x100



Filtronic Sweden

Extraction arms 32 mm



Article number
3A3B0-0000-AF07

Description

Extraction arm 4000 (Ø 32 mm)

Short extraction arm with 700 mm flexible hose part (incl. table console).

Diameter (mm)	Arm Ø 60 End part Ø 32
Measure/arm part (mm)	230 / 895
Total measure (mm)	1125

3A3BW-0000-AF07

Extraction arm 4400 (Ø 32 mm)

As above but with air valve.



399B0-0000-AF99

Extraction arm 4001 (Ø 32 mm)

Short extraction arm with two 700 mm flexible hose parts (incl. table console).

Diameter (mm)	Arm Ø 60 End part Ø 32
Measure/arm part (mm)	230 / 895
Total measure (mm)	1125

399BW-0000-AF99

Extraction arm 4401 (Ø 32 mm)

As above but with air valve.



30000-0000-0F15

Extraction arm 4002 (Ø 32 mm)

Flexible extraction arm for direct connection to MG75 / MG95 / MG100S / BT75 units.

Diameter (mm)	Connection Ø 60 Arm Ø 32 End part Ø 32
Total measure (mm)	1450



Filtronic Sweden

Accessories

for 60 mm extraction arms (article numbers start with 5)



K
(to be discontinued)

Description

Plastic nozzle, antistatic, not ESD-approved (⌘)

Fits extraction arm with flexible hose part

Width (mm) 140
Height (mm) 80
Connection (mm) quick-connection Ø 60



L

Plastic nozzle, antistatic, not ESD-approved (⌘)

Fits extraction arm with flexible hose part

Width (mm) 190
Height (mm) 100
Connection (mm) quick-connection Ø 60



U

Plastic nozzle, ESD (black) (⌘)

Fits extraction arm with flexible hose part

Width (mm) 190
Height (mm) 100
Connection (mm) quick-connection Ø 60



X

Plastic nozzle, ESD (black) (⌘)

Fits extraction arm with flexible hose part

Width (mm) 345
Height (mm) 75
Depth (mm) 240
Connection (mm) quick-connection Ø 60



ALFA

Plastic nozzle, ESD (black) (⌘)

Fits extraction arm with flexible hose part

Width (mm) 225
Height (mm) 100
Connection (mm) quick-connection Ø 60



N

Metal tube nozzle, short, ESD (⌘)

Fits extraction arm with flexible hose part

Diameter (mm) Ø 50
Length (mm) 130



NS

Metal tube nozzle, short, with grid ESD (⌘)

Fits extraction arm with flexible hose part

Diameter (mm) Ø 50
Length (mm) 130



P

Metal tube nozzle, long, ESD

Fits extraction arm without flexible hose part

Diameter (mm) Ø 50
Length (mm) 300

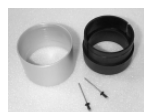

Z

Adapter, ESD

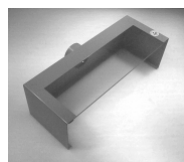
for extraction arms without flexible hose part

700-3033-ESD
(to be discontinued)

Suction hood with transparent top and flexible junction, ESD

Width (mm) 470
Height (mm) 150
Depth (mm) 180
Connection (mm) Ø 75
Junction (mm) Ø75 / Ø 60 quick-connection

(⌘) = to be mounted on an extraction arm without flexible hose part, adapter Z is needed.



Filtronic Sweden

Accessories

For extraction arms (both 32 mm and 60 mm)



Article number

700-3026

Description

Cleaning brush for extraction arm Ø 60 mm**W SPECIAL****Valve part, with quick -connection, for extraction arm***For installation on extraction arm without air valve function.*

Diameter (mm): Ø 60

Length (mm): 115

**700-3030-ESD****Extra long clamps (pair) for table console (B), for a table top max. 95 mm thick.***Accessories for table console.*

Spare parts extraction arms

300-3005

Plastic foot for extraction arm

300-3006

Slip joint for extraction arm, complete with O-rings

300-3011

Connection end pieces (quick-connection), female, for flexible hose

300-3012

Connection end pieces (quick-connection), male, for aluminium tubes

**700-3050**

Spring blade for quick-connection, fits on pipes Ø 50-60 mm



Filtronic Sweden

Compose your own extraction arm

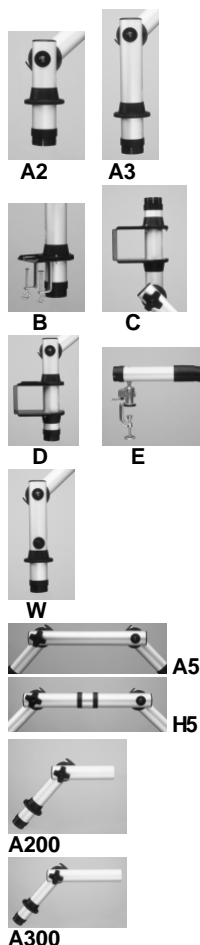

A200

A300

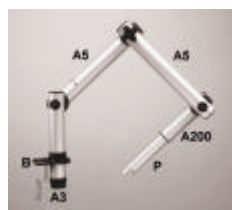

Article number

3*

5

A2

A3

99

00

B

C

D

E**

9

0

W***

0

A5

H5

99

00

A200

A300

AF

0F

05

07

10

15

99

00

ALFA

K (to be discontinued)

L

N

NS

P****

T

U

X

9

0

Z

Description

Size

Diameter 32 mm

(*Just the flexible hose.)

Diameter 55 mm

Foot-tube

232 mm aluminium tube

350 mm aluminium tube

Special

No foot-tube

Bracket

Table clamp

Wall from top

Wall from under

Ball joint (**fits only together with foot-tube 99 and end-tube 0F)

Special

No bracket

Valve

With valve function (** fits only foot-tube A3 and 99)

Without valve function

Middle-tube

475 mm aluminium tube

500 mm with horizontal link

Special

None

End-tubes

232 mm aluminium tube

350 mm aluminium tube

232 mm aluminium tube with flexible hose

Flexible hose only (none aluminium)

Length (extended) of the flexible part

500 mm flexible hose

700 mm flexible hose

1000 mm flexible hose

1500 mm flexible hose

Special

No flexible part

Nozzle

Nozzle, ESD (black)

Plastic nozzle, antistatic, not ESD

Plastic nozzle, antistatic, not ESD.

Metal tube nozzle, short

Metal tube nozzle, short, with grid ESD

Metal tube nozzle, long (**** fits only A200 and A300)

Nozzle, ESD (black)

Nozzle, ESD (black)

Nozzle, ESD (black)

Special

None

Adapter, ESD

Example of codes

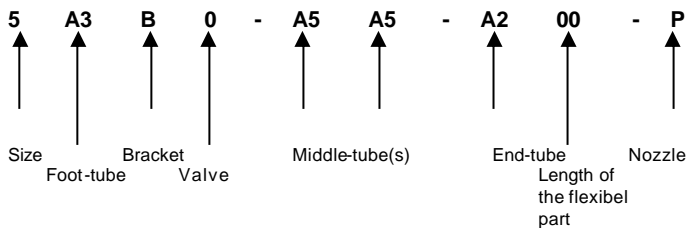



Filtronic Sweden

High vacuum systems

for tip extraction integrated on soldering iron.



Article number

112-0000-ESD

Description

Filter unit FT12, ESD-safe*Filter unit operated by compressed air for 1-2 soldering irons.***Technical data FT12**

Maximum connected irons	2
Height (mm)	200
Diameter (mm)	120
Weight (kg)	1,5
Sound level dB(A) 1 m	37
Air consumption at 5,5 bar (l/min)	13
Air consumption free air flow (NI/min)	12-40
Suction capacity (l/min) (one iron connected)	20-50
Work pressure (bar)	3,5-7
Micro filter – tested separation degree DOP	>99,99%
Gas filter – Purafil CP-Media, separation degree	>99%
Warranty (except for filters) years	2

Replacement filter FT12**210-0323-ESD**

Top filter

210-0310

Top filter (model 93)

212-0012-ESD

Main filter

210-0309

Filter discs (white) (10 pcs)

210-0313

Filter discs (pink) for heavy soldering (10 pcs)

**111-1000-ESD****Filter unit FT11, ESD-safe***Filter unit operated by compressed air for one soldering iron.***Technical data FT11**

Maximum connected irons	1
Height (mm)	200
Diameter (mm)	120
Weight (kg)	1,5
Sound level dB(A) 1 m	37
Air consumption at 5,5 bar (l/min)	13
Air consumption free air flow (NI/min)	10-36
Suction capacity (l/min) (one iron connected)	30
Work pressure (bar)	3,5-7
Micro filter – tested separation degree DOP	>99,99%
Gas filter – Purafil CP-Media, separation degree	>99%
Warranty (except for filters) years	2

Replacement filters FT11**210-0323-ESD**

Top filter

211-1111-ESD

Main filter

210-0309

Filter discs (white) (10 pcs)

210-0313

Filter discs (pink) for heavy soldering (10 pcs)



Filtronic Sweden

High vacuum systems

for tip extraction integrated on soldering iron.

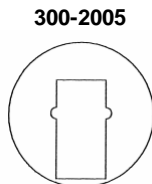
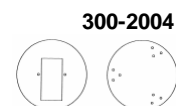
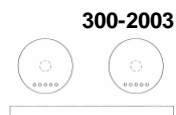

Article number

Description

112-4000-ESD

Filter unit FE3000, ESD-safe

Electrically operated filter unit for 1-2 soldering irons.

Technical data FE 3000

Maximum connected irons	2
Height (mm)	335
Width (mm)	180
Depth (mm)	280
Weight (kg)	6,7
Sound level dB(A) 1 m	42
Voltage 1-phase 50/60 Hz (Volt)	(115) 200-240
Effect (watt)	45
Suction capacity (l/min) (two irons connected)	>50
Micro filter – tested separation degree DOP	>99,99%
Gas filter – Purafil CP-Media, separation degree	>99%
Warranty (except for filters) years	1

112-4115-ESD

Filter unit FE3000, 115V with cable stand, ESD-safe

Electrically operated filter unit for 1-2 soldering irons (data in brackets).

Please state which power cord you require:

PC-UK

Power cord model United Kingdom

PC-EU

Power cord model Europé

PC-US

Power cord model USA

PC-AU

Power cord model Australia

212-4012-ESD

Replacement filter FE3000

Main filter FE3000

210-0316

Filter discs (10 pcs), FE3000

Special filters for FT- and FE-units

911-1000

PREFILTER 911

Prefilter to be adapted to FT- or FE-units when the life of the ordinary main filter is short caused by heavy smoke.

911-2000

Replacement filter PREFILTER 911

210-0326-ESD

Top filter with exhaust air connection

For FT-units (units produced in 1994 and later)

Spare parts FT- and FE-Series

Replacement vanes and top filter for FE12-units

Radiator fan FE12

Printed circuit board FE12

Renovating kit for pump FT Electric

Throttle valve FT1, FT11, FT12

Hose set FT

Ejector (for FT1, FT11, FT12)

Sound damper set FT (model 1)

Sound damper set FT (model 2)

Sound damper set FT (model 3)

Throttle valve FT13

300-1000

300-1001

300-1002

300-1003

300-2000

300-2001

300-2002

300-2003

300-2004

300-2005

300-2007

300-2003

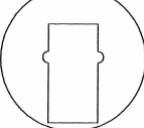



Filtronic Sweden

Central system

for tip extraction integrated on soldering iron



Article number

115-0000
150-0000

Description

Central unit FC15-M

Central unit FC50-M

Micro process controlled filter units for up to 18 and 50 soldering irons respectively.

Technical data

	FC15-M	FC50-M
Max. No. of soldering irons (pcs)	18	50
Diameter (mm)	385	385
Height (mm)	920	920
Weight (kg)	30	30
Voltage (Volt)	1-phase 230	1-phase 230
Effect (kW)	0,4	1,2
Sound level dB(A)	53	56
Maximum air flow (m ³ /h)	72	130
Working vacuum (mmvp)	100-1250	100-1500
Max. vacuum (mmvp)	1250	1500
Separation degree for particles DOP	99,99%	99,99%
Gas filter	purafil CP-media	purafil CP-media
Visual filter guard gas	Yes	Yes

Please state which power cord you require:

Power cord model United Kingdom

Power cord model Europé

Power cord model USA

Power cord model Australia

PC-UK
PC-EU
PC-US
PC-AU

Replacement filter FC15-M, FC50-M, FC52, FC102

Replacement filter for soldering smoke.

Replacement filter for solvent and glue (without micro filter)

252-2000
252-2001



520-2000

520-2001

Accessories for FC15-M/ FC50-M

Mounting console for remote control FC15-M/FC50-M

Suction hood for FC15-M/ FC50-M with exhaust air connection

Tube system Ø 50 mm

for installation of central units

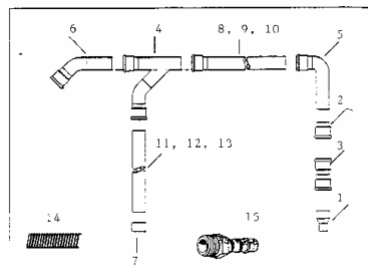

1. 520-1000
2. 520-1001
3. 520-1002
4. 520-1003
5. 520-1004
6. 520-1005
7. 520-1006
8. 520-1007
9. 520-1008
10. 520-1009
11. 520-1010
12. 520-1011
13. 520-1012
14. 520-1015
15. 520-1014
520-1013

Reduction Ø50/32 mm

Socket

Double socket

Branch pipe

Bend of 90°

Bend of 45°

End plug

Pipe 5 m incl. socket

Pipe 2,5 m incl. socket

Pipe 1,25 m incl. socket

Pipe 5 m without socket

Pipe 2,5 m without socket

Pipe 1,25 m without socket

Hose Ø 50 mm (meter) incl. 2 pcs hose clamps

Hose connection incl. sealing plug

Pipe clamps



Filtronic Sweden

Central system

for tip extraction integrated on soldering iron

Article number	Description
----------------	-------------

Spare parts FC-Series

300-4000	Pump 1,3 kW
300-4001	Pump 2,2 kW
300-4002	Protective motor switch 2,5-4 A
300-4003	Protective motor switch 4-6 A
300-4004	Pressure switch
300-4005	Hour meter
300-4006	Indicator red light
300-4007	Indicator green light
300-4008	Replacement shunt
300-4009	Sound damper shunt
300-4010	Sound damper outlet
300-4012	Pump FC15-M
300-4013	Pump FC50-M



Filtronic Sweden

Clip-on kits

accessories for extraction on soldering irons

Consisting of: 1 pc clip, 1 pc spot suction nozzle, 2 m hose, 5 pcs e-clips and 1 pc cleaning brush.

NOTE! Soldering iron is NOT included.

FILTRONIC SWEDEN offers you clip-on kits for most models of soldering irons.



Article number

001-0043-ESD

Description

Clip-on kit universal, model 3
For soldering irons from ERSA, Hakko, Weller, Metcal and others



001-0051-ESD

Clip-on kit ERSA Micro tool



001-0061

Clip-on kit JBC 2010/2210



001-0062

Clip-on kit JBC 2045/2245, Weller VMP



001-0082

Clip-on kit Pace PS80/SP2A



001-0093

Clip-on kit Weller WSP80/MLR21/MT1500, Hakko 907/912

ACCESSORIES

010-2823-ESD

Spot suction nozzle for Weller FE

Length (mm): 250 Diameter (mm) 6,0 / 5,5

010-2824-ESD

Spot suction nozzle for clip-on kit MLR-20

Length (mm): 160 Diameter (mm) 4,5 / 3,9

010-2825-ESD

Spot suction nozzle for clip-on kit Metcal/ Universal 3

Length (mm): 200 Diameter (mm) 5,0 / 4,6

010-2826-ESD

Spot suction nozzle for clip-on kit MPR-30

Length (mm): 90 Diameter (mm) 4,5 / 3,9

010-2827-ESD

Spot suction nozzle for clip-on kit ERSA Micro tool

Length (mm): 140 Diameter (mm) 5,0 / 4,6

010-2828-ESD

Spot suction nozzle for clip-on kit Filtronic Universal 3

Length (mm): 220 Diameter (mm) 5,0 / 4,6

010-2833-ESD

Spot suction nozzle for clip-on kit Pace PS80/ SP2A

Length (mm): 220 Diameter (mm) 4,5 / 3,9

010-2834-ESD

Spot suction nozzle for clip-on kit Weller WSP80/ MLR21/MT1500,
Hakko 907/912

Length (mm): 180 Diameter (mm) 6,3 / 5,4

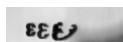

001-0001

E-clips, 6/8 mm

001-0004

E-clips, 6/6 mm

001-0014

E-clips, 4/6 mm



010-1038

On/off-tap for FT-units



010-1041-ESD

Conductive silicone hose Ø 7/4,5 mm, by meter

010-1042-ESD

Conductive silicone hose Ø 8/5 mm, by meter

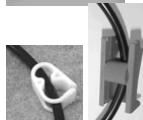

010-1044

Cut-off clip for hose 3-11 mm

010-1045

Cut-off clip for hose 5-14 mm

010-1050

Airflow meter EK

010-4000

Handle for FE3000



010-9901-ESD

Cleaning brush 4 mm, brass

010-9902-ESD

Cleaning brush 5 mm, stainless steel

010-9905-ESD

Cleaning brush 3,2 mm



Filtronic Sweden

Clean Bench Concept

The new efficient way of control air pollution.

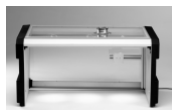

Article number	Description
CBC-A-112-G01-G65-I1	Air Curtain Cabinet, basic model Model CBC-A-112, cabinet with special recirculation system to create a clean workbench environment with less extracted air. Supplied with a sheet top cover (1160x580x1,25 mm) with one Ø 100 mm connection (G01) and a sheet backside panel (1160x600x1,25 mm) (G65). Internal halogen lighting 3x20W, 100-240V.
I3	To add internal accessories: add the following codes:
I4	Mounting Bracket TFT-screen
I5	Tool holder
	Flourescent tube lighting 2x30W, 230V
G65	For change of backpanel: replace code G65 with the following codes:
G70	Back panel in sheet 1160x600x1,25 mm, ESD-safe
G80	Back panel in transparent plexiglas, 1160x600x3 mm, not ESD-safe
	Back panel transparent polycarbonate, 1160x600x3 mm, ESD-safe
G01	For change of topcover: replace code G01 with the following codes:
	Top cover in sheet 1160x580x1,25 mm with one Ø 100 mm connection, ESD-safe
G02	Top cover in sheet 1160x580x1,25 mm with one Ø 160 mm connection, ESD-safe
G04	Same as G01 but with 4 quick connections to fit 2 x MG100S
G21	Top cover in transparent plexiglas 1160x580x3 mm with Ø 100 mm connection, not ESD-safe
G24	Same as G21 but with 4 quick connections to fit 2 x MG100S
G31	Top cover in transparent polycarbonate, 1160x580x3 mm with Ø 100 mm connection, ESD-safe
G34	Same as G31 but with 4 quick connections to fit 2 x MG100S
	Technical details CBC-A-112:
	Dimensions internally WxHxD (mm) 1120x525x580
	Height is inside gear
	Dimensions externally WxHxD (mm) 1275x625x760
	Extracted air volume (m³/hr) 180-230
	Weight (kg) 53
	Voltage 110/240V, 50/60Hz
	Tube lighting only in 230V/50Hz
	Power (watt) 60
	Noise level dB(A) 1 m at 200 m³/hr 49
	Warranty (year) 1
PC-UK	Please state which power cord you require:
PC-EU	Power cord model United Kingdom
PC-US	Power cord model Europe
PC-AU	Power cord model USA
	Power cord model Australia
H01	External accessories
H02	Silencer Ø 100 mm, length 1000 mm
	Silencer Ø 160 mm, length 1000 mm
H03	Barrel nipple Ø 100 mm
H04	Barrel nipple Ø 160 mm



Filtronic Sweden

Suction cabinet

**600-1000**

Description

Model 1

Made of nature anodised aluminium with vertical sliding hatch 4 mm simple glass.

Is connected to suction unit or existing ventilation. The quantity of exhaust air for the suction cabinet should be dimensioned in that way that an air speed of 0,5 m/s is exceeded by opening of the hatch. Please contact FILTRONIC AB for further information.

Suction cabinet, aluminium

Width (mm)	1000
Height (mm)	1000
Depth (mm)	600

600-1001

Suction cabinet, aluminium

Width (mm)	800
Height (mm)	600
Depth (mm)	600

If you want other measures than above you can make a made-to-measure-order.

Model 2

Made of nature anodised aluminium with firm opening 4 mm simple glass.

Is connected to suction unit or existing ventilation. The quantity of exhaust air for the suction cabinet should be dimensioned in that way that an air speed of 0,5 m/s is exceeded by opening of the hatch. Please contact FILTRONIC AB for further information.

**600-1500**

Suction cabinet, aluminium

Width (mm)	800
Height (mm)	300
Depth (mm)	440

If you want other measures than above you can make a made-to-measure-order.



Filtronic Sweden

Replacement filters

for all filter units in our assortment

Article number	Description
750-2000-ESD	<u>Replacement filters MG75</u>
750-2002-ESD	Micro/gas filter, standard
750-2003-ESD	Micro/gas filter, Clean Room
750-2005-ESD	Micro/gas filter, solvents type MEK
750-2006-ESD	Micro/gas filter, Epoxy-application
750-2007-ESD	Micro/gas filter, ammonia
	Micro/gas filter, CO ₂
950-2000-ESD	<u>Replacement filters MG95</u>
950-2002-ESD	Micro/gas filter, standard
950-2003-ESD	Micro/gas filter, Clean Room
950-2005-ESD	Micro/gas filter, solvents type MEK
950-2006-ESD	Micro/gas filter, Epoxy-application
950-2007-ESD	Micro/gas filter, ammonia
	Micro/gas filter, CO ₂
100-2000-ESD	<u>Replacement filters MG100S</u>
100-2003-ESD	Micro/gas filter, standard
100-2005-ESD	Micro/gas filter, solvents type MEK
100-2006-ESD	Micro/gas filter, Epoxy-application
100-2007-ESD	Micro/gas filter, ammonia
	Micro/gas filter, CO ₂
800-2000	<u>Replacement filters MG350S</u>
800-2001	Micro filter
800-2003	Gas filter, standard
800-2006	Gas filter, solvents type MEK
800-2007	Gas filter, ammonia
	Gas filter, CO ₂
500-2000	<u>Replacement filters BT75</u>
500-4000	Micro filter
	Pre filter bag (5 pcs/pack)
210-0309	<u>Replacement filters FT11</u>
210-0313	Filter discs (white) 10 pcs
210-0323-ESD	Filter discs (pink) for heavy soldering (10 pcs)
211-1111-ESD	Top filter
	Main filter
210-0309	<u>Replacement filters FT12</u>
210-0310	Filter discs (white) 10 pcs
210-0313	Top filter (modell 93)
210-0323-ESD	Filter discs (pink) for heavy soldering (10 pcs)
212-0012-ESD	Top filter
	Main filter
210-0316	<u>Replacement filters FE3000</u>
212-4012-ESD	Filter discs (pink) (10 pcs)
	Main filter
252-2000	<u>Replacement filters FC15-M / FC50-M</u>
252-2001	Filter for soldering smoke
	Filter for solvent and glue (without micro filter)



Filtronic Sweden

Replacement filters

for discontinued filter units

Article number	Description
700-2000-ESD	<u>Replacement filters MG70</u>
700-2001-ESD	Micro filter
700-2002-ESD	Gas filter
700-2003-ESD	Gas filter, Clean Room
	Gas filter, solvents type MEK
780-2000-ESD	<u>Replacement filters MG80S</u>
780-2003-ESD	Micro/gas filter
	Micro/gas filter, MEK-application
2000-2000	<u>Replacement filters FC2000</u>
2000-2040	Gas filter FC2000, 100% purafil
2000-2050	Gas filter FC2000, 90% carbon, 10% pruafil
2000-2060	Gas filter FC2000, 100% kol
	Gas filter FC2000, 50% carbon, 50% purafil
2000-2010	Micro filter FC2000
2000-2030	Dust filter FC2000
2000-2031	Dust filter FC2000, same as above but with higher filtering class.
210-0323-ESD	<u>Replacement filter FT1</u>
211-0011-ESD	Top filter
210-0308	Main filter
210-0315	Filter discs (white) (10pcs)
	Filter discs (pink) for heavy soldering (10 pcs)
210-0323-ESD	<u>Replacement filter FT13</u>
210-0310	Top filter
213-0013-ESD	Top filter (model93)
210-0309	Main filter
210-0313	Filter discs (white) (10pcs)
	Filter discs (pink) for heavy soldering (10 pcs)
210-0323-ESD	<u>Replacement filter FE12, FE12-S</u>
212-0012-ESD	Top filter
210-0309	Main filter
210-0313	Filter discs (10 pcs)
	Filter disc (pink) for heavy soldering (10 pcs)
212-3012	<u>Replacement filter FT Electric</u>
210-0313	Main filter FT Electric
	Filter discs (pink) for heavy soldering (10 pcs) FT Electric
210-0327	<u>Replacement filters and accessories to High vacuum PCB-Cleaner</u>
213-5013	Top filter
010-1303	Main filter
010-1304	Prefilter
010-1306	Container for prefilter
010-1310-ESD	Handle
010-1043-ESD	Nozzle with thread for handle 010-1306
010-1305-ESD	Conductive silicone hose 12/7 mm
010-1311	Brush with thread for handle (010-1306)
010-1308-ESD	On/off-tap for PCB-cleaner
	Holder for handle 010-1306 (excl screws)