

To install your XM-EXT50 please follow the instructions and illustrations listed below:

Step 1

Remove rubber boot as shown.

Step 2

Insert antenna's connector through the rubber boot as illustrated and into amplifier's connector. Replace rubber boot.

Step 3

Insert the cable's connector into the connector marked ANT or Antenna on the XM receiver or Plug & Play system.



Warning

DO NOT attempt to cut, splice or otherwise shorten the cable! Any remaining length should be carefully coiled.

DO NOT kink the cable. Avoid bending cable with a bend radius of less than 1 inch.

DO NOT expose the cable to severe environmental conditions. Care should also be taken to avoid direct and high moisture areas.

DO NOT link more than two extension kits.

Step 1

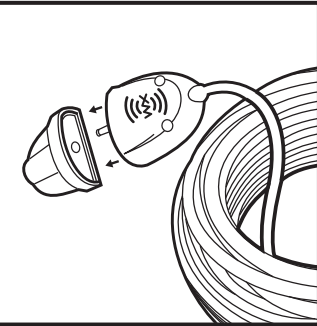

Step 2

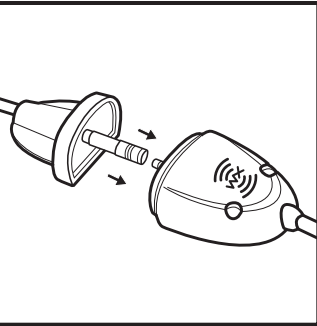

Step 3

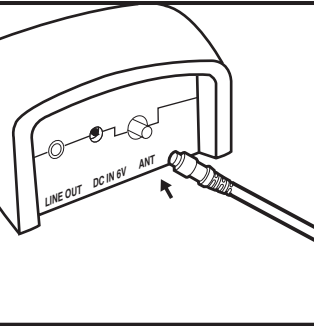

Yes

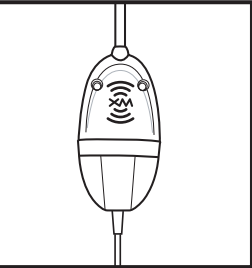

Please mount amplifier upright as shown above.

No

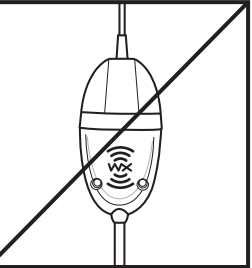

Please refer to the XM-EXT50 user guide included with your receiver to complete your XM system set up.

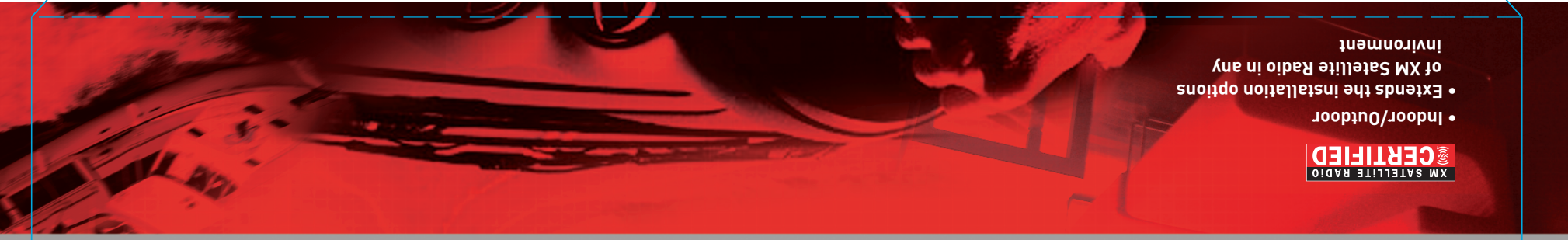

**CERTIFIED**  
XM SATELLITE RADIO

- Indoor/Outdoor
- Extends the installation options of XM Satellite Radio in any environment

**XM-EXT50 50' EXTENSION KIT**

For use with all XM Satellite Radio Systems\*

**TERK**



Specifications

Cable Length	50 feet
Cable Type	RG-58
Frequency	2300 to 2400 MHz
Amplifier Gain	10dB +/- 1 dB @ 2300 MHz
Return Loss	-10dB
Connectors	SMB

Installation instructions printed on the inside of this card.

**TERK**

For additional information:  
Call 1.800.942.TERK (8375)  
or visit [www.terk.com](http://www.terk.com)

For additional information about XM Satellite Radio service  
visit [www.xmradio.com](http://www.xmradio.com)

Made in China

One year limited warranty

The XM name and related logos are trademarks of  
XM Satellite Radio inc.

TERK and TERK Technologies are trademarks of  
TERK Technologies Corp. Commack, NY

©2004 TERK Technologies Corp.  
136P003

