

## 1 Pick a Spot for Your Radio

### Install the Dash or Vent Mount

You can use either the Dash Mount or the Vent Mount for your Starmate 5, depending upon your vehicle and the location where you want to place your radio.

**CAUTION!** Make sure your radio isn't in a place where it could interfere with driver visibility or safe deployment of the airbags.

#### Installing the Dash Mount:

**CAUTION:** The adhesive used on the Dash Mount may be difficult to remove. Do not install this mount on leather surfaces (contact your vehicle dealer if you are unsure about your dash surface), and make sure the air temperature is at least 60°F (15°C) during installation. If it's not at least 60°F, turn on the heater in your vehicle to bring the temperature up to 60°F.

- 1 Locate a flat surface for the Dash Mount. (Options 1, 2, or 3.) Make sure there is ample room for the dock and radio when installed.

- 2 Set the orientation of the mount before adhering it. Loosen the knob and adjust the adhesive foot for the location you selected:

- Option 1 & Option 3 should be oriented as I.
- Option 2 should be oriented as II.

- 3 Clean the surface with the alcohol preparation pad, and let it dry thoroughly.

- 4 Attach the Dash Mount to the PowerConnect Vehicle Dock using the provided screws.

- 5 Peel off the adhesive liner. Position, press, and hold the Dash Mount in place for 30 seconds.

**IMPORTANT!** Allow the Dash Mount adhesive to cure (dry) for a minimum of 2-4 hours before using the mount. The best adhesion occurs after 24 hours.

- 6 The dock mounting plate can be tilted in different directions.

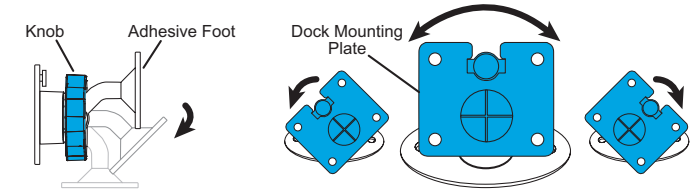

## Pick a Spot for Your Radio (continued)

### Installing the Vent Mount:

- 1 Locate a suitable vent in your vehicle which is strong enough to hold the Starmate 5 and the PowerConnect Vehicle Dock. (Options 4 or 5.)

- 2 If the vent louvers are recessed, you'll have to use the extended vent clamps. The Vent Mount is assembled with the short vent clamps, so you will have to remove the short clamps and install the extended clamps as shown below.

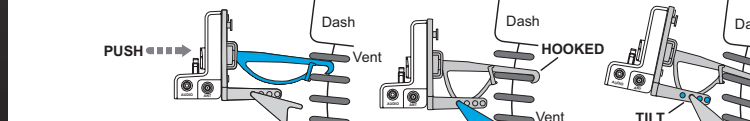
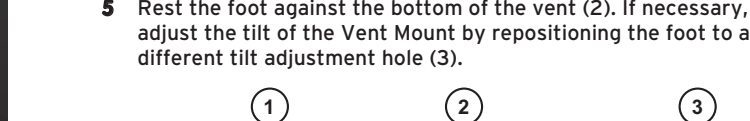
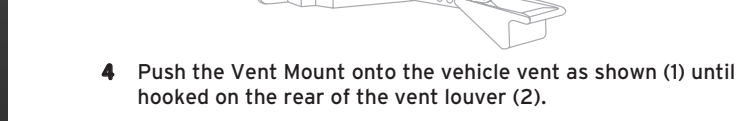
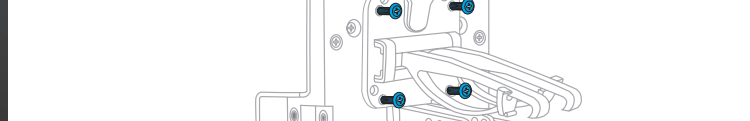
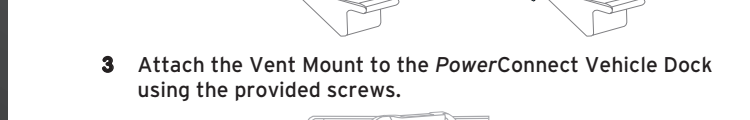
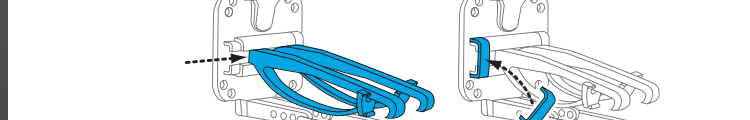
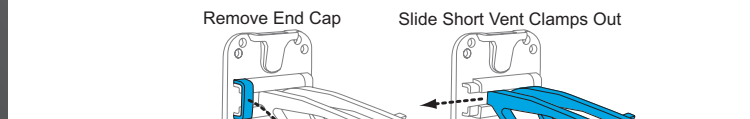

## 2 Install the Magnetic Mount Antenna

### Mount the Magnetic Mount Antenna

Choose the best location for the antenna considering your vehicle type. Refer to the antenna placement tips and cautions in the User Guide beginning on page 23.

- **Sedan or Coupe:** We recommend mounting the antenna above either the front windshield or the back window.
- **Pickup Truck:** We recommend mounting the antenna above the front windshield.
- **Convertible:** We recommend mounting the antenna at the leading edge of the trunk.
- **SUV:** We recommend mounting the antenna at the rear of the roof.

**CAUTION! STOP** and read the more specific instructions in the User Guide for all types of vehicles – or get someone who knows vehicles to help – if you don't understand what to do. You might accidentally do damage to your vehicle.

Attach the Rubber Tail to the antenna and press the antenna cable into the Rubber Tail. Use the Rubber Tail to position the antenna the correct distance from the edge of the roof or trunk lid.

Clean the surface of the selected mounting location using the alcohol preparation pad and let it dry thoroughly. Peel the protective material from the adhesive strips and press the Rubber Tail firmly into place on the vehicle for 30 seconds. At room temperature (68° F), maximum adhesion usually occurs within 72 hours. During this period, avoid car washes and other contact with the antenna and the Rubber Tail.

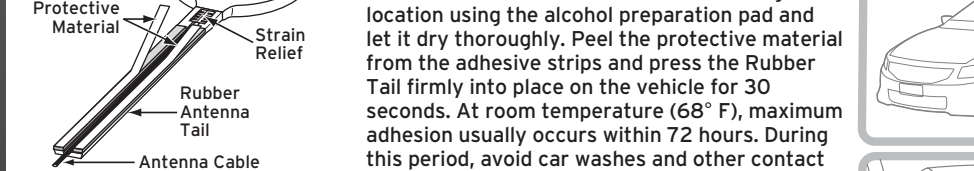

Feed the antenna wire under the rubber molding around the front or rear windshield, and into the seal around the trunk or door. For a convertible, the cable can be routed directly into the trunk.

**TIP!** Use a tool like a blunt plastic putty knife, a credit card, a plastic knife, or a similar blunt tool to help hide wires along the windshield trim.

### Hide the Magnetic Mount Antenna Cable Inside the Vehicle

The best place to hide your antenna cable depends on your type of vehicle.

When the antenna is mounted at the rear of the vehicle, it's usually easiest to run the cable from the rear to the front toward the radio by routing the cable along the interior trim where it meets the carpet, gently pushing it behind the edges of the trim. Bring the cable out from the trim and route it under the carpet toward the dashboard.

When the antenna is mounted at the front of the vehicle, bring the cable into the rubber weather stripping around the door to the bottom of the door opening. Bring the cable out of the weather stripping and route it under the carpet toward the dashboard.

Coil any excess cable in a hidden location, such as under the carpet, keeping it away from any vehicle pedals or controls. Secure the excess cable with wire ties.

Plug the antenna into the silver ANT connection on the right side of the dock.

**TIP!** Avoid damaging or compromising the window, door, and trunk seals.

**TIP!** For more help, refer to the detailed antenna cable routing instructions for your type of vehicle, in the User Guide beginning on page 26.

## 3 Connect the Audio to Your Vehicle's Stereo

### Decide How to Connect

You will listen to the Starmate 5 through your vehicle's stereo system or FM radio. First, the Starmate 5 must be receiving the SIRIUS signal. Ensure your vehicle is outside with the antenna having a clear view of the sky. Your audio connection options are:

- **Best:** Use the **Aux In Cable** if your vehicle's stereo system has an auxiliary input connection. Plug one end of the cable into the **green AUDIO** connector on the PowerConnect Vehicle Dock and the other end into the vehicle stereo system's auxiliary input jack. Set the stereo system to play from the auxiliary input source.

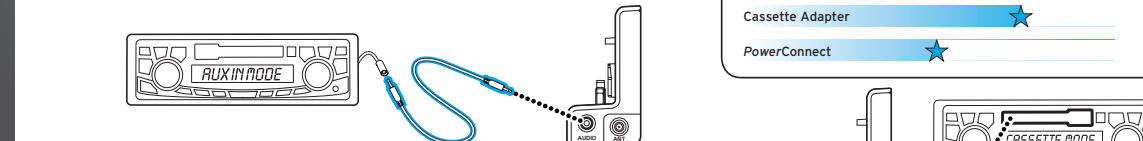

- **Better:** Use a **Cassette Adapter** if your vehicle has a built-in cassette player. Cassette Adapters are sold separately. Plug the Cassette Adapter into the **green AUDIO** connector on the PowerConnect Vehicle Dock. Insert the Cassette Adapter into the vehicle's cassette deck. Set the stereo system to play from the cassette source.

- **Good:** Use the **PowerConnect** feature in the Starmate 5. PowerConnect plays the audio through your vehicle's FM radio. When you have finished step 4 (below), you'll first need to find an available FM channel in your area, and then you need to ensure that the Starmate 5 and your vehicle's FM radio are tuned to the same available FM channel. (Step 5)

- **Best:** Use an **FM Direct Adapter (FMDA)** if none of the above three audio connection options works in your vehicle. The FMDA needs to be installed by a professional installer and directly connects the Starmate 5 to your vehicle's FM radio.

**TIP!** Refer to your vehicle's owners manual to find the location of the auxiliary input jack, or consult the vehicle dealer. To learn more about purchasing a Cassette Adapter or FMDA, check with the retailer where you bought your Starmate 5 or go to [sirius.com/accessories](http://sirius.com/accessories).

## 4 Finish the Installation and Power On

### Connect the PowerConnect Power Adapter

Insert the PowerConnect Power Adapter into your vehicle's cigarette lighter or power adapter socket. Then plug it into the **red PWR** connector on the left side of the dock.

### Place the Radio in the Dock

Insert your Starmate 5 into the dock, aligning the radio against the rear of the dock so that the rails on the dock fit into the mounting slots in the back of the radio.

Press the **Power** button to turn it On.

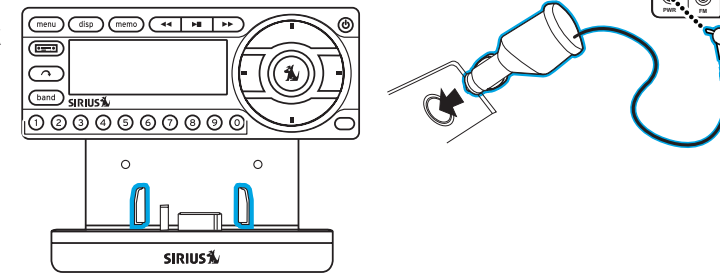

## 5 PowerConnect

If you have connected the audio in step 3 using the Aux In Cable or Cassette Adapter, continue with step 6.

### Tune the Starmate 5 and Vehicle FM Radio to the Same FM Channel

- 1 Find an Available FM Channel in Your Area

An available FM channel is one that's not being used by an FM radio station in your area. When you tune your FM radio to an available channel, you should only hear static or silence – not talk or music. We recommend one of the following methods to find an available FM channel:

- a. Use the SIRIUSXM FM Channel Finder at [www.sirius.com/fmchannel](http://www.sirius.com/fmchannel). Go to the website and enter your zip code. The Channel Finder will suggest a list of available FM channels in your area. For convenience, write down or print out the list.

OR

- b. Manually tune through your local FM channels on your vehicle's FM radio. Locate and create a list of channels that aren't being used by any FM radio station. Write down the list. Once you have created your list of available FM channels, you will need to find the one that provides the best match for the Starmate 5.

**TIP!** You'll need to use the 'Manual' tune function on your vehicle's FM radio to tune through every FM channel one-by-one. Turn on your vehicle's FM radio. Start at 88.1 and use the 'Manual' tune function on your vehicle's FM radio to tune through each FM channel one-by-one (88.1 followed by 88.3 etc.) to locate channels that aren't being used by a local FM radio station. Write down each FM channel that has only static or silence on it, until you reach 107.9.

- 2 Tune your Vehicle's FM Radio

- a. Pick the first FM channel on your list.
- b. Turn on your vehicle's FM radio (if you have not already done so) and tune it to this FM channel.



- 3 Set Your Starmate 5 to Transmit on the Same FM Channel

- a. Press **menu**.
- b. Press the **Down** button to scroll and highlight **FM Transmitter** and press the **Select** button.

- c. **FM Presets** will be highlighted. Press the **Select** button.

- d. Press the **Down** button to scroll and highlight the storage location **FM2**. Press the **Select** button.

- e. Tune to the FM channel you found in step 3. Press the **Up** or **Down** button to tune in steps of .2, i.e., 99.3 to 99.5. Press the **Left** or **Right** button to tune in steps of 1, i.e., 99.3 to 100.3. When the desired FM channel is displayed on screen, press the **Select** button.

- f. The FM channel you selected will be confirmed on the display screen. The Starmate 5 will tune to the FM channel.

- g. You should hear SIRIUS through your vehicle's radio when Starmate 5 is tuned to channel 184. If you are satisfied with the sound quality, you're done.

FM Presets
FM1 88.1 MHz
FM2 <EMPTY>
FM3 <EMPTY>
FM4 <EMPTY>

FM2 Frequency
96.3 MHz

FM Presets
FM1 88.1 MHz
FM2 96.3 MHz
FM3 <EMPTY>
FM4 <EMPTY>

## PowerConnect (continued)

- 4 You May Need to Try Other FM Channels on Your List

If the chosen FM channel doesn't work well for you, work down the list of FM channels until you find one that allows you to hear SIRIUS clearly. Each time, you will need to tune your vehicle's FM radio and the Starmate 5 to the same FM channel.

**TIP!** You may find an FM channel with static or silence that does not work with the Starmate 5. It is possible that some type of inaudible interference is present that prevents reception of the Starmate 5 broadcast. Your only options are to use another FM channel or a different audio connection method.

## 6 Activate

### Activate Your Service

Before you can enjoy Commercial-Free Music, Plus Sports, News, Talk & Entertainment, you need to activate your Starmate 5.

- 1 Make sure your Starmate 5 is properly installed, turned on, and receiving the SIRIUS signal so that you can hear the audio on channel 184.

- 2 Make a note of your SIRIUS Radio ID. You can find it:

- On channel 0 (zero)
- On a label on the bottom of the gift box
- On the label on the back of your Starmate 5

- 3 Activate your service:

- Online: Go to [www.sirius.com](http://www.sirius.com) and click on "Install and Activate"

OR

- By phone: Call 1-888-539-SIRIUS (1-888-539-7474)

- 4 When your service is activated, your Starmate 5 will display an alert message. To continue, press any button. Thereafter, if you press the **Up** or **Down** button you can scroll and tune other channels. Activation usually takes less than 5 minutes, but sometimes may take longer. We recommend that your radio remain on until activated.

**TIP!** If the signal reception is low, check to see if the antenna's view of the sky is blocked by a tree, a building, a bridge, or by anything on the vehicle roof such as a roof rack or luggage container, etc. Adjust until you are receiving a good signal.

To check the signal, press **menu**, press the **Down** button to scroll and highlight **Signal Indicator**. Press the **Select** button to display the **Signal Indicator** screen.

Signal Indicator
SAT - [ ] +
TER - [ ] +

What's in the Box?

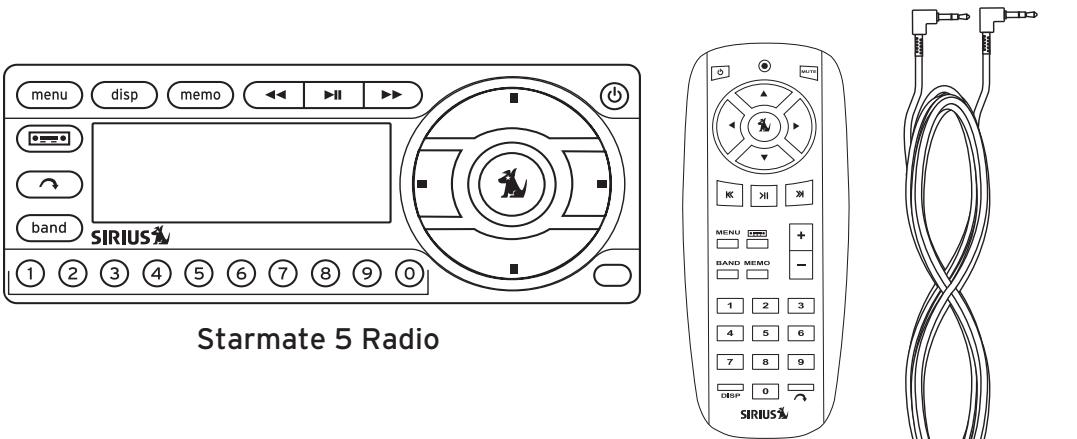

Starmate 5 Radio

Remote Control

Aux In Cable

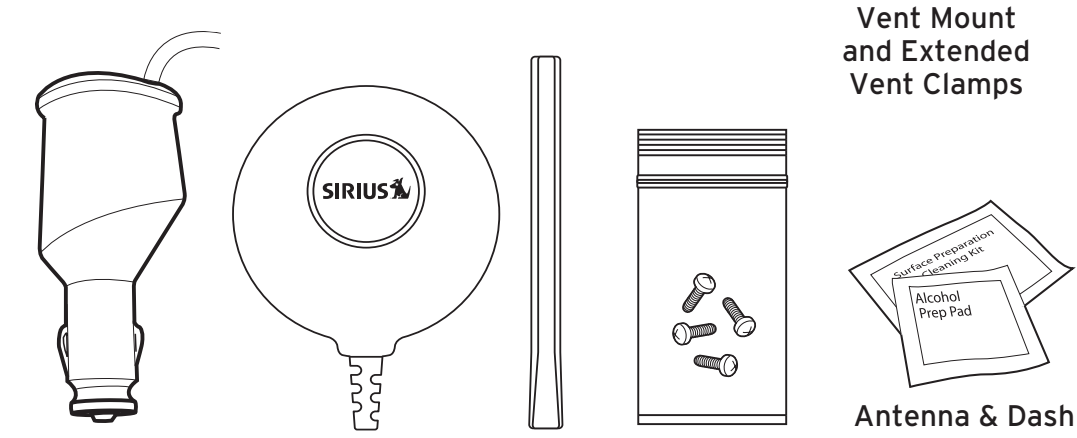
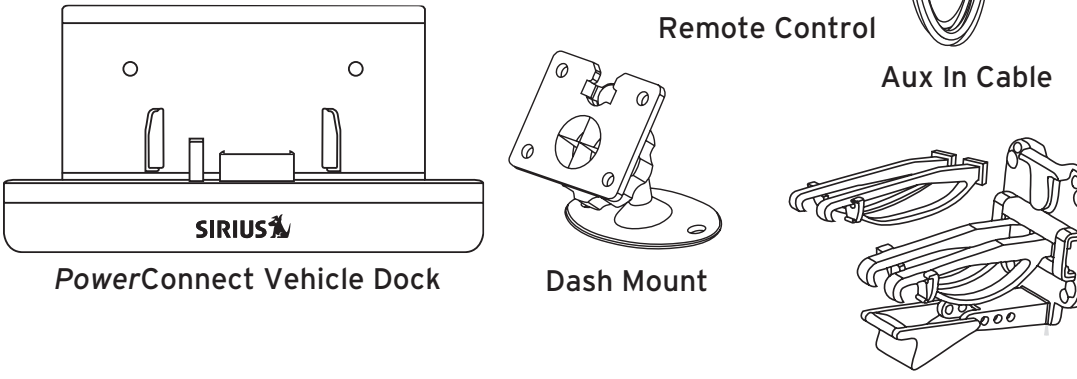

PowerConnect Power Adapter

Magnetic Mount Antenna & Rubber Tail

Screws

Antenna & Dash Mount Alcohol Preparation Pads

[sirius.com](http://sirius.com)

SIRIUS XM Radio Inc.  
1221 Avenue of the Americas  
New York, NY 10020

1.888.539.7474

© 2010 SIRIUS XM Radio Inc.  
SDST5QSG 030210a

# SIRIUS STARMATE 5

## Quick Start Guide



SIRIUS XM | ((XM))  
S A T E L L I T E   R A D I O

Starmate 5 Button Functions

