

1 Pick a Spot for Your Radio

Install the Dash or Vent Mount

You can use either the Dash Mount or the Vent Mount for your Sportster 5, depending upon your vehicle and the location where you want to place your radio.

CAUTION! Make sure your radio isn't in a place where it could interfere with driver visibility or safe deployment of the airbags.

Installing the Dash Mount:

CAUTION: The adhesive used on the Dash Mount may be difficult to remove. Do not install this mount on leather surfaces (contact your vehicle dealer if you are unsure about your dash surface), and make sure the air temperature is at least 60°F (15°C) during installation. If it's not at least 60°F, turn on the heater in your vehicle to bring the temperature up to 60°F.

- 1 Locate a flat surface for the Dash Mount. (Options 1, 2, or 3.) Make sure there is ample room for the dock and radio when installed.
- 2 Set the orientation of the mount before adhering it. Loosen the knob and adjust the adhesive foot for the location you selected:

- Option 1 & Option 3 should be oriented as **I**.
- Option 2 should be oriented as **II**.

- 3 Clean the surface with the alcohol preparation pad, and let it dry thoroughly.

- 4 Attach the Dash Mount to the PowerConnect Vehicle Dock using the provided screws.

- 5 Peel off the adhesive liner. Position, press, and hold the Dash Mount in place for 30 seconds.

IMPORTANT! Allow the Dash Mount adhesive to cure (dry) for a minimum of 2-4 hours before using the mount. The best adhesion occurs after 24 hours.

- 6 The dock mounting plate can be tilted in different directions. Adjust as necessary for your particular vehicle. When the orientation is correct, tighten the knob.

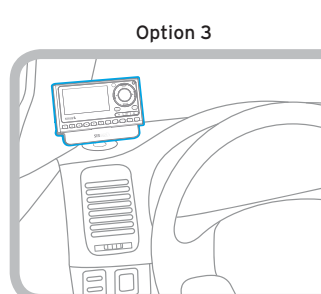
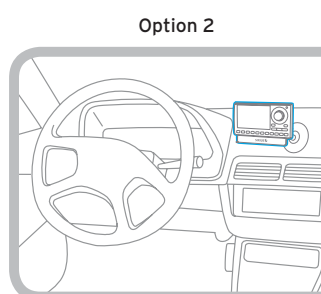
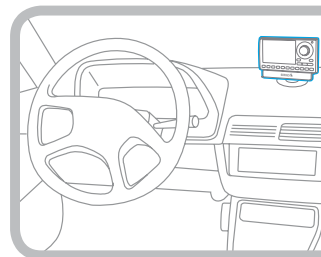
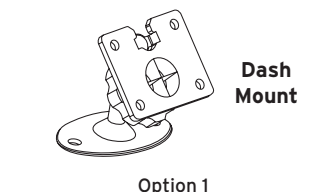
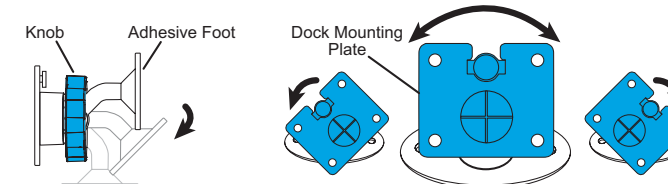

Pick a Spot for Your Radio (continued)

Install the Vent Mount:

- 1 Locate a suitable vent in your vehicle which is strong enough to hold the Sportster 5 and the PowerConnect Vehicle Dock. (Options 4 or 5.)

- 2 If the vent louvers are recessed, you'll have to use the extended vent clamps. The Vent Mount is assembled with the short vent clamps, so you will have to remove the short clamps and install the extended clamps as shown below.

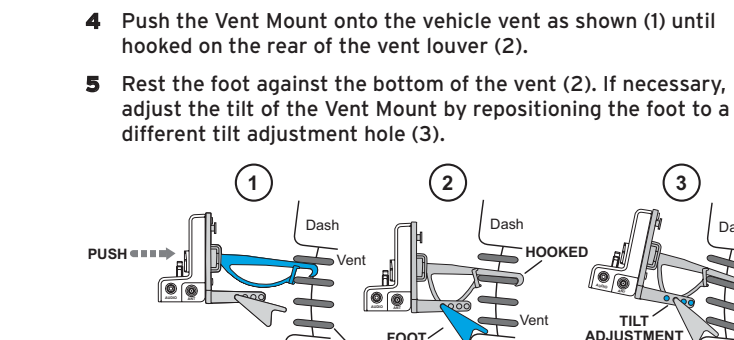
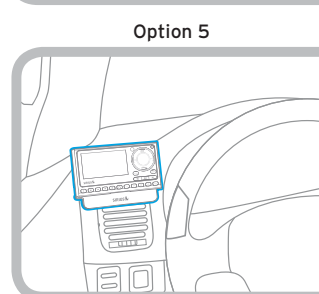
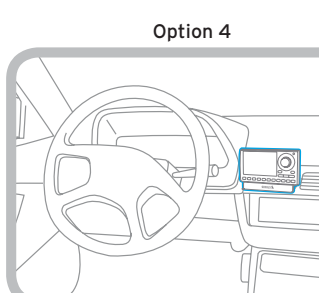
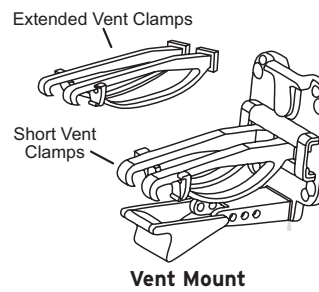
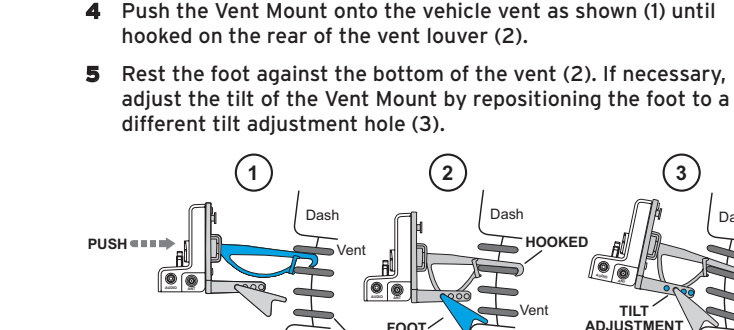
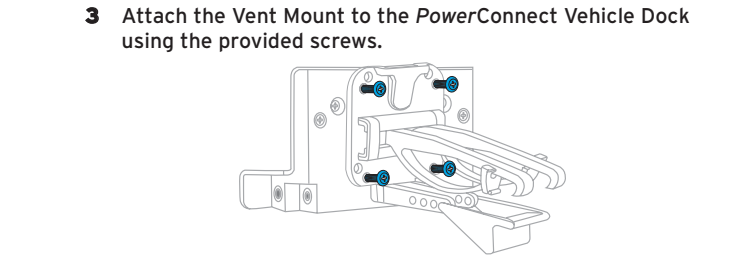
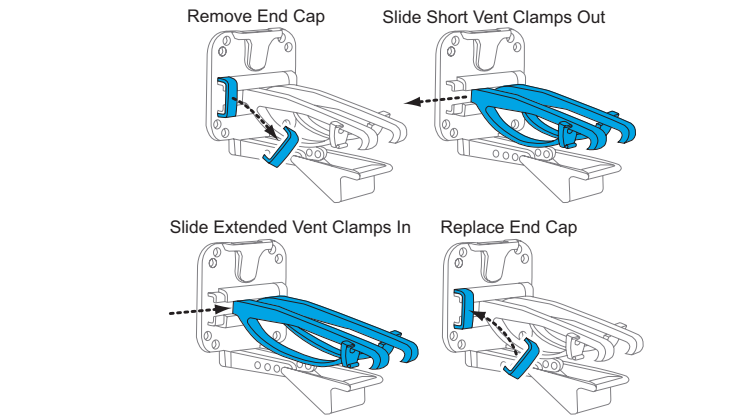

2 Install the Magnetic Mount Antenna

Mount the Magnetic Mount Antenna

Choose the best location for the antenna considering your vehicle type. Refer to the antenna placement tips and cautions in the User Guide beginning on page 23.

- **Sedan or Coupe:** We recommend mounting the antenna above either the front windshield or the back window.
- **Pickup Truck:** We recommend mounting the antenna above the front windshield.
- **Convertible:** We recommend mounting the antenna at the leading edge of the trunk.
- **SUV:** We recommend mounting the antenna at the rear of the roof.

CAUTION! STOP and read the more specific instructions in the User Guide for all types of vehicles – or get someone who knows vehicles to help – if you don't understand what to do. You might accidentally do damage to your vehicle.

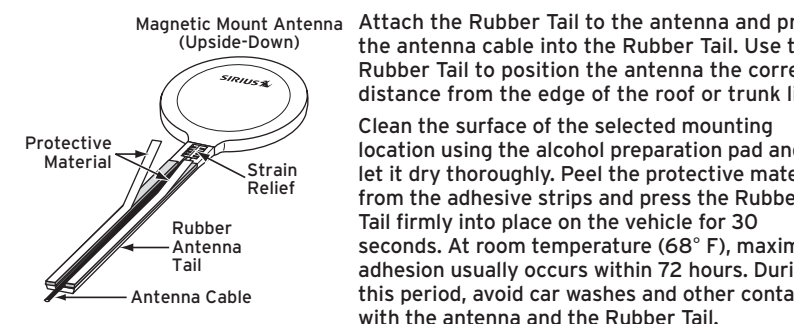

Feed the antenna wire under the rubber molding around the front or rear windshield, and into the seal around the trunk or door. For a convertible, the cable can be routed directly into the trunk.

TIP! Use a tool like a blunt plastic putty knife, a credit card, a plastic knife, or a similar blunt tool to help hide wires along the windshield trim.

Hide the Magnetic Mount Antenna Cable Inside the Vehicle

The best place to hide your antenna cable depends on your type of vehicle.

When the antenna is mounted at the rear of the vehicle, it's usually easiest to run the cable from the rear to the front toward the radio by routing the cable along the interior trim where it meets the carpet, gently pushing it behind the edges of the trim. Bring the cable out from the trim and route it under the carpet toward the dashboard.

When the antenna is mounted at the front of the vehicle, bring the cable into the rubber weather stripping around the door to the bottom of the door opening. Bring the cable out of the weather stripping and route it under the carpet toward the dashboard.

Coil any excess cable in a hidden location, such as under the carpet, keeping it away from any vehicle pedals or controls. Secure the excess cable with wire ties.

Plug the antenna into the **silver ANT** connection on the right side of the dock.

TIP! Avoid damaging or compromising the window, door, and trunk seals.

TIP! For more help, refer to the detailed antenna cable routing instructions for your type of vehicle, in the User Guide beginning on page 26.

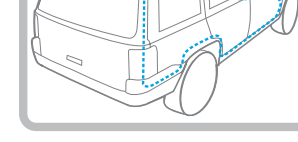
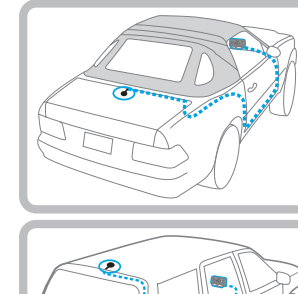
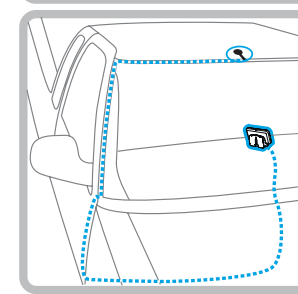
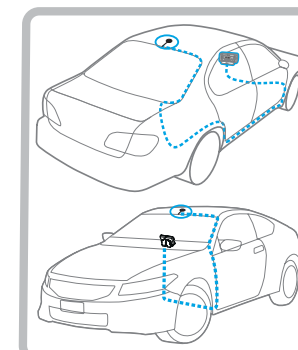
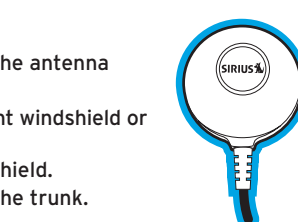

3 Connect the Audio to Your Vehicle's Stereo

Decide How to Connect

You will listen to the Sportster 5 through your vehicle's stereo system or FM radio. First, the Sportster 5 must be receiving the SIRIUS signal. Ensure your vehicle is outside with the antenna having a clear view of the sky. Your audio connection options are:

- **Best:** Use the **Aux In Cable** if your vehicle's stereo system has an auxiliary input connection. Plug one end of the cable into the **green AUDIO** connector on the PowerConnect Vehicle Dock and the other end into the vehicle stereo system's auxiliary input jack. Set the stereo system to play from the auxiliary input source.

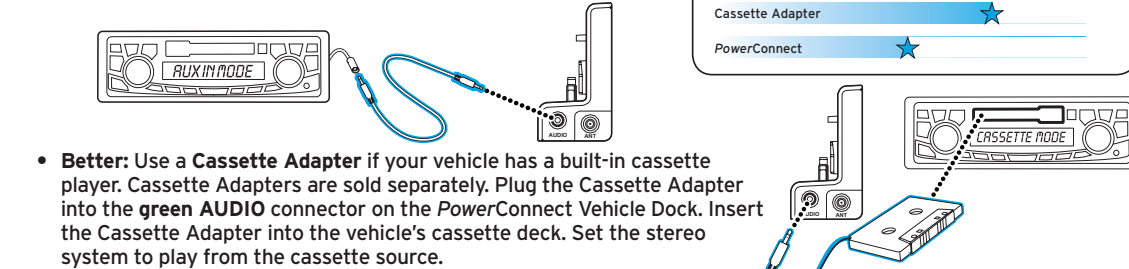

- **Better:** Use a **Cassette Adapter** if your vehicle has a built-in cassette player. Cassette Adapters are sold separately. Plug the Cassette Adapter into the **green AUDIO** connector on the PowerConnect Vehicle Dock. Insert the Cassette Adapter into the vehicle's cassette deck. Set the stereo system to play from the cassette source.

- **Good:** Use the **PowerConnect** feature in the Sportster 5. PowerConnect plays the audio through your vehicle's FM radio. When you have finished step 4 (below), you'll first need to find an available FM channel in your area, and then you need to ensure that the Sportster 5 and your vehicle's FM radio are tuned to the same available FM channel. (Step 5)

- **Best:** Use an **FM Direct Adapter (FMDA)** if none of the above three audio connection options works in your vehicle. The FMDA needs to be installed by a professional installer and directly connects the Sportster 5 to your vehicle's FM radio.

TIP! Refer to your vehicle's owners manual to find the location of the auxiliary input jack, or consult the vehicle dealer. To learn more about purchasing a Cassette Adapter or FMDA, check with the retailer where you bought your Sportster 5 or go to sirius.com/accessories.

4 Finish the Installation and Power On

Connect the PowerConnect Power Adapter

Insert the PowerConnect Power Adapter into your vehicle's cigarette lighter or power adapter socket. Then plug it into the **red PWR** connector on the left side of the dock.

Place the Radio in the Dock

Insert your Sportster 5 into the dock, aligning the radio against the rear of the dock so that the rails on the dock fit into the mounting slots in the back of the radio.

Press the **Power** button to turn it on.

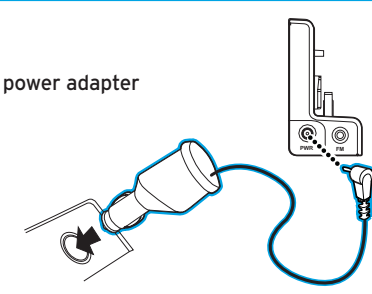
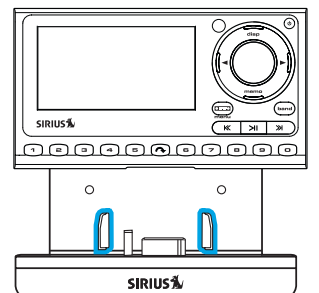

5 PowerConnect

If you have connected the audio in step 3 using the Aux In Cable or Cassette Adapter, continue with step 6.

Tune the Sportster 5 and Vehicle FM Radio to the Same FM Channel

- 1 Find an Available FM Channel in Your Area

An available FM channel is one that's not being used by an FM radio station in your area. When you tune your FM radio to an available channel, you should only hear static or silence – not talk or music. We recommend one of the following methods to find an available FM channel:

- a. Use the SIRIUS|XM FM Channel Finder at www.sirius.com/fmchannel. Go to the website and enter your zip code. The Channel Finder will suggest a list of available FM channels in your area. For convenience, write down or print out the list.
- OR
- b. Manually tune through your local FM channels on your vehicle's FM radio. Locate and create a list of channels that aren't being used by any FM radio station. Write down the list. Once you have created your list of available FM channels, you will need to find the one that provides the best match for the Sportster 5.

TIP! You'll need to use the 'Manual' tune function on your vehicle's FM radio to tune through every FM channel one-by-one. Turn on your vehicle's FM radio. Start at 88.1 and use the 'Manual' tune function on your vehicle's FM radio to tune through each FM channel one-by-one (88.1 followed by 88.3 etc.) to locate channels that aren't being used by a local FM radio station. Write down each FM channel that has only static or silence on it, until you reach 107.9.

- 2 Tune your Vehicle's FM Radio

- a. Pick the first FM channel on your list.
- b. Turn on your vehicle's FM radio (if you have not already done so) and tune it to this FM channel.

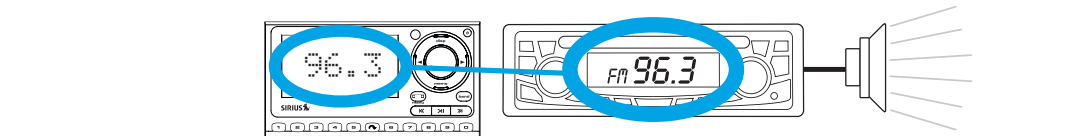

- 3 Set Your Sportster 5 to Transmit on the Same FM Channel

- a. Press and hold **menu** until the menu options are displayed.
- b. Rotate the **Control knob** and scroll to highlight **Settings** and press the **Select** button.
- c. **FM Transmitter** will be highlighted. Press the **Select** button.
- d. **Set FM Presets** will be highlighted. Press the **Select** button.
- e. Rotate the **Control knob** and highlight the storage location **FM2**. Press the **Select** button.
- f. Tune to the FM channel you found in step 1. Rotate the **Control knob** to scroll and highlight the desired FM channel. Press the **Select** button to select the FM channel.
- g. The FM channel you selected will be confirmed on the display screen. The Sportster 5 will tune to the FM channel.
- h. You should hear SIRIUS through your vehicle's radio when Sportster 5 is

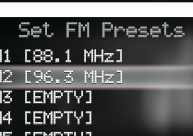
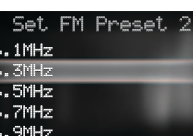

PowerConnect (continued)

tuned to channel 184. If you are satisfied with the sound quality, you're done.

- 4 You May Need to Try Other FM Channels on Your List

If the chosen FM channel doesn't work well for you, work down the list of FM channels until you find one that allows you to hear SIRIUS clearly. Each time, you will need to tune your vehicle's FM radio and the Sportster 5 to the same FM channel.

TIP! You may find an FM channel with static or silence that does not work with the Sportster 5. It is possible that some type of inaudible interference is present that prevents reception of the Sportster 5 broadcast. Your only options are to use another FM channel or a different audio connection method.

6 Activate

Activate Your Service

Before you can enjoy Commercial-Free Music, Plus Sports, News, Talk & Entertainment, you need to activate your Sportster 5.

- 1 Make sure your Sportster 5 is properly installed, turned on, and receiving the SIRIUS signal so that you can hear the audio on channel 184.
- 2 Make a note of your SIRIUS Radio ID. You can find it:
 - On channel 0 (zero)
 - On a label on the bottom of the gift box
 - On the label on the back of your Sportster 5

- 3 Activate your service:

- Online: Go to www.sirius.com and click on "Install and Activate"

OR

- By phone: Call 1-888-539-SIRIUS (1-888-539-7474)

- 4 When your service is activated, your Sportster 5 will display an alert message. To continue, press any button. Thereafter, if you rotate the **Control knob**, you can scroll and tune other channels. Activation usually takes less than 5 minutes, but sometimes may take longer. We recommend that your radio remain on until activated.

TIP! If the signal reception is low, check to see if the antenna's view of the sky is blocked by a tree, a building, a bridge, or by anything on the vehicle roof such as a roof rack or luggage container, etc. Adjust until you are receiving a good signal. To check the signal, press and hold **menu**, rotate the **Control knob** and highlight **Signal Indicator**. Press the **Select** button to display the **Signal Indicator** screen.

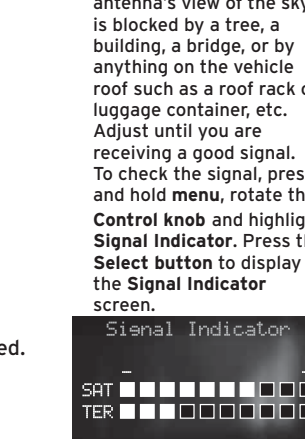

What's in the Box?

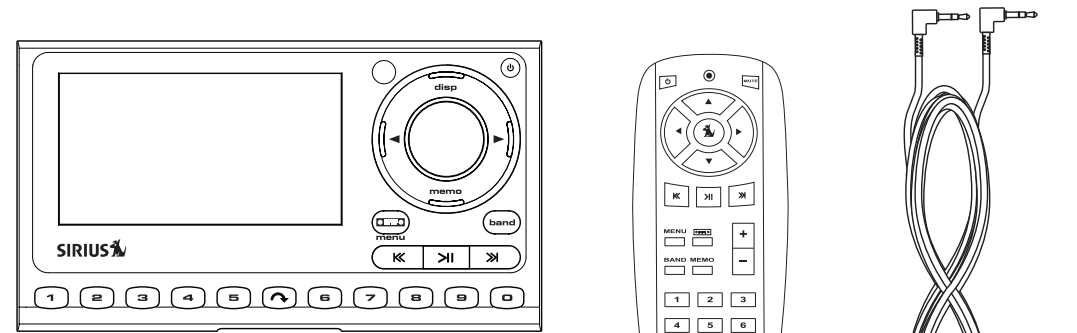

Sportster 5 Radio

Remote Control

Aux In Cable

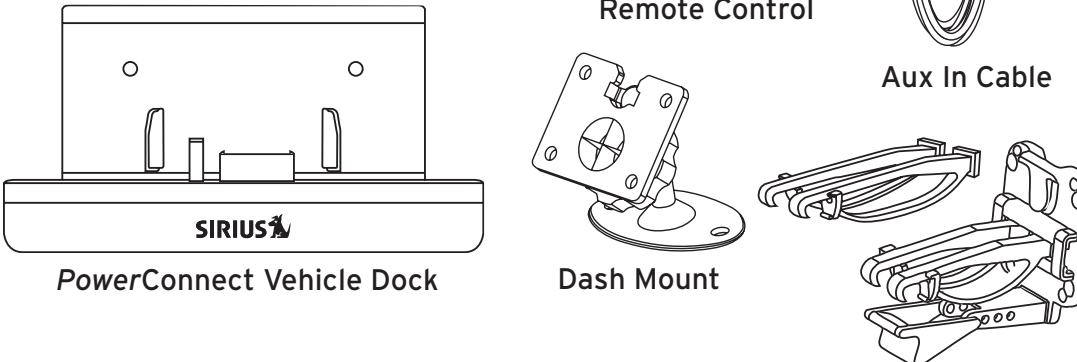

PowerConnect Vehicle Dock

Dash Mount

Vent Mount and Extended Vent Clamps

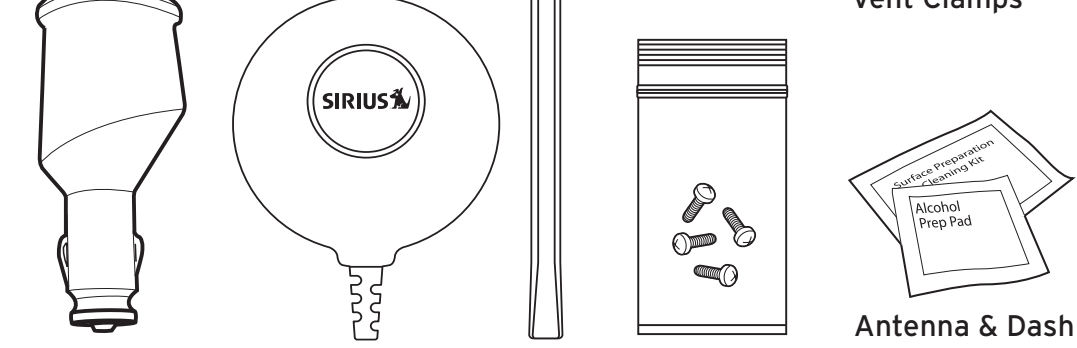

PowerConnect Power Adapter

Magnetic Mount Antenna & Rubber Tail

Screws

Antenna & Dash Mount Alcohol Preparation Pads

SIRIUS SPORTSTER 5

Quick Start Guide



sirius.com

SIRIUS XM Radio Inc.
1221 Avenue of the Americas
New York, NY 10020

1.888.539.7474

© 2010 SIRIUS XM Radio Inc.
SDSP5QSG 031510a

Sportster 5 Button & Control Knob Functions

- FM / Menu Button**
FM: Press to access and cycle through FM presets.
Menu: Press and hold to access advanced features and configuration options; also when in configuration options, press and hold to return to main display screen.
- Left and Right Buttons**
Press and release to search for channels by category. Press and hold to adjust display's brightness.
- Display Button**
Customize the way you view content on the display.
- Power Button**
Turn radio on and off.
- Select Button**
Press to confirm selection of highlighted items in a menu or list; also when not in a menu or list, press first before entering the channel number, to directly tune to a channel. Press and hold to go back to the previous channel.
- Control Knob**
Rotate to preview and tune channels through the channel lineup; also scroll through lists and highlight menu options.
- Band Button**
Press and release to switch between the favorite channel preset banks. Press and hold to view My Presets category.
- Memo Button**
Press and release to save artists and songs. Press and hold to display stored artists and songs.
- Number Buttons**
Select your favorite channels; also enter a channel number.
- Jump Button**
Directly access traffic and weather of the 20 most congested cities; or access a favorite channel.
- Pause and Replay Buttons**
Pause, rewind, and replay up to 60 minutes of live radio.

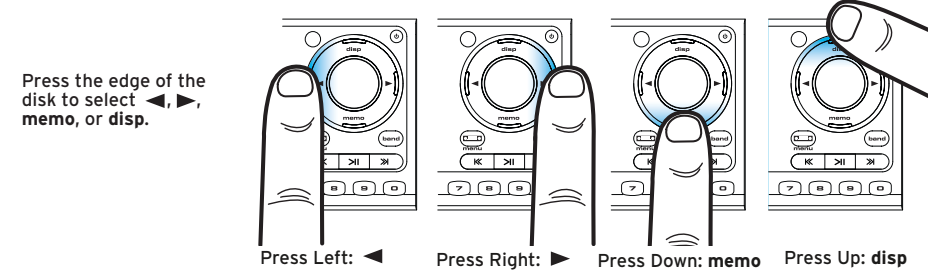
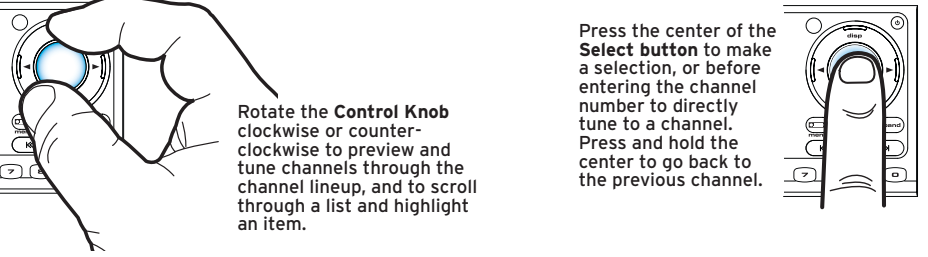

Press Left: ◀ Press Right: ▶ Press Down: memo Press Up: disp