

Product End-of-Life Instructions

ALTIVAR 21 22 – 75 kW IP54

Product Range

ALTIVAR 21 22 – 75 kW IP54

Marketing Model

ATV21WD22N4 and all models of range ALTIVAR 21 22 – 75 kW IP54

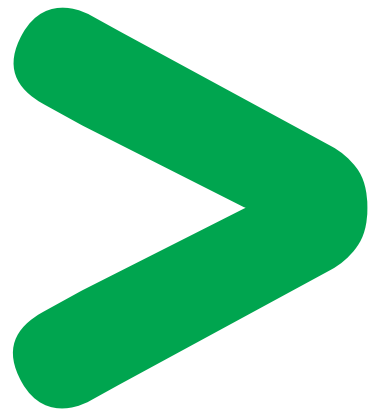

Size in mm (or m):

W x H x D : 284 x 720 x 315

Weight (excluding packaging) in kg (or g):

29170 g



Schneider
Electric

Operations recommended for the end of life treatment

There are several steps to process the products at the end of life so as to recover components, materials or energy:

Reuse ⇒ Depollution ⇒ Dismantling ⇒ Shredding

The components of the products that are recommended to be depolluted (according to the WEEE 2002/96/EC list) or that are recommended to be re-used or dismantled so as to improve the material recovery or that lead to some hazards are listed, identified and located hereunder.

This ATV21 contains electrolytic capacitors which may cause electrical shock during the end of life treatment process. **BEFORE SERVICING, REMOVE ALL POWER and WAIT 15 MINUTES.**

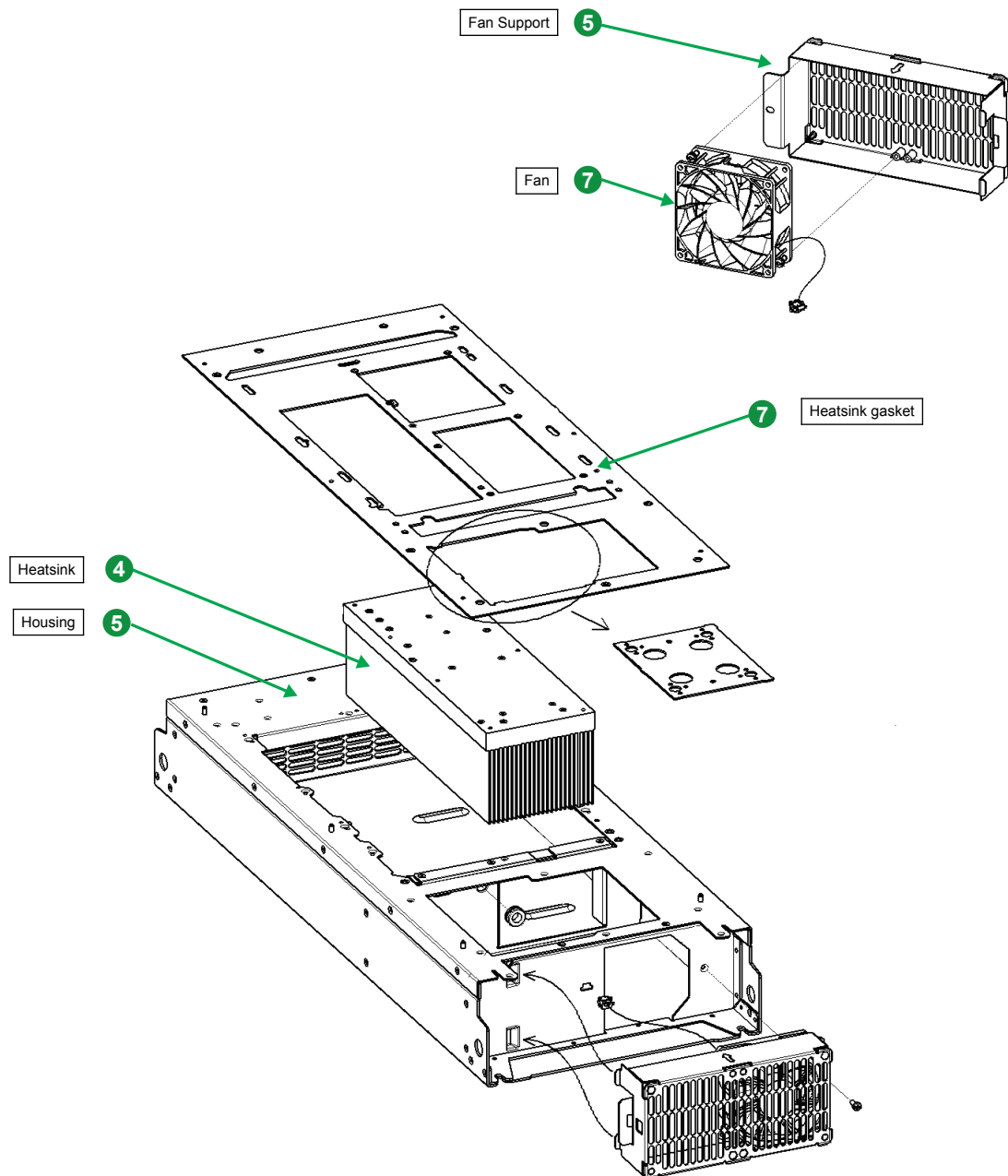

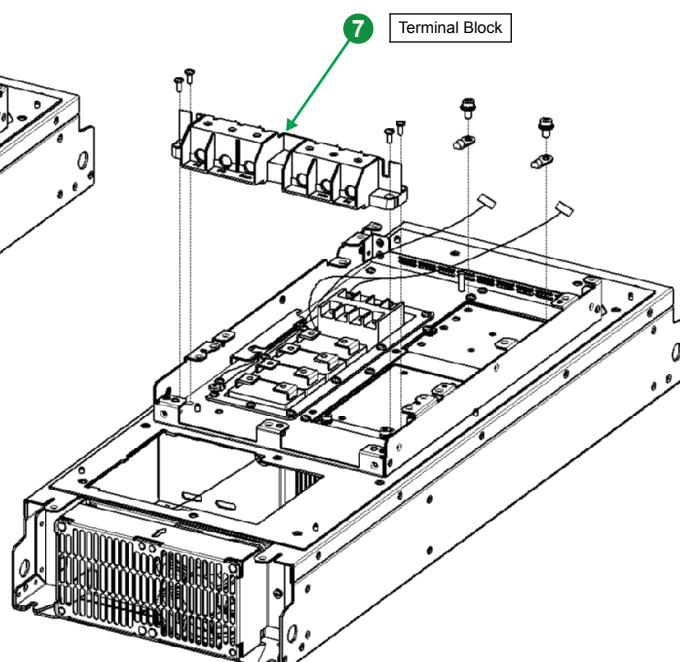
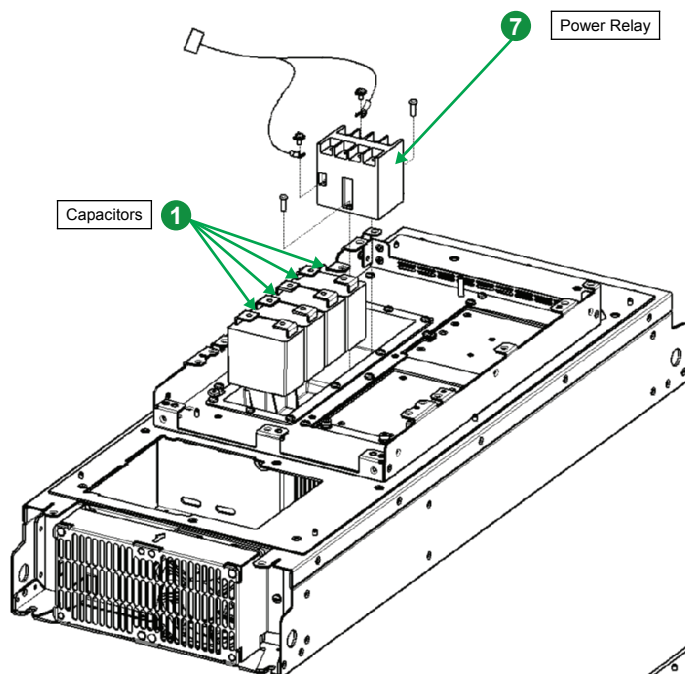
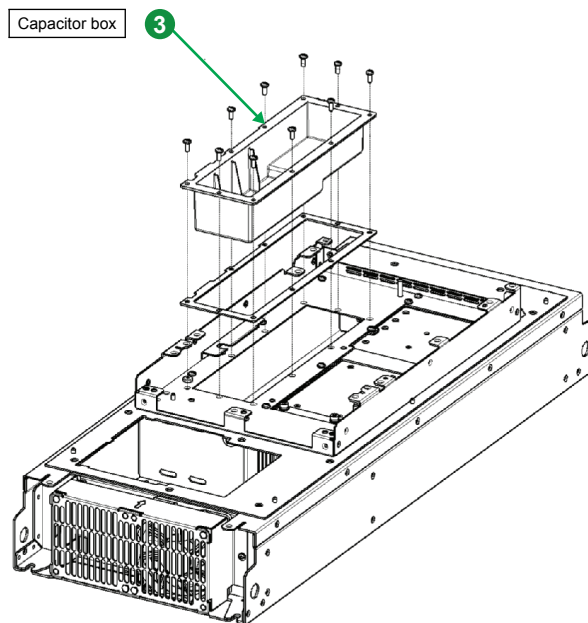
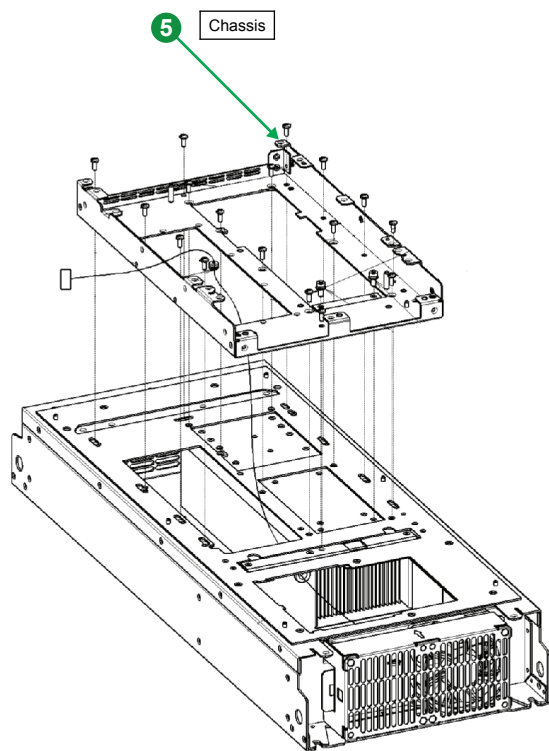

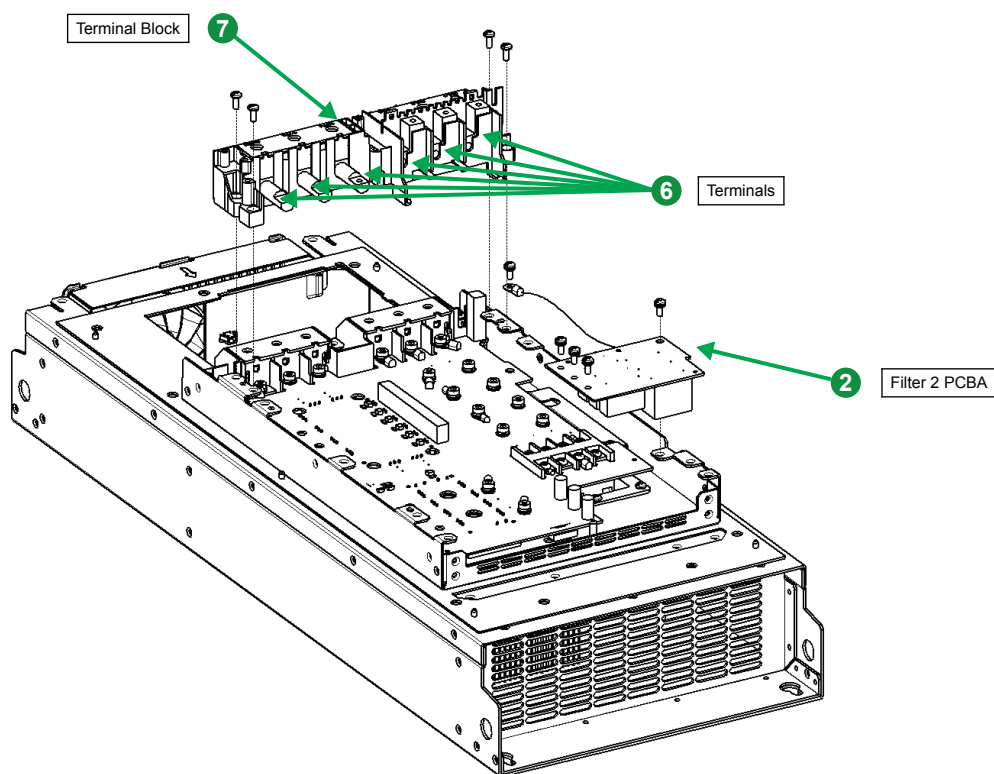
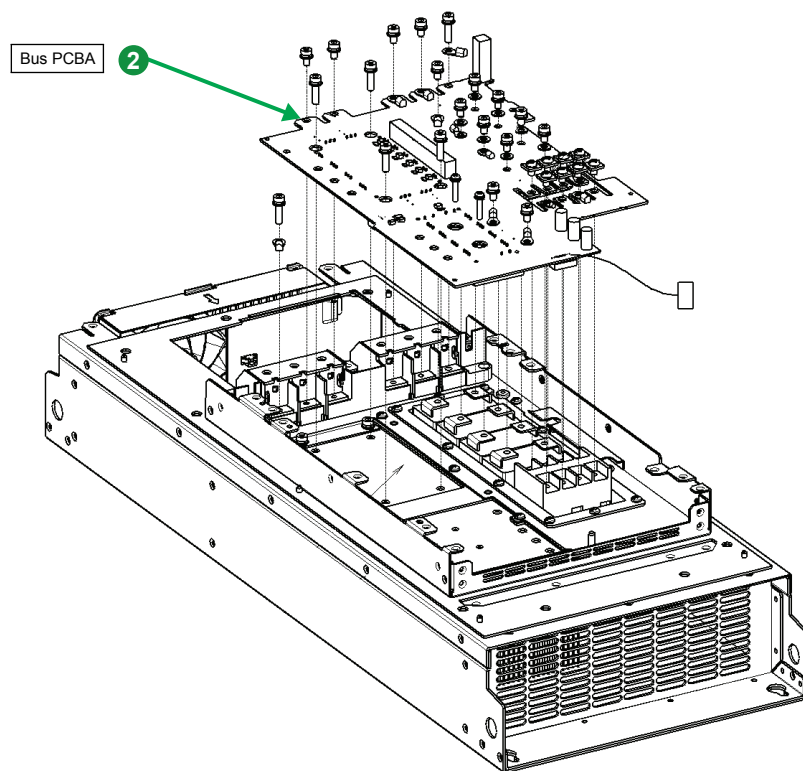

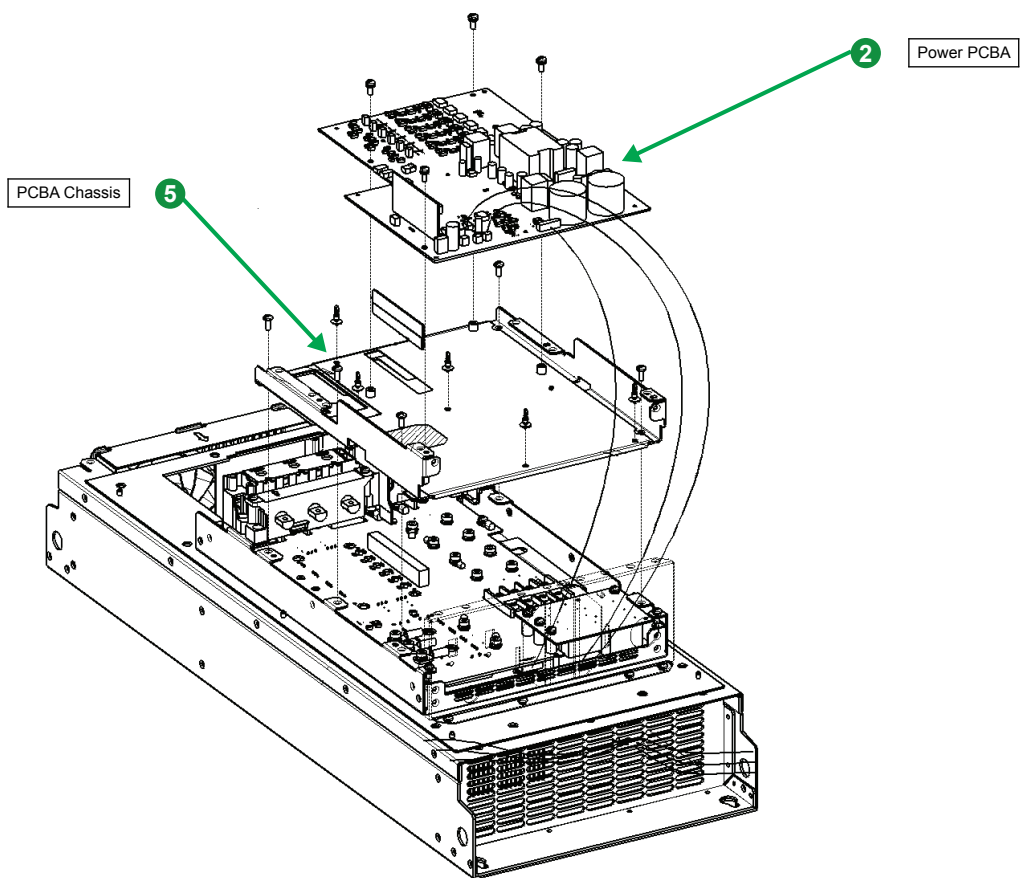
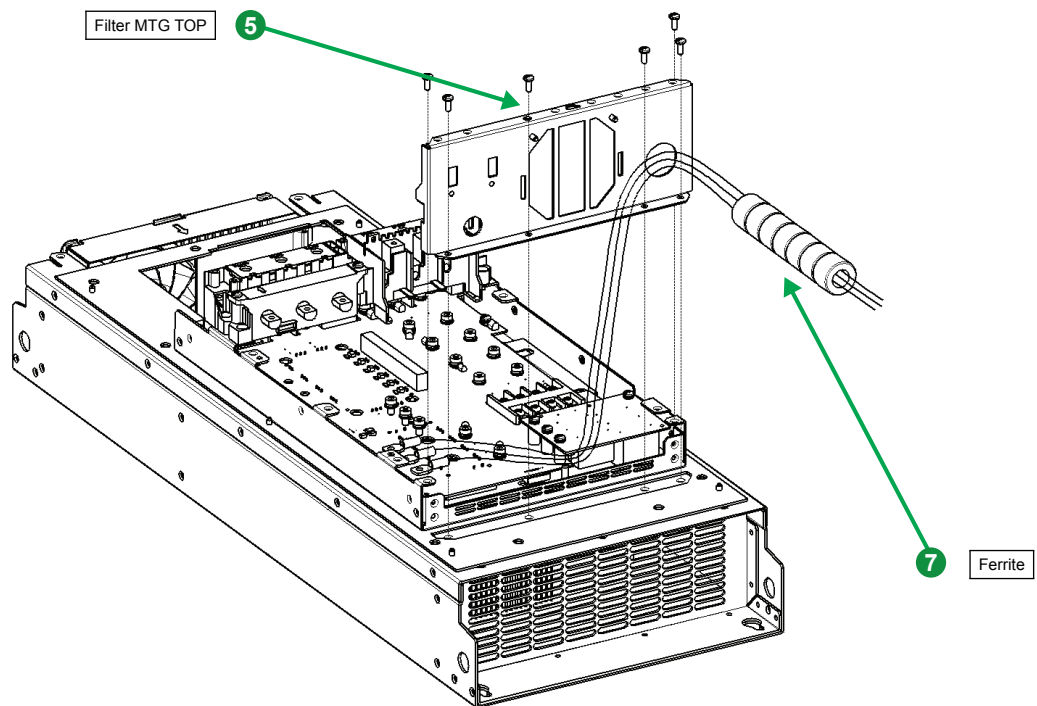

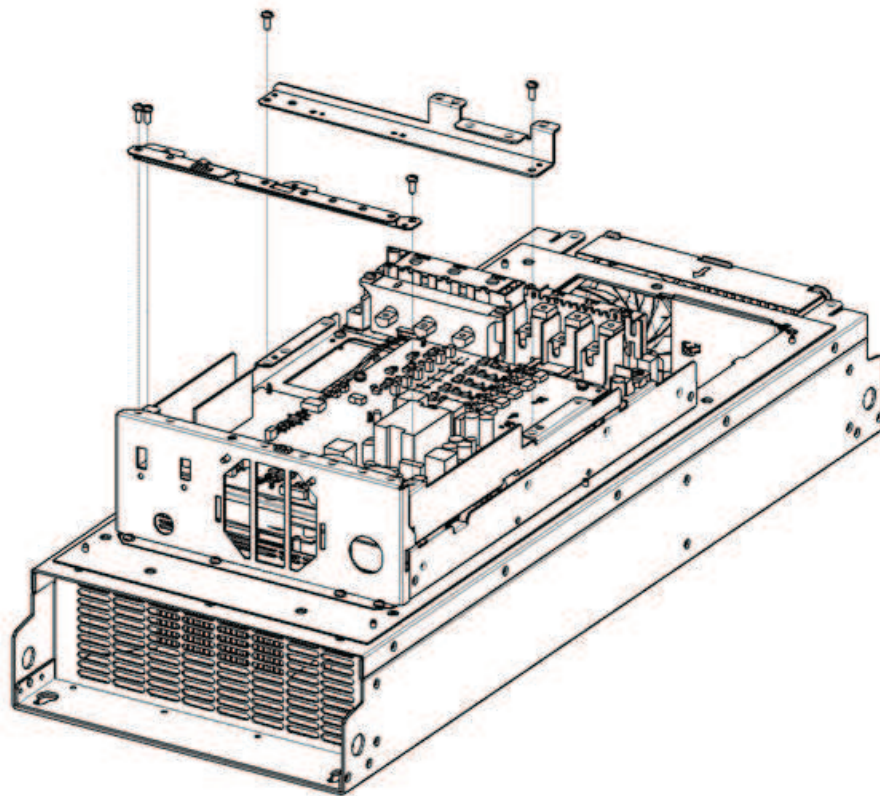

Fan Mount Plate

5

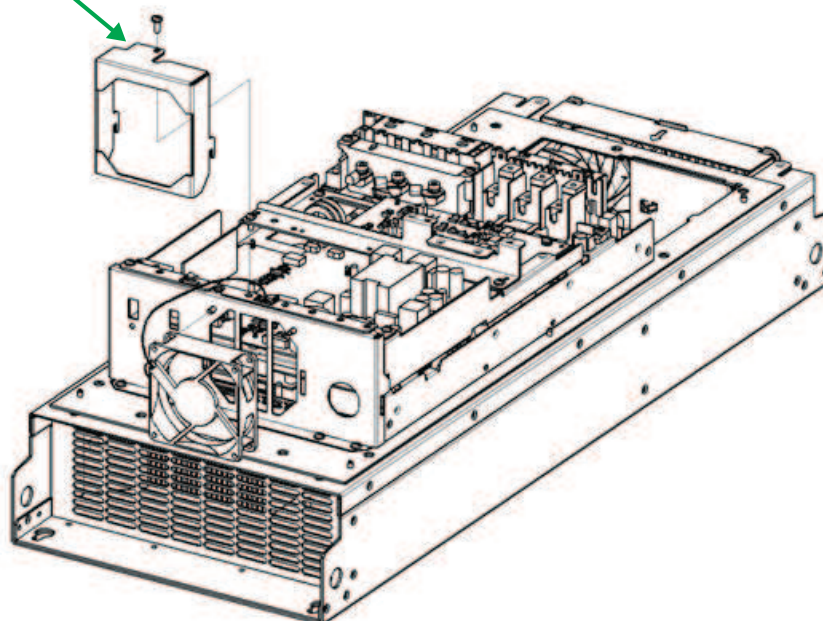

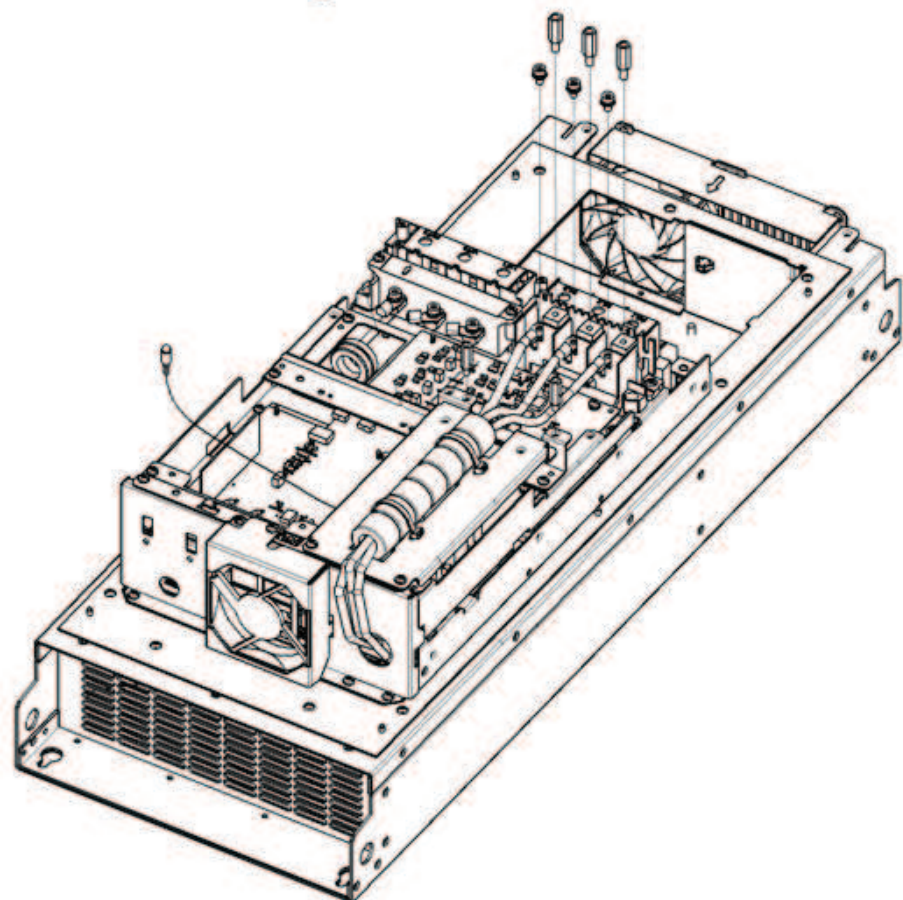
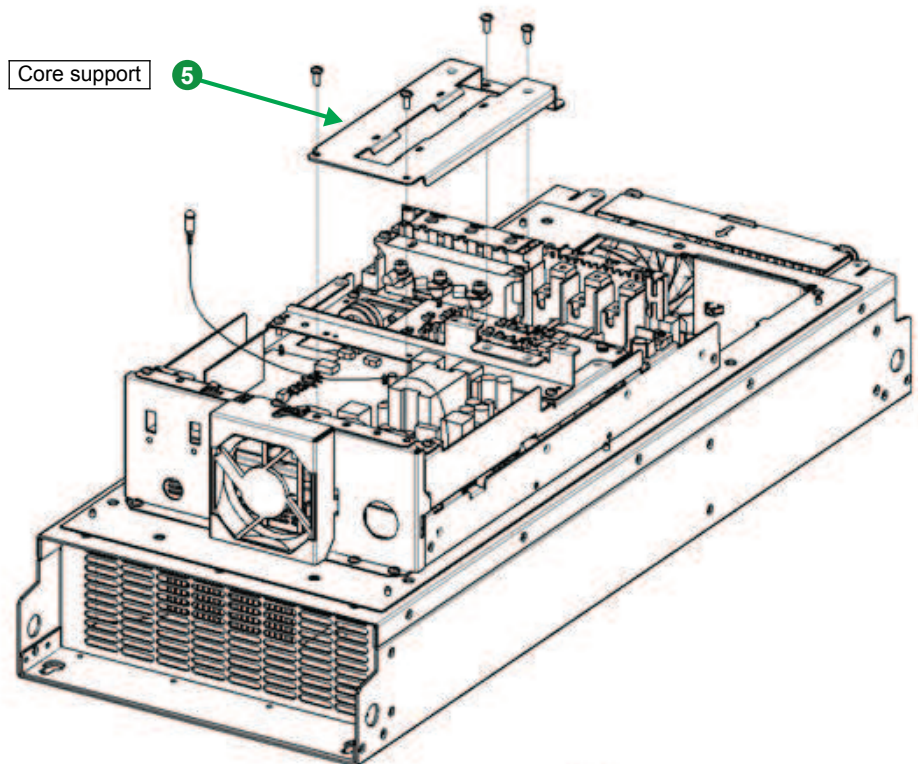

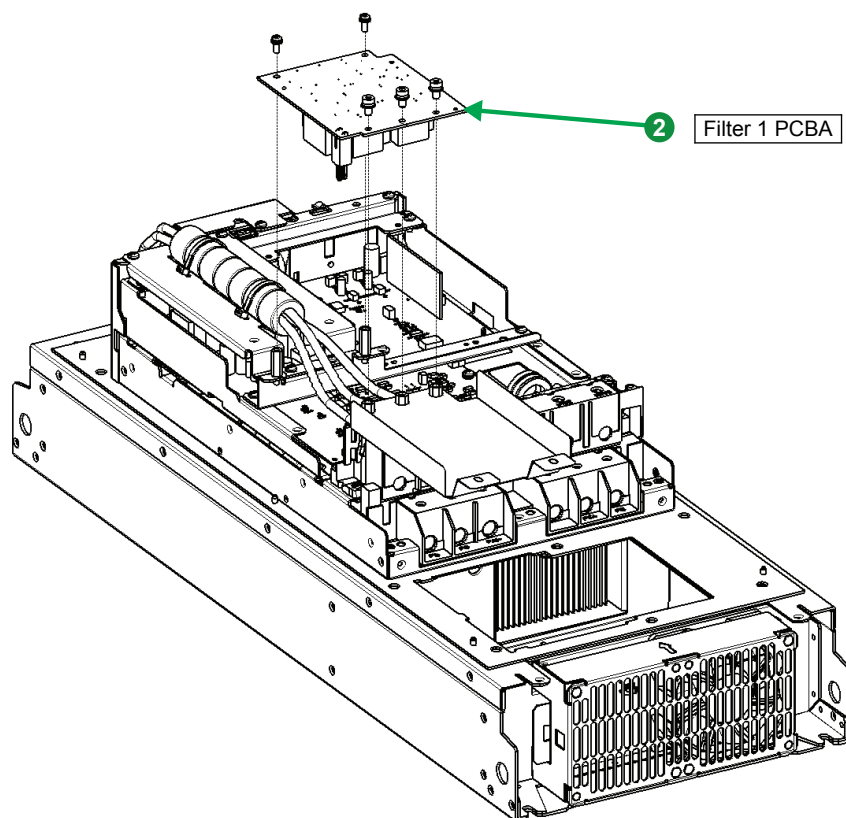

Contrôle Channel

5

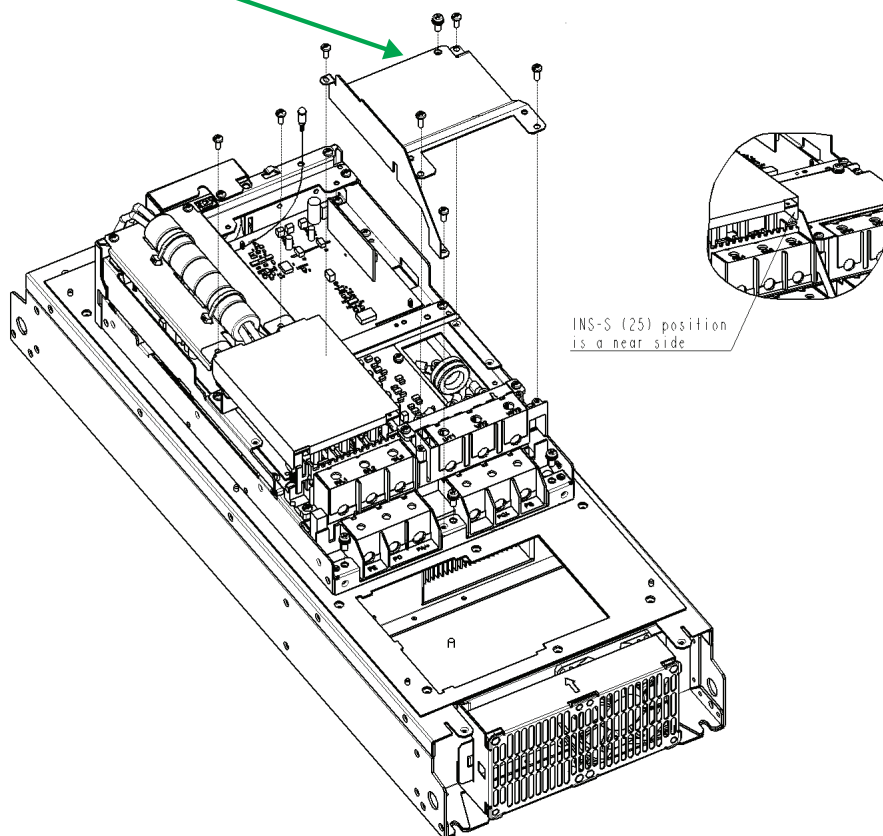

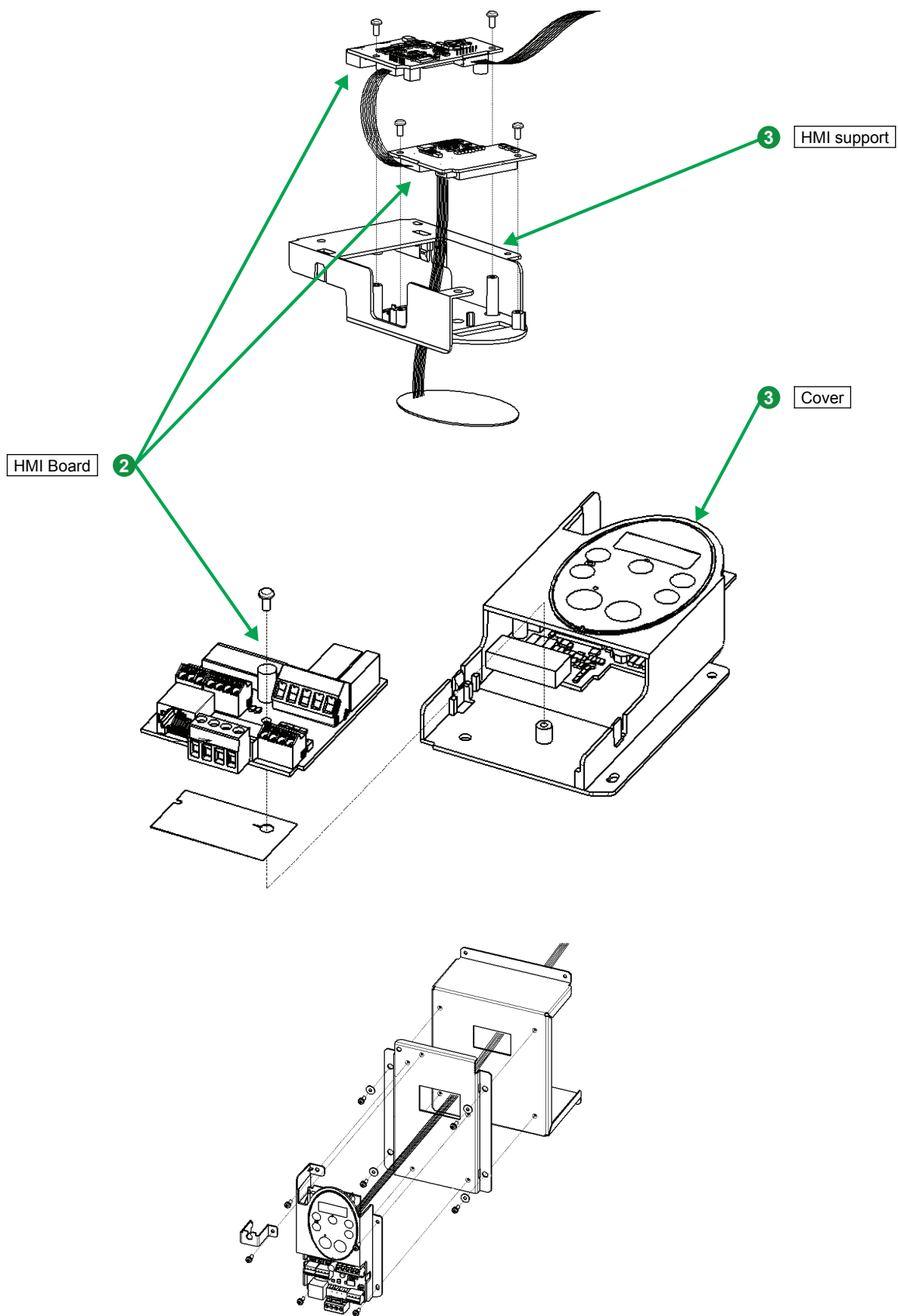

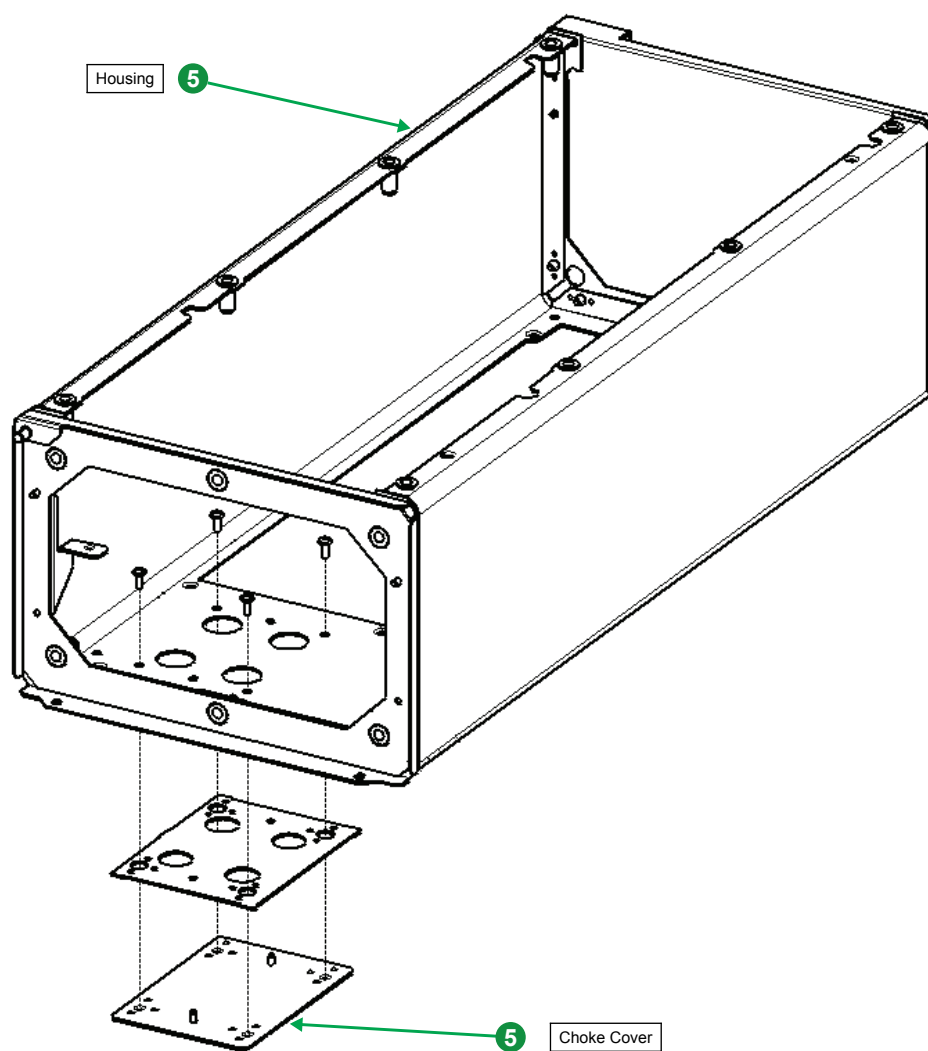

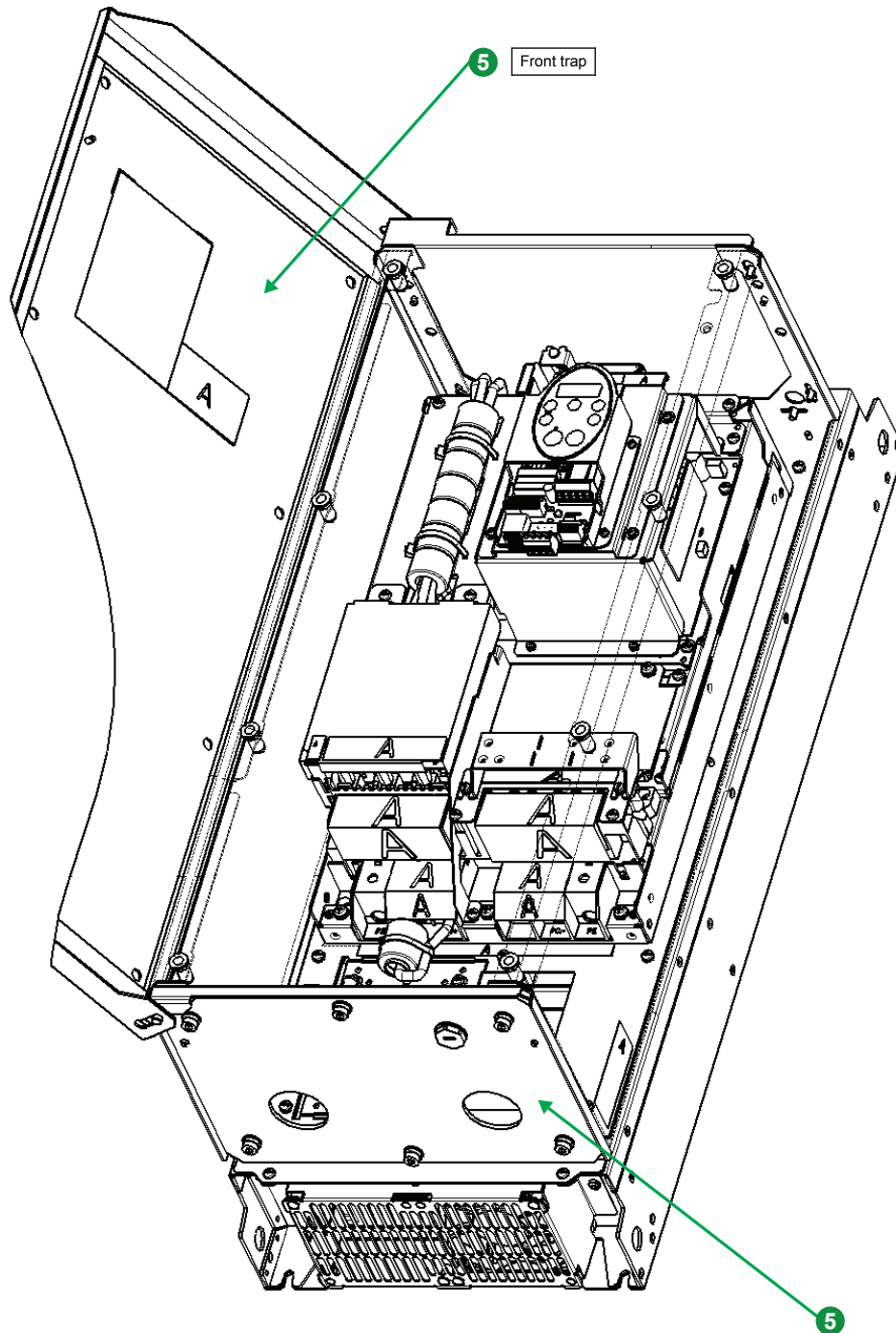

Types of Components	Number on drawing	Components description
Components listed for operating hazards	①	Electrolytic capacitors
Components listed for reuse	None	None
Components listed for depollution	①	Electrolytic capacitors
	②	Printed Circuit Board Assembly (PCBA) + Cables and connectors (not shown on drawing)
Components listed for dismantling operation which improves the recycling performance	③	Plastic parts > PC FR <
	④	Aluminium (heatsink)
	⑤	Steel
	⑥	Brass
Other components and parts listed for Shredding operations	⑦	Miscellaneous

Schneider Electric Industries SAS

35, rue Joseph Monier
CS30323
F - 92506 Rueil Malmaison Cedex

RCS Nanterre 954 503 439
Capital social 896 313 776 €
www.schneider-electric.com

The version of the Guide used to create the document: End of Life Instruction Drafting Guide of Schneider Electric version V1.

Publication : Schneider Electric