

OLYMPUS

MAUSB-500

USB Memory Adapter

Start Guide

Introduction

The **MAUSB-500** USB Memory Adapter (hereinafter referred to as "the adapter") is designed exclusively for reading and writing data to an **xD-Picture Card™** (hereinafter referred to as "card"). You can transfer large amounts of data to and from the card quickly and easily using a computer equipped with a USB port.

- Before using the adapter, read this Start Guide carefully.
- For more details, refer to the Reference Manual (PDF file) on the OLYMPUS web site or contact our Customer Support.

MAUSB-500 Reference Manual:
<http://www.olympus.co.jp/en/support/>

- Every effort has been made to ensure that the information in this leaflet is correct. If you find errors or anything else questionable, please contact our Customer Support.
- Olympus shall not be liable for any damages, passive damages, or demands from a third party resulting from improper use of the adapter.

FCC Notice

This equipment has been tested and found to comply with the limits for a Class B digital device, pursuant to Part 15 of the FCC Rules. These limits are designed to provide reasonable protection against harmful interference in a residential installation. This equipment generates, uses, and can radiate radio frequency energy and, if not installed and used in accordance with the instructions, may cause harmful interference to radio communications. However, there is no guarantee that interference will not occur in a particular installation. If this equipment does cause harmful interference to radio or television reception, which can be determined by turning the equipment off and on, the user is encouraged to try to correct the interference by one or more of the following measures:

- Adjust or relocate the receiving antenna.
- Increase the distance between the equipment and receiver.
- Connect the equipment to an outlet on a circuit different from that to which the receiver is connected.
- Consult your dealer or an experienced radio/TV technician for help.

What's included

MAUSB-500
(Adapter and
Cap)



Start Guide (this leaflet)

Names of parts

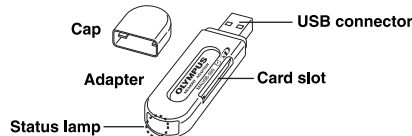

For customers in North and South America

For customers in USA

Dedication of Conformity
Model Number : MAUSB-500
Trade Name : OLYMPUS
Responsible Party : **OLYMPUS IMAGING AMERICA INC.**
Address : 3500 Corporate Parkway, P.O. Box 610, Center Valley, PA 18034-0610 U.S.A.
Telephone Number : 484-896-5000

Tested To Comply With FCC Standards
FOR HOME OR OFFICE USE

This device complies with Part 15 of the FCC rules. Operation is subject to the following two conditions:
(1) This device may not cause harmful interference.
(2) This device must accept any interference received, including interference that may cause undesired operation.

For customers in Canada

This Class B digital apparatus meets all requirements of the Canadian Interference-Causing Equipment Regulations.

For customers in Europe

CE mark indicates that this product complies with the European requirements for safety, health, environment and customer protection.

WEEE This symbol [crossed-out wheeled bin WEEE Annex IV] indicates separate collection of waste electrical and electronic equipment in the EU countries. Please do not throw the equipment into the domestic refuse.
Please use the return and collection systems available in your country for the disposal of this product.

Trademarks

- Microsoft and Windows are either registered trademarks or trademarks of Microsoft Corporation in the United States and/or other countries.
- Apple, Mac, Macintosh, Mac OS are trademarks of Apple Inc., registered in the U.S. and other countries.
- **xD-Picture Card** and other company and product names are registered trademarks and/or trademarks of their respective owners in Japan and/or other countries.

OLYMPUS IMAGING AMERICA INC.

3500 Corporate Parkway, P.O. Box 610, Center Valley, PA 18034-0610 U.S.A.
Tel. 484-896-5000
24/7 online automated help: <http://www.olympusamerica.com/support>
Phone customer support: Tel. 1-888-553-4448 (Toll-free)

OLYMPUS IMAGING AUSTRALIA PTY LTD.

82 Waterloo Road, North Ryde, NSW, 2113
Customer Service: Line 1300-659-678 Fax (02)-9888-7538
<http://www.olympus.com.au>

Before getting started

System requirements

Your computer must conform to the following minimum standards in order to use it with the adapter.

- Supported computers
 - See "Supported computers" in "Specifications".
- Compatible operating systems
 - See "Supported operating systems" in "Specifications".
 - Version of Windows 2000 Professional upgraded from Windows 95/NT 4.0/NT 3.51 may not work properly. In this case, you may need to reinstall your OS.

Precautions

- Before using the adapter, make sure there is adequate space around the computer's USB port so that the adapter can be connected properly. Plugging in the adapter forcibly may damage the adapter and/or USB port.
- In some cases, depending on your computer system's operating environment (i.e. hardware, software, and device drivers), the adapter may not work properly.
- The adapter may not function properly when connected to a PC via a USB port on a USB hub, keyboard or display. In this case, connect the adapter directly to the computer's USB port.
- **Do not pull the card out of the card slot, or unplug the adapter while the status lamp is blinking.** Doing so may destroy data on the card or damage the card.
- The adapter does not support computer power-saving functions. Turn off the power-saving function before you use the adapter with your computer.
- It is not possible to connect two or more MAUSB-500 adapters to a single PC at the same time.
- To attach the cap, align the front of the cap with the front of the adapter and slide it into place.

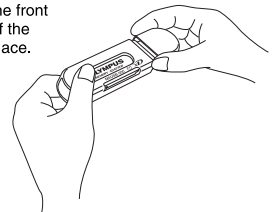

Safety Precautions <Be Sure to Read This Section>

Please follow the precautions below to ensure proper use and to avoid injury to yourself or others and damage to property.

Signs used in this section

	If the adapter is used without observing the information given under this sign, injury or death may result.
	If the adapter is used without observing the information given under this sign, minor personal injury, damage to the equipment, or loss of valuable data may result.

	Prohibited		Mandatory
	Symbols prohibiting a specific action		Symbols requiring a specific action

WARNING

- **Keep the adapter away from infants or toddlers as it could be accidentally swallowed.** If this happens, call a doctor, emergency or poison control center immediately.
- **Do not disassemble or modify the adapter.** Doing so may cause an electric shock, fire, equipment failure, or accident.
- **Do not spill liquid or let metallic objects or anything flammable get inside the adapter.** This could result in a fire, electric shock, equipment failure, or accident.
- **Do not insert anything other than the card into the card slot.** Doing so may cause equipment failure or fire.

If any devices make strange noises or produce smoke, or if a foreign object gets inside the adapter, turn off the device connected to the adapter. Then contact your dealer or authorized Olympus service center.

Before cleaning the adapter, disconnect the USB connector from the PC. Cleaning the adapter while it is still connected to the PC via the USB connector may cause an electric shock.

CAUTION

Precautions on Operating and Storage Environment

- Avoid using or storing the adapter in extremely hot or cold places.
- Avoid using or storing the adapter in places with excessive dirt and dust, or in direct sunlight.
- Avoid using or storing the adapter in places with strong vibrations or on unstable surfaces. This may cause equipment failure.
- Avoid using the adapter near the objects with strong magnetism (motors, transformers, televisions, speakers, magnets, etc.). This may cause malfunctions.
- Avoid using the adapter in a sealed environment.

Before transporting the adapter, make sure that the card has been removed.

This adapter is a precision instrument. Do not expose it to vibrations, shocks, or impacts.

Cleaning Precautions

- Do not apply organic solvent such as thinner, benzene, or insecticide to the adapter. This may cause the surface of the adapter to deteriorate and its coating to peel off.
- Use a soft cloth to wipe the adapter. If it is very dirty, wipe it with a soft cloth moistened with a small amount of diluted neutral detergent first, then wipe off any moisture with a dry cloth.

Card Handling Precautions

- **Be sure to format the card on a digital camera regularly.** For details on formatting with a camera, refer to the camera's instruction manual.
- When formatting the **xD-Picture Card**, make sure that there is no important data on it. **Existing data will not be usable after the card has been formatted.**

Specifications

Supported Cards	xD-Picture Card 3.3 V 16/32/64/128/256/512MB/1GB/2GB
Interface	USB Ver. 2.0 or Ver. 1.1
Operating voltage	5V (Powered via USB port)
Consumption current	0.2A Max.
Operating environment	Temperature: 0°C - 50°C (41°F - 122°F) Humidity: 20% - 85% (No condensation)
Storage environment	Temperature: -25°C - 60°C (-13°F - 140°F)
Dimensions (L x W x H)	76.9 mm x 24.2 mm x 10.0 mm
Weight	Main unit: Approx. 12 g Cap: Approx. 1.6 g
Supported computers	Any computer equipped with a USB interface as standard (USB Ver. 2.0 or Ver. 1.1 compliant)
Supported operating systems	Any of the following pre-installed operating systems · Windows 2000 Professional · Windows XP · Windows Vista · Mac OS 9.0-9.2 · Mac OS X (v10.1-10.4)

- The specifications are subject to change without prior notice.
- For the latest information, visit the OLYMPUS web site: <http://www.olympus.com/>

Using the adapter (for Windows/Macintosh)

① Insert a card into the adapter.

Make sure the card is level and that the gold-colored contact area is facing **down**. Insert the card all the way into the card slot.

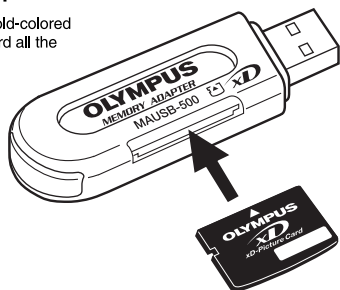

② Connect the adapter to the computer.

Connect the adapter's connector to the computer's USB port. (You can plug in the USB connector while the computer is in use.)
The status lamp lights up. (When there is no card in the adapter, the status lamp does not light.)

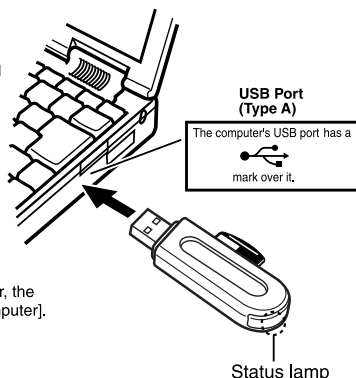

For Windows

When the adapter is recognized by the computer, the [Removable Disk] icon will be added to [My Computer].

For Macintosh

When the card is inserted correctly and the adapter is recognized by the computer, the card icon appears on the desktop.

Status lamp

Lights : When the adapter is connected to the computer and is ready to use.

Blinks : When reading/writing to a card.

Goes out : When there is no card in the adapter, or when performing the procedure* in

"③ Disconnect the adapter from the computer".

* Depending on your Mac OS version, the status lamp may go out when you drag & drop the card's icon onto the Trash icon.

Goes out after lighting : When the card is not recognized.

③ Disconnect the adapter from the computer.

- You can unplug the adapter with the computer's power on. (You do not need to turn off the computer, restart it, or put it in the sleep mode.)
- Close all software programs that are using data on the card (e.g. graphics applications). Otherwise, you cannot perform this step.

For Windows

1. Left-click the [Safely Remove Hardware] icon on the taskbar.
 - The message that appears with the [Safely Remove Hardware] icon may differ depending on the computer you are using.
2. A message titled [Safely remove USB Mass Storage Device - Drive (X:)] appears on the taskbar. Click on it.
 - The drive letter (X:) above will differ depending on the computer you are using.
3. Make sure that the status lamp is **NOT on**, then click the [OK] button.
4. Unplug the adapter from the computer's USB port.

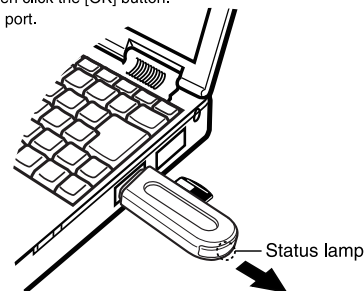

For Macintosh

1. Drag & drop the card's icon onto the Trash icon.
2. Make sure that the status lamp is **NOT blinking**.
3. Unplug the adapter from the computer's USB port.



④ Remove the card.

Pull the card out of the card slot as shown in the illustration.

