



Getting Started



CAUTION: Before you set up and operate your device, read and follow the safety instructions in the *Owner's Manual*.

1. reset button
2. back button
3. recording button
4. volume buttons
5. power button
6. integrated microphone
7. headphone connector
8. USB 2.0/1.1 connector
9. button lock switch

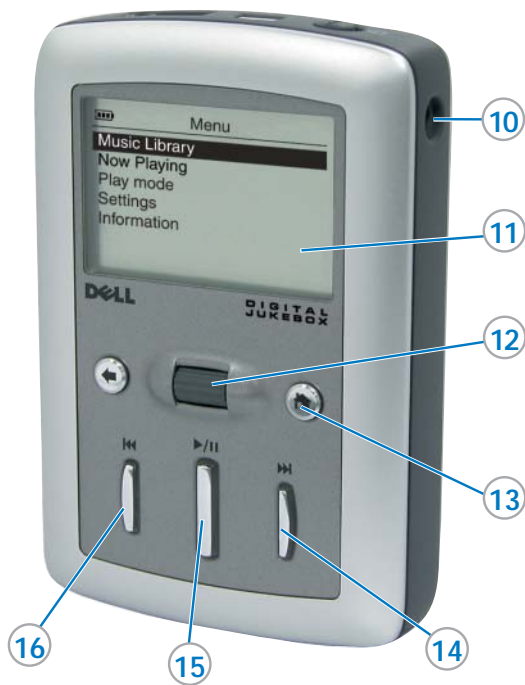

- 10. DC adapter connector
- 11. LCD screen
- 12. scroll dial/select
- 13. Home button
- 14. forward/skip forward button
- 15. play/pause button
- 16. reverse/skip back button

1 Charge the Battery and Turn On the Device



NOTICE: Do not use your Dell DJ™ until you have charged the battery for at least 6 hours.

1. Plug the DC adapter into the wall outlet. Then connect the DC adapter to the Dell DJ as shown and charge your device for at least 6 hours.



2. After the battery is charged, press and hold the power button for 2 seconds.





 **NOTICE:** Ensure that your device is not connected to your computer during the software installation process.

 **NOTICE:** Close all other applications while installing the software.

1. Insert the *Dell DJ Software and Documentation CD* into your CD drive.

The CD runs automatically, and the installation process begins.

If the CD *does not run automatically*:

- a Using Windows® Explorer® or the **My Computer** icon, navigate to the drive where you loaded the *Dell DJ Software and Documentation CD*.
 - b Double-click **start.exe**.
2. When the Dell Digital Jukebox installation screen appears, click **OK** to start the software installation process. Follow the instructions on the screen and click **OK**, **Next** or **Yes** when prompted.

The software may determine that you have a newer version of MusicMatch already on your computer. If so, you will be asked whether or not you would like to continue installing MusicMatch from the CD. Make your selection to proceed.

If you select "**Yes**," the installation process will continue.

If you select "**No**" you will be asked if you would like to install the MusicMatch plug-in for the Dell DJ. **You must select "Yes" and install the plug-in, if you intend to use MusicMatch with your Dell DJ.**

3. After the software installation is complete, a message appears asking if you want to restart your computer now or later. Select **Yes** to restart your computer immediately or **No** if you will restart your computer later.



NOTE: The software is not enabled until after you restart your computer.



NOTICE: After the software installation is complete and your computer has been re-booted, you can connect your Dell DJ to your computer.

Connect your device to your computer using the USB cable provided to transfer data files or audio tracks.

To connect the device to your computer:

1. Connect the smaller end of the USB cable to the USB connector on your device.
2. Connect the larger end of the USB cable to the USB connector on your computer.



Using MusicMatch



NOTE: MusicMatch® has the capability to 'rip' or convert music CDs to digital music files on your computer. Refer to the MusicMatch Help tutorial to create digital music files from your music CDs.

1. Start MusicMatch by clicking **Start** → **All Programs** → **MusicMatch** → **MusicMatch Jukebox**. The MusicMatch main window appears.
2. Click **View** → **Portable Device Manager**.
3. With the Portable Device Manager (PDM) open, you can transfer tracks or playlists in a drag-and-drop or copy-and-paste operation from your computer's MusicMatch Jukebox playlists onto the Dell DJ.
4. To drag-and-drop, locate and click the track or playlist that you want to copy, then drag it to Dell DJ or one of its playlists.
5. To copy-and-paste, locate and right-click the track or playlist that you want to copy, then click **Copy**. Right-click **Dell Digital Jukebox** or one of its playlists, then click **Paste**.

Using Dell DJ Explorer



NOTE: When transferring music tracks to your Dell DJ, be sure to transfer them to the Music Library folder of your Dell DJ. If you transfer music files from your PC to the Data Library folder of your Dell DJ, these music tracks will not be playable on your Dell DJ. They are stored on your Dell DJ as data files.

1. Connect the Dell DJ to your computer using the included USB cable.
2. Select **Start** → **All Programs** → **Dell** → **Dell DJ Explorer** → **Dell DJ Explorer**.
or
3. Open Microsoft Windows Explorer, then double-click **Dell DJ Explorer**.
4. With Dell DJ Explorer open, click **Folders** in the Dell DJ Explorer toolbar.
5. Click **Dell DJ Explorer** in the left window to expand its contents.
6. Click **Dell Digital Jukebox** beneath **Dell DJ Explorer** in the left window to expand its contents.
7. Click **Music Library** beneath **Dell Digital Jukebox** in the left window to expand its contents.
8. Using Dell DJ Explorer, locate the track, file or folder you want to copy.
9. To drag-and-drop, locate the track, file or folder that you want to copy, and drag it to the folder in which you want to place the track, file or folder.
10. To copy-and-paste, right-click the track, file or folder you want to copy and click **Copy**. Locate and right-click the folder in which you want to place the copy, and then click **Paste**. A copy of the track, file or folder is placed in the selected folder.



The Dell DJ can play tracks in MP3, WMA or WAV file formats. The Dell DJ comes with a few sample MP3 tracks already loaded into the Music Library.

To play all music tracks:

1. Press the **Home** button on your Dell DJ.
2. Scroll-select **Music Library**.
3. Scroll-select **Play All Music Tracks**.

 **NOTE:** Scroll-select means to rotate and then press the scroll dial.

All tracks are added to the Selected Music list. Playback starts after all music tracks have been queued.

 **NOTE:** In addition to playing digital music, you can also use your Dell DJ as a digital recording device and as a data storage device.

Be sure to check the Owner's Manual to learn about using these features.

Also, be sure to periodically check support.dell.com for software and documentation updates for your Dell DJ.



Finding Information

- Dell Owner's Manual — Details on setting up, configuring, and using your device.
- MusicMatch Help — Click **Start** → **All Programs** → **MusicMatch**. Click **Help** in MusicMatch.
- support.dell.com — Up-to-date information on your device including the latest software downloads, latest versions of the Owner's Manual, Getting Started placemats and answers to the most Frequently Asked Questions

Information in this document is subject to change without notice.
© 2003-2004 Dell Inc. All rights reserved.

Reproduction in any manner whatsoever without the written permission of Dell Inc. is strictly forbidden.

Dell, Dell DJ and the *DELL* logo are trademarks of Dell Inc.; *MusicMatch* is a registered trademark of MusicMatch Inc.; Microsoft and Windows are registered trademarks of Microsoft Corporation. Dell disclaims proprietary interest in the marks and names of others.

February 2004



0N2971A01