



Zebra® RW 420
Mobile Printer
Quick Start Guide

Introduction

Thank you for choosing one of our Zebra RW 420 Mobile Printers. These rugged printers will become productive and efficient additions to your workplace thanks to their innovative design. Because they're made by Zebra Technologies Corporation, you can be assured of world-class support for all of your bar code printers, software, and supplies.

This document provides an easy reference for operating and maintaining the RW 420 Mobile Printer. Complete documentation for this model printer is provided by the **RW 420 User Guide** available via the Internet at: <http://www.zebra.com/manuals>.

QSG-RW4-001 rev. A

© ZIH Corp. 2004

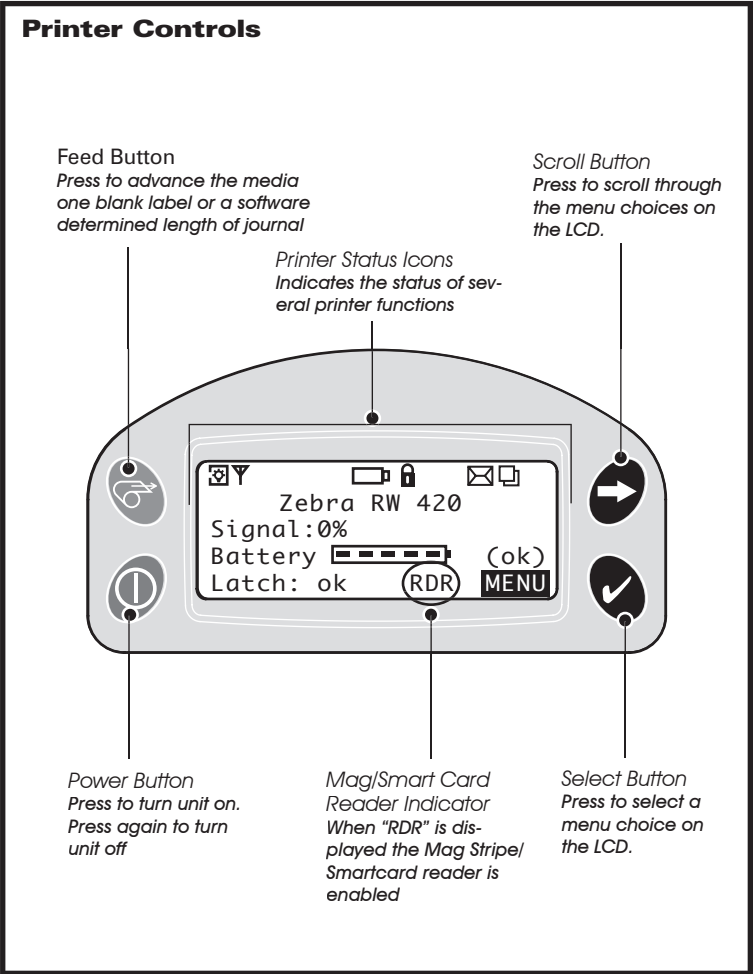
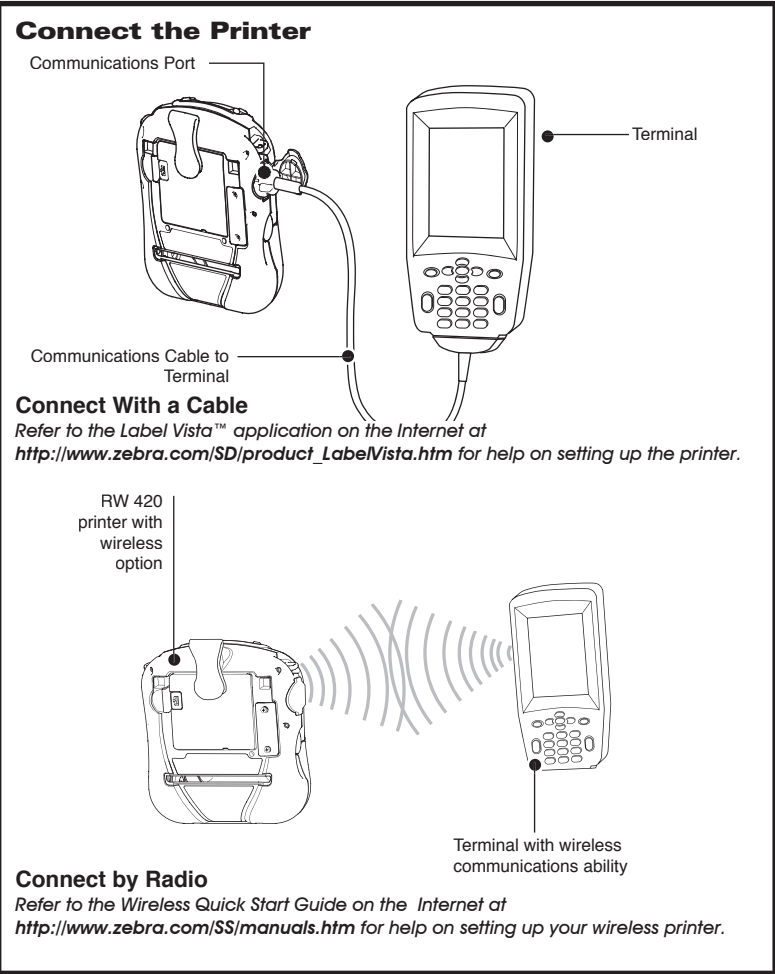
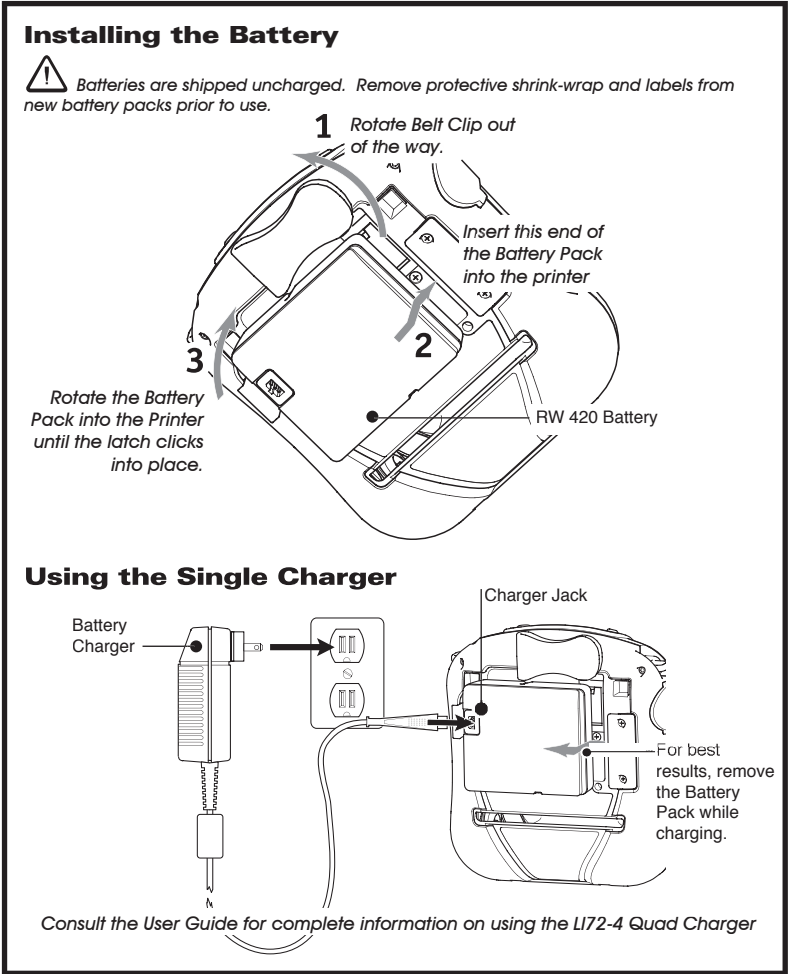
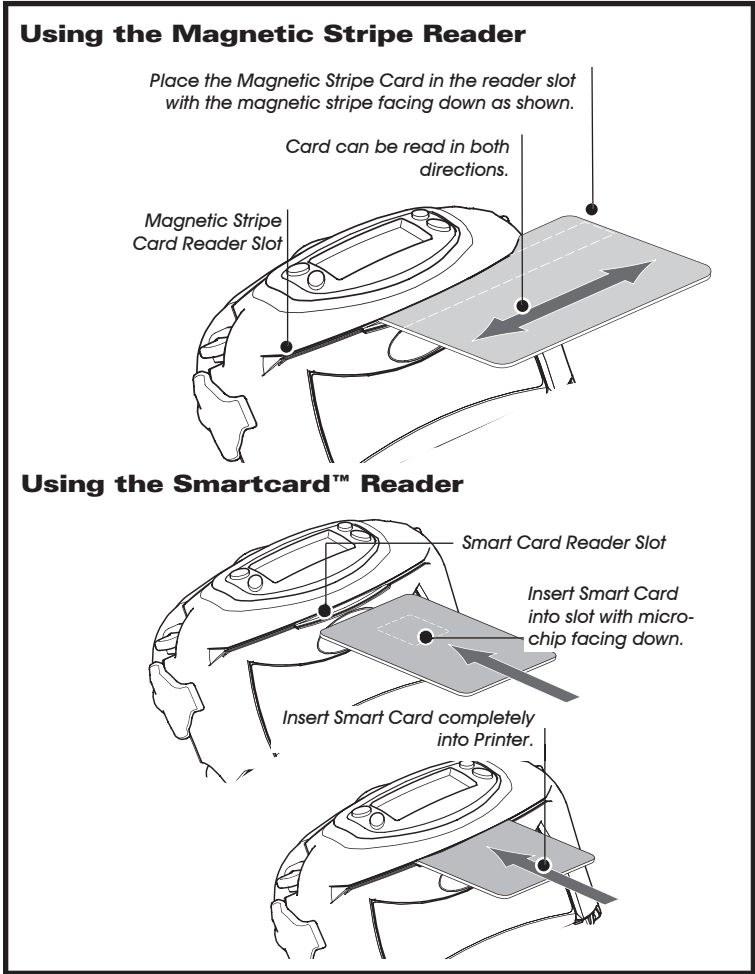
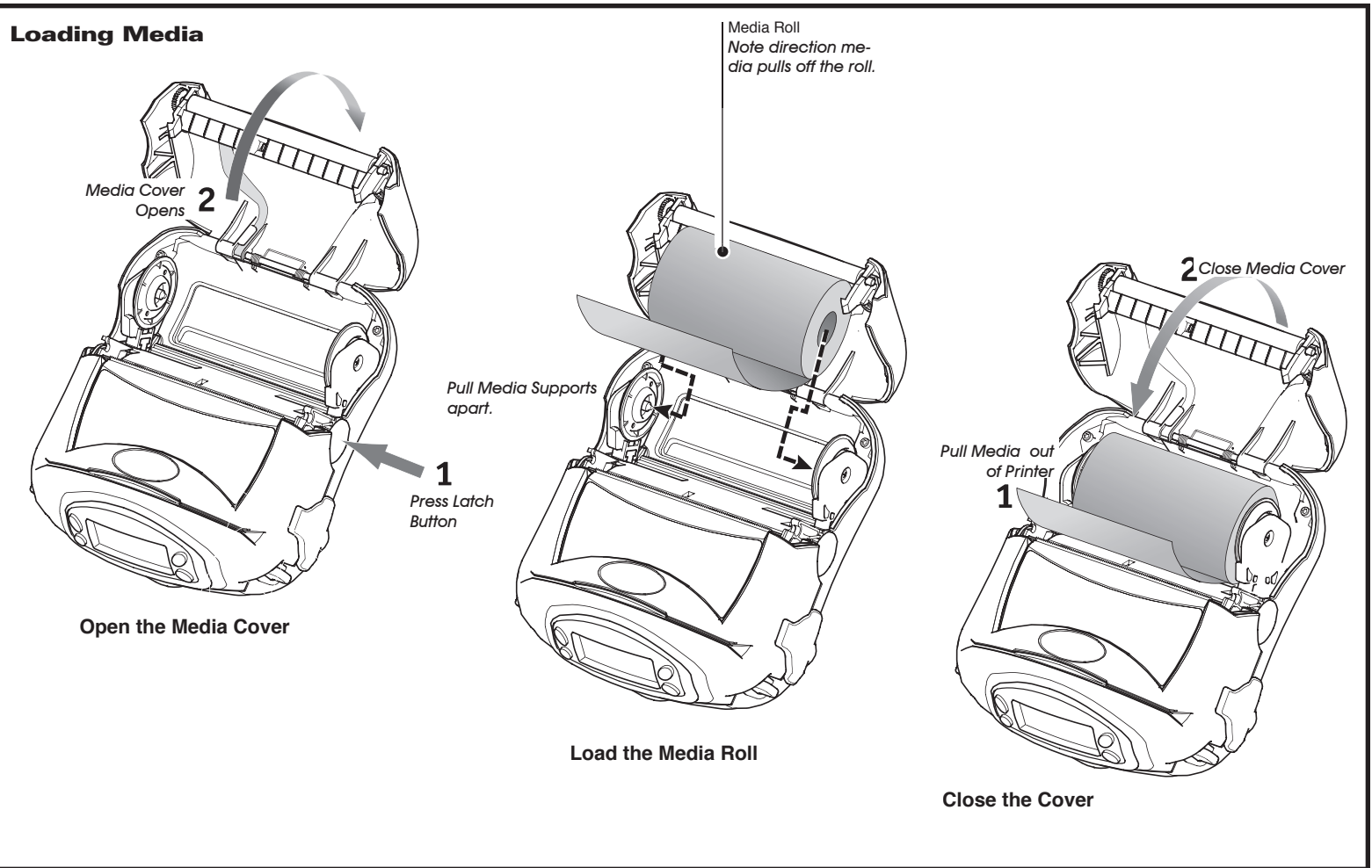
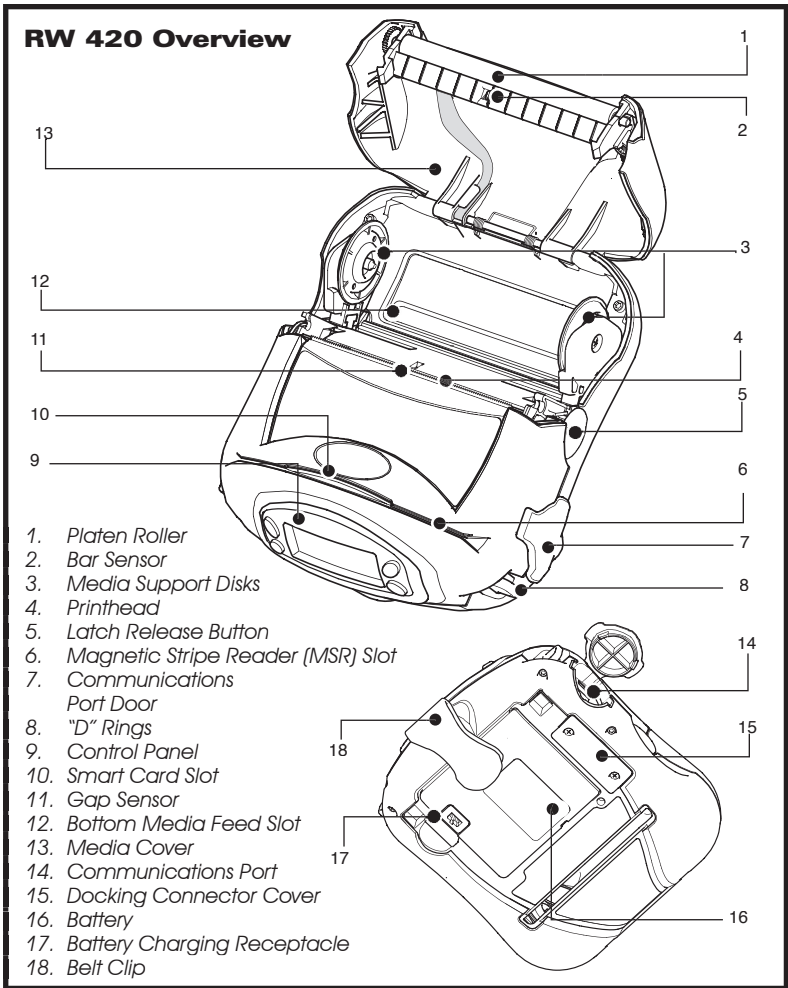

Cleaning the Printer

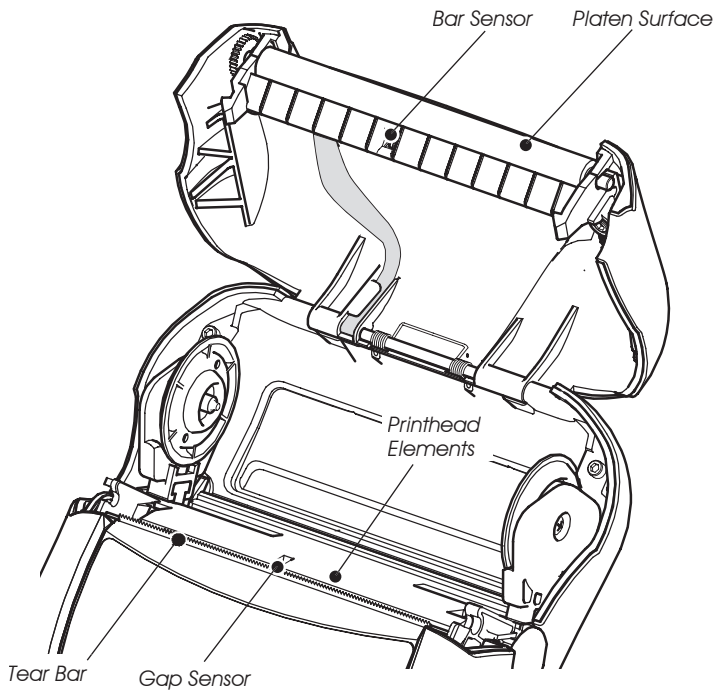

Area	Method	Interval
Printhead	Use the supplied cleaning pen or 70% isopropyl alcohol on a cotton swab to clean the print elements from end to end (the print elements are located in the thin gray line on the printhead).	After every five rolls of media (or more often, if needed)
Tear bar	Clean thoroughly with the cleaning pen or 70% isopropyl alcohol and a cotton swab.	
Platen	Rotate the platen roller and clean it thoroughly with the cleaning pen or 70% isopropyl alcohol and a cotton swab.	
Exterior	Water-dampened cloth	As needed
Interior	Brush/air blow. Ensure the Bar Sensor and Gap Sensor windows are free of dust.	After every five rolls of media (or more often, if needed)

Using the Accessories

Cradle

The RW 420 can be used in conjunction with a Cradle. When the printer is “docked” the Cradle allows the printer to print, receive and transmit data and charge batteries. Refer to the documentation either in the Users Guide or supplied with the Cradle for more information.

Installing the Printer

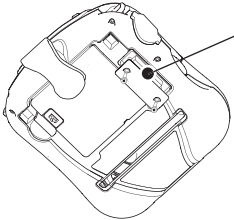

- As a safety precaution, remove the shoulder strap prior to docking the Printer.
- Remove the Docking Connector Cover from the bottom of the printer, and retain it for future use.
- Place the bottom of the printer over the two pins in the Cradle.
- Rock the top of the Printer into the Cradle and press firmly until it latches in place.
- Ensure that the power indicator on the Cradle is lit and turn the printer on.

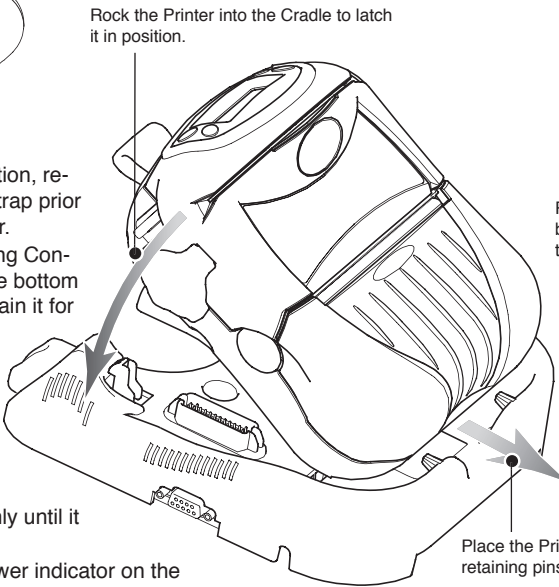

Removing the Printer

- Turn the Printer off.
 - Push on the latch on the Cradle and rock the top of the printer away from the Cradle.
 - Lift the Printer out from the Cradle.
- Replace the Docking Connector Cover if you will be using the Printer for an extended period of time away from the Cradle.

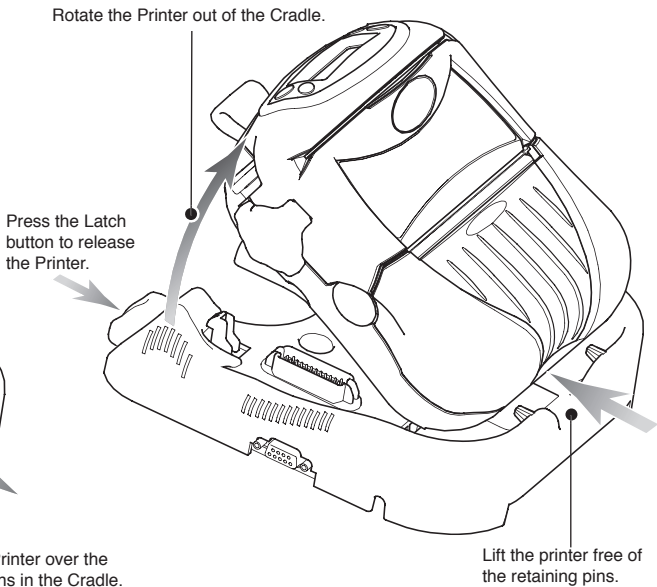

Using the Accessories

Belt Clip (standard on all printers)

To use: hook the clip over your belt, and ensure that the clip is securely attached to the belt. The belt clip will pivot to allow you to move freely while wearing the printer.

Adjustable Shoulder Strap (optional)

Refer to figure below. Snap each end of the shoulder strap into the “D” rings in the top of the printer. Slide the buckle away from or towards the printer until you achieve the desired length.

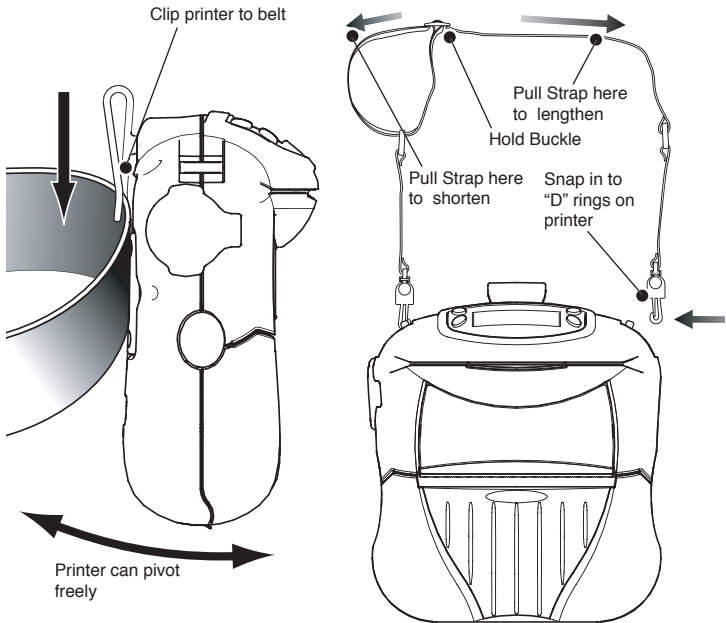

Troubleshooting

LCD Control Panel

The top of the display shows several icons which indicate various printer functions. Check the indicator status, then refer to the Troubleshooting topic referenced in the chart.

Status Icon	Condition	Indication	Ref. to Topic
	Steady	802.11b RF Link established	n/a
	Flashing	Transmitting/Receiving via 802.11b	n/a
	Off	No 802.11b RF Link	5
	Steady	Bluetooth Link established	n/a
	Flashing	Transmitting/Receiving via Bluetooth	n/a
	Off	No Bluetooth Link	5
	Flashing	Low Battery	3,5,6
	Flashing	Head latch not closed	8,10
	Flashing	Printer is receiving a file	7
	Flashing	Out of media	8,10
Blank Screen	n/a	No application	1,12

Troubleshooting Topics

- No power:**
 - Check that battery is installed properly.
 - Recharge or replace battery as necessary.
- Media does not feed:**
 - Be sure printhead is closed and latched.
 - Check spindle holding media for any binding.
 - Ensure label sensor is not blocked.
- Poor or faded print or icon flashing:**
 - Clean printhead.
 - Check battery and recharge or replace as necessary.
 - Check quality of media.
- Partial/missing print:**
 - Check media alignment.

- Clean printhead.
 - Ensure printhead is properly closed and latched.
- No print:**
 - Replace battery.
 - Check cable to terminal.
 - (Wireless units only) Restore wireless connection.
 - Reduced battery life:**
 - Check battery date code — if battery is one to two years old, short life may be due to normal aging.
 - Replace battery.
 - Flashing icon:**
 - No application or application corrupted; program must be re-loaded.
 - (Wireless units only): flashing error light indicates data transmission.
 - Flashing or icons:**
 - Check that media is loaded and that printhead is closed and securely latched.
 - Skips labels:**
 - Ensure correct media is being used.
 - Ensure bar/ or gap sensor is not blocked.
 - Communication Error:**
 - Check media is loaded, head is closed and error light is off.
 - Replace cable to terminal.
 - Label Jam:**
 - Open media cover.
 - Generously apply alcohol to printer in area of jammed label.
 - Blank LCD Screen:**
 - No application loaded or application corrupted; program must be re-loaded.
 - Magnetic Strip Card or Smart Card Won't Read**
 - Ensure the “RDR” text is displayed, indicating card reader is enabled.
 - Ensure card is inserted with the magnetic stripe or microchip facing in the correct direction.
 - Check card for excessive wear or damage to either the magnetic strip or the microchip.
 - Battery Pack Is Hard to Insert**
 - The battery packs for the RW 420 and QL 420 model printers are similar in size and shape. Verify you are using the correct battery pack.
 - Battery pack part numbers for RW 420 are CT17102-1 (standard capacity) or CT17102-2 (double capacity).

Regulatory Information for the RW 420 Printer

N255718275

Canadian Compliance Statement
This Class B digital apparatus complies with Canadian ICES-003.
Cet appareil numérique de la classe B est conforme à la norme NMB-003 du Canada.



Warning - Static Discharge and Thermal Printing

Static Discharge:
The discharge of electrostatic energy can damage or destroy the printhead or electronic components used in this device. DO NOT TOUCH the printhead or any exposed electronic components.

Thermal Printing:
The printhead becomes hot while printing. Use only the cleaning pen to perform maintenance on the printhead.

Product Support

For product support, contact Zebra Technologies at: www.zebra.com

Zebra Technologies International, LLC
333 Corporate Woods Parkway
Vernon Hills, Illinois 60061-3109 USA
Phone: +1.847.793.2600 or +1.800.423. 0422
Fax: +1.847.913.8766

Latin American Sales Office
9800 NW 41Street
Suite 220
Doral, Florida 33178 USA
Phone: +1.305.558.8470
Fax: +1.305.558.8485

Zebra Technologies Europe Limited
Zebra House
The Valley Centre, Gordon Road
High Wycombe
Buckinghamshire HP13 6EQ, UK
Phone: +44.1494.472872
Fax: +44.1494.450103

Zebra Technologies Asia Pacific, LLC
1 Sims Lane, #06-11
Singapore 387355
Phone: +65-68580722

Zebra Technologies International, LLC
333 Corporate Woods Parkway
Vernon Hills, Illinois 60061.3109 USA
Phone: +1.847.634.6700
Toll-Free: +1.800.423.0422
Fax: +1.847.913.8766