



THANK YOU FOR PURCHASING "KOSO MINI LCD THERMOMETER", BEFORE OPERATING, PLEASE READ THESE INSTRUCTIONS CAREFULLY AND RETAIN THEM FOR FUTURE REFERENCE.

## NOTICE

1. POWER SUPPLY: BATTERY (TYPE NUMBER CR2032)
2. FOR INSTALLATION, PLEASE FOLLOW THE STEPS DESCRIBED IN MANUAL. ANY DAMAGE CAUSED BY WRONG INSTALLATION SHALL BE IMPUTED TO THE USERS.
3. DON'T BREAK OR MODIFY THE WIRE TERMINAL. TO AVOID THE SHORT CIRCUIT, PLEASE DON'T PULL THE WIRE WHEN INSTALLING.
4. DO NOT DISASSEMBLE OR CHANGE ANY PARTS EXCLUDING THE MANUAL DESCRIPTION.
5. THE INTERIOR EXAMINATION OR MAINTENANCE SHOULD BE EXECUTED BY OUR PROFESSIONALS.

### MARK MEANING:

**NOTE** YOU COULD GET THE INSTALLATION DETAILS FROM THE INFORMATION BEHIND THE MARK.

**△** SOME PROCESSES MUST BE FOLLOWED TO AVOID THE AFFECTION CAUSED BY WRONG INSTALLATION.

**△ WARNING!** SOME PROCESSES MUST BE FOLLOWED TO AVOID DAMAGES TO YOURSELF OR THE PUBLIC.



## 1 ACCESSORY

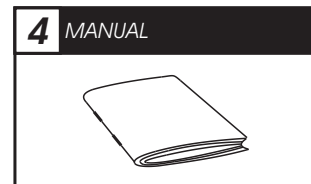
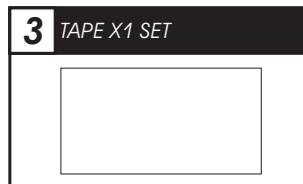
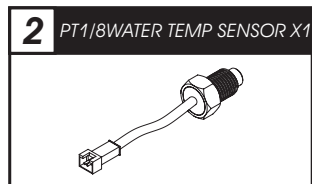
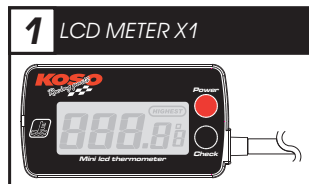

**NOTE** PLEASE CONTACT US IF THE ITEMS YOU OPEN ARE NOT THE SAME, WITH THE ABOVE-LISTED ONES.

## 2 INSTALLATION INSTRUCTION.

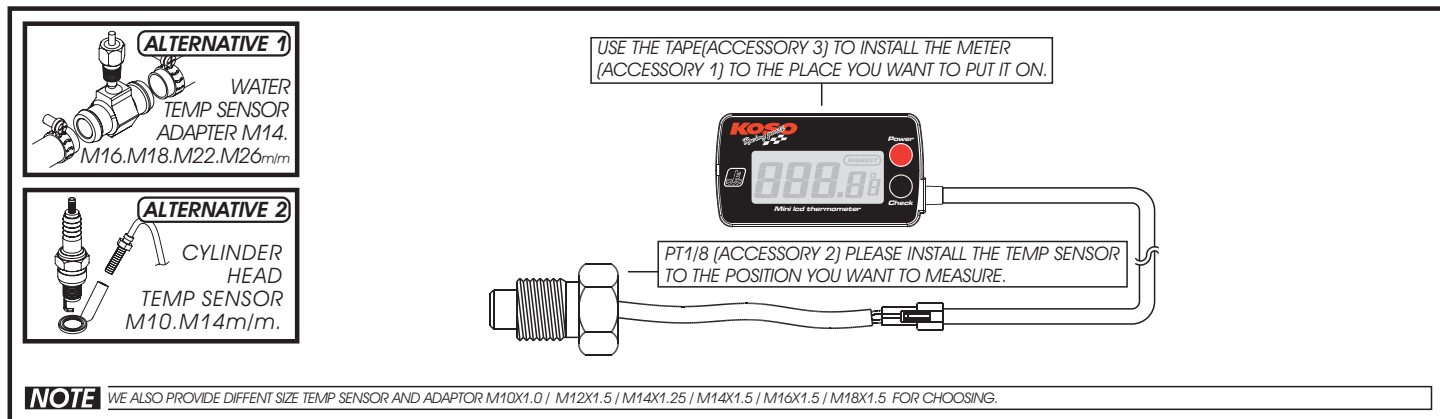

## 3 FUNCTION INSTRUCTION.

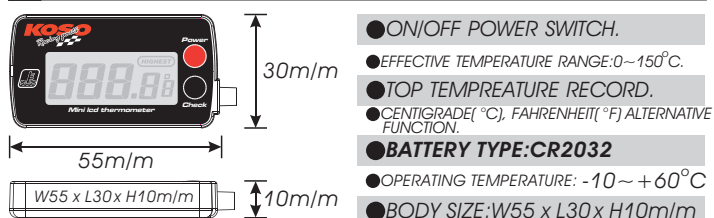

**NOTE** DESIGN AND SPECIFICATIONS ARE SUBJECT TO CHANGE WITHOUT NOTICE!

### 3-1 POWER ON, OFF/TOP TEMPERATURE CHECK.

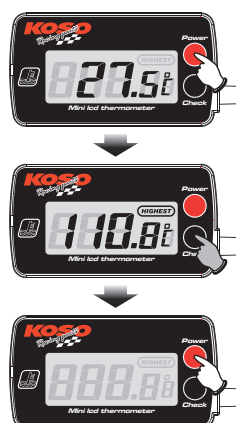

PRESS THE **Power** BUTTON TO START THE THERMOMETER.  
EX: 27.5°C.

HOLD DOWN THE **Check** BUTTON TO DISPLAY THE TOP TEMPERATURE RECORD.  
EX: THE TOP TEMPERATURE.

**△ WARNING!** TO AVOID ANY ACCIDENTS HAPPENED, DO NOT CHECK THE RECORD WHEN RIDING.

PRESS THE **Power** BUTTON TO TURN OFF THE METER.

**△** ONCE YOU TURN OFF THE POWER, THE TOP TEMPERATURE RECORD WILL BE RESET.

### 3-2 CENTIGRADE/FAHRENHEIT SWITCH FUNCTION INSTRUCTION.

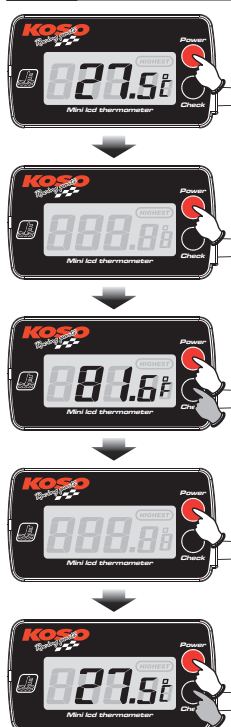

PRESS THE **Power** BUTTON TO START THE THERMOMETER.  
EX: NOW IT DISPLAY AS CENTIGRADE(°C).

PRESS THE **Power** BUTTON AGAIN TO TURN OFF THE METER.

HOLD DOWN THE **Check** BUTTON AND THEN PRESS THE **Power** BUTTON TO START THE METER.

**△** THE UNIT SWITCH FROM °C TO °F.

PRESS THE **Power** BUTTON TO TURN OFF THE METER.

HOLD DOWN THE **Check** BUTTON AND THEN PRESS THE **Power** BUTTON TO START THE METER.

**△** THE UNIT SWITCH FROM °F TO °C.