

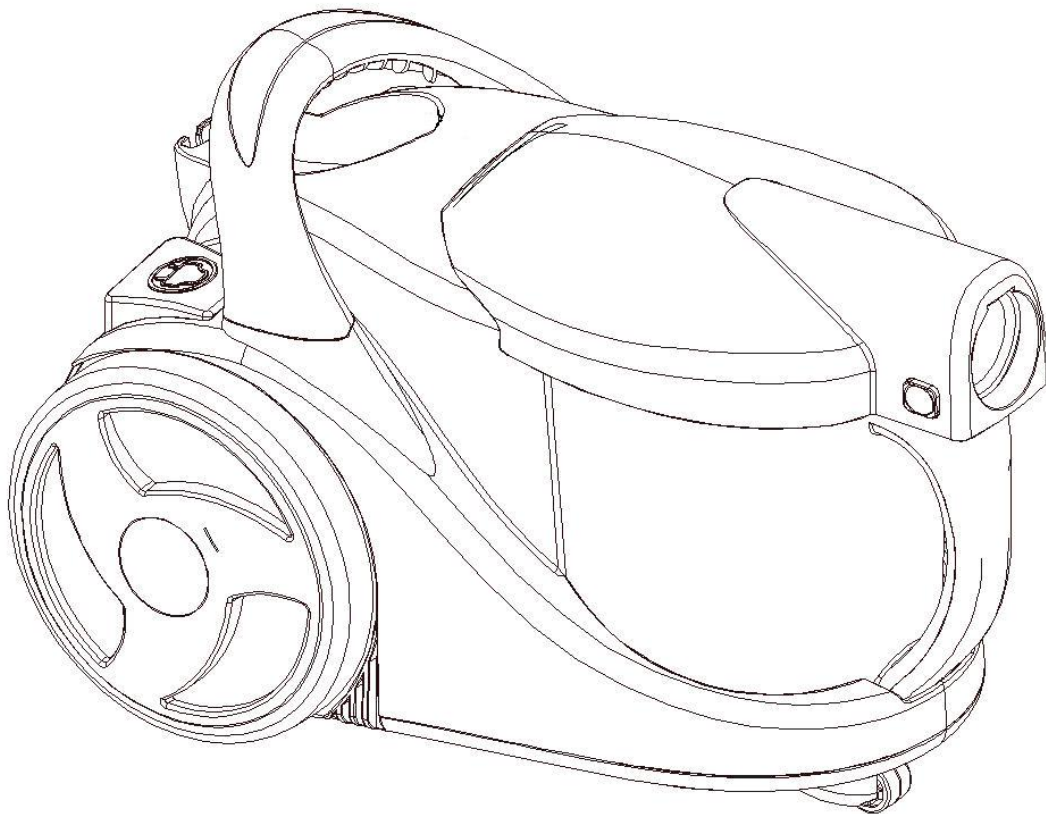

INSTRUCTION MANUAL
Vacuum Cleaner
Model No.: VB-100



Please read carefully before using this cleaner.
Always fully extend the mains cable before use.
Retain for future reference.

1. Parts and components overview

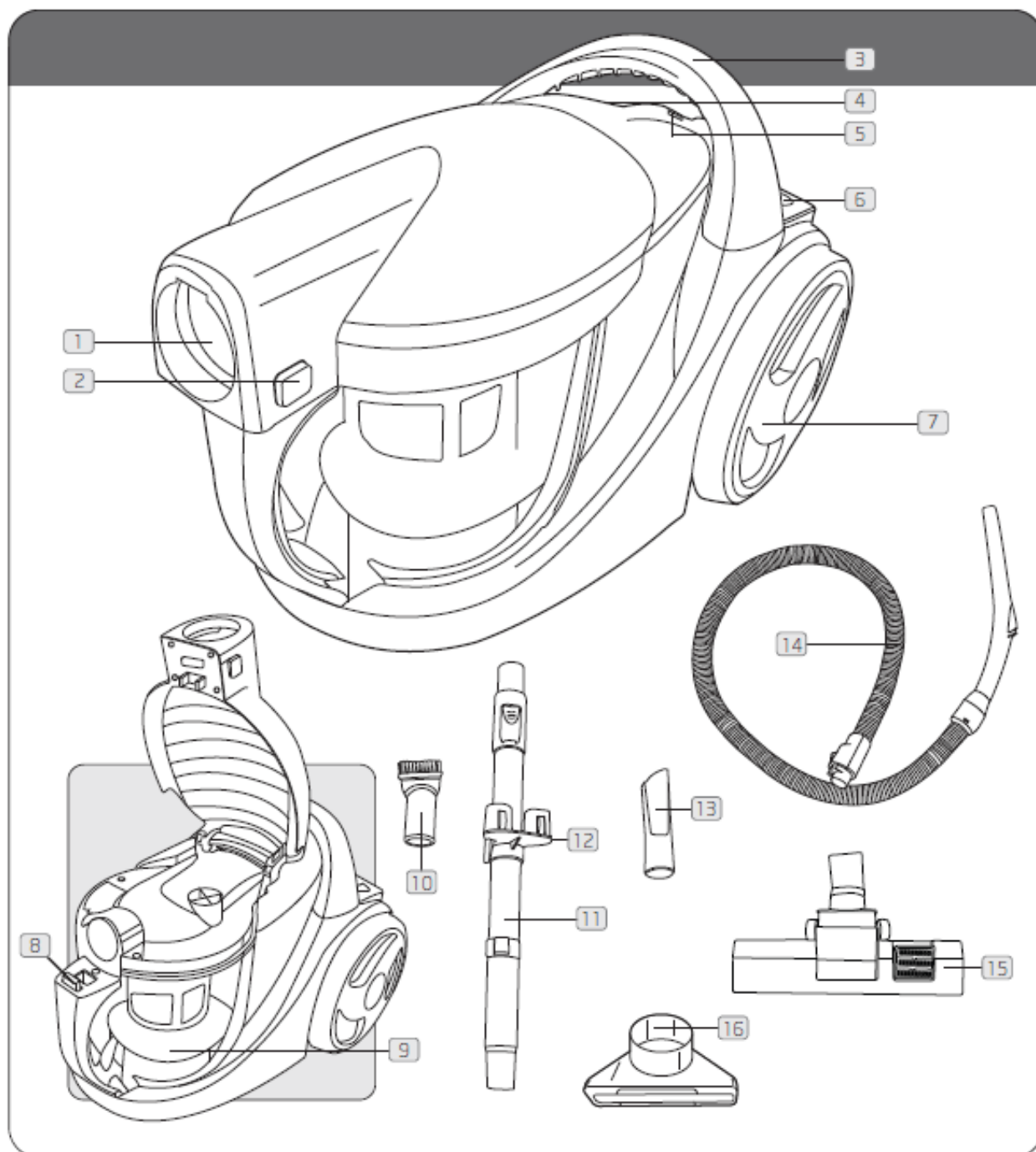

Note: Illustrations may differ from actual product.

- | | |
|----------------------------------|-------------------------------------|
| 1. Hose inlet | 9. Dirt container |
| 2. Lid release button | 10. Dusting brush |
| 3. Carry handle | 11. Telescopic extension tube |
| 4. Auto cord rewind button | 12. Accessories holder |
| 5. Floor tool parking slot | 13. Crevice tool |
| 6. On/Off button | 14. Flexible hose |
| 7. Wheel | 15. Combination floor tool |
| 8. Dirt container release button | 16. Upholstery tool / Curtain brush |

2. Safety Information

For Household Use Only

When using the vacuum cleaner, basic safety precautions should always be observed, including the following:

1. Only use the vacuum cleaner indoors on dry surfaces.
2. Turn off the vacuum cleaner controls before connecting or disconnecting from the mains supply.
3. Always unplug the vacuum cleaner before connecting or disconnecting the vacuum hose and accessories.
4. Children should be supervised to ensure that they do not play with the appliance.
5. The appliance is not intended for use by persons (including children) with reduced physical, sensory or mental capabilities, or lack of experience and knowledge, unless they have been given supervision or instruction concerning use of the appliance by a person responsible for their safety.
6. Use only as described in this manual. Use only the manufacturer's recommended attachments.
7. Do not use the vacuum cleaner if it has been dropped, damaged, left outdoors or dropped into water. Do not use the vacuum cleaner with a damaged cord or plug. If the supply cord or plug is damaged, return the vacuum cleaner to a Whirlpool Authorised Service Agent or suitably qualified person for examination, repair or adjustment.
8. Do not pull or carry by the cord. Do not use the cord as a handle, close a door on the cord or pull the cord around sharp edges or corners. Do not run the vacuum cleaner over the cord. Keep the cord away from heated surfaces.
9. Do not handle the plug or vacuum cleaner with wet hands. Do not use outdoors or on wet surfaces.
10. Do not put any objects into openings. Do not use with any openings blocked and do not restrict air flow. Keep all openings free of dust, lint, hair or anything that may reduce airflow.
11. Keep hair, loose clothing, fingers and all parts of the body away from openings and moving parts.
12. Do not pick up hot coals, cigarette butts, matches or any hot, smoking or burning objects.
13. Do not pick up flammable or combustible materials (lighter fluid, petrol, kerosene, etc) or use in the presence of explosive liquids or vapours.
14. Do not vacuum up harmful or toxic material (chlorine bleach, ammonia, drain cleaner, etc).
15. Do not vacuum up hard or sharp objects such as glass, nails, screws, coins, etc.
16. Do not use without the filters in place.
17. Take extra care when vacuuming stairs.
18. Keep vacuuming area well lit.
19. Store the vacuum cleaner indoors in a cool, dry area.
20. Turn off the on/off switch before unplugging the vacuum cleaner.
21. Use only CE-approved 13 amp extension cords. Nonapproved extension cords may overheat. Care should be taken to arrange the cord so that the cord cannot be pulled or tripped over.

 **WARNING:** Always switch off and unplug the vacuum cleaner from the electrical outlet before assembling, opening or emptying the dirt container, or before connecting/disconnecting the attachments.

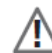
 **CAUTION:** The vacuum cleaner is a very powerful unit. Before plugging the cord into the electrical outlet, make sure the switch is in the 'off' position.

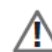
 **IMPORTANT:** If the inlet, hose or telescopic tube is blocked, switch off the vacuum cleaner and remove the blockage(s) before re-starting the vacuum cleaner.

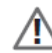
 **IMPORTANT:** Cleaning filters improves vacuum performance. Make sure all the filters are completely dry before inserting back into the vacuum cleaner.

This vacuum cleaner is intended for household use only and not for commercial or industrial use.

3. How to Assemble



IMPORTANT: Always unplug the vacuum cleaner from the electrical outlet before assembling or removing the accessories.

1. Insert the flexible hose connector into the inlet on the main body of the vacuum cleaner until it clicks into place.

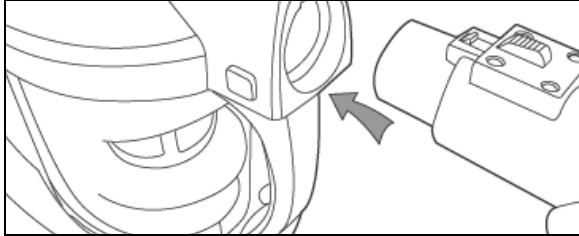

3. The telescopic extension tube can be lengthened or shortened by pushing the button in and sliding the tube apart or together as required.

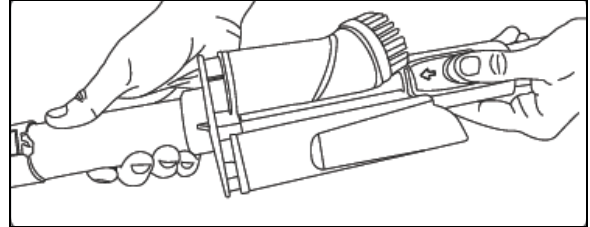

2. Push the telescopic extension tube on to the end of the handle.

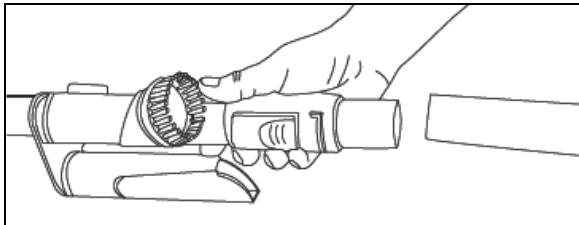

4. Fit the combination floor head by pushing onto the extension tube.

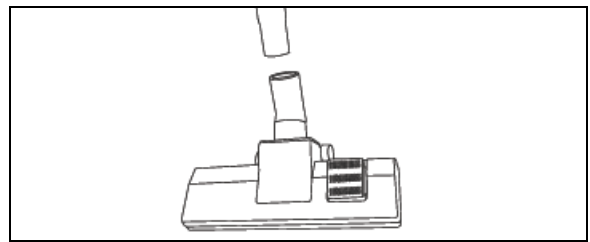

4. How to Operate

Cord Release

Fully unwind the power cord. A yellow mark on the power cord indicates the recommended cord length. Do not exceed the cord length beyond the red mark.

On/Off Button

Insert the power plug into the electrical outlet. Ensure the vacuum cleaner is switched off.

Press the on/off button located on the top of the vacuum cleaner and press the button again to turn the vacuum cleaner off.

Carpet Cleaning

For carpet and rug cleaning press the rocker switch on the combination floor head to raise the brushes.

Hard floor Cleaning

For hard floor cleaning, press the rocker switch on the combination floor head to lower the brushes.

Cord Rewind

To rewind the power cord, press the cord rewind button, located on the top of the vacuum cleaner, and guide the power cord with one hand. This will prevent the cord from whipping which could cause damage or injury.

Carry Handle

Use the carry handle located on the top of the vacuum cleaner to move the vacuum cleaner from room to room.

Hose Storage

For convenience there is a slot located at the rear of the vacuum cleaner where the floor tool and hose can be parked for storage.

5. Accessories:

The accessories can be attached directly to the handle by removing the telescopic tube and pushing in the desired accessory.

The accessories can also be attached to the telescopic tube for extra reach. Remove the combination floor head and push on the desired accessory.

Crevice tool: for crevices, corners and cracks, etc.

Dusting brush: for delicate surfaces.

Upholstery tool / Curtain brush: for curtain, carpet, upholstery, stairs, etc.

6. Dirt Container & Filter Removal and Replacement:

NOTE: Before emptying the dirt container and removing or replacing any filters the hose must be removed from the vacuum.



WARNING: Always unplug the vacuum cleaner from the electrical outlet before removing the dirt container.



WARNING: Do NOT use the vacuum cleaner without ALL of the filters in place.

NOTE: For best performance, replace filters annually.

Press and hold in the latch on the top of the hose connector and remove the connector away from the vacuum cleaner

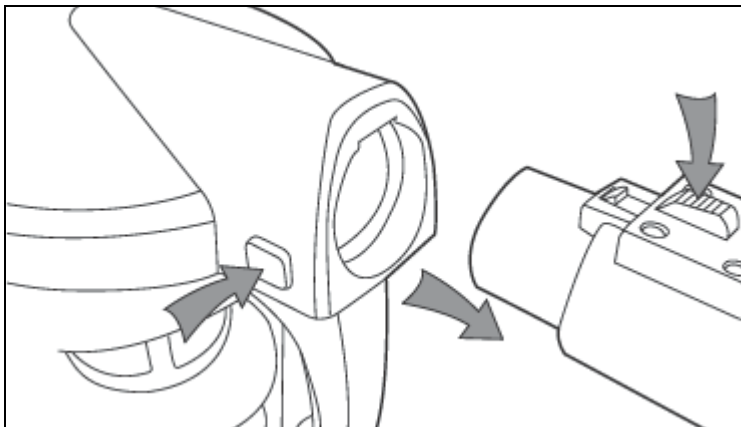

Emptying the Dirt Container

Lift the lid of the vacuum cleaner by pressing in the lid release buttons on the vacuum cleaner. Rotate the dirt container anti-clockwise and lift the container out of the vacuum cleaner

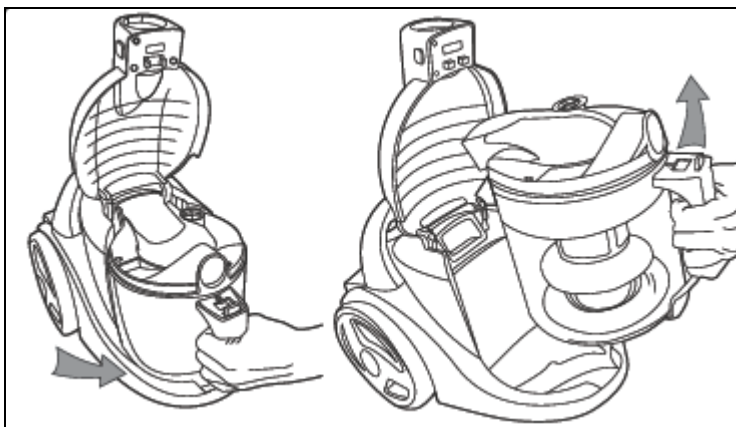

Position the dirt container over a rubbish bin and press the dirt container release catch.

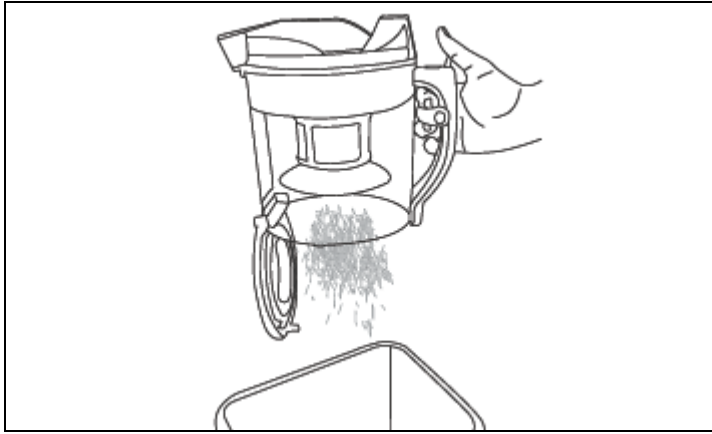

When all the dirt has fallen close the dirt container base, and return the dirt container to the vacuum cleaner.

Cleaning the Filters:

NOTE: NOTE: Do not use any detergents or boiling water to wash the filters. Whirlpool recommends checking the filters every time the dirt container is emptied and cleaning as instructed below.

NOTE: All filters must be in place before using the vacuum cleaner.

Central Pre-motor Filter

Remove the dirt container as directed above.
Remove the central filter as shown:

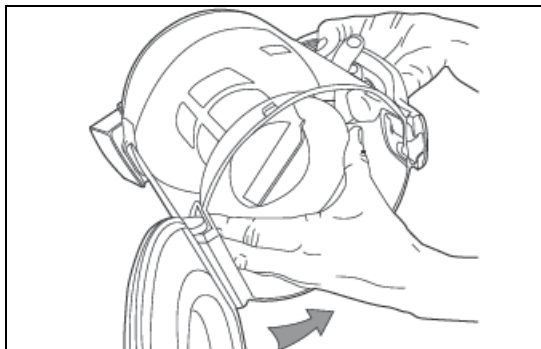

The filter can be separated into two separate parts.

Gently tap the central filter, filter shroud and filter sleeve against the side of a rubbish bin to remove excess dirt

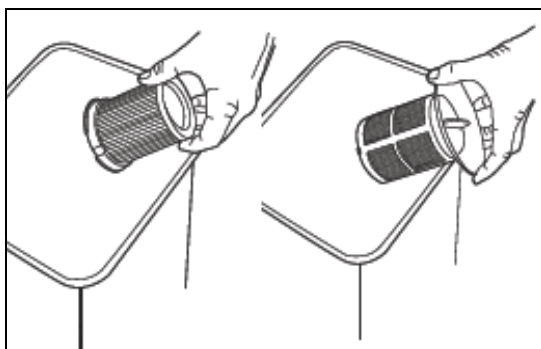

The Central filter and filter can be rinsed in warm water (max 40°C). Allow to air dry completely before replacing.

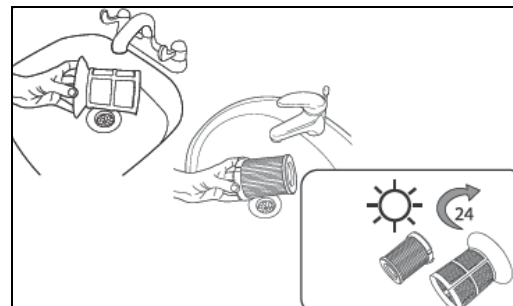

Return the central filter, shroud and filter sleeve to the dirt container. Replace the dirt container as directed, ensuring that it locks into place rotating clockwise before the lid is closed.

Post-motor filter:

NOTE: This is located on the back of the vacuum cleaner.

Release the post-motor cover by pressing down on the catch at the top of the cover.

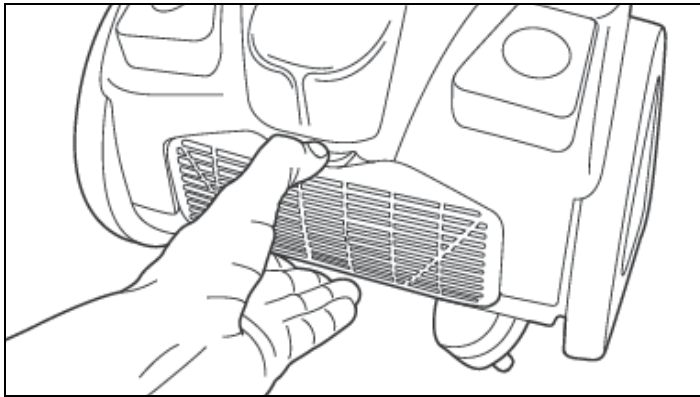

Remove the filter and case by pulling away from the casing then separate the filter from the case.

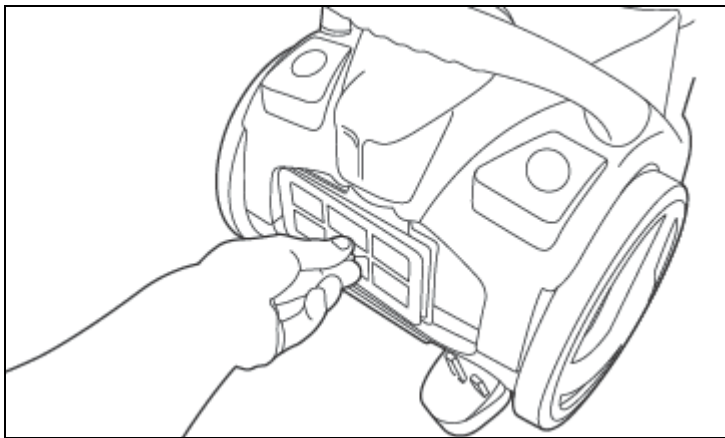

The post-motor filter can be rinsed in warm water (max 40°C). Allow to air dry for at least 24 hours before replacing.

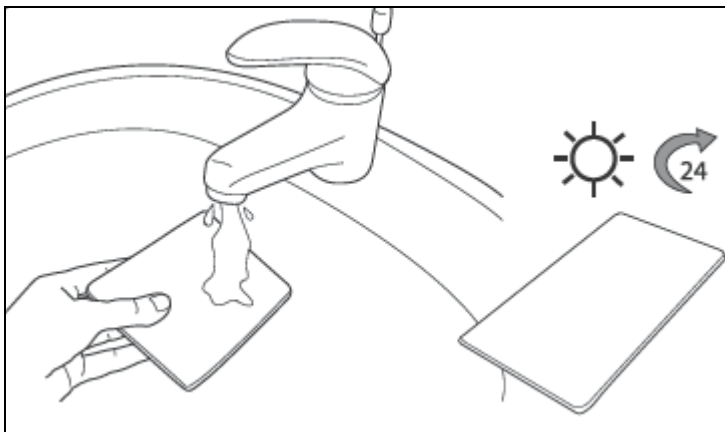

Return the post-motor filter to the casing and re-fit to the back to the vacuum cleaner.

8. Storage



IMPORTANT: Always unplug the vacuum cleaner from the electrical outlet and rewind the power cord as directed before storing.

NOTE: Always store the vacuum cleaner base down.

9. Troubleshooting



WARNING: To reduce the risk of personal injury, unplug the vacuum cleaner before performing maintenance or troubleshooting checks.

PROBLEM:	Vacuum cleaner won't run
Cause:	Not properly plugged into electrical outlet.
Solution:	Plug in securely.
Cause:	No electricity in the electrical outlet.
Solution:	Check fuse or breaker.
Cause:	On/off switch not turned on.
Solution:	Push on/off switch to 'on'.
Cause:	Blocked central filter.
Solution:	Remove, clean and replace filters. See page 6.
Cause:	Blown fuse/tripped breaker.
Solution:	Reset circuit breaker or replace fuse.
PROBLEM:	Cleaner won't pick up/loss of suction.
Cause:	Dirt container not installed properly.
Solution:	Review dirt container replacement.
Cause:	Dirt container full or blocked.
Solution:	Empty dirt container.
Cause:	Clogged filters.
Solution:	Remove, clean and replace filters.
PROBLEM:	Accessories won't pick up.
Cause:	Accessories are not attached correctly.
Solution:	Refer to section 5.
PROBLEM:	Dust escaping from the vacuum cleaner
Cause:	Dirt container full.
Solution:	Empty dirt container.
Cause:	Dirt container not installed correctly.
Solution:	Review dirt container replacement.
Cause:	Hose is not installed correctly.
Solution:	Review installation.
Cause:	Filter not installed completely.
Solution:	Remove, clean and replace filters.

10. Technical Specification

Model:	VB-100
Voltage:	220V ~50Hz
Power:	1400W
Capacity:	1.6 Litres approx
Cord length:	5M approx

*Subject to technical change without notice.



11. Service & Help

Please contact Whirlpool Service Centre:

Address : 14/F Wilson Logistics Centre, 24-28 Kung Yip Street, Kwai Chung, Hong Kong
Star Hotline : 852-2406 9138